

Oklahoma Corporation Commission  
Oil & Gas Conservation Division  
Post Office Box 52000  
Oklahoma City, Oklahoma 73152-2000  
Rule 165: 10-3-25

Form 1002A

API No.: 35037293850000

**Completion Report**

Spud Date: November 14, 2017

OTC Prod. Unit No.: 037-223648-0-0000

Drilling Finished Date: November 22, 2017

1st Prod Date: December 07, 2017

Completion Date: December 04, 2017

**Drill Type: STRAIGHT HOLE**

Well Name: WINGO 4

Purchaser/Measurer:

Location: CREEK 21 16N 10E  
SE NW NW SW  
2285 FSL 451 FWL of 1/4 SEC  
Derrick Elevation: 0 Ground Elevation: 0

First Sales Date:

Operator: WEINS HORTON L 21286  
PO BOX 571117  
21710 W 41ST ST (SAND SPRINGS)  
TULSA, OK 74157-1117

Completion Type		Location Exception		Increased Density	
X	Single Zone	Order No		Order No	
	Multiple Zone	There are no Location Exception records to display.		There are no Increased Density records to display.	
	Commingled				

Casing and Cement							
Type	Size	Weight	Grade	Feet	PSI	SAX	Top of CMT
SURFACE	8 5/8	23	L/S	451		150	SURFACE
PRODUCTION	4 1/2	11.60	L/S	2964		200	1630

Liner								
Type	Size	Weight	Grade	Length	PSI	SAX	Top Depth	Bottom Depth
There are no Liner records to display.								

**Total Depth: 3000**

Packer		Plug	
Depth	Brand & Type	Depth	Plug Type
There are no Packer records to display.		There are no Plug records to display.	

Initial Test Data										
Test Date	Formation	Oil BBL/Day	Oil-Gravity (API)	Gas MCF/Day	Gas-Oil Ratio Cu FT/BBL	Water BBL/Day	Pumpin or Flowing	Initial Shut-In Pressure	Choke Size	Flow Tubing Pressure
Dec 04, 2017	BURGESS	25	36			100	PUMPING	220		

Completion and Test Data by Producing Formation			
Formation Name: BURGESS		Code: 404BRGS	Class: OIL
<b>Spacing Orders</b>		<b>Perforated Intervals</b>	
<b>Order No</b>	<b>Unit Size</b>	<b>From</b>	<b>To</b>
548701	40	2902	2912
<b>Acid Volumes</b>		<b>Fracture Treatments</b>	
500 GALLONS 7 1/2% 10% XYLENE		600 BARRELS OIL, 30,000 POUNDS SAND	

Formation	Top
SKINNER	2030
BARTLESVILLE	2450
DUTCHER	2860
BURGESS	2901

Were open hole logs run? No  
Date last log run: December 04, 2017  
  
Were unusual drilling circumstances encountered? No  
Explanation:

Other Remarks
DID NOT RUN ELECTRIC LOGS DUE TO HOLE BRIDGING OFF.

FOR COMMISSION USE ONLY	
Status: Accepted	1144736

RECEIVED

Form 1002A

Rev. 2009

FEB 04 2020

API NO. 037-29389  
OTC PROB. UNIT NO. 037-223648

(PLEASE TYPE OR USE BLACK INK ONLY)

## OKLAHOMA CORPORATION COMMISSION

Oil &amp; Gas Conservation Division

Post Office Box 52000

Oklahoma City, Oklahoma 73152-2000

Rule 165:10-3-25

## OKLAHOMA CORPORATION COMMISSION

☒ ORIGINAL  
☐ AMENDED (Reason) \_\_\_\_\_

## COMPLETION REPORT

## TYPE OF DRILLING OPERATION

☒ STRAIGHT HOLE ☐ DIRECTIONAL HOLE ☐ HORIZONTAL HOLE  
☐ SERVICE WELL

If directional or horizontal, see reverse for bottom hole location.

COUNTY	Creek	SEC	21	TWP	16N	RGE	10E
LEASE NAME	Wingo	WELL NO.	4	DATE OF WELL COMPLETION	12-4-17	1st PROD DATE	12-7-17
SE 1/4 NW 1/4 NW 1/4 SW 1/4	FSL OF 1/4 SEC	2285	FWL OF 1/4 SEC	451	RECOMP DATE		
ELEVATION	Ground	Latitude (if known)		Longitude (if known)			
OPERATOR NAME	Horton L. Weins	OTC / OCC OPERATOR NO.	21286				
ADDRESS	PO Box 571117						
CITY	Tulsa	STATE	OK	ZIP	74157		

640 Acres

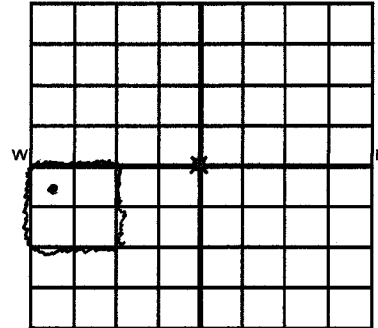

LOCATE WELL

## COMPLETION TYPE

<input checked="" type="checkbox"/> SINGLE ZONE	Burgess
<input type="checkbox"/> MULTIPLE ZONE	
<input type="checkbox"/> COMMINGLED	
<input type="checkbox"/> LOCATION EXCEPTION	
<input type="checkbox"/> ORDER NO.	
<input type="checkbox"/> INCREASED DENSITY	
<input type="checkbox"/> ORDER NO.	

## CASING &amp; CEMENT (Attach Form 1002C)

TYPE	SIZE	WEIGHT	GRADE	FEET	PSI	SAX	TOP OF CMT
CONDUCTOR							
SURFACE	8 5/8	23#	45	451		150	Surface
INTERMEDIATE							
PRODUCTION	4 1/2	11.60#	45	2964		200	1630
LINER							
						TOTAL DEPTH	3000

PACKER @ \_\_\_\_\_ BRAND &amp; TYPE \_\_\_\_\_

PLUG @ \_\_\_\_\_

TYPE \_\_\_\_\_

PLUG @ \_\_\_\_\_

TYPE \_\_\_\_\_

TOTAL DEPTH

PACKER @ \_\_\_\_\_ BRAND &amp; TYPE \_\_\_\_\_

PLUG @ \_\_\_\_\_

TYPE \_\_\_\_\_

PLUG @ \_\_\_\_\_

TYPE \_\_\_\_\_

## COMPLETION &amp; TEST DATA BY PRODUCING FORMATION

FORMATION	Burgess						Monitor Report to Frac Folios
SPACING & SPACING	548' 701' (40)						
ORDER NUMBER							
CLASS: Oil, Gas, Dry, Inj, Disp, Comm Disp, Svc	Oil						
PERFORATED INTERVALS	2902 - 2912	2 Shots	Per Ft				
ACID/VOLUME	500 gyl	7 1/2 %	10 % xylene				
FRACTURE TREATMENT (Fluids/Prop Amounts)	600 bbls oil						
	30,000 lbs sand						

Min Gas Allowable

(165:10-17-7)

Gas Purchaser/Measurer



OR

First Sales Date

Oil Allowable

(165:10-13-3)

## INITIAL TEST DATA

INITIAL TEST DATE	12-4-17					
OIL-BBL/DAY	25					
OIL-GRAVITY (API)	36					
GAS-MCF/DAY	N/A min					
GAS-OIL RATIO CU FT/BBL						
WATER-BBL/DAY	100					
PUMPING OR FLOWING	Pumping					
INITIAL SHUT-IN PRESSURE	220 lbs					
CHOKE SIZE						
FLOW TUBING PRESSURE						

A record of the formations drilled through, and pertinent remarks are presented on the reverse. I declare that I have knowledge of the contents of this report and am authorized by my organization to make this report, which was prepared by me or under my supervision and direction, with the data and facts stated herein to be true, correct, and complete to the best of my knowledge and belief.

Horton L. Weins

SIGNATURE

Horton L. Weins

NAME (PRINT OR TYPE)

1-31-2020 918694-006

DATE

PHONE NUMBER

PO Box 571117

ADDRESS

Tulsa

CITY

OK 74157

STATE

ZIP

EMAIL ADDRESS

PLEASE TYPE OR USE BLACK INK ONLY  
FORMATION RECORD

Give formation names and tops, if available, or descriptions and thickness of formations drilled through. Show intervals cored or drillstem tested.

NAMES OF FORMATIONS	TOP
Skinner Show oil & gas	2030
Bartlesville	2450
Dutcher	2860-
Burgess Show oil	2898
	2901-
	2914

LEASE NAME \_\_\_\_\_ WELL NO. \_\_\_\_\_

FOR COMMISSION USE ONLY	
ITD on file <input type="checkbox"/> YES <input type="checkbox"/> NO	
APPROVED _____	DISAPPROVED _____
2) Reject Codes	
_____	
_____	
_____	
_____	

Were open hole logs run?	yes <input type="checkbox"/> no <input checked="" type="checkbox"/>
Date Last log was run	Dec 4 2017
Was CO <sub>2</sub> encountered?	yes <input type="checkbox"/> no <input checked="" type="checkbox"/> at what depths? _____
Was H <sub>2</sub> S encountered?	yes <input type="checkbox"/> no <input checked="" type="checkbox"/> at what depths? _____
Were unusual drilling circumstances encountered?	yes <input type="checkbox"/> no <input checked="" type="checkbox"/>
If yes, briefly explain below	

Other remarks: Did Not Run Electric logs Due to Hole bridging off

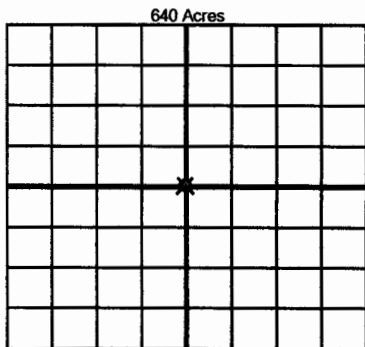

If more than three drainholes are proposed, attach a separate sheet indicating the necessary information.

Direction must be stated in degrees azimuth. Please note, the horizontal drainhole and its end point must be located within the boundaries of the lease or spacing unit.

Directional surveys are required for all drainholes and directional wells.

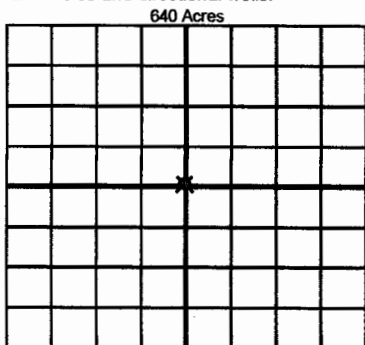

BOTTOM HOLE LOCATION FOR DIRECTIONAL HOLE

SEC	TWP	RGE	COUNTY
Spot Location			
1/4	1/4	1/4	1/4
Measured Total Depth		True Vertical Depth	Feet From 1/4 Sec Lines FSL _____ FWL _____
BHL From Lease, Unit, or Property Line: _____			

BOTTOM HOLE LOCATION FOR HORIZONTAL HOLE: (LATERALS)

LATERAL #1			
SEC	TWP	RGE	COUNTY
Spot Location			
1/4	1/4	1/4	1/4
Depth of Deviation		Radius of Turn	Direction
Measured Total Depth		True Vertical Depth	Total Length
BHL From Lease, Unit, or Property Line: _____			

LATERAL #2			
SEC	TWP	RGE	COUNTY
Spot Location			
1/4	1/4	1/4	1/4
Depth of Deviation		Radius of Turn	Direction
Measured Total Depth		True Vertical Depth	Total Length
BHL From Lease, Unit, or Property Line: _____			

LATERAL #3			
SEC	TWP	RGE	COUNTY
Spot Location			
1/4	1/4	1/4	1/4
Depth of Deviation		Radius of Turn	Direction
Measured Total Depth		True Vertical Depth	Total Length
BHL From Lease, Unit, or Property Line: _____			