

Oklahoma Corporation Commission  
Oil & Gas Conservation Division  
Post Office Box 52000  
Oklahoma City, Oklahoma 73152-2000  
Rule 165: 10-3-25

Form 1002A

API No.: 35111275330000

**Completion Report**

Spud Date: November 18, 2019

OTC Prod. Unit No.:

Drilling Finished Date: November 21, 2019

1st Prod Date: February 25, 2020

Completion Date: February 01, 2020

**Drill Type: STRAIGHT HOLE**

Well Name: BIG CHIEF 2-30

Purchaser/Measurer:

Location: OKMULGEE 30 15N 11E  
C S2 SW SE  
330 FSL 660 FWL of 1/4 SEC  
Derrick Elevation: 0 Ground Elevation: 774

First Sales Date:

Operator: WFD OIL CORPORATION 17501

16800 CONIFER LN  
EDMOND, OK 73012-0619

| Completion Type |               | Location Exception |  | Increased Density |  |
|-----------------|---------------|--------------------|--|-------------------|--|
| X               | Single Zone   | Order No           |  | Order No          |  |
|                 | Multiple Zone | 708649             |  | 708055            |  |
|                 | Commingled    |                    |  |                   |  |

| Casing and Cement |  |       |        |       |      |     |     |            |
|-------------------|--|-------|--------|-------|------|-----|-----|------------|
| Type              |  | Size  | Weight | Grade | Feet | PSI | SAX | Top of CMT |
| SURFACE           |  | 7     | 23     | NEW   | 122  |     | 30  | SURFACE    |
| PRODUCTION        |  | 4 1/2 | 11.5   | NEW   | 3122 |     | 130 | 1764       |

| Liner                                  |      |        |       |        |     |     |           |              |
|----------------------------------------|------|--------|-------|--------|-----|-----|-----------|--------------|
| Type                                   | Size | Weight | Grade | Length | PSI | SAX | Top Depth | Bottom Depth |
| There are no Liner records to display. |      |        |       |        |     |     |           |              |

**Total Depth: 3144**

| Packer                                  |              | Plug                                  |           |
|-----------------------------------------|--------------|---------------------------------------|-----------|
| Depth                                   | Brand & Type | Depth                                 | Plug Type |
| There are no Packer records to display. |              | There are no Plug records to display. |           |

| Initial Test Data |           |             |                   |             |                         |               |                   |                          |            |                      |
|-------------------|-----------|-------------|-------------------|-------------|-------------------------|---------------|-------------------|--------------------------|------------|----------------------|
| Test Date         | Formation | Oil BBL/Day | Oil-Gravity (API) | Gas MCF/Day | Gas-Oil Ratio Cu FT/BBL | Water BBL/Day | Pumpin or Flowing | Initial Shut-In Pressure | Choke Size | Flow Tubing Pressure |
| Feb 15, 2020      | WILCOX    | 15          | 40                |             |                         | 25            | PUMPING           |                          |            |                      |

| Completion and Test Data by Producing Formation |                  |                             |            |
|-------------------------------------------------|------------------|-----------------------------|------------|
| Formation Name: WILCOX                          |                  | Code: 202WLCX               | Class: OIL |
| <b>Spacing Orders</b>                           |                  | <b>Perforated Intervals</b> |            |
| <b>Order No</b>                                 | <b>Unit Size</b> | <b>From</b>                 | <b>To</b>  |
| 658780                                          | 80               | 3036                        | 3046       |
| <b>Acid Volumes</b>                             |                  | <b>Fracture Treatments</b>  |            |
| 250 GALLONS                                     |                  | NONE                        |            |

| Formation       | Top  |
|-----------------|------|
| RED FORK SS     | 1720 |
| BARTLESVILLE SS | 1996 |
| BOOCH SS        | 2300 |
| DUTCHER SS      | 2498 |
| WOODFORD SHALE  | 2922 |
| VIOLA           | 2991 |
| WILCOX SS       | 3034 |

Were open hole logs run? Yes  
Date last log run: February 03, 2020

Were unusual drilling circumstances encountered? No  
Explanation:

| Other Remarks                                                                                                              |
|----------------------------------------------------------------------------------------------------------------------------|
| OCC - SPACING ORDER NUMBER 658780 CREATED AN IRREGULAR UNIT COMPRISED OF SW SE OF SECTION 30 AND NW NE SECTION 31-15N-11E. |

| FOR COMMISSION USE ONLY |         |
|-------------------------|---------|
| Status: Accepted        | 1145077 |

API NO. **111-21533**  
 OTC PROD  
 UNIT NO.

(PLEASE TYPE OR USE BLACK INK ONLY)

OKLAHOMA CORPORATION COMMISSION

Oil & Gas Conservation Division

Post Office Box 52000

Oklahoma City, Oklahoma 73152-2000

Rule 165:10-3-25

Form 1002A

Rev. 2009

☒ ORIGINAL  
☐ AMENDED (Reason) \_\_\_\_\_

COMPLETION REPORT

TYPE OF DRILLING OPERATION

☒ STRAIGHT HOLE ☐ DIRECTIONAL HOLE ☐ HORIZONTAL HOLE  
☐ SERVICE WELL

If directional or horizontal, see reverse for bottom hole location.

|                                                                                |                           |                           |                                         |                                    |
|--------------------------------------------------------------------------------|---------------------------|---------------------------|-----------------------------------------|------------------------------------|
| COUNTY <b>Oklmulgee</b>                                                        | SEC <b>30</b>             | TWP <b>75N</b>            | RGE <b>11E</b>                          | SPUD DATE <b>11/18/19</b>          |
| LEASE NAME <b>BIG CHIEF</b>                                                    | WELL NO. <b>2-30</b>      |                           |                                         | DRLG FINISHED DATE <b>11/21/19</b> |
| C <b>1/4</b> <b>3 1/2</b> <b>1/4</b> <b>SW</b> <b>1/4</b> <b>SE</b> <b>1/4</b> | FSL OF 1/4 SEC <b>330</b> | FWL OF 1/4 SEC <b>660</b> | DATE OF WELL COMPLETION <b>2-1-2020</b> |                                    |
| ELEVATION Ground <b>774</b>                                                    | Latitude (if known)       | Longitude (if known)      | 1st PROD DATE <b>2-25-2020</b>          |                                    |
| OPERATOR NAME <b>WFD OIL CORP</b>                                              |                           |                           | RECOMP DATE                             |                                    |
| ADDRESS <b>16800 Conifer Lane</b>                                              |                           |                           | OTC / OCC OPERATOR NO. <b>17501</b>     |                                    |
| CITY <b>EDMOND</b>                                                             | STATE <b>OK</b>           | ZIP <b>73012</b>          |                                         |                                    |

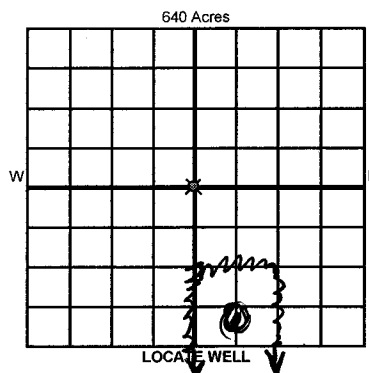

COMPLETION TYPE

|                                                 |                |
|-------------------------------------------------|----------------|
| <input checked="" type="checkbox"/> SINGLE ZONE |                |
| <input type="checkbox"/> MULTIPLE ZONE          |                |
| Application Date                                |                |
| <input type="checkbox"/> COMMINGLED             |                |
| Application Date                                |                |
| LOCATION EXCEPTION ORDER NO.                    | <b>7080549</b> |
| INCREASED DENSITY ORDER NO.                     | <b>7080055</b> |

CASING & CEMENT (Attach Form 1002C)

| TYPE         | SIZE   | WEIGHT | GRADE | FEET     | PSI | SAX         | TOP OF CMT  |
|--------------|--------|--------|-------|----------|-----|-------------|-------------|
| CONDUCTOR    |        |        |       |          |     |             |             |
| SURFACE      | 7"     | 23     | new   | 625' 122 |     | 30          | surface     |
| INTERMEDIATE |        |        |       |          |     |             |             |
| PRODUCTION   | 4 1/2" | 11.5   | new   | 3122     |     | 130         | 1764        |
| LINER        |        |        |       |          |     |             |             |
|              |        |        |       |          |     | TOTAL DEPTH | <b>3144</b> |

PACKER @ \_\_\_\_\_ BRAND & TYPE \_\_\_\_\_ PLUG @ \_\_\_\_\_ TYPE \_\_\_\_\_ PLUG @ \_\_\_\_\_ TYPE \_\_\_\_\_  
 PACKER @ \_\_\_\_\_ BRAND & TYPE \_\_\_\_\_ PLUG @ \_\_\_\_\_ TYPE \_\_\_\_\_ PLUG @ \_\_\_\_\_ TYPE \_\_\_\_\_

COMPLETION & TEST DATA BY PRODUCING FORMATION

|                                                 |                   |  |  |  |  |                |
|-------------------------------------------------|-------------------|--|--|--|--|----------------|
| FORMATION                                       | <b>WILCOX SS</b>  |  |  |  |  | <b>No Frac</b> |
| SPACING & SPACING ORDER NUMBER                  | <b>6587 80-80</b> |  |  |  |  |                |
| CLASS: Oil, Gas, Dry, Inj, Disp, Comm Disp, Svc | <b>OIL</b>        |  |  |  |  |                |
| PERFORATED INTERVALS                            | <b>3036-46</b>    |  |  |  |  |                |
| ACID VOLUME                                     | <b>250 gal C</b>  |  |  |  |  |                |
| FRACTURE TREATMENT (Fluids/Prop Amounts)        | <b>None</b>       |  |  |  |  |                |

Min Gas Allowable (165:10-17-7)

Gas Purchaser/Measurer

☐

OR

First Sales Date

INITIAL TEST DATA

Oil Allowable (165:10-13-3)

|                          |                  |  |  |  |  |
|--------------------------|------------------|--|--|--|--|
| INITIAL TEST DATE        | <b>2-15-2020</b> |  |  |  |  |
| OIL-BBL/DAY              | <b>15</b>        |  |  |  |  |
| OIL-GRAVITY (API)        | <b>40</b>        |  |  |  |  |
| GAS-MCF/DAY              | <b>757M</b>      |  |  |  |  |
| GAS-OIL RATIO CU FT/BBL  | <b>—</b>         |  |  |  |  |
| WATER-BBL/DAY            | <b>25</b>        |  |  |  |  |
| PUMPING OR FLOWING       | <b>pumping</b>   |  |  |  |  |
| INITIAL SHUT-IN PRESSURE | <b>—</b>         |  |  |  |  |
| CHOKE SIZE               | <b>—</b>         |  |  |  |  |
| FLOW TUBING PRESSURE     | <b>—</b>         |  |  |  |  |

**RECEIVED**  
**APR 17 2020**  
 Oklahoma Corporation  
 Commission

A record of the formation drilled through, and pertinent remarks are presented on the reverse. I declare that I have knowledge of the contents of this report and am authorized by my organization to make this report, which was prepared by me or under my supervision and direction, with the data and facts stated herein to be true, correct, and complete to the best of my knowledge and belief.

|                                                   |                                       |                       |                                  |
|---------------------------------------------------|---------------------------------------|-----------------------|----------------------------------|
| SIGNATURE <b>WFDost JR</b>                        | NAME (PRINT OR TYPE) <b>WFDost JR</b> | DATE <b>3/31/2020</b> | PHONE NUMBER <b>405-715-3136</b> |
| ADDRESS <b>16800 Conifer Lane</b>                 | CITY <b>EDMOND</b>                    | STATE <b>OK</b>       | ZIP <b>73012</b>                 |
| EMAIL ADDRESS <b>Bdost, WFD &amp; caxinet.net</b> |                                       |                       |                                  |

PLEASE TYPE OR USE BLACK INK ONLY

FORMATION RECORD

Give formation names and tops, if available, or descriptions and thickness of formations drilled through. Show intervals cored or drillstem tested.

LEASE NAME

Big Chief

WELL NO.

2-30

| NAMES OF FORMATIONS | TOP   |
|---------------------|-------|
| Red Fork ss         | 1720' |
| Bartholomew ss      | 1996  |
| Booch ss            | 2300  |
| Dutcher ss          | 2498  |
| Woodford sh         | 2922  |
| Viola               | 2991  |
| Wilcox ss           | 3034  |

FOR COMMISSION USE ONLY

ITD on file ☐ YES ☐ NO

APPROVED \_\_\_\_\_ DISAPPROVED \_\_\_\_\_

2) Reject Codes \_\_\_\_\_

Were open hole logs run? ☒ yes ☐ no

Date Last log was run 2-3-2020

Was CO<sub>2</sub> encountered? ☐ yes ☒ no at what depths? \_\_\_\_\_

Was H<sub>2</sub>S encountered? ☐ yes ☒ no at what depths? \_\_\_\_\_

Were unusual drilling circumstances encountered? ☐ yes ☒ no

If yes, briefly explain below \_\_\_\_\_

Other remarks:

OCC - Spacing order 658780 created an irregular unit comprised of SWSE of Sec 30 & NWNE section 31 - 15N-11E.

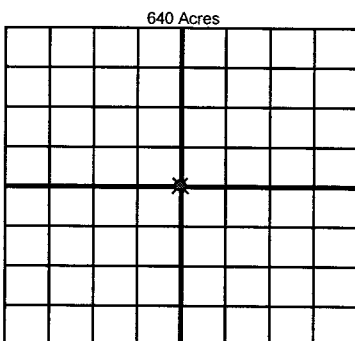

If more than three drainholes are proposed, attach a separate sheet indicating the necessary information.

Direction must be stated in degrees azimuth. Please note, the horizontal drainhole and its end point must be located within the boundaries of the lease or spacing unit.

Directional surveys are required for all drainholes and directional wells.

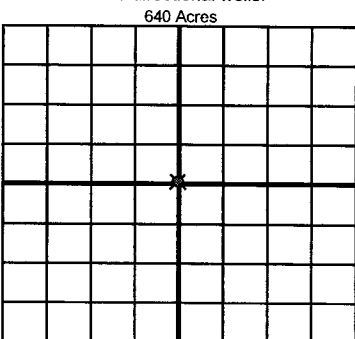

BOTTOM HOLE LOCATION FOR DIRECTIONAL HOLE

|                      |     |                     |                                         |
|----------------------|-----|---------------------|-----------------------------------------|
| SEC                  | TWP | RGE                 | COUNTY                                  |
| Spot Location        |     |                     |                                         |
| 1/4                  | 1/4 | 1/4                 | 1/4                                     |
| Measured Total Depth |     | True Vertical Depth | BHL From Lease, Unit, or Property Line: |
|                      |     |                     |                                         |

BOTTOM HOLE LOCATION FOR HORIZONTAL HOLE: (LATERALS)

LATERAL #1

|                      |     |                     |                                         |
|----------------------|-----|---------------------|-----------------------------------------|
| SEC                  | TWP | RGE                 | COUNTY                                  |
| Spot Location        |     |                     |                                         |
| 1/4                  | 1/4 | 1/4                 | 1/4                                     |
| Depth of Deviation   |     | Radius of Turn      | Direction                               |
| Measured Total Depth |     | True Vertical Depth | BHL From Lease, Unit, or Property Line: |
|                      |     |                     |                                         |

LATERAL #2

|                      |     |                     |                                         |
|----------------------|-----|---------------------|-----------------------------------------|
| SEC                  | TWP | RGE                 | COUNTY                                  |
| Spot Location        |     |                     |                                         |
| 1/4                  | 1/4 | 1/4                 | 1/4                                     |
| Depth of Deviation   |     | Radius of Turn      | Direction                               |
| Measured Total Depth |     | True Vertical Depth | BHL From Lease, Unit, or Property Line: |
|                      |     |                     |                                         |

LATERAL #3

|                      |     |                     |                                         |
|----------------------|-----|---------------------|-----------------------------------------|
| SEC                  | TWP | RGE                 | COUNTY                                  |
| Spot Location        |     |                     |                                         |
| 1/4                  | 1/4 | 1/4                 | 1/4                                     |
| Depth of Deviation   |     | Radius of Turn      | Direction                               |
| Measured Total Depth |     | True Vertical Depth | BHL From Lease, Unit, or Property Line: |
|                      |     |                     |                                         |