

Oklahoma Corporation Commission
Oil & Gas Conservation Division
Post Office Box 52000
Oklahoma City, Oklahoma 73152-2000
Rule 165: 10-3-25

Form 1002A

API No.: 35137275940000

Completion Report

Spud Date: December 28, 2019

OTC Prod. Unit No.: 137-2266430-000

Drilling Finished Date: February 14, 2020

1st Prod Date: March 23, 2020

Completion Date: March 09, 2020

Drill Type: HORIZONTAL HOLE

Well Name: NORTH BASIN 2-13HW

Purchaser/Measurer: ENABLE GATHERING &
PROCESSING

First Sales Date: 4/02/2020

Location: STEPHENS 13 1N 5W
NW NE NW NW
272 FNL 705 FWL of 1/4 SEC
Latitude: 34.5644351896 Longitude: -97.68342835
Derrick Elevation: 1227 Ground Elevation: 1200

Operator: CITATION OIL & GAS CORPORATION 14156

14077 CUTTEN RD
HOUSTON, TX 77069-2212

Completion Type		Location Exception		Increased Density	
X	Single Zone	Order No		Order No	
	Multiple Zone	713440		There are no Increased Density records to display.	
	Commingle				

Casing and Cement							
Type	Size	Weight	Grade	Feet	PSI	SAX	Top of CMT
SURFACE	13.375	54.5	J-55	1533	400	745	SURFACE
PRODUCTION	5.50	23	HCP-110	17430	2970	1840	10359
INTERMEDIATE	9.625	40	HCP110	10362	1400	1175	9422

Liner								
Type	Size	Weight	Grade	Length	PSI	SAX	Top Depth	Bottom Depth
There are no Liner records to display.								

Total Depth: 17431

Packer		Plug	
Depth	Brand & Type	Depth	Plug Type
NA	NA	NA	NA

Initial Test Data

Test Date	Formation	Oil BBL/Day	Oil-Gravity (API)	Gas MCF/Day	Gas-Oil Ratio Cu FT/BBL	Water BBL/Day	Pumpin or Flowing	Initial Shut-In Pressure	Choke Size	Flow Tubing Pressure
Mar 02, 2019	WOODFORD	192	56	8863	46161	1500	FLOWING	2200	45/64	680

Completion and Test Data by Producing Formation

Formation Name: WOODFORD

Code: 319WDFD

Class: GAS

Spacing Orders	
Order No	Unit Size
697479	640

Perforated Intervals	
From	To
12615	17289
12615	12732
12771	12891
12945	13079
13146	13300
13507	13619
13677	13783
13825	13953
13995	14109
14170	14292
14330	14441
14509	14610
14669	14790
14847	14964
15024	15149
15192	15313
15375	15489
15538	15681
15730	15854
15906	16042
16286	16415
16466	16600
16090	16241
16655	16799
16864	17014
17079	17239

Acid Volumes
PERFS 12615 - 17289 OA - 81,000 GALLONS 15% HCL
PERFS 17,288-17,289' AS FOLLOWS: 3000 GALS 15% HCL
PERFS 17,079-17,239', AS FOLLOWS: 3,000 GALS 15% HCL,
PERFS 16,864-17,014' AS FOLLOWS: 3000 GALS 15% HCL

Fracture Treatments
PERFS 12615 - 17289 OA - 8,258,728 LBS SAND
PERFS 12615-12732 OA - 301,181 LBS PROPANT
PERFS 12771 - 12891 OA - 302263 LBS PROPANT
PERFS 12945 - 13079 OA - 312078 LBS PROPANT
PERFS 13146 - 13300 OA - 313720 LBS PROPANT

PERFS 16,655-16,799' AS FOLLOWS: 3,000 GALS 15% HCL
PERFS 16,466-16,600' AS FOLLOWS: 3,000 GALS 15% HCL
PERFS 16,286-16,415' AS FOLLOWS: 3,192 GALS 15% HCL
PERFS 16,090-16,241' AS FOLLOWS: 3000 GALS 15% HC
PERFS 15,906-16,042' AS FOLLOWS: 3,000 GALS 15% HCL
PERFS 15,730-15,854' AS FOLLOWS: 3,000 GALS 15% HCL
PERFS 15,538-15,681' AS FOLLOWS: 3,360 GALS 15% HCL
PERFS 15,375-15,489' AS FOLLOWS: 3000 GALS 15% HCL
PERFS 15,192-15,313' AS FOLLOWS: 3,000 GALS 15% HCL
PERFS 15,024-15,149' AS FOLLOWS: 3,000 GALS 15% HCL
PERFS 14,847-14,964' AS FOLLOWS: 3,000 GALS 15% HCL
PERFS 14,669-14,790' AS FOLLOWS: 3000 GALS 15% HCL
PERFS 14,509-14,610' AS FOLLOWS: 3,000 GALS 15% HCL
PERFS 14,330-14,441' AS FOLLOWS: 3,000 GALS 15% HCL
PERFS 14,170-14,292' AS FOLLOWS: 3000 GALS 15% HCL
PERFS 13,995-14,109' AS FOLLOWS: 3,000 GALS 15% HCL
PERFS 13,825-13,953' AS FOLLOWS: 3,000 GALS 15% HCL
PERFS 13,677-13,783' AS FOLLOWS: 3,000 GALS 15% HCL
PERFS 13,507-13,619' AS FOLLOWS: 3,000 GALS 15% HCL
PERFS 13,350-13,459' AS FOLLOWS: 3000 GALS 15% HCL
PERFS 13,146-13,300' AS FOLLOWS: 3,000 GALS 15% HCL
PERFS 12,945-13,079' AS FOLLOWS: 3,000 GALS 15% HCL
PERFS 12,771-12,891' AS FOLLOWS: 3,000 GALS 15% HCL
PERFS 12,615-12,732' AS FOLLOWS: 3000 GALS 15% HCL

PERFS 13350 - 13459 OA - 312411 LBS PROPANT
PERFS 13507 - 13619 OA - 306304 LBS PROPANT
PERFS 13677 - 13783 OA 308813 LBS PROPANT
PERFS 13825 - 13953 OA - 312810 LBS PROPANT
PERFS 13995 - 14109 OA - 311078 LBS PROPANT
PERFS 14170 - 14292 OA - 313001 LBS PROPAN
PERFS 14330 - 14441 OA - 313544 LBS PROPANT
PERFS 14509 - 14610 OA - 306876 LBS PROPANT
PERFS 14669 - 14790 OA - 312078 LBS PROPANT
PERFS 14847 - 14964 OA - 313734 LBS PROPANT
PERFS 15024 - 15149 OA - 312324 LBS PROPANT
PERFS 15192 - 15313 OA - 315989 LBS PROPANT
PERFS 15375 - 15489 OA - 314416 LBS PROPANT
PERFS 15538 - 15681 OA - 312082 LBS PROPANT
PERFS 15730 - 15854 OA - 313238 LBS PROPANT
PERFS 15906 - 16042 OA - 315401 LBS PROPANT
PERFS 16090 - 16241 OA - 311818 LBS PROPANT
PERFS 16286 - 16415 OA - 312017 LBS PROPANT
PERFS 16466 - 15500 OA - 312017 LBS PROPANT
PERFS 16655 - 16799 OA 312105 LBS PROPANT
PERFS 16864 - 17014 OA - 316630 LBS PROPANT
PERFS 17079 - 17239 OA - 312141 LBS PROPANT

Formation	Top
WOODFORD	12615

Were open hole logs run? Yes

Date last log run: February 23, 2020

Were unusual drilling circumstances encountered? No

Explanation:

Other Remarks
There are no Other Remarks.

Lateral Holes
Sec: 13 TWP: 1N RGE: 5W County: STEPHENS
SE SW SW SW
50 FSL 398 FWL of 1/4 SEC
Depth of Deviation: 12234 Radius of Turn: 431 Direction: 180 Total Length: 4674
Measured Total Depth: 17431 True Vertical Depth: 12432 End Pt. Location From Release, Unit or Property Line: 50

FOR COMMISSION USE ONLY
Status: Accepted

 SIGNATURE		Sharon Ward NAME (PRINT OR TYPE)		4/27/2020 DATE	281-891-1555 PHONE NUMBER
14077 Cutten Rd ADDRESS		Houston CITY	Texas 77069 STATE ZIP	sward@cogc.com EMAIL ADDRESS	

PLEASE TYPE OR USE BLACK INK ONLY
FORMATION RECORD

Give formation names and tops, if available, or descriptions and thickness of formations drilled through. Show intervals cored or drillstem tested.

NAMES OF FORMATIONS	TOP
Woodford	12615

LEASE NAME NORTH BASIN

WELL NO. 2-134W

FOR COMMISSION USE ONLY	
ITD on file	<input type="checkbox"/> YES <input type="checkbox"/> NO
APPROVED	DISAPPROVED
2) Reject Codes	

Were open hole logs run?	<input checked="" type="checkbox"/> yes <input type="checkbox"/> no
Date Last log was run	February 13, 2020
Was CO ₂ encountered?	<input type="checkbox"/> yes <input checked="" type="checkbox"/> no at what depths?
Was H ₂ S encountered?	<input type="checkbox"/> yes <input checked="" type="checkbox"/> no at what depths?
Were unusual drilling circumstances encountered?	<input type="checkbox"/> yes <input checked="" type="checkbox"/> no
If yes, briefly explain below	

Other remarks:

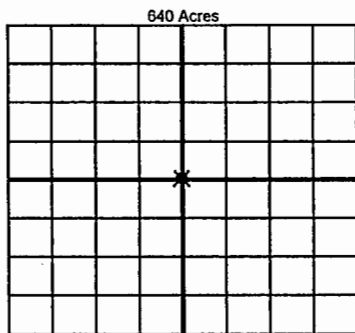

If more than three drainholes are proposed, attach a separate sheet indicating the necessary information.

Direction must be stated in degrees azimuth. Please note, the horizontal drainhole and its end point must be located within the boundaries of the lease or spacing unit.

Directional surveys are required for all drainholes and directional wells.

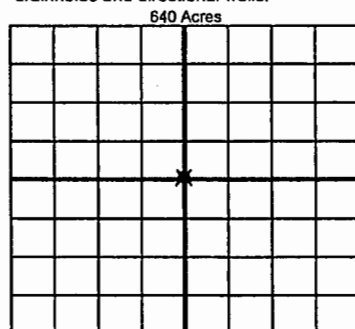

BOTTOM HOLE LOCATION FOR DIRECTIONAL HOLE

SEC	TWP	RGE	COUNTY
Spot Location	1/4	1/4	1/4
Measured Total Depth	True Vertical Depth	BHL From Lease, Unit, or Property Line:	FSL FWL

BOTTOM HOLE LOCATION FOR HORIZONTAL HOLE: (LATERALS)

LATERAL #1			
SEC	TWP	RGE	COUNTY
13	1N	5W	Stephens
Spot Location	1/4	1/4	1/4
Depth of Deviation	12234'	Radius of Turn	431.62
Measured Total Depth	17431'	True Vertical Depth	12452'
Direction	180.4 deg	Total Length	4674'
BHL From Lease, Unit, or Property Line:	47 FSL		287 FWL

LATERAL #2			
SEC	TWP	RGE	COUNTY
Spot Location	1/4	1/4	1/4
Depth of Deviation		Radius of Turn	
Measured Total Depth		True Vertical Depth	
Direction		Total Length	
BHL From Lease, Unit, or Property Line:			

LATERAL #3			
SEC	TWP	RGE	COUNTY
Spot Location	1/4	1/4	1/4
Depth of Deviation		Radius of Turn	
Measured Total Depth		True Vertical Depth	
Direction		Total Length	
BHL From Lease, Unit, or Property Line:			