

Oklahoma Corporation Commission
Oil & Gas Conservation Division
Post Office Box 52000
Oklahoma City, Oklahoma 73152-2000
Rule 165: 10-3-25

Form 1002A

API No.: 35125237090003

Completion Report

Spud Date: December 17, 2010

OTC Prod. Unit No.: 125-205009-0-0000

Drilling Finished Date: January 08, 2011

Amended

1st Prod Date: February 10, 2011

Amend Reason: RECOMPLETION - SHOW ACID JOB

Completion Date: July 08, 2011

Recomplete Date: January 30, 2018

Drill Type: STRAIGHT HOLE

Well Name: MATTHEWS 2-6

Purchaser/Measurer:

Location: POTTAWATOMIE 6 6N 2E
W2 NE SW NE
990 FSL 763 FWL of 1/4 SEC
Latitude: 35.012937 Longitude: -97.0749989
Derrick Elevation: 0 Ground Elevation: 1125

First Sales Date:

Operator: EAGLE ROAD OIL LLC 23778

321 S BOSTON AVE STE 700
TULSA, OK 74103-3312

| Completion Type | |
|-----------------|---------------|
| X | Single Zone |
| | Multiple Zone |
| | Commingled |

| Location Exception | |
|---|--|
| Order No | |
| There are no Location Exception records to display. | |

| Increased Density | |
|--|--|
| Order No | |
| There are no Increased Density records to display. | |

| Casing and Cement | | | | | | | |
|-------------------|-------|--------|-------|------|-----|-----|------------|
| Type | Size | Weight | Grade | Feet | PSI | SAX | Top of CMT |
| CONDUCTOR | 16 | | | 47 | | 10 | SURFACE |
| SURFACE | 8 5/8 | 24 | J-55 | 370 | | 265 | SURFACE |
| PRODUCTION | 5 1/2 | 17 | J-55 | 7018 | | 500 | 4550 |

| Liner | | | | | | | | |
|--|------|--------|-------|--------|-----|-----|-----------|--------------|
| Type | Size | Weight | Grade | Length | PSI | SAX | Top Depth | Bottom Depth |
| There are no Liner records to display. | | | | | | | | |

Total Depth: 7050

| Packer | |
|---|--------------|
| Depth | Brand & Type |
| There are no Packer records to display. | |

| Plug | |
|-------|-----------|
| Depth | Plug Type |
| 5580 | CIBP |
| 5959 | CIBP |
| 6900 | CIBP |

| Initial Test Data | | | | | | | | | | |
|-------------------|-----------|-------------|-------------------|-------------|-------------------------|---------------|-------------------|--------------------------|------------|----------------------|
| Test Date | Formation | Oil BBL/Day | Oil-Gravity (API) | Gas MCF/Day | Gas-Oil Ratio Cu FT/BBL | Water BBL/Day | Pumpin or Flowing | Initial Shut-In Pressure | Choke Size | Flow Tubing Pressure |
| Jan 30, 2018 | WOODFORD | 2 | 32 | | | 8 | PUMPING | | | |

| Completion and Test Data by Producing Formation | | | | | | | | | |
|---|--|-----------|--|--|--|--|------------|--|--|
| Formation Name: WOODFORD | | | | Code: 319WDFD | | | Class: OIL | | |
| Spacing Orders | | | | Perforated Intervals | | | | | |
| Order No | | Unit Size | | From | | | To | | |
| 566840 | | 80 | | 5510 | | | 5530 | | |
| Acid Volumes | | | | Fracture Treatments | | | | | |
| 700 GALLONS 15% ACID | | | | 10,300 BARRELS LOAD WATER, 296,070 POUNDS SAND | | | | | |

| Formation | Top |
|-----------|------|
| WOODFORD | 5339 |

Were open hole logs run? Yes
Date last log run: January 08, 2011

Were unusual drilling circumstances encountered? No
Explanation:

| Other Remarks |
|-----------------------------|
| There are no Other Remarks. |

| FOR COMMISSION USE ONLY | |
|-------------------------|---------|
| Status: Accepted | 1144788 |

API NO. 3512523709
OTC PROD. UNIT NO. 125-205009

OKLAHOMA CORPORATION COMMISSION
Oil & Gas Conservation Division
Post Office Box 52000
Oklahoma City, Oklahoma 73152-2000
Rule 165:10-3-25

RECEIVED

Form 1002A
Rev. 2009

FEB 18 2020

ORIGINAL
☒ AMENDED (Reason)

RECOMPLETION - Show Acid Job

COMPLETION REPORT

TYPE OF DRILLING OPERATION

☒ STRAIGHT HOLE ☐ DIRECTIONAL HOLE ☐ HORIZONTAL HOLE
☐ SERVICE WELL

If directional or horizontal, see reverse for bottom hole location.

| | | | | | | | | | |
|-----------------------------|------------------------------|------------------------|---------------------|--------------------|----------------------|-------------------------|----------|---------------|------------|
| COUNTY | Pottawatomie | SEC | 6 | TWP | 6N | RGE | 2E | SPUD DATE | 12-17-2010 |
| LEASE NAME | Matthews | WELL NO. | 2-6 | DRLG FINISHED DATE | 1-8-2011 | DATE OF WELL COMPLETION | 7-8-2011 | 1st PROD DATE | 2-10-2011 |
| W2 1/4 NE 1/4 SW 1/4 NE 1/4 | FSL OF 1/4 SEC | 990 | FWL OF 1/4 SEC | 763 | RECOMP DATE | 1-30-18 | | | |
| ELEVATION Derrick FL | Ground | 1125 | Latitude (if known) | 35.012937 | Longitude (if known) | -97.074989 | | | |
| OPERATOR NAME | Eagle Road Oil, LLC | OTC / OCC OPERATOR NO. | 23778 | 0 | | | | | |
| ADDRESS | 321 So. Boston Ave Suite 700 | | | | | | | | |
| CITY | Tulsa | STATE | OK | ZIP | 74103 | | | | |

OKLAHOMA CORPORATION COMMISSION

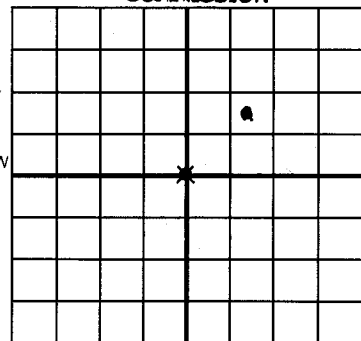

LOCATE WELL

COMPLETION TYPE

| | |
|---|--|
| <input checked="" type="checkbox"/> SINGLE ZONE | |
| <input type="checkbox"/> MULTIPLE ZONE | |
| Application Date | |
| COMMINGLED | |
| Application Date | |
| LOCATION EXCEPTION ORDER NO. | |
| INCREASED DENSITY ORDER NO. | |

CASING & CEMENT (Attach Form 1002C)

| TYPE | SIZE | WEIGHT | GRADE | FEET | PSI | SAX | TOP OF CMT |
|--------------|-------|--------|-------|------|-----|-----|------------|
| CONDUCTOR | 16 | | | 47 | | 10 | surface |
| SURFACE | 8 5/8 | 24 | J-55 | 370 | | 265 | surface |
| INTERMEDIATE | | | | | | | |
| PRODUCTION | 5 1/2 | 17 | J-55 | 7018 | | 500 | 4550 |
| LINER | | | | | | | |

PACKER @ _____ BRAND & TYPE _____ PLUG @ 5580 TYPE CIBP PLUG @ 6900 TYPE CFBP
PACKER @ _____ BRAND & TYPE _____ PLUG @ 5459 TYPE CFBP PLUG @ _____ TYPE _____

TOTAL DEPTH 7,050

COMPLETION & TEST DATA BY PRODUCING FORMATION

| | | | | | | | |
|---|---|--|--|--|--|--|--|
| FORMATION | Woodford | | | | | | |
| SPACING & SPACING ORDER NUMBER | 80 ac 566840 | | | | | | |
| CLASS: Oil, Gas, Dry, Inj, Disp, Comm Disp, Svc | Oil | | | | | | |
| PERFORATED INTERVALS | 5510-30 | | | | | | |
| ACID/VOLUME | 700 gal 15% acid | | | | | | |
| FRACTURE TREATMENT (Fluids/Prop Amounts) | 10,300 BLW Bbls Load Water 296,070# sand | | | | | | |

Min Gas Allowable (165:10-17-7)

Gas Purchaser/Measurer

OR

First Sales Date

Oil Allowable (165:10-13-3)

INITIAL TEST DATA

| | | | | | | | |
|--------------------------|-----------|--|--|--|--|--|--|
| INITIAL TEST DATE | 1/30/2018 | | | | | | |
| OIL-BBL/DAY | 2 | | | | | | |
| OIL-GRAVITY (API) | 32 | | | | | | |
| GAS-MCF/DAY | TSTM | | | | | | |
| GAS-OIL RATIO CU FT/BBL | | | | | | | |
| WATER-BBL/DAY | 8 | | | | | | |
| PUMPING OR FLOWING | Pumping | | | | | | |
| INITIAL SHUT-IN PRESSURE | | | | | | | |
| CHOKE SIZE | | | | | | | |
| FLOW TUBING PRESSURE | | | | | | | |

A record of the formations drilled through, and pertinent remarks are presented on the reverse. I declare that I have knowledge of the contents of this report and am authorized by my organization to make this report, which was prepared by me or under my supervision and direction, with the data and facts stated herein to be true, correct, and complete to the best of my knowledge and belief.

Ann Houchin SIGNATURE ANN HOUCHIN NAME (PRINT OR TYPE) 2/11/20 DATE 918-986-7611 PHONE NUMBER
321 S Boston Ave, Suite 700 ADDRESS Tulsa CITY OK STATE 74103 ZIP a.houchin@eagleroadoil.com EMAIL ADDRESS

PLEASE TYPE OR USE BLACK INK ONLY
FORMATION RECORD

Give formation names and tops, if available, or descriptions and thickness of formations drilled through. Show intervals cored or drillstem tested.

LEASE NAME MATTHEWS

WELL NO. 2-6

| NAMES OF FORMATIONS | TOP |
|---------------------|------|
| Woodford | 5339 |

FOR COMMISSION USE ONLY

ITD on file ☐ YES ☐ NO

APPROVED _____ DISAPPROVED _____

2) Reject Codes _____

Were open hole logs run? ☒ yes ☐ no

Date Last log was run 1-8-2011

Was CO₂ encountered? ☐ yes ☒ no at what depths? _____

Was H₂S encountered? ☐ yes ☒ no at what depths? _____

Were unusual drilling circumstances encountered? ☐ yes ☒ no

If yes, briefly explain below _____

Per Original 1002A

Other remarks: _____

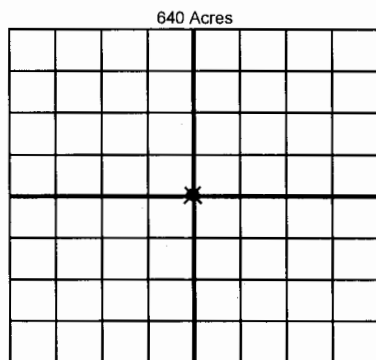

If more than three drainholes are proposed, attach a separate sheet indicating the necessary information.

Direction must be stated in degrees azimuth. Please note, the horizontal drainhole and its end point must be located within the boundaries of the lease or spacing unit.

Directional surveys are required for all drainholes and directional wells.

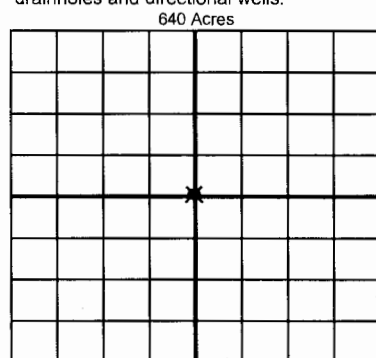

BOTTOM HOLE LOCATION FOR DIRECTIONAL HOLE

| | | | |
|----------------------|-----|-------------------------|---|
| SEC | TWP | RGE | COUNTY |
| Spot Location | | Feet From 1/4 Sec Lines | FSL FWL |
| 1/4 | 1/4 | 1/4 | 1/4 |
| Measured Total Depth | | True Vertical Depth | BHL From Lease, Unit, or Property Line: |

BOTTOM HOLE LOCATION FOR HORIZONTAL HOLE: (LATERALS)

LATERAL #1

| | | | |
|----------------------|---------------------|---|--------------|
| SEC | TWP | RGE | COUNTY |
| Spot Location | | Feet From 1/4 Sec Lines | FSL FWL |
| 1/4 | 1/4 | 1/4 | 1/4 |
| Depth of Deviation | Radius of Turn | Direction | Total Length |
| Measured Total Depth | True Vertical Depth | BHL From Lease, Unit, or Property Line: | |

LATERAL #2

| | | | |
|----------------------|---------------------|---|--------------|
| SEC | TWP | RGE | COUNTY |
| Spot Location | | Feet From 1/4 Sec Lines | FSL FWL |
| 1/4 | 1/4 | 1/4 | 1/4 |
| Depth of Deviation | Radius of Turn | Direction | Total Length |
| Measured Total Depth | True Vertical Depth | BHL From Lease, Unit, or Property Line: | |

LATERAL #3

| | | | |
|----------------------|---------------------|---|--------------|
| SEC | TWP | RGE | COUNTY |
| Spot Location | | Feet From 1/4 Sec Lines | FSL FWL |
| 1/4 | 1/4 | 1/4 | 1/4 |
| Depth of Deviation | Radius of Turn | Direction | Total Length |
| Measured Total Depth | True Vertical Depth | BHL From Lease, Unit, or Property Line: | |