

Oklahoma Corporation Commission
Oil & Gas Conservation Division
Post Office Box 52000
Oklahoma City, Oklahoma 73152-2000
Rule 165: 10-3-25

Form 1002A

API No.: 35133204630001

Completion Report

Spud Date: October 19, 1970

OTC Prod. Unit No.: 133-043290-0-0000

Drilling Finished Date: October 31, 1970

Amended

1st Prod Date: November 18, 1970

Amend Reason: RECOMPLETION

Completion Date: November 17, 1970

Recomplete Date: January 20, 2020

Drill Type: STRAIGHT HOLE

Well Name: GOFORTH 17

Purchaser/Measurer:

Location: SEMINOLE 15 8N 6E
N2 NW SW NE
1065 FSL 330 FWL of 1/4 SEC
Derrick Elevation: 925 Ground Elevation: 918

First Sales Date:

Operator: KEENER OIL & GAS COMPANY 19336

1648 S BOSTON AVE STE 200
TULSA, OK 74119-4416

Completion Type		Location Exception		Increased Density	
X	Single Zone	Order No		Order No	
	Multiple Zone	There are no Location Exception records to display.		There are no Increased Density records to display.	
	Commingled				

Casing and Cement							
Type	Size	Weight	Grade	Feet	PSI	SAX	Top of CMT
SURFACE	10.75	32	J-55	90		80	SURFACE
PRODUCTION	7	24	J-55	4224		150	3200

Liner								
Type	Size	Weight	Grade	Length	PSI	SAX	Top Depth	Bottom Depth
There are no Liner records to display.								

Total Depth: 4250

Packer		Plug	
Depth	Brand & Type	Depth	Plug Type
3291	ARROW 1X	4004	7" CIBP

Initial Test Data										
Test Date	Formation	Oil BBL/Day	Oil-Gravity (API)	Gas MCF/Day	Gas-Oil Ratio Cu FT/BBL	Water BBL/Day	Pumpin or Flowing	Initial Shut-In Pressure	Choke Size	Flow Tubing Pressure
Feb 04, 2020	VIOLA	3	35			1	PUMPING			

Completion and Test Data by Producing Formation

Formation Name: MARSHALL

Code: 202MRSL

Class: DRY

Spacing Orders

Order No	Unit Size
N/A	

Perforated Intervals

From	To
4050	4062

Acid Volumes

N/A

Fracture Treatments

N/A

Formation Name: VIOLA

Code: 202VIOL

Class: OIL

Spacing Orders

Order No	Unit Size
N/A	

Perforated Intervals

From	To
3908	3916

Acid Volumes

500 GALLONS 15%, 1,500 GALLONS 15%

Fracture Treatments

N/A

Formation	Top
MARSHALL	4050
VIOLA	3908

Were open hole logs run? No

Date last log run:

Were unusual drilling circumstances encountered? No

Explanation:

Other Remarks

OCC - ORIGINAL 1002A SAYS D-V TOOL SET AT 907', USED 225 SACKS OF CEMENT.

FOR COMMISSION USE ONLY

1144785

Status: Accepted

API NO. 35-133-20463
OTC PROD. UNIT NO. 133-043290

(PLEASE TYPE OR USE BLACK INK ONLY)

OKLAHOMA CORPORATION COMMISSION
Oil & Gas Conservation Division
Post Office Box 52000
Oklahoma City, Oklahoma 73152-2000
Rule 165:10-3-25

RECEIVED

Form 1002A
Rev. 2009

MAR 02 2020

☐ ORIGINAL
☒ AMENDED (Reason)

Re-Completion

COMPLETION REPORT

TYPE OF DRILLING OPERATION

☒ STRAIGHT HOLE ☐ DIRECTIONAL HOLE ☐ HORIZONTAL HOLE
☐ SERVICE WELL

If directional or horizontal, see reverse for bottom hole location.

COUNTY	Seminole	SEC	15	TWP	8N	RGE	6E	
LEASE NAME	GOFORTH						WELL NO.	17
N2 1/4 NW 1/4 SW 1/4 NE 1/4	FSL OF 1/4 SEC		1065	FWL OF 1/4 SEC		330		
ELEVATION Derrick FL	925	Ground	918	Latitude (if known)		Longitude (if known)		
OPERATOR NAME	KEENER OIL & GAS COMPANY						OTC / OCC OPERATOR NO.	19336-0
ADDRESS	1648 S. BOSTON AVE., SUITE 200							
CITY	TULSA		STATE	OK		ZIP	74119	

OKLAHOMA CORPORATION COMMISSION

640 Acres

LOCATE WELL

COMPLETION TYPE

<input checked="" type="checkbox"/> SINGLE ZONE	
<input type="checkbox"/> MULTIPLE ZONE	
Application Date	
<input type="checkbox"/> COMMINGLED	
Application Date	
LOCATION EXCEPTION	
ORDER NO.	
INCREASED DENSITY	
ORDER NO.	

CASING & CEMENT (Attach Form 1002C)

TYPE	SIZE	WEIGHT	GRADE	FEET	PSI	SAX	TOP OF CMT
CONDUCTOR	NA						
SURFACE	10.75"	32#	J55	90'	NA	80	Surface
INTERMEDIATE	NA						
PRODUCTION	7"	24#	J55	4224'	NA	150	3200'
LINER	NA						

PACKER @ 3291' BRAND & TYPE Arrow 1X PLUG @ 4004' TYPE 7" CIBP PLUG @ TYPE TOTAL DEPTH 4250

COMPLETION & TEST DATA BY PRODUCING FORMATION

FORMATION	MARSHALL	VIOLA				
SPACING & SPACING	NA	NA				No Frac
ORDER NUMBER						
CLASS: Oil, Gas, Dry, Inj, Disp, Comm Disp, Svc	DRY	OIL				
PERFORATED INTERVALS	4050-4062'	3908-3916'				
ACID/VOLUME	NA	500 GALS 15%	1500 GALS 15%			
FRACTURE TREATMENT (Fluids/Prop Amounts)	NA	NA				

Min Gas Allowable (165:10-17-7)
OR
Oil Allowable (165:10-13-3)

Gas Purchaser/Measurer
First Sales Date

INITIAL TEST DATA

INITIAL TEST DATE	2/4/2020
OIL-BBL/DAY	3
OIL-GRAVITY (API)	35
GAS-MCF/DAY	NA
GAS-OIL RATIO CU FT/BBL	NA
WATER-BBL/DAY	1
PUMPING OR FLOWING	PUMPING
INITIAL SHUT-IN PRESSURE	0
CHOKE SIZE	NA
FLOW TUBING PRESSURE	NA

A record of the formations drilled through, and pertinent remarks are presented on the reverse. I declare that I have knowledge of the contents of this report and am authorized by my organization to make this report, which was prepared by me or under my supervision and direction, with the data and facts stated herein to be true, correct, and complete to the best of my knowledge and belief.

SIGNATURE DEWEY F. BARTLETT, JR. DATE 2-27-20 (918) 587-4154
1648 S. Boston Ave., Suite 200 Tulsa OK 74119
ADDRESS CITY STATE ZIP
EMAIL ADDRESS dewey@keeneroil.com

PLEASE TYPE OR USE BLACK INK ONLY

FORMATION RECORD

Give formation names and tops, if available, or descriptions and thickness of formations drilled through. Show intervals cored or drillstem tested.

NAMES OF FORMATIONS	TOP
MARSHALL	4050'
VIOLA	3908'

LEASE NAME _____ WELL NO. _____

FOR COMMISSION USE ONLY	
ITD on file <input type="checkbox"/> YES <input type="checkbox"/> NO	
APPROVED _____	DISAPPROVED _____
2) Reject Codes	

Were open hole logs run?	_____ yes _____ no
Date Last log was run	_____
Was CO ₂ encountered?	_____ yes _____ no at what depths? _____
Was H ₂ S encountered?	_____ yes _____ no at what depths? _____
Were unusual drilling circumstances encountered?	_____ yes _____ no
If yes, briefly explain below	

Other remarks:

OCC - Original 1002A says D-V tool set at 907' used 225 sacks of cement

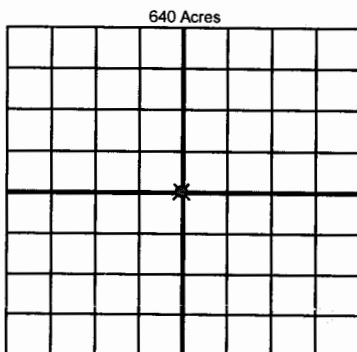

If more than three drainholes are proposed, attach a separate sheet indicating the necessary information.

Direction must be stated in degrees azimuth. Please note, the horizontal drainhole and its end point must be located within the boundaries of the lease or spacing unit.

Directional surveys are required for all drainholes and directional wells.

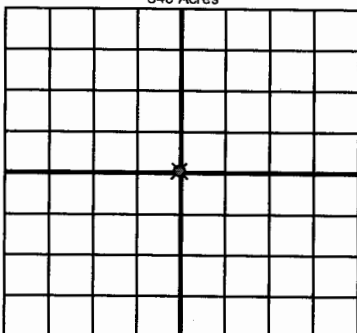

BOTTOM HOLE LOCATION FOR DIRECTIONAL HOLE

SEC	TWP	RGE	COUNTY
Spot Location			
1/4	1/4	1/4	1/4
Measured Total Depth		True Vertical Depth	BHL From Lease, Unit, or Property Line:

BOTTOM HOLE LOCATION FOR HORIZONTAL HOLE: (LATERALS)

LATERAL #1

SEC	TWP	RGE	COUNTY
Spot Location			
1/4	1/4	1/4	1/4
Depth of Deviation		Radius of Turn	Direction
			Total Length
Measured Total Depth		True Vertical Depth	BHL From Lease, Unit, or Property Line:

LATERAL #2

SEC	TWP	RGE	COUNTY
Spot Location			
1/4	1/4	1/4	1/4
Depth of Deviation		Radius of Turn	Direction
			Total Length
Measured Total Depth		True Vertical Depth	BHL From Lease, Unit, or Property Line:

LATERAL #3

SEC	TWP	RGE	COUNTY
Spot Location			
1/4	1/4	1/4	1/4
Depth of Deviation		Radius of Turn	Direction
			Total Length
Measured Total Depth		True Vertical Depth	BHL From Lease, Unit, or Property Line:

OKLAHOMA CORPORATION Oklahoma City Oklahoma
OIL AND GAS CONSERVATION DEPARTMENT

460 Acres

V13320463

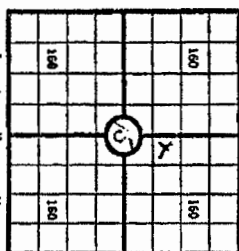

WELL RECORD
COUNTY Seminole SEC 15 TWP 8N RGE 6E
COMPANY OPERATING Keener Oil Company
OFFICE ADDRESS 406 National Bank of Tulsa Bldg.
FARM NAME GoForth
WELL NO 17
DRILLING STARTED 10-19-1970 DRILLING FINISHED 10-31-1970
DATE OF FIRST PRODUCTION 11-18-70 COMPLETED 11-17-70
WELL LOCATED NW 1/4 SW 1/4 NE 1/4 1065 North of South
Line and 330 If East of West Line of Quarter Section
Elevation (Relative to sea level) DENRICK FLOOR 925 GROUND 918
CHARACTER OF WELL (Oil gas or dryhole) Oil

OIL OR GAS SANDS OR ZONES

Name	From	To	Name	From	To
1 2nd Wilcox	4126	4250			
2					
3					

Perforating Record If Any

Shot Record

Formation	From	To	No of Shots	Formation	From	To	Size of Shot
2nd Wilcox	4160	4182	88				

CASING RECORD

Size	WT	Thd	More	FT	In	FT	In	Size	Length	Depth Set	Make
10-3/4	32	8	New	90							
7"	24	10V	Used	4224							

Inner Record Amount

Kind

CEMENTING AND MUDDING

Top

Bottom

Size	Amount Set	Sacks	Chemical	Method of	Amount	Mudding	Results
10-3/4	90	80	Col	Moire			
7"	4224	150	Top	Stage w/DV @ 907'	w/225 SX		

Note What method was used to protect sands if outer strings were pulled?

NOTE Were bottom hole plugs used? If so state kind depth set and results obtained

TOOLS USED

Rotary Tools were used from 0 feet to 4250 cable tools were used from feet to feet and from feet to feet and from feet to feet

Type

INITIAL PRODUCTION TEST

Describe method test whether by flow through tubing or casing or by pumping

Pumping

Amount of Oil Production 70 bbls Size of choke if any None Length of test 24 hrs et
Production 0 bbls Gravity of oil 42 Type of Pump if pump is used describe
2" X 1 1/2" X 4" X 10' bottom hold down

FORMATION RECORD

Formation	Top	Bottom	Formation	Top	Bottom
Surface Hole	0	96			
Shale & Sand	96	1130			
Sand	1130	1237			
Shale & Sand	1237	1554			
Sand & Shale	1554	1827			
Sand & Shale	1827	2572			
Shale-Sand	2572	2675			
Sand-Shale	2675	2943			
Shale-Sand	2943	3047			
Shale-Sand	3047	3240			
Shale	3240	3417			
Shale-Lime	3417	3530			
Shale	3530	3729			
Shale-Lime	3729	3808			
Shale-Sylvan	3808	3896			
Lime-Viola	3896	3960			
Dolomite	3960	4026			
Sand-1st Wilcox	4026	4078			
Dolomite	4078	4098			
Lime	4098	4126			
Sand-2nd Wilcox	4126	4250			
Total Depth	4250				

RECEIVED
NOV 20 1973
OKLAHOMA CORPORATION
COMMISSION

I the undersigned being first duly sworn upon oath state that this well record is true correct and complete according to the records of this office and to the best of my knowledge and belief

Subscribed and sworn to before me this 19th day of November 1970
My Commission expires June 4, 1972
Notary Public

KEENER OIL & GAS COMPANY

1648 SOUTH BOSTON, SUITE 200
TULSA, OKLAHOMA 74119-4434

JAMIE TAYLOR BOYD
LAND MANAGER

(918) 587-4154
FAX: (918) 587-4981
E-Mail: jamie@keeneroil.com

February 28, 2020

RECEIVED

MAR 02 2020

**OKLAHOMA CORPORATION
COMMISSION**

Oklahoma Corporation Commission
ATTN: Central Processing
P.O. Box 52000
Oklahoma City, OK 73152-2000

Re: Amended 1002A—Recompletion

To Whom It May Concern:

Enclosed please find an original and one copy of an Amended Form 1002A regarding the recompletion of the following vertical well:

Goforth #17
N/2 NW/4 SW/4 NE/4 of 15-T8N-R6E
Seminole County, Oklahoma

Please do not hesitate to contact me if you require anything additional from Keener Oil & Gas Company.

With my regards,

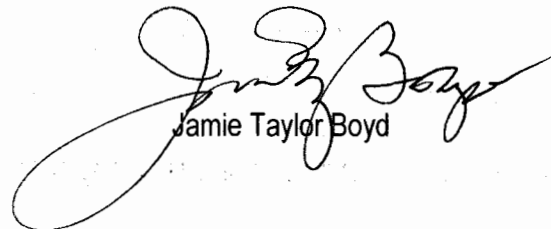

Jamie Taylor Boyd

Enclosures

Oklahoma Corporation Commission
Oil & Gas Conservation Division
Post Office Box 52000
Oklahoma City, Oklahoma 73152-2000
Rule 165: 10-3-25

Form 1002A

API No.: 35133204630001

Completion Report

Spud Date: October 19, 1970

OTC Prod. Unit No.: 133-043290-0-0000

Drilling Finished Date: October 31, 1970

1st Prod Date: November 18, 1970

Amended

Completion Date: November 17, 1970

Amend Reason: RECOMPLETION

Recomplete Date: January 20, 2020

Drill Type: STRAIGHT HOLE

Well Name: GOFORTH 17

Purchaser/Measurer:

Location: SEMINOLE 15 8N 6E
N2 NW SW NE
1065 FSL 330 FWL of 1/4 SEC
Derrick Elevation: 925 Ground Elevation: 918

First Sales Date:

Operator: KEENER OIL & GAS COMPANY 19336

1648 S BOSTON AVE STE 200
TULSA, OK 74119-4416

Completion Type		Location Exception		Increased Density	
X	Single Zone	Order No		Order No	
	Multiple Zone	There are no Location Exception records to display.		There are no Increased Density records to display.	
	Commingled				

Casing and Cement							
Type	Size	Weight	Grade	Feet	PSI	SAX	Top of CMT
SURFACE	10.75	32	J-55	90		80	SURFACE
PRODUCTION	7	24	J-55	4224		150	3200

Liner								
Type	Size	Weight	Grade	Length	PSI	SAX	Top Depth	Bottom Depth
There are no Liner records to display.								

Total Depth: 4250

Packer		Plug	
Depth	Brand & Type	Depth	Plug Type
3291	ARROW 1X	4004	7" CIBP

Initial Test Data										
Test Date	Formation	Oil BBL/Day	Oil-Gravity (API)	Gas MCF/Day	Gas-Oil Ratio Cu FT/BBL	Water BBL/Day	Pumpin or Flowing	Initial Shut-In Pressure	Choke Size	Flow Tubing Pressure
Feb 04, 2020	VIOLA	3	35			1	PUMPING			

Completion and Test Data by Producing Formation

Formation Name: MARSHALL

Code: 202MRS

Class: DRY

Spacing Orders

Order No	Unit Size
N/A	

Perforated Intervals

From	To
4050	4062

Acid Volumes

N/A

Fracture Treatments

N/A

Formation Name: VIOLA

Code: 202VIOL

Class: OIL

Spacing Orders

Order No	Unit Size
N/A	

Perforated Intervals

From	To
3908	3916

Acid Volumes

500 GALLONS 15%, 1,500 GALLONS 15%

Fracture Treatments

N/A

Formation	Top
MARSHALL	4050
VIOLA	3908

Were open hole logs run? No

Date last log run:

Were unusual drilling circumstances encountered? No

Explanation:

Other Remarks

OCC - ORIGINAL 1002A SAYS D-V TOOL SET AT 907', USED 225 SACKS OF CEMENT.

FOR COMMISSION USE ONLY

1144785

Status: Accepted