

Oklahoma Corporation Commission
Oil & Gas Conservation Division
Post Office Box 52000
Oklahoma City, Oklahoma 73152-2000
Rule 165: 10-3-25

Form 1002A

API No.: 35071249020000

Completion Report

Spud Date: January 06, 2019

OTC Prod. Unit No.: 071-225197-0-0000

Drilling Finished Date: January 12, 2019

1st Prod Date: September 30, 2019

Completion Date: September 10, 2019

Drill Type: STRAIGHT HOLE

Well Name: MAYER 1-21

Purchaser/Measurer:

Location: KAY 21 27N 1E
SE SW NE NE
1040 FNL 800 FEL of 1/4 SEC
Derrick Elevation: 1096 Ground Elevation: 1084

First Sales Date:

Operator: APOGEE OIL & GAS LLC 24277

1802 CANYON PARK CIR STE A
EDMOND, OK 73013-6565

Completion Type		Location Exception		Increased Density	
X	Single Zone	Order No		Order No	
	Multiple Zone	There are no Location Exception records to display.		There are no Increased Density records to display.	
	Commingled				

Casing and Cement								
Type		Size	Weight	Grade	Feet	PSI	SAX	Top of CMT
SURFACE		8 5/8	24	J-55	308	100	200	SURFACE
PRODUCTION		5 1/2	15.50	J-55	4073	400	130	3230

Liner								
Type	Size	Weight	Grade	Length	PSI	SAX	Top Depth	Bottom Depth
There are no Liner records to display.								

Total Depth: 4067

Packer		Plug	
Depth	Brand & Type	Depth	Plug Type
There are no Packer records to display.		There are no Plug records to display.	

Initial Test Data										
Test Date	Formation	Oil BBL/Day	Oil-Gravity (API)	Gas MCF/Day	Gas-Oil Ratio Cu FT/BBL	Water BBL/Day	Pumpin or Flowing	Initial Shut-In Pressure	Choke Size	Flow Tubing Pressure
Sep 10, 2019	WILCOX	28				850	PUMPING	485		

Completion and Test Data by Producing Formation			
Formation Name: WILCOX		Code: 202WLCX	Class: OIL
Spacing Orders		Perforated Intervals	
Order No	Unit Size	From	To
689823	40	3842	4002
Acid Volumes		Fracture Treatments	
4,000 GALLONS 7.5%		NONE	

Formation	Top
BIG LIME	3310
RED FORK	3590
MISSISSIPPI CHAT	3680
WOODFORD	3805
WILCOX	3815

Were open hole logs run? Yes
Date last log run: January 12, 2019

Were unusual drilling circumstances encountered? No
Explanation:

Other Remarks
There are no Other Remarks.

FOR COMMISSION USE ONLY	
Status: Accepted	1144787

RECEIVED

FEB 18 2020

Form 1002A
Rev. 2009

API NO. **071-24902**
OTC PROD. UNIT NO. **071-225197**

(PLEASE TYPE OR USE BLACK INK ONLY)

OKLAHOMA CORPORATION COMMISSION
Oil & Gas Conservation Division
Post Office Box 52000
Oklahoma City, Oklahoma 73152-2000
Rule 165-10-3-25
COMPLETION REPORT

OKLAHOMA CORPORATION
COMMISSION

☒ ORIGINAL
☐ AMENDED (Reason) _____

TYPE OF DRILLING OPERATION

☒ STRAIGHT HOLE ☐ DIRECTIONAL HOLE ☐ HORIZONTAL HOLE
☐ SERVICE WELL

If directional or horizontal, see reverse for bottom hole location.

COUNTY **Ray** SEC **21** TWP **21N** RGE **1E**

LEASE NAME **Mayer** WELL NO. **1-21**

SE 1/4 SW 1/4 NE 1/4 NE 1/4 FBL OF 1/4 SEC **1040** FBL OF 1/4 SEC **800**

ELEVATION Derrick Ft. **1096** Ground **1084** Latitude (if known)

OPERATOR NAME **A Pogue Oil & Gas LLC** OTC / OCC OPERATOR NO. **24277**

ADDRESS **1802 Canyon Park Circle Suite A**

CITY **Edmond** STATE **OK** ZIP **73012-6545**

SPUD DATE **1-6-19**

DRUG FINISHED DATE **1-12-19**

DATE OF WELL COMPLETION **9-10-19**

1st PROD DATE **9-30-19**

RECOMP DATE

Longitude (if known)

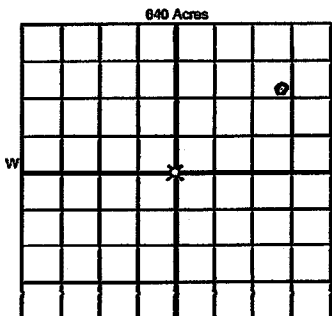

COMPLETION TYPE

☒ SINGLE ZONE
☐ MULTIPLE ZONE
Application Date
COMINGLED
Application Date
LOCATION EXCEPTION
ORDER NO. **693463**
INCREASED DENSITY
ORDER NO.

CASING & CEMENT (Attach Form 1002C)

TYPE	SIZE	WEIGHT	GRADE	FEET	PSI	SAX	TOP OF CMT
CONDUCTOR							
SURFACE	8 5/8	24	J-55	308'	100#	200	Surface
INTERMEDIATE							
PRODUCTION	5 1/2	18.50	J-55	4073'	400#	130	3230
LINER							

PACKER @ _____ BRAND & TYPE _____

PLUG @ _____ TYPE _____

PLUG @ _____ TYPE _____

TOTAL DEPTH **4067**

PACKER @ _____ BRAND & TYPE _____

PLUG @ _____ TYPE _____

PLUG @ _____ TYPE _____

COMPLETION & TEST DATA BY PRODUCING FORMATION

202 WLCX

FORMATION	Wilcox						No Frac
SPACING & SPACING	609823 (40)						
ORDER NUMBER							
CLASS: Oil, Gas, Dry, Int.	Oil						
Disp, Comm Disp, Svc							
	3842-4002						
PERFORATED INTERVALS							
ACID/VOLUME	4000 gal 7.5%						
FRACTURE TREATMENT (Fluids/Prop Amounts)	NONE						

Min Gas Allowable

(165-10-17-7)

Gas Purchaser/Measurer



OR

First Sales Date

Oil Allowable

(165-10-13-3)

INITIAL TEST DATA

INITIAL TEST DATE	9-10-19					
OIL-BBL/DAY	22					
OIL-GRAVITY (API)						
GAS-MCF/DAY	TSTM					
GAS-OIL RATIO CU FT/BBL						
WATER-BBL/DAY	850 BBLs					
PUMPING OR FLOWING	Pumping					
INITIAL SHUT-IN PRESSURE	485#					
CHOKE SIZE	N/A					
FLOW TUBING PRESSURE	N/A					

A record of the formations drilled through, and pertinent remarks are presented on the reverse. I declare that I have knowledge of the contents of this report and am authorized by my organization to make this report, which was prepared by me or under my supervision and direction, with the data and facts stated herein to be true, correct, and complete to the best of my knowledge and belief.

Douglas R Johnson **Douglas R Johnson** **2-3-2020**
SIGNATURE NAME (PRINT OR TYPE) DATE PHONE NUMBER

PLEASE TYPE OR USE BLACK INK ONLY

FORMATION RECORD

Give formation names and tops, if available, or descriptions and thickness of formations drilled through. Show intervals cored or drillstem tested.

NAMES OF FORMATIONS	TOP
Big Lene	3310
Red Fork	3590
MISSISSIPPI	
MISSISSIPPI: Chat	3650'
woodford	3805'
Wilcox	3815'

LEASE NAME Mayer WELL NO. 1-21

FOR COMMISSION USE ONLY	
ITD on file	<input type="checkbox"/> YES <input type="checkbox"/> NO
APPROVED	DISAPPROVED
2) Reject Codes	

Were open hole logs run?	<u>X</u> yes <u>no</u>
Date last log was run	<u>1-12-19</u>
Was CO ₂ encountered?	<u>no</u> yes <u>X</u> no at what depths? <u> </u>
Was H ₂ S encountered?	<u>no</u> yes <u>X</u> no at what depths? <u> </u>
Were unusual drilling circumstances encountered?	<u>no</u> yes <u>X</u>
If yes, briefly explain below	

Other remarks:

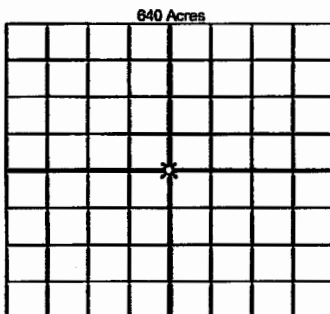

If more than three drainholes are proposed, attach a separate sheet indicating the necessary information.

Direction must be stated in degrees azimuth. Please note, the horizontal drainhole and its end point must be located within the boundaries of the lease or spacing unit.

Directional surveys are required for all drainholes and directional wells.

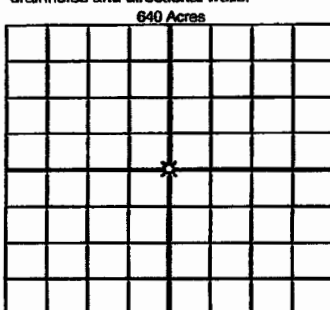

BOTTOM HOLE LOCATION FOR DIRECTIONAL HOLE

SEC	TWP	RGE	COUNTY
Spot Location		Feet From 1/4 Sec Lines	
1/4	1/4	1/4	1/4
Measured Total Depth		True Vertical Depth	BHL From Lease, Unit, or Property Line:

BOTTOM HOLE LOCATION FOR HORIZONTAL HOLE: (LATERALS)

LATERAL #1			
SEC	TWP	RGE	COUNTY
Spot Location		Feet From 1/4 Sec Lines	
1/4	1/4	1/4	1/4
Depth of Deviation	Radius of Turn	Direction	Total Length
Measured Total Depth	True Vertical Depth	BHL From Lease, Unit, or Property Line:	

LATERAL #2			
SEC	TWP	RGE	COUNTY
Spot Location		Feet From 1/4 Sec Lines	
1/4	1/4	1/4	1/4
Depth of Deviation	Radius of Turn	Direction	Total Length
Measured Total Depth	True Vertical Depth	BHL From Lease, Unit, or Property Line:	

LATERAL #3			
SEC	TWP	RGE	COUNTY
Spot Location		Feet From 1/4 Sec Lines	
1/4	1/4	1/4	1/4
Depth of Deviation	Radius of Turn	Direction	Total Length
Measured Total Depth	True Vertical Depth	BHL From Lease, Unit, or Property Line:	