

Oklahoma Corporation Commission
Oil & Gas Conservation Division
Post Office Box 52000
Oklahoma City, Oklahoma 73152-2000
Rule 165: 10-3-25

Form 1002A

API No.: 35019263430000

Completion Report

Spud Date: November 07, 2019

OTC Prod. Unit No.: 019-012538-0-5383

Drilling Finished Date: November 21, 2019

1st Prod Date: January 30, 2020

Completion Date: January 29, 2020

Drill Type: STRAIGHT HOLE

Min Gas Allowable: Yes

Well Name: SW WILDCAT JIM DEESE UNIT SWDU 15-3-I

Purchaser/Measuror: TARGA PIPELINE MID
CONTINENT

First Sales Date: N/A

Location: CARTER 7 2S 2W
NW NE SE NW
1447 FNL 2246 FWL of 1/4 SEC
Latitude: 34.40111 Longitude: -97.449626
Derrick Elevation: 1036 Ground Elevation: 1011

Operator: MACK ENERGY CO 11739
PO BOX 400
1202 N 10TH ST
DUNCAN, OK 73534-0400

Completion Type		Location Exception		Increased Density	
X	Single Zone	Order No		Order No	
	Multiple Zone	There are no Location Exception records to display.		There are no Increased Density records to display.	
	Commingled				

Casing and Cement								
Type		Size	Weight	Grade	Feet	PSI	SAX	Top of CMT
SURFACE		9 5/8	40	J-55	1301		425	SURFACE
PRODUCTION		7	26	J-55	4228		575	2920

Liner								
Type	Size	Weight	Grade	Length	PSI	SAX	Top Depth	Bottom Depth
There are no Liner records to display.								

Total Depth: 4250

Packer		Plug	
Depth	Brand & Type	Depth	Plug Type
There are no Packer records to display.		There are no Plug records to display.	

Initial Test Data

Test Date	Formation	Oil BBL/Day	Oil-Gravity (API)	Gas MCF/Day	Gas-Oil Ratio Cu FT/BBL	Water BBL/Day	Pumpin or Flowing	Initial Shut-In Pressure	Choke Size	Flow Tubing Pressure
Feb 08, 2020	DEESE	18	22	149	8278	170	PUMPING	20	2	

Completion and Test Data by Producing Formation

Formation Name: DEESE

Code: 404DEESS

Class: OIL

Spacing Orders

Order No	Unit Size
701901	UNIT

Perforated Intervals

From	To
3800	3867

Acid Volumes

1,500 GALLONS 7.5% NEFE

Fracture Treatments

1,528 BARRELS, 75,000 POUNDS 16/30 SAND

Formation Name: DEESE

Code: 404DEESS

Class: OIL

Spacing Orders

Order No	Unit Size
701901	UNIT

Perforated Intervals

From	To
3560	3572

Acid Volumes

252 GALLONS 7.5% AZ

Fracture Treatments

266 BARRELS, 16,000 POUNDS 16/30 SAND

Formation Name: DEESE

Code: 404DEESS

Class: OIL

Spacing Orders

Order No	Unit Size
701901	UNIT

Perforated Intervals

From	To
3120	3200

Acid Volumes

350 GALLONS 7.5% NEFE HCL

Fracture Treatments

860 BARRELS, 27,500 POUNDS 16/30 SAND

Formation	Top
DEESE	2750

Were open hole logs run? Yes

Date last log run: November 20, 2019

Were unusual drilling circumstances encountered? No

Explanation:

Other Remarks

There are no Other Remarks.

Status: Accepted

API NO. 019-26343
OTC PROD. 019-012538
UNIT NO. -0-5383

(PLEASE TYPE OR USE BLACK INK ONLY)

OKLAHOMA CORPORATION COMMISSION
Oil & Gas Conservation Division
Post Office Box 52000
Oklahoma City, Oklahoma 73152-2000
Rule 165:10-3-25

RECEIVED

Form 1002A
Rev. 2009

FEB 18 2020

☒ ORIGINAL
☐ AMENDED (Reason) _____

COMPLETION REPORT

TYPE OF DRILLING OPERATION

☒ STRAIGHT HOLE ☐ DIRECTIONAL HOLE ☐ HORIZONTAL HOLE
☐ SERVICE WELL

If directional or horizontal, see reverse for bottom hole location.

COUNTY	Carter	SEC	7	TWP	2S	RGE	2W	SPUD DATE	11-7-2019
LEASE NAME	SW Wilcox SW WJDU Jim Deese Unit ENL 1447 NO SW WJDU 15-3-i							DRLG FINISHED DATE	11-21-19
NW 1/4 NE 1/4 SE 1/4 NW 1/4	FSL OF 1/4 SEC 3899 FWL OF 1/4 SEC 2246'							DATE OF WELL COMPLETION	1-29-20
ELEVATION Derrick FL	1036'	Ground	1011'	Latitude (if known)	34.40111			1st PROD DATE	1-30-20
OPERATOR NAME	Mack Energy Co.							RECOMP DATE	
ADDRESS	P.O. Box 400							OTC / OCC OPERATOR NO.	11739
CITY	Duncan	STATE	OK	ZIP	73533				

OKLAHOMA CORPORATION COMMISSION

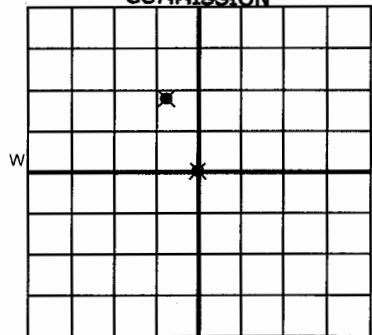

COMPLETION TYPE

<input checked="" type="checkbox"/> SINGLE ZONE	
<input type="checkbox"/> MULTIPLE ZONE	
<input type="checkbox"/> COMMINGLED	
<input type="checkbox"/> LOCATION EXCEPTION	
<input type="checkbox"/> ORDER NO.	
<input type="checkbox"/> INCREASED DENSITY	
<input type="checkbox"/> ORDER NO.	

CASING & CEMENT (Attach Form 1002C)

TYPE	SIZE	WEIGHT	GRADE	FEET	PSI	SAX	TOP OF CMT
CONDUCTOR							
SURFACE	9 5/8"	40#	J-55	1301'		425	Surface
INTERMEDIATE							
PRODUCTION	7"	26#	J-55	4228'		575	2920'
LINER							
						TOTAL DEPTH	4250'

PACKER @ _____ BRAND & TYPE _____ PLUG @ _____ TYPE _____ PLUG @ _____ TYPE _____
PACKER @ _____ BRAND & TYPE _____ PLUG @ _____ TYPE _____ PLUG @ _____ TYPE _____

COMPLETION & TEST DATA BY PRODUCING FORMATION

FORMATION	(Morris) Deese	(Carpenter) Deese	(Tussy) Deese	
SPACING & SPACING	40 acres	40 acres	40 acres	
ORDER NUMBER	701901 (unit)	701901 (unit)	701901 (unit)	
CLASS: Oil, Gas, Dry, Inj, Disp, Comm Disp, Svc	Oil	Oil	Oil	
PERFORATED INTERVALS	3800-3826'	3560-3572'	3120-50'	
	3856-3832'		3197-3200'	
	3860-3867'			
ACID/VOLUME	1500 gals 7.5% NeFe	252 gals 7.5% az	350 gals 7.5% NeFe HCl	
FRACTURE TREATMENT (Fluids/Prop Amounts)	1528 bbls	266 bbls	860 bbls	
	75000# 16/30 sd	16000# 16/30 sd	27500# 16/30 sd	

☒ Min Gas Allowable (165:10-17-7)
OR
Oil Allowable (165:10-13-3)

Gas Purchaser/Measurer
First Sales Date

Targa Pipeline Mid Cont.
N/A

INITIAL TEST DATA

INITIAL TEST DATE	2/8/2020				
OIL-BBL/DAY	18				
OIL-GRAVITY (API)	22				
GAS-MCF/DAY	149				
GAS-OIL RATIO CU FT/BBL	8278				
WATER-BBL/DAY	170				
PUMPING OR FLOWING	Pumping				
INITIAL SHUT-IN PRESSURE	20 psi				
CHOKE SIZE	2"				
FLOW TUBING PRESSURE	N/A				

A record of the formations drilled through, and pertinent remarks are presented on the reverse. I declare that I have knowledge of the contents of this report and am authorized by my organization to make this report, which was prepared by me or under my supervision and direction, with the data and facts stated herein to be true, correct, and complete to the best of my knowledge and belief.

SIGNATURE	Dinah Mayes, Engineering Tech.	DATE	2/12/2020	PHONE NUMBER	580-856-3705
ADDRESS	3730 Samedan Road	CITY	Ratliff City	STATE	OK
			ZIP		73481
				EMAIL ADDRESS	dmayes@mackenergy.com

X 213

PLEASE TYPE OR USE BLACK INK ONLY

FORMATION RECORD

Give formation names and tops, if available, or descriptions and thickness of formations drilled through. Show intervals cored or drillstem tested.

LEASE NAME SW WJDU

WELL NO. 15-3-i

NAMES OF FORMATIONS	TOP
Deese	2750'

FOR COMMISSION USE ONLY	
ITD on file <input type="checkbox"/> YES <input type="checkbox"/> NO	
APPROVED _____	DISAPPROVED _____
2) Reject Codes	

Were open hole logs run?	<input checked="" type="checkbox"/> yes <input type="checkbox"/> no
Date Last log was run	<u>11/20/2019</u>
Was CO ₂ encountered?	<input type="checkbox"/> yes <input checked="" type="checkbox"/> no at what depths? _____
Was H ₂ S encountered?	<input type="checkbox"/> yes <input checked="" type="checkbox"/> no at what depths? _____
Were unusual drilling circumstances encountered?	<input type="checkbox"/> yes <input checked="" type="checkbox"/> no
If yes, briefly explain below	

Other remarks:

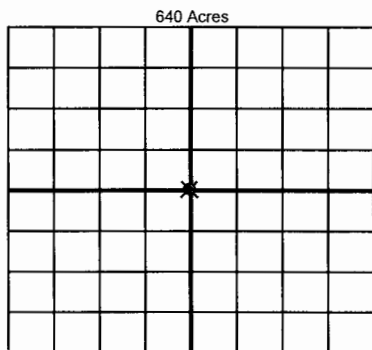

If more than three drainholes are proposed, attach a separate sheet indicating the necessary information.

Direction must be stated in degrees azimuth. Please note, the horizontal drainhole and its end point must be located within the boundaries of the lease or spacing unit.

Directional surveys are required for all drainholes and directional wells.

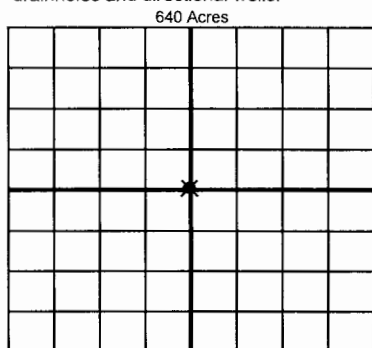

BOTTOM HOLE LOCATION FOR DIRECTIONAL HOLE

SEC	TWP	RGE	COUNTY
Spot Location			
1/4	1/4	1/4	1/4
Measured Total Depth		True Vertical Depth	Feet From 1/4 Sec Lines FSL FWL BHL From Lease, Unit, or Property Line:

BOTTOM HOLE LOCATION FOR HORIZONTAL HOLE: (LATERALS)

LATERAL #1			
SEC	TWP	RGE	COUNTY
Spot Location			
1/4	1/4	1/4	1/4
Depth of Deviation		Radius of Turn	Direction
Measured Total Depth		True Vertical Depth	Total Length
BHL From Lease, Unit, or Property Line:			

LATERAL #2			
SEC	TWP	RGE	COUNTY
Spot Location			
1/4	1/4	1/4	1/4
Depth of Deviation		Radius of Turn	Direction
Measured Total Depth		True Vertical Depth	Total Length
BHL From Lease, Unit, or Property Line:			

LATERAL #3			
SEC	TWP	RGE	COUNTY
Spot Location			
1/4	1/4	1/4	1/4
Depth of Deviation		Radius of Turn	Direction
Measured Total Depth		True Vertical Depth	Total Length
BHL From Lease, Unit, or Property Line:			