

Oklahoma Corporation Commission
Oil & Gas Conservation Division
Post Office Box 52000
Oklahoma City, Oklahoma 73152-2000
Rule 165: 10-3-25

Form 1002A

API No.: 35037293860001

Completion Report

Spud Date: December 04, 2017

OTC Prod. Unit No.: 037-007278-0-0000

Drilling Finished Date: December 11, 2017

1st Prod Date: February 01, 2018

Completion Date: January 31, 2018

Drill Type: STRAIGHT HOLE

Well Name: RUTH DAVIS 5

Purchaser/Measurer: NONE

Location: CREEK 2 17N 7E
C SW NE SW
1650 FSL 1650 FWL of 1/4 SEC
Derrick Elevation: 917 Ground Elevation: 908

First Sales Date:

Operator: BAUGH ALLAN L 14665

12589 S 486TH WEST AVE
DRUMRIGHT, OK 74030-5914

Completion Type		Location Exception		Increased Density	
X	Single Zone	Order No		Order No	
	Multiple Zone	There are no Location Exception records to display.		There are no Increased Density records to display.	
	Commingled				

Casing and Cement							
Type	Size	Weight	Grade	Feet	PSI	SAX	Top of CMT
SURFACE	8 5/8	24	J-55	859		425	SURFACE
PRODUCTION	5 1/2	17	J-55	3000		100	2402

Liner								
Type	Size	Weight	Grade	Length	PSI	SAX	Top Depth	Bottom Depth
There are no Liner records to display.								

Total Depth: 3000

Packer	
Depth	Brand & Type
There are no Packer records to display.	

Plug	
Depth	Plug Type
2710	CIBP
2956	CIBP

Initial Test Data

Test Date	Formation	Oil BBL/Day	Oil-Gravity (API)	Gas MCF/Day	Gas-Oil Ratio Cu FT/BBL	Water BBL/Day	Pumpin or Flowing	Initial Shut-In Pressure	Choke Size	Flow Tubing Pressure
Jan 24, 2018	ARBUCKLE					30				
Jan 26, 2018	WILCOX					30				
Feb 01, 2018	BARTLESVILLE	5				30	PUMPING			

Completion and Test Data by Producing Formation

Formation Name: ARBUCKLE

Code: 169ABCK

Class: DRY

Spacing Orders

Order No	Unit Size
NONE	

Perforated Intervals

From	To
2960	2960

Acid Volumes

NONE

Fracture Treatments

NONE

Formation Name: WILCOX

Code: 202WLCX

Class: DRY

Spacing Orders

Order No	Unit Size
NONE	

Perforated Intervals

From	To
2718	2728

Acid Volumes

400 GALLONS

Fracture Treatments

NONE

Formation Name: BARTLESVILLE

Code: 404BRVL

Class: OIL

Spacing Orders

Order No	Unit Size
NONE	

Perforated Intervals

From	To
2562	2568

Acid Volumes

300 GALLONS

Fracture Treatments

NONE

Formation	Top
HOGSHOOTER LIME	1332
UPPER LAYTON SAND	1369
LOWER LAYTON SAND	1432
BIG LIME	2138
OSWEGO LIME	2154
VERDIGRIS LIME	2292
PINK LIME	2458
BARTLESVILLE SAND	2558
WILCOX SAND	2719

Were open hole logs run? Yes

Date last log run: December 11, 2017

Were unusual drilling circumstances encountered? No

Explanation:

ARBUCKLE LIME	2776
---------------	------

Other Remarks
There are no Other Remarks.

FOR COMMISSION USE ONLY	
Status: Accepted	1145429

API NO. **037-29386**
OTC PROD. UNIT NO. **037-07278**

(PLEASE TYPE OR USE BLACK INK ONLY)

OKLAHOMA CORPORATION COMMISSION
Oil & Gas Conservation Division
Post Office Box 52000
Oklahoma City, Oklahoma 73152-2000
Rule 165:10-3-25

037-007278-0-0000
☒ ORIGINAL
☐ AMENDED (Reason) _____

COMPLETION REPORT

TYPE OF DRILLING OPERATION
☒ STRAIGHT HOLE ☐ DIRECTIONAL HOLE ☐ HORIZONTAL HOLE
☐ SERVICE WELL
If directional or horizontal, see reverse for bottom hole location.

SPUD DATE **12-4-2017**

DRLG FINISHED DATE **12-11-2017**

DATE OF WELL COMPLETION **1-31-2018**

1st PROD DATE **2-1-2018**

RECOMP DATE

COUNTY **CREEK** SEC **2** TWP **17N** RGE **7E**
LEASE NAME **RUTH DAVIS** WELL NO. **5**

C **1/4 SW 1/4 NE 1/4 SW 1/4** FSL OF 1/4 SEC **1650** FWL OF 1/4 SEC **1650**

ELEVATION Derrick FL **917'** Ground **908'** Latitude (if known)

Longitude (if known)

OPERATOR NAME **ALLAN L. BAUGH**

OTC / OCC OPERATOR NO. **14665**

ADDRESS **12589 S. 486th West Ave.**

CITY **DAWRIGHT**

STATE **OK**

ZIP **74030**

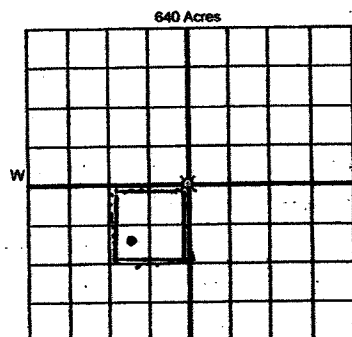

COMPLETION TYPE

<input checked="" type="checkbox"/> SINGLE ZONE	
<input type="checkbox"/> MULTIPLE ZONE	
Application Date	
<input type="checkbox"/> COMINGLED	
Application Date	
LOCATION EXCEPTION ORDER NO.	
INCREASED DENSITY ORDER NO.	

CASING & CEMENT (Attach Form 1002C)

TYPE	SIZE	WEIGHT	GRADE	FEET	PSI	SAX	TOP OF CMT
CONDUCTOR							
SURFACE	8-5/8"	24#	J-55	859'		425	Surface
INTERMEDIATE							
PRODUCTION	5-1/2"	17#	J-55	3000'		100	2921'
LINER							
							3000'

PACKER @ BRAND & TYPE

PLUG @ **2956'** TYPE **CIBP** PLUG @ TYPE

TOTAL DEPTH **3000'**

PACKER @ BRAND & TYPE

PLUG @ **2710'** TYPE **CIBP** PLUG @ TYPE

COMPLETION & TEST DATA BY PRODUCTION FORMATION

FORMATION	ARBUCKLE	WILCOX	BARTLESVILLE	No Frac
SPACING & SPACING ORDER NUMBER	none	none	none	
CLASS: Oil, Gas, Dry, Inj. Disp, Comm Disp, Svc	DRY	DRY	OIL	
PERFORATED INTERVALS	2960'	2718-2720'	2562-2568'	
		2722-2728'		
ACID/VOLUME	NONE	400G.	300G.	
FRACTURE TREATMENT (Fluids/Prop Amounts)	NONE	NONE	NONE	

RECEIVED

JUL 16 2020

Oklahoma Corporation Commission

Min Gas Allowable

(165:10-17-7)

Gas Purchaser/Measurer

NONE

OR

First Sales Date

INITIAL TEST DATA

Oil Allowable

(165:10-13-3)

INITIAL TEST DATE	JAN. 24, 2018	JAN. 26, 2018	FEB. 1, 2018
OIL-BBL/DAY	NONE	NONE	5 BOPD
OIL-GRAVITY (API)			
GAS-MCF/DAY	NONE	SHOW	SHOW
GAS-OIL RATIO CU FT/BBL			
WATER-BBL/DAY	30 BWPH	30 BWPH	30 BWPH
PUMPING OR FLOWING			Pumping
INITIAL SHUT-IN PRESSURE			
CHOKE SIZE			
FLOW TUBING PRESSURE			

A record of the formations drilled through, and pertinent remarks are presented on the reverse. I declare that I have knowledge of the contents of this report and am authorized by my organization to make this report, which was prepared by me or under my supervision and direction, with the data and facts stated herein to be true, correct, and complete to the best of my knowledge and belief.

SIGNATURE **ALLAN L. BAUGH**

NAME (PRINT OR TYPE) **ALLAN L. BAUGH**

DATE **7-10-20**

PHONE NUMBER **918-625-1712**

ADDRESS **12589 S. 486th West Ave. Dawright**

CRY STATE ZIP **OK 74030**

EMAIL ADDRESS **ritabaugh@yahoo.com**

Per Allan Baugh

PLEASE TYPE OR USE BLACK INK ONLY

FORMATION RECORD

Give formation names and tops, if available, or descriptions and thickness of formations drilled through. Show intervals cored or drillstem tested.

LEASE NAME

RUTH DAVIS

WELL NO. 5

NAMES OF FORMATIONS	TOP
HOG SHOOTER LIME	1332
UPPER LAYTON SAND	1369
LOWER LAYTON SAND	1432
BIG LIME	2138
OSWEGO LIME	2154
VERDIGRIS LIME	2292
PINK LIME	2458'
BARTLESVILLE SAND	2558'
WILCOX SAND	2719'
ARBuckle LIME	2776'
TD	3000'

FOR COMMISSION USE ONLY	
ITD on file <input type="checkbox"/> YES <input type="checkbox"/> NO	
APPROVED	DISAPPROVED
2) Reject Codes	

Were open hole logs run?	<input checked="" type="checkbox"/> yes <input type="checkbox"/> no
Date Last log was run	DEC. 11, 2017
Was CO ₂ encountered?	<input type="checkbox"/> yes <input checked="" type="checkbox"/> no at what depths?
Was H ₂ S encountered?	<input type="checkbox"/> yes <input checked="" type="checkbox"/> no at what depths?
Were unusual drilling circumstances encountered?	<input type="checkbox"/> yes <input checked="" type="checkbox"/> no
If yes, briefly explain below	

Other remarks:

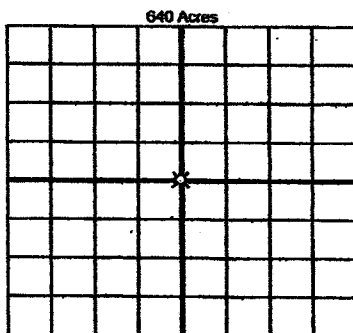

If more than three drainholes are proposed, attach a separate sheet indicating the necessary information.

Direction must be stated in degrees azimuth. Please note, the horizontal drainhole and its end point must be located within the boundaries of the lease or spacing unit.

Directional surveys are required for all drainholes and directional wells.

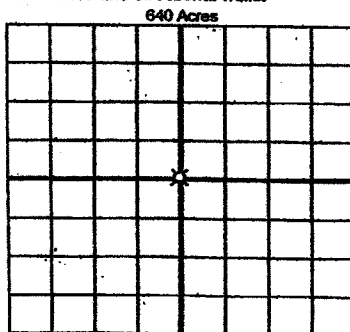

BOTTOM HOLE LOCATION FOR DIRECTIONAL HOLE

SEC	TWP	RGE	COUNTY
Spot Location			
1/4	1/4	1/4	1/4
Measured Total Depth		True Vertical Depth	BHL From Lease, Unit, or Property Line:

BOTTOM HOLE LOCATION FOR HORIZONTAL HOLE: (LATERALS)

LATERAL #1			
SEC	TWP	RGE	COUNTY
Spot Location			
1/4	1/4	1/4	1/4
Depth of Deviation		Radius of Turn	Direction
Measured Total Depth		True Vertical Depth	BHL From Lease, Unit, or Property Line:

LATERAL #2			
SEC	TWP	RGE	COUNTY
Spot Location			
1/4	1/4	1/4	1/4
Depth of Deviation		Radius of Turn	Direction
Measured Total Depth		True Vertical Depth	BHL From Lease, Unit, or Property Line:

LATERAL #3			
SEC	TWP	RGE	COUNTY
Spot Location			
1/4	1/4	1/4	1/4
Depth of Deviation		Radius of Turn	Direction
Measured Total Depth		True Vertical Depth	BHL From Lease, Unit, or Property Line: