

Oklahoma Corporation Commission
Oil & Gas Conservation Division
Post Office Box 52000
Oklahoma City, Oklahoma 73152-2000
Rule 165: 10-3-25

Form 1002A

API No.: 35117236900000

Completion Report

Spud Date: August 24, 2017

OTC Prod. Unit No.: 117-009863

Drilling Finished Date: August 29, 2017

1st Prod Date:

Completion Date: September 12, 2017

Recomplete Date: August 22, 2019

Drill Type: STRAIGHT HOLE

SERVICE WELL

Well Name: J L MILLER 34

Purchaser/Measurer:

Location: PAWNEE 19 21N 8E
NW SW NW NE
665 FNL 165 FWL of 1/4 SEC
Latitude: 36.28773 Longitude: -96.48708
Derrick Elevation: 0 Ground Elevation: 930

First Sales Date:

Operator: MID-CON ENERGY OPERATING LLC 23271

2431 E 61ST ST STE 850
TULSA, OK 74136-1236

Completion Type		Location Exception		Increased Density	
X	Single Zone	Order No		Order No	
	Multiple Zone	There are no Location Exception records to display.		There are no Increased Density records to display.	
	Commingled				

Casing and Cement							
Type	Size	Weight	Grade	Feet	PSI	SAX	Top of CMT
SURFACE	8 5/8	24	J-55	161		100	SURFACE
PRODUCTION	5 1/2	15.5	J-55	2297		370	890

Liner								
Type	Size	Weight	Grade	Length	PSI	SAX	Top Depth	Bottom Depth
There are no Liner records to display.								

Total Depth: 2310

Packer		Plug	
Depth	Brand & Type	Depth	Plug Type
1584	BAKER AD-1	2150	CIBP

Initial Test Data

Test Date	Formation	Oil BBL/Day	Oil-Gravity (API)	Gas MCF/Day	Gas-Oil Ratio Cu FT/BBL	Water BBL/Day	Pumpin or Flowing	Initial Shut- In Pressure	Choke Size	Flow Tubing Pressure
There are no Initial Data records to display.										

Completion and Test Data by Producing Formation									
Formation Name: CLEVELAND				Code: 405CLVD			Class: INJ		
Spacing Orders				Perforated Intervals					
Order No		Unit Size		From			To		
There are no Spacing Order records to display.				1665			1702		
Acid Volumes				Fracture Treatments					
1,500 GALLONS 15% NEFE				There are no Fracture Treatments records to display.					

Formation	Top
LAYTON	1229
CHECKERBOARD	1514
CLEVELAND	1594
BIG LIME	1824
OSWEGO	1874
LOWER SKINNER	2029
PINK LIME	2084
BARTLESVILLE	2164

Were open hole logs run? Yes

Date last log run:

Were unusual drilling circumstances encountered? No

Explanation:

Other Remarks
REFERENCE INJECTION PERMIT NUMBER 1800230038. SQUEEZED THE CLEVELAND PERFORATIONS @ 1,620' - 1,650' WITH 175 SACKS CLASS "A" CEMENT OCC - PER OPERATOR CHANGE WELL NAME TO J L MILLER 34.

FOR COMMISSION USE ONLY
<div> <div>Status: Accepted</div> <div>1147503</div> </div>

RECEIVED

Form 1002A

JAN 28 2022

API NO. 35-117-23690
 OTC PROD. UNIT NO. 117-009863

Oil and Gas Conservation Division
 P.O. Box 52000
 Oklahoma City, OK 73152-2000
 405-522-0577
 OCCCentralProcessing@OCC.OK.GOV



OKLAHOMA
 Corporation
 Commission

OKLAHOMA CORPORATION
 COMMISSION



ORIGINAL
 AMENDED (Reason)

Rule 165:10-3-25

COMPLETION REPORT

TYPE OF DRILLING OPERATION

☒ STRAIGHT HOLE ☐ DIRECTIONAL HOLE ☐ HORIZONTAL HOLE
☒ SERVICE WELL

If directional or horizontal, see reverse for bottom hole location.

COUNTY	PAWNEE	SEC	19	TWP	21N	RGE	08E	
LEASE NAME	JL MILLER			WELL NO.	34			
NW 1/4 SW 1/4 NW 1/4 NE 1/4				FNL	665	FWL	165	
ELEVATION	Demick FL	Ground	930	Latitude	36.28773		Longitude	-96.48708
OPERATOR NAME	MIDCON ENERGY OPERATING, LLC				OTC/OCC OPERATOR NO.	23271		
ADDRESS	2431 E 61ST ST, SUITE 850							
CITY	TULSA		STATE	OK	ZIP	74136		

SPUD DATE 08/24/2017

DRLG FINISHED DATE 08/29/2017

DATE OF WELL COMPLETION 09/12/2017

1st PROD DATE INJECTOR

RECOMP DATE 08/22/2019

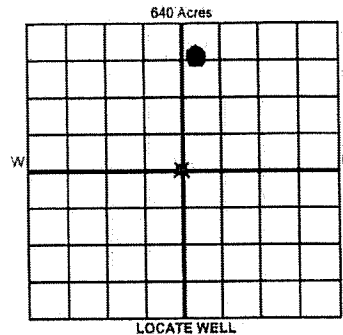

COMPLETION TYPE

<input checked="" type="radio"/> SINGLE ZONE	
<input type="radio"/> MULTIPLE ZONE	
<input type="radio"/> COMMINGLED	
<input type="radio"/> LOCATION EXCEPTION	
<input type="radio"/> ORDER NO.	
<input type="radio"/> MULTIUNIT ORDER NO.	
<input type="radio"/> INCREASED DENSITY	
<input type="radio"/> ORDER NO.	

CASING & CEMENT (Attach Form 1002C)

TYPE	SIZE	WEIGHT	GRADE	FEET	PSI	SAX	TOP OF CMT
CONDUCTOR							
SURFACE	8 5/8	24	J-55	161		100	SURFACE
INTERMEDIATE							
PRODUCTION	5 1/2	15.5	J-55	2297		370	890
LINER							

PACKER @ 1584' BRAND & TYPE BAKER AD-1 PLUG @ 2150' TYPE CIBP PLUG @ TYPE TOTAL DEPTH 2310'

COMPLETION & TEST DATA BY PRODUCING FORMATION

FORMATION	Cleveland					No Frac
SPACING & SPACING ORDER NUMBER						
CLASS: Oil, Gas, Dry, Inj, Disp, Comm Disp, Svc	Inj					
PERFORATED INTERVALS	1665-1702					
	2 SPF					
ACID/VOLUME	1500 Gals 15% NE-FE					
FRACTURE TREATMENT (Fluids/Prop Amounts)						

Min Gas Allowable (165:10-17-7)



OR

Oil Allowable (165:10-13-3)

Purchaser/Measurer

First Sales Date

INITIAL TEST DATA

INITIAL TEST DATE	AN INJECTION				
OIL-BBL/DAY					
OIL-GRAVITY (API)					
GAS-MCF/DAY					
GAS-OIL RATIO CU FT/BBL					
WATER-BBL/DAY					
PUMPING OR FLOWING					
INITIAL SHUT-IN PRESSURE					
CHOKER SIZE					
FLOW TUBING PRESSURE					

A record of the formations drilled through, and pertinent remarks are presented on the reverse. I declare that I have knowledge of the contents of this report and am authorized by my organization to make this report, which was prepared by me or under my supervision and direction, with the data and facts stated herein to be true, correct, and complete to the best of my knowledge and belief.

SIGNATURE: 1717 S BOULDER AVE, SUITE 900 TULSA OK 74119
 ADDRESS CITY STATE ZIP
 MARK POSTULART, ENGINEERING ANALYST
 NAME (PRINT OR TYPE)
 DATE: 01/25/2022 (918) 392-3332
 PHONE NUMBER
 mark.postulart@contango.com
 EMAIL ADDRESS

PLEASE TYPE OR USE BLACK INK ONLY
FORMATION RECORD

Give formation names and tops, if available, or descriptions and thickness of formations drilled through. Show intervals cored or drillstem tested.

NAMES OF FORMATIONS	TOP
Layton	1229
Checkerboard	1514
Cleveland	1594
Big Lime	1824
Oswego	1874
Lower Skinner	2029
Pink Lime	2084
Bartlesville	2164

LEASE NAME _____ WELL NO. _____

FOR COMMISSION USE ONLY	
ITD on file	<input type="checkbox"/> YES <input type="checkbox"/> NO
APPROVED	DISAPPROVED
2) Reject Codes	

Were open hole logs run?	<input checked="" type="radio"/> yes <input type="radio"/> no
Date last log was run	
Was CO ₂ encountered?	<input type="radio"/> yes <input checked="" type="radio"/> no at what depths?
Was H ₂ S encountered?	<input type="radio"/> yes <input checked="" type="radio"/> no at what depths?
Were unusual drilling circumstances encountered?	<input type="radio"/> yes <input checked="" type="radio"/> no
If yes, briefly explain below	

Other remarks: Reference injection permit 1800230038.

Squeezed the Cleveland perforations @ 1620-1650' with 175 sacks class "A" cement.

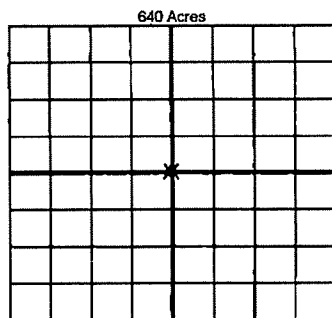

If more than three drainholes are proposed, attach a separate sheet indicating the necessary information.

Direction must be stated in degrees azimuth. Please note, the horizontal drainhole and its end point must be located within the boundaries of the lease or spacing unit.

Directional surveys are required for all drainholes and directional wells

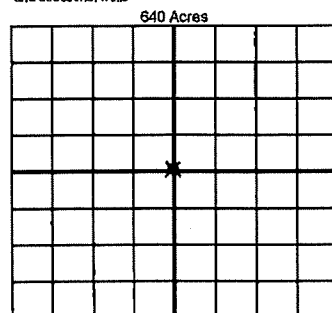

BOTTOM HOLE LOCATION FOR DIRECTIONAL HOLE

SEC	TWP	RGE	COUNTY
1/4	1/4	1/4	1/4
Measured Total Depth		True Vertical Depth	
		BHL From Lease, Unit, or Property Line:	

BOTTOM HOLE LOCATION FOR HORIZONTAL HOLE: (LATERALS)

LATERAL #1			
SEC	TWP	RGE	COUNTY
1/4	1/4	1/4	1/4
Depth of Deviation		Radius of Turn	Direction
Measured Total Depth		True Vertical Depth	Total Length
		BHL From Lease, Unit, or Property Line:	

LATERAL #2			
SEC	TWP	RGE	COUNTY
1/4	1/4	1/4	1/4
Depth of Deviation		Radius of Turn	Direction
Measured Total Depth		True Vertical Depth	Total Length
		BHL From Lease, Unit, or Property Line:	

LATERAL #3			
SEC	TWP	RGE	COUNTY
1/4	1/4	1/4	1/4
Depth of Deviation		Radius of Turn	Direction
Measured Total Depth		True Vertical Depth	Total Length
		BHL From Lease, Unit, or Property Line:	