

Oklahoma Corporation Commission  
Oil & Gas Conservation Division  
Post Office Box 52000  
Oklahoma City, Oklahoma 73152-2000  
Rule 165: 10-3-25

Form 1002A

API No.: 35109362510002

**Completion Report**

Spud Date: April 01, 1935

OTC Prod. Unit No.:

Drilling Finished Date: October 01, 1937

**Amended**

1st Prod Date:

Amend Reason: CONVERT TO SALT WATER DISPOSAL

Completion Date: October 01, 1937

Recomplete Date: February 27, 2019

**Drill Type: STRAIGHT HOLE**

**SERVICE WELL**

Well Name: BUTLER 1

Purchaser/Measurer:

Location: OKLAHOMA 35 12N 3W  
NW NE SW NW  
1130 FSL 700 FWL of 1/4 SEC  
Derrick Elevation: 0 Ground Elevation: 0

First Sales Date:

Operator: TNT OPERATING COMPANY INC 19087

10600 S PENNSYLVANIA AVE STE 16-601  
OKLAHOMA CITY, OK 73170-4257

Completion Type		Location Exception		Increased Density	
X	Single Zone	Order No		Order No	
	Multiple Zone	There are no Location Exception records to display.		There are no Increased Density records to display.	
	Commingled				

Casing and Cement							
Type	Size	Weight	Grade	Feet	PSI	SAX	Top of CMT
CONDUCTOR	20	85		250		400	SURFACE
SURFACE	13 3/8	54.5		2159		2560	SURFACE
PRODUCTION	9 5/8	40		6239		2000	4800

Liner								
Type	Size	Weight	Grade	Length	PSI	SAX	Top Depth	Bottom Depth
LINER	7	26		0	0	350	SURFACE	6045

**Total Depth: 6497**

Packer		Plug	
Depth	Brand & Type	Depth	Plug Type
6028	MODEL R	6170	CIBP

Initial Test Data
-------------------

Test Date	Formation	Oil BBL/Day	Oil-Gravity (API)	Gas MCF/Day	Gas-Oil Ratio Cu FT/BBL	Water BBL/Day	Pumpin or Flowing	Initial Shut- In Pressure	Choke Size	Flow Tubing Pressure
-----------	-----------	----------------	----------------------	----------------	----------------------------	------------------	----------------------	---------------------------------	---------------	-------------------------

There are no Initial Data records to display.

Completion and Test Data by Producing Formation

Formation Name: OSWEGO

Code: 404OSWG

Class: DISP

Spacing Orders		Perforated Intervals	
Order No	Unit Size	From	To
There are no Spacing Order records to display.		6074	6109
Acid Volumes		Fracture Treatments	
There are no Acid Volume records to display.		There are no Fracture Treatments records to display.	

Formation	Top
OSWEGO	6074

Were open hole logs run? No

Date last log run:

Were unusual drilling circumstances encountered? No

Explanation:

Other Remarks
UIC PERMIT NUMBER 1811650022

FOR COMMISSION USE ONLY

1142257

Status: Accepted

109-36251-02  
OTC PROD.  
UNIT NO.

OKLAHOMA CORPORATION COMMISSION  
Oil & Gas Conservation Division  
Post Office Box 52000  
Oklahoma City, Oklahoma 73152-2000  
Rule 165:10-3-25

RECEIVED

MAR 05 2019

Form 10  
Rev. 2

Oklahoma Corporation  
Commission

COMPLETION REPORT

☐ ORIGINAL  
☒ AMENDED (Reason) Convert to SWD  
TYPE OF DRILLING OPERATION  
☒ STRAIGHT HOLE ☐ DIRECTIONAL HOLE ☐ HORIZONTAL HOLE  
If directional or horizontal, see reverse for bottom hole location.

COUNTY Oklahoma SEC 35 TWP 12N RGE 3W  
LEASE NAME Butler WELL NO. 1  
NW 1/4 SW 1/4 NW 1/4 1/4 FSL OF 1/4 SEC 1130 FWL OF 1/4 SEC 700  
ELEVATION  
Derrick FL Ground Latitude (if known) Longitude (if known)  
OPERATOR NAME TNT Operating Co Inc OTC/OCC OPERATOR NO. 19087  
ADDRESS 10600 S. Pennsylvania Ave, Suite 16-601  
CITY Oklahoma City STATE OK ZIP 73170

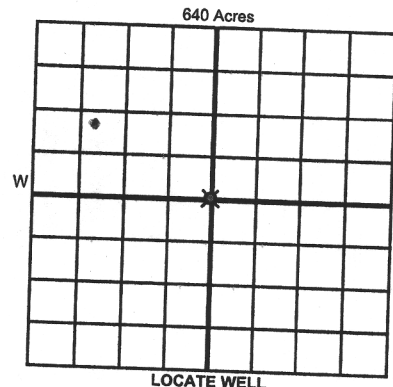

COMPLETION TYPE

☒ SINGLE ZONE  
☐ MULTIPLE ZONE  
☐ COMMINGLED  
LOCATION EXCEPTION ORDER NO.  
INCREASED DENSITY ORDER NO.

CASING & CEMENT (Attach Form 1002C)

TYPE	SIZE	WEIGHT	GRADE	FEET	PSI	SAX	TOP OF CMT
CONDUCTOR	20"	85#		250		400	Surface
SURFACE	13 3/8	54 1/2		2159		2560	Surface
INTERMEDIATE	9 5/8	40		60239		2000	4800
PRODUCTION							
LINER	7	26		6045 - surface		350	3000

PACKER @ 6028 BRAND & TYPE Model R

PACKER @ 6170 BRAND & TYPE Model R

PLUG @ 6170 TYPE CTAP

PLUG @ 6028 TYPE Model R

TOTAL DEPTH 6170

COMPLETION & TEST DATA BY PRODUCING FORMATION

FORMATION Oswego 4040SWG  
SPACING & SPACING (see remarks)  
ORDER NUMBER 1811650022  
CLASS: Oil, Gas, Dry, Inj, Disp, Comm Disp, Svc Disposal  
PERFORATED INTERVALS 6074-6084  
6089-6109  
ACID/VOLUME  
FRACTURE TREATMENT (Fluids/Prop Amounts)

Min Gas Allowable (165:10-17-7)  
OR  
Oil Allowable (165:10-13-3)

Gas Purchaser/Measurer  
First Sales Date

INITIAL TEST DATA

INITIAL TEST DATE					
OIL-BBL/DAY					
OIL-GRAVITY (API)					
GAS-MCF/DAY					
GAS-OIL RATIO CU FT/BBL					
WATER-BBL/DAY					
PUMPING OR FLOWING					
INITIAL SHUT-IN PRESSURE					
CHOKE SIZE					
FLOW TUBING PRESSURE					

AS SUBMITTED

A record of the formations drilled through, and pertinent remarks are presented on the reverse. I declare that I have knowledge of the contents of this report and am authorized by my organization to make this report, which was prepared by me or under my supervision and direction, with the data and facts stated herein to be true, correct, and complete to the best of my knowledge and belief.

Byron R. Deher  
SIGNATURE

Byron Deher  
NAME (PRINT OR TYPE)

2-28-19 627-1734  
DATE PHONE NUMBER

### FORMATION RECORD

LEASE NAME \_\_\_\_\_ WELL NO. \_\_\_\_\_

NAMES OF FORMATIONS	TOP
Oswego	6674

FOR COMMISSION USE ONLY	
ITD on file	<input type="checkbox"/> YES <input type="checkbox"/> NO
APPROVED	DISAPPROVED
2) Reject Codes  _____ _____ _____ _____ _____	

Were open hole logs run? \_\_\_\_\_ yes \_\_\_\_\_ no

Date Last log was run \_\_\_\_\_

Was CO<sub>2</sub> encountered? \_\_\_\_\_ yes \_\_\_\_\_ no at what depths? \_\_\_\_\_

Was H<sub>2</sub>S encountered? \_\_\_\_\_ yes \_\_\_\_\_ no at what depths? \_\_\_\_\_

Were unusual drilling circumstances encountered? \_\_\_\_\_ yes \_\_\_\_\_ no

If yes, briefly explain below

UIC Permit # 1811650022

640 Acres



Directional surveys are required for all drainholes and directional wells.

640 Acres

A 10x10 grid representing 640 acres. The grid is divided into four equal vertical sections by a thick vertical line. The top-left section is shaded light blue. The top-right section is shaded light green. The bottom-left section is shaded light orange. The bottom-right section is shaded light purple. The grid is labeled '640 Acres' at the top center.

SEC	TWP	RGE	COUNTY		
Spot Location			Feet From 1/4 Sec Lines	FSL	FWL
1/4	1/4	1/4	1/4		
Measured Total Depth		True Vertical Depth	BHL From Lease, Unit, or Property Line:		

LATERAL #1

SEC	TWP	RGE	COUNTY			
Spot Location				Feet From 1/4 Sec Lines	FSL	FWL
1/4	1/4	1/4	1/4			
Depth of Deviation		Radius of Turn	Direction	Total Length		
Measured Total Depth		True Vertical Depth	BHL From Lease, Unit, or Property Line:			

SEC	TWP	RGE	COUNTY			
Spot Location			Feet From 1/4 Sec Lines		FSL	FWL
1/4	1/4	1/4	1/4			
Depth of Deviation		Radius of Turn	Direction	Total Length		
Measured Total Depth		True Vertical Depth	BHL From Lease, Unit, or Property Line:			

SEC	TWP	RGE	COUNTY			
Spot Location			Feet From 1/4 Sec Lines		FSL	FWL
1/4	1/4	1/4	1/4			
Depth of Deviation		Radius of Turn	Direction	Total Length		
Measured Total Depth		True Vertical Depth	BHL From Lease, Unit, or Property Line:			