

Oklahoma Corporation Commission
Oil & Gas Conservation Division
Post Office Box 52000
Oklahoma City, Oklahoma 73152-2000
Rule 165: 10-3-25

Form 1002A

API No.: 35019263130002

Completion Report

Spud Date: February 17, 2019

OTC Prod. Unit No.: 019-227390-0-0000

Drilling Finished Date: May 17, 2019

1st Prod Date: October 06, 2021

Amended

Completion Date: October 06, 2021

Amend Reason: SHOW COMPLETION AND CORRECT BOTTOM HOLE LOCATION
DIRECTION

Drill Type: HORIZONTAL HOLE

Min Gas Allowable: Yes

Well Name: NAYLOR 1-11H2X35

Purchaser/Measurer: TARGA PIPELINE MID-
CONTINENT LLC

First Sales Date: 10/06/2021

Location: CARTER 11 4S 2E
SW NW NW NE
522 FNL 2314 FEL of 1/4 SEC
Latitude: 34.229258 Longitude: -97.063107
Derrick Elevation: 802 Ground Elevation: 777

Operator: XTO ENERGY INC 21003

22777 SPRINGWOODS VILLAGE PARKWAY
SPRING, TX 77389-1425

Completion Type		Location Exception		Increased Density	
X	Single Zone	Order No		Order No	
	Multiple Zone	724136		689887	
	Commingled			689955	

Casing and Cement							
Type	Size	Weight	Grade	Feet	PSI	SAX	Top of CMT
CONDUCTOR	20	53	A53 B	80			SURFACE
SURFACE	13 3/8	54.5	J-55	2005		855	SURFACE
PRODUCTION	5 1/2	23	P-110	25118		3000	8766

Liner								
Type	Size	Weight	Grade	Length	PSI	SAX	Top Depth	Bottom Depth
There are no Liner records to display.								

Total Depth: 25143

Packer	
Depth	Brand & Type
There are no Packer records to display.	

Plug	
Depth	Plug Type
There are no Plug records to display.	

Initial Test Data

Test Date	Formation	Oil BBL/Day	Oil-Gravity (API)	Gas MCF/Day	Gas-Oil Ratio Cu FT/BBL	Water BBL/Day	Pumpin or Flowing	Initial Shut-In Pressure	Choke Size	Flow Tubing Pressure
Nov 05, 2021	WOODFORD	19	50	3239	170474	903	FLOWING		39/64	643

Completion and Test Data by Producing Formation	
Formation Name: WOODFORD	Code: 319WDFD
Class: GAS	

Spacing Orders	
Order No	Unit Size
199785	640
584421	640
724089	MULTIUNIT

Perforated Intervals	
From	To
15108	25003

Acid Volumes	
5,999 GALLONS	

Fracture Treatments	
36 STAGES - 485,405 BARRELS TREATED WATER, 8,249,988 100 MESH SAND, 2,956,510 POUNDS 40/80 WHITE SAND, 3,070,320 POUNDS 40/70 WHITE SAND	

Formation	Top
WOODFORD	15038

Were open hole logs run? No

Date last log run:

Were unusual drilling circumstances encountered? No

Explanation:

Other Remarks
INITIAL COMPLETION AND CORRECT BOTTOM HOLE LOCATION DIRECTION

Lateral Holes
<p>Sec: 35 TWP: 3S RGE: 2E County: CARTER</p> <p>NE NE NW NW</p> <p>167 FNL 1291 FWL of 1/4 SEC</p> <p>Depth of Deviation: 13800 Radius of Turn: 923 Direction: 351 Total Length: 9893</p> <p>Measured Total Depth: 25143 True Vertical Depth: 13635 End Pt. Location From Release, Unit or Property Line: 167</p>

FOR COMMISSION USE ONLY	
Status: Accepted	1147339

API NO. 35-019-26313
OTC PROD. UNIT NO. 010-227380-0-0000

Oil and Gas Conservation Division
P.O. Box 52000
Oklahoma City, OK 73152-2000
405-522-0577
OCCCentralProcessing@OCC.OK.GOV



OKLAHOMA
Corporation
Commission

RECEIVED

DEC 10 2021

ORIGINAL
AMENDED (Reason) Initial Completion & Correct BHL Direction

Rule 165.10-3-25

COMPLETION REPORT

TYPE OF DRILLING OPERATION

☐ STRAIGHT HOLE ☐ DIRECTIONAL HOLE ☒ HORIZONTAL HOLE
☐ SERVICE WELL

If directional or horizontal, see reverse for bottom hole location.

COUNTY	Carter	SEC	11	TWP	4S	RGE	2E	SPUD DATE	2/17/19
LEASE NAME	Naylor	WELL NO.	1-11H2X35	DRLG FINISHED DATE	5/17/19	DATE OF WELL COMPLETION	10/6/21	1st PROD DATE	10/6/21
SW 1/4 NW 1/4 NW 1/4 NE 1/4	(FNL) 522 (FEL) 2314	RECOMP DATE							
ELEVATION	802	Ground	777	Latitude	34.229258	Longitude	-97.063107		
OPERATOR NAME	XTO Energy Inc	OTC / OCC OPERATOR NO.	21003						
ADDRESS	22777 Springwoods Village parkway								
CITY	Spring	STATE	TX	ZIP	77389				

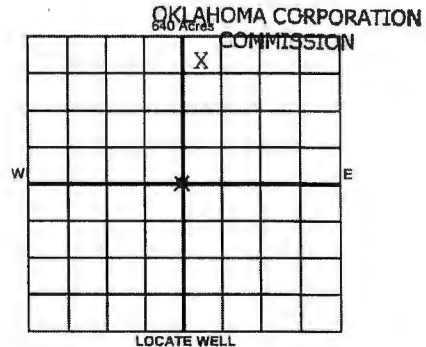

COMPLETION TYPE

<input checked="" type="radio"/> SINGLE ZONE	
<input type="radio"/> MULTIPLE ZONE	
Application Date	
COMINGLED	
Application Date	
LOCATION EXCEPTION ORDER NO.	724136 691966 FD
MULTIUNIT ORDER NO.	724089 691963 FD
INCREASED DENSITY ORDER NO.	689887, 689955 FD

CASING & CEMENT (Attach Form 1002C)

TYPE	SIZE	WEIGHT	GRADE	FEET	PSI	SAX	TOP OF CMT
CONDUCTOR	20"	53#	A53 B	80			Surface
SURFACE	13 3/8"	54.5#	J-55	2005		855	Surface
INTERMEDIATE							
PRODUCTION	5 1/2"	23#	P-110	25118		3000	8766'
LINER							

PACKER @ BRAND & TYPE PLUG @ TYPE PLUG @ TYPE PLUG @ TYPE TOTAL DEPTH 25143

COMPLETION & TEST DATA BY PRODUCING FORMATION

FORMATION	Woodford					Reported to Frac Treas
SPACING & SPACING ORDER NUMBER	(HC) 584421, 199785	(640)				
CLASS: Oil, Gas, Dry, Inj, Disp, Comm Disp, Svc	Gas					
PERFORATED INTERVALS	15,108' - 25,003'					
ACID/VOLUME	5999 Gals					
FRACTURE TREATMENT (Fluids/Prop Amounts)	36 Stages - 485,405 BTW, 8,249,988# 100 Mesh Sand, 2,956,510# 40/80 White Sand, 3,070,320# 40/70 White Sand					

V

Min Gas Allowable (165:10-17-7)

OR

Oil Allowable (165:10-13-3)

Purchaser/Messurer

First Sales Date

Targa Pipeline Mid-Continent LLC

10/6/21

INITIAL TEST DATA

INITIAL TEST DATE	11/5/21					
OIL-BBL/DAY	19					
OIL-GRAVITY (API)	50					
GAS-MCF/DAY	3239					
GAS-OIL RATIO CU FT/BBL	170474					
WATER-BBL/DAY	903					
PUMPING OR FLOWING	Flowing					
INITIAL SHUT-IN PRESSURE	N/A					
CHOKE SIZE	39/64"					
FLOW TUBING PRESSURE	643					

A record of the formations drilled through, and pertinent remarks are presented on the reverse. I declare that I have knowledge of the contents of this report and am authorized by my organization to make this report, which was prepared by me or under my supervision and direction, with the data and facts stated herein to be true, correct, and complete to the best of my knowledge and belief.

SIGNATURE

210 Park Ave, Suite 2350

ADDRESS

NAME (PRINT OR TYPE)

Oklahoma City OK 73102

CITY

STATE

ZIP

12/9/21

DATE

405-594-9453

PHONE NUMBER

liv.adams@exxonmobil.com

EMAIL ADDRESS

PLEASE TYPE OR USE BLACK INK ONLY
FORMATION RECORD

Give formation names and tops, if available, or descriptions and thickness of formations drilled through. Show intervals cored or drillstem tested.

NAMES OF FORMATIONS	TOP
Woodford	15038

LEASE NAME _____ Mayor _____ WELL NO. _____ 1-11H2K35

FOR COMMISSION USE ONLY	
ITD on file	<input type="checkbox"/> YES <input type="checkbox"/> NO
APPROVED	DISAPPROVED
2) Reject Codes	

Were open hole logs run?	<input type="checkbox"/> yes <input checked="" type="radio"/> no
Date Last log was run	
Was CO ₂ encountered?	<input type="checkbox"/> yes <input checked="" type="radio"/> no at what depths?
Was H ₂ S encountered?	<input type="checkbox"/> yes <input checked="" type="radio"/> no at what depths?
Were unusual drilling circumstances encountered?	<input type="checkbox"/> yes <input checked="" type="radio"/> no
If yes, briefly explain below	

Other remarks: Initial Completion & Correct BHL Direction.

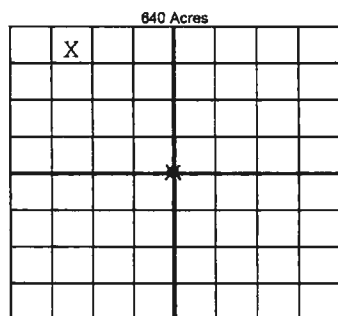

If more than three drainholes are proposed, attach a separate sheet indicating the necessary information.

Direction must be stated in degrees azimuth. Please note, the horizontal drainhole and its end point must be located within the boundaries of the lease or spacing unit.

Directional surveys are required for all drainholes and directional wells

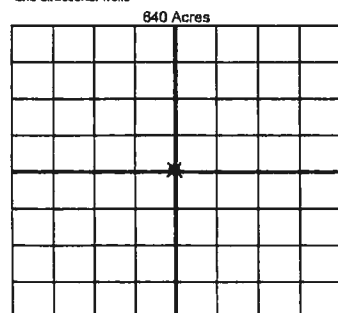

BOTTOM HOLE LOCATION FOR DIRECTIONAL HOLE

SEC	TWP	RGE	COUNTY
1/4	1/4	1/4	1/4
Measured Total Depth		True Vertical Depth	BHL From Lease, Unit, or Property Line:

BOTTOM HOLE LOCATION FOR HORIZONTAL HOLE: (LATERALS)

LATERAL #1			
SEC	TWP	RGE	COUNTY
35	3S	2E	Carter
NE	NE	NW	NW
1/4	1/4	1/4	1/4
Feet From 1/4 Sec Lines		FNL	FWL
		167	1291
Depth of Deviation		Radius of Turn	Direction
13800		923	351
Measured Total Depth		True Vertical Depth	Total Length
25143		13635	9893
		BHL From Lease, Unit, or Property Line:	
		167	

LATERAL #2

SEC	TWP	RGE	COUNTY
1/4	1/4	1/4	1/4
Feet From 1/4 Sec Lines			
Depth of Deviation		Radius of Turn	Direction
Measured Total Depth		True Vertical Depth	Total Length
		BHL From Lease, Unit, or Property Line:	

LATERAL #3

SEC	TWP	RGE	COUNTY
1/4	1/4	1/4	1/4
Feet From 1/4 Sec Lines			
Depth of Deviation		Radius of Turn	Direction
Measured Total Depth		True Vertical Depth	Total Length
		BHL From Lease, Unit, or Property Line:	