

Oklahoma Corporation Commission
Oil & Gas Conservation Division
Post Office Box 52000
Oklahoma City, Oklahoma 73152-2000
Rule 165: 10-3-25

Form 1002A

API No.: 35019263140001

Completion Report

Spud Date: February 14, 2019

OTC Prod. Unit No.: 019-227391-0-0000

Drilling Finished Date: August 05, 2019

1st Prod Date: October 06, 2021

Completion Date: October 06, 2021

Amended

Amend Reason: SHOW COMPLETION, CORRECT PRODUCTION TOP OF CEMENT AND
BOTTOM HOLE LOCATION DETAILS

Drill Type: HORIZONTAL HOLE

Min Gas Allowable: Yes

Well Name: NAYLOR 2-11H2X35

Purchaser/Measurer: TARGA PIPELINE MID-
CONTINENT LLC

First Sales Date: 10/06/2021

Location: CARTER 11 4S 2E
SE NW NW NE
540 FNL 2307 FEL of 1/4 SEC
Latitude: 34.229207 Longitude: -97.063083
Derrick Elevation: 803 Ground Elevation: 778

Operator: XTO ENERGY INC 21003

22777 SPRINGWOODS VILLAGE PARKWAY
SPRING, TX 77389-1425

Completion Type		Location Exception		Increased Density	
X	Single Zone	Order No		Order No	
	Multiple Zone	724137		689887	
	Commingled			689955	

Casing and Cement							
Type	Size	Weight	Grade	Feet	PSI	SAX	Top of CMT
CONDUCTOR	20	53	A53 B	80			SURFACE
SURFACE	13 3/8	54.5	J-55	2000		855	SURFACE
PRODUCTION	5 1/2	23	P-110	25008		2435	13860

Liner								
Type	Size	Weight	Grade	Length	PSI	SAX	Top Depth	Bottom Depth
There are no Liner records to display.								

Total Depth: 25008

Packer	
Depth	Brand & Type
There are no Packer records to display.	

Plug	
Depth	Plug Type
There are no Plug records to display.	

Initial Test Data

Test Date	Formation	Oil BBL/Day	Oil-Gravity (API)	Gas MCF/Day	Gas-Oil Ratio Cu FT/BBL	Water BBL/Day	Pumpin or Flowing	Initial Shut-In Pressure	Choke Size	Flow Tubing Pressure
Nov 02, 2021	WOODFORD	42	50	3327	79214	906	FLOWING		42/64	308

Completion and Test Data by Producing Formation	
Formation Name: WOODFORD	Code: 319WDFD
Class: GAS	

Spacing Orders	
Order No	Unit Size
199785	640
584421	640
724090	MULTIUNIT

Perforated Intervals	
From	To
15142	24866

Acid Volumes	
6,164 GALLONS	

Fracture Treatments	
36 STAGES - 542,687 BARRELS TREATED WATER, 3,460,110 POUNDS 100 MESH SAND, 8,067,540 40/80 WHITE SAND, 2,954,670 POUNDS 40/70 WHITE SAND	

Formation	Top
WOODFORD	14840

Were open hole logs run? No

Date last log run:

Were unusual drilling circumstances encountered? No

Explanation:

Other Remarks
INITIAL COMPLETION, CORRECT PRODUCTION TOP OF CEMENT AND BOTTOM HOLE LOCATION DETAILS

Lateral Holes
<p>Sec: 35 TWP: 3S RGE: 2E County: CARTER</p> <p>NW NE NE NW</p> <p>154 FNL 2160 FWL of 1/4 SEC</p> <p>Depth of Deviation: 14000 Radius of Turn: 821 Direction: 356 Total Length: 9718</p> <p>Measured Total Depth: 25008 True Vertical Depth: 13507 End Pt. Location From Release, Unit or Property Line: 154</p>

FOR COMMISSION USE ONLY	
Status: Accepted	1147366

API NO. 35-019-26314
OTC PROD. 019-227391-0-0000
UNIT NO.

Oil and Gas Conservation Division
P.O. Box 52000
Oklahoma City, OK 73152-2000
405-522-0577
OCCCentralProcessing@OCC.OK.GOV

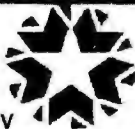

OKLAHOMA
Corporation
Commission

RECEIVED

Form 1002A
Rev. 2020

DEC 10 2021

ORIGINAL
AMENDED (Reason) Initial Completion, Correct prod TOC & BHL details

Rule 165:10-3-25

COMPLETION REPORT

TYPE OF DRILLING OPERATION
☐ STRAIGHT HOLE ☐ DIRECTIONAL HOLE ☒ HORIZONTAL HOLE
☐ SERVICE WELL
If directional or horizontal, see reverse for bottom hole location.

COUNTY	Carter	SEC	11	TWP	4S	RGE	2E	SPUD DATE	2/14/19	
LEASE NAME	Naylor	WELL NO.	2-11H2X35	DATE OF WELL COMPLETION	10/6/21	DRLG FINISHED DATE			8/5/19	
SE 1/4 NW 1/4 NW 1/4 NE 1/4	FNL 540	FEL 2307	RECOMP DATE							
ELEVATION	803	Ground	778	Latitude	34.229207	Longitude	-97.063083	1st PROD DATE		10/6/21
OPERATOR NAME	XTO Energy Inc				OTC / OCC OPERATOR NO.	21003				
ADDRESS	22777 Springwoods Village parkway									
CITY	Spring	STATE	TX	ZIP	77389					

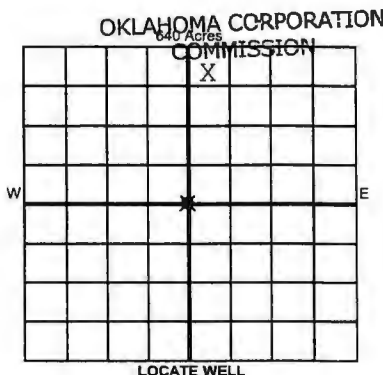

COMPLETION TYPE	
<input checked="" type="radio"/> SINGLE ZONE	
<input type="radio"/> MULTIPLE ZONE	
<input type="radio"/> COMMINGLED	
LOCATION EXCEPTION ORDER NO.	724137 691967 ID
MULTIUNIT ORDER NO.	724090 691964 ID
INCREASED DENSITY ORDER NO.	689887, 689855

TYPE	SIZE	WEIGHT	GRADE	FEET	PSI	SAX	TOP OF CMT
CONDUCTOR	20"	53#	A53 B	80			Surface
SURFACE	13 3/8"	54.5#	J-55	2000		855	Surface
INTERMEDIATE							
PRODUCTION	5 1/2"	23#	P-110	25008		2435	13860'
LINER							

PACKER @ BRAND & TYPE PLUG @ TYPE PLUG @ TYPE TOTAL DEPTH 25145 25008

COMPLETION & TEST DATA BY PRODUCING FORMATION

FORMATION	Woodford								
SPACING & SPACING ORDER NUMBER	(640) 584421, 199785	(640)							
CLASS: Oil, Gas, Dry, Inj, Disp, Comm Disp, Svc	Gas								
PERFORATED INTERVALS	15,142' - 24,866'								
ACID/VOLUME	6164 Gals								
FRACTURE TREATMENT (Fluids/Prop Amounts)	36 Stages - 542,687 BTW, 3,460,110# 100 Mesh Sand, 8,067,540# 40/80 White Sand, 2,954,670# 40/70 White Sand								

Reported to survey vBHL
Frac Woods

Min Gas Allowable (165:10-17-7) OR Oil Allowable (165:10-13-3) Purchaser/Measurer Targa Pipeline Mid-Continent LLC First Sales Date 10/6/21

INITIAL TEST DATA

INITIAL TEST DATE	11/2/21					
OIL-BBL/DAY	42					
OIL-GRAVITY (API)	50					
GAS-MCF/DAY	3327					
GAS-OIL RATIO CU FT/BBL	79214					
WATER-BBL/DAY	906					
PUMPING OR FLOWING	Flowing					
INITIAL SHUT-IN PRESSURE	N/A					
CHOKE SIZE	42/64"					
FLOW TUBING PRESSURE	308					

A record of the formations drilled through, and pertinent remarks are presented on the reverse. I declare that I have knowledge of the contents of this report and am authorized by my organization to make this report, which was prepared by me or under my supervision and direction, with the data and facts stated herein to be true, correct, and complete to the best of my knowledge and belief.

SIGNATURE 210 Park Ave, Suite 2350 ADDRESS
NAME (PRINT OR TYPE) Oklahoma City OK 73102 CITY STATE ZIP
12/9/21 DATE 405-594-9453 PHONE NUMBER
liv.adams@exxonmobil.com EMAIL ADDRESS

PLEASE TYPE OR USE BLACK INK ONLY

FORMATION RECORD

Give formation names and tops, if available, or descriptions and thickness of formations drilled through. Show intervals cored or drillstem tested.

LEASE NAME

Hayler

WELL NO.

1-11H2X35

NAMES OF FORMATIONS	TOP
Woodford	14840

FOR COMMISSION USE ONLY

ITD on file ☐ YES ☐ NO

APPROVED _____ DISAPPROVED _____

2) Reject Codes _____

Were open hole logs run? ☐ yes ☒ no

Date Last log was run _____

Was CO₂ encountered? ☐ yes ☒ no at what depths? _____

Was H₂S encountered? ☐ yes ☒ no at what depths? _____

Were unusual drilling circumstances encountered? ☐ yes ☒ no

If yes, briefly explain below.

Other remarks: Initial Completion, Correct prod TOC & BHL details.

640 Acres

If more than three drainholes are proposed, attach a separate sheet indicating the necessary information.

Direction must be stated in degrees azimuth. Please note, the horizontal drainhole and its end point must be located within the boundaries of the lease or spacing unit.

Directional surveys are required for all drainholes and directional wells

640 Acres

BOTTOM HOLE LOCATION FOR DIRECTIONAL HOLE

SEC	TWP	RGE	COUNTY
1/4	1/4	1/4	1/4
Measured Total Depth		True Vertical Depth	Feet From 1/4 Sec Lines BHL From Lease, Unit, or Property Line:

BOTTOM HOLE LOCATION FOR HORIZONTAL HOLE: (LATERALS)

LATERAL #1

SEC	35	TWP	3S	RGE	2E	COUNTY	Carter
NW	1/4	NE	1/4	NE	1/4	NW	1/4
Depth of Deviation		14000		Radius of Turn		821	
Measured Total Depth		25008		True Vertical Depth		13507	
Direction		356		Total Length		9718	
BHL From Lease, Unit, or Property Line:		154		FWL		2160	

LATERAL #2

SEC	TWP	RGE	COUNTY
1/4	1/4	1/4	1/4
Depth of Deviation		Radius of Turn	
Measured Total Depth		True Vertical Depth	
Direction		Total Length	
BHL From Lease, Unit, or Property Line:			

LATERAL #3

SEC	TWP	RGE	COUNTY
1/4	1/4	1/4	1/4
Depth of Deviation		Radius of Turn	
Measured Total Depth		True Vertical Depth	
Direction		Total Length	
BHL From Lease, Unit, or Property Line:			