

Oklahoma Corporation Commission  
Oil & Gas Conservation Division  
Post Office Box 52000  
Oklahoma City, Oklahoma 73152-2000  
Rule 165: 10-3-25

Form 1002A

API No.: 35051245530001

**Completion Report**

Spud Date: February 03, 2019

OTC Prod. Unit No.: 051-227332-0-0000

Drilling Finished Date: March 17, 2021

1st Prod Date: September 01, 2021

Completion Date: June 25, 2021

**Drill Type:** HORIZONTAL HOLE

Min Gas Allowable: Yes

Well Name: JESSICA 6-1-12XH

Purchaser/Measurer: ENABLE

Location: GRADY 1 7N 5W  
NW NW NW NE  
300 FNL 2325 FEL of 1/4 SEC  
Latitude: 35.115884767 Longitude: -97.677947646  
Derrick Elevation: 1317 Ground Elevation: 1289

First Sales Date: 09/01/2021

Operator: BRICKTOWN ENERGY LLC 24520

3030 NW EXPRESSWAY STE 900  
OKLAHOMA CITY, OK 73112-5468

Completion Type		Location Exception		Increased Density	
X	Single Zone	Order No		Order No	
	Multiple Zone	720488		701404	
	Commingled			701405	

Casing and Cement							
Type	Size	Weight	Grade	Feet	PSI	SAX	Top of CMT
CONDUCTOR	20	52	X-42	105			
SURFACE	13.375	54.5	J-55	570		535	SURFACE
INTERMEDIATE	9.625	36.0	J-55	3227		565	SURFACE
PRODUCTION	5.5	23.0	HCP-110	21174		3470	3200

Liner								
Type	Size	Weight	Grade	Length	PSI	SAX	Top Depth	Bottom Depth
There are no Liner records to display.								

**Total Depth: 21174**

Packer	
Depth	Brand & Type
There are no Packer records to display.	

Plug	
Depth	Plug Type
There are no Plug records to display.	

Initial Test Data
-------------------

Test Date	Formation	Oil BBL/Day	Oil-Gravity (API)	Gas MCF/Day	Gas-Oil Ratio Cu FT/BBL	Water BBL/Day	Pumpin or Flowing	Initial Shut-In Pressure	Choke Size	Flow Tubing Pressure
Sep 01, 2021	WOODFORD	346	45	557	1610	4400	PUMPING	139	48/64	

#### Completion and Test Data by Producing Formation

Formation Name: WOODFORD

Code: 319WDFD

Class: OIL

#### Spacing Orders

Order No	Unit Size
678842	640
697669	640 CONFIRM
720489	MULTIUNIT

#### Perforated Intervals

From	To
10945	15917
15952	21054

#### Acid Volumes

3,838 GALLONS 7.5% HCl

#### Fracture Treatments

553,212 BARRELS FLUID, 20,101,488 POUNDS SAND

Formation	Top
CHEROKEE	9268
VERDIGRIS	9410
RED FORK	9870
SPRINGER	10259
MERAMEC	10404
SYCAMORE	10493

Were open hole logs run? No

Date last log run:

Were unusual drilling circumstances encountered? No

Explanation:

#### Other Remarks

ECHO E & P DRILLED WELL. BRICKTOWN ENERGY LLC PURCHASED WELL BORE AND COMPLETED WELL.

#### Lateral Holes

Sec: 12 TWP: 7N RGE: 5W County: GRADY

SW SE SE SE

53 FSL 378 FEL of 1/4 SEC

Depth of Deviation: 10009 Radius of Turn: 999 Direction: 182 Total Length: 10161

Measured Total Depth: 21174 True Vertical Depth: 10700 End Pt. Location From Release, Unit or Property Line: 53

#### FOR COMMISSION USE ONLY

1147294

Status: Accepted

RECEIVED

API NO. 35-051-24553  
OTC PROD. UNIT NO. 0512273320000

Oil and Gas Conservation Division  
P.O. Box 52000  
Oklahoma City, OK 73152-2000  
405-521-2331  
OCCCentralProcessing@OCC.OK.GOV



OKLAHOMA Corporation Commission

NOV 22 2021

Form 1002A Rev. 2021



ORIGINAL  
AMENDED (Reason)

Rule 185:10-3-25

COMPLETION REPORT

OKLAHOMA CORPORATION COMMISSION

TYPE OF DRILLING OPERATION

☐ STRAIGHT HOLE ☐ DIRECTIONAL HOLE ☒ HORIZONTAL HOLE

If directional or horizontal, see reverse for bottom hole location.

SPUD DATE 2/3/2019  
DRLG FINISHED DATE 3/17/2021  
DATE OF WELL COMPLETION 6/25/2021  
1st PROD DATE 9/01/2021  
RECOMP DATE  
OTC / OCC OPERATOR NO. 24250 24520

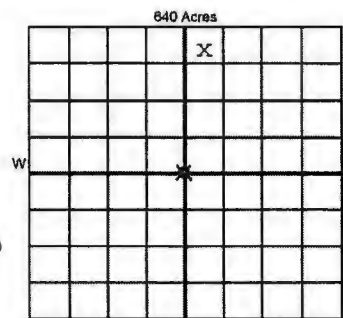

COUNTY Grady SEC 01 TWP 07N RGE 05W  
LEASE NAME Jessica  
WELL NO. 6-1-12XH  
FNL 300  
ELEVATION Derrick FL 1317 Ground 1289  
Latitude 35.115884767° N Longitude -97.677947646° W  
OPERATOR NAME Bricktown Energy LLC  
ADDRESS 3030 NW Expressway #900  
CITY OKC STATE OK ZIP 73120

COMPLETION TYPE

☒ SINGLE ZONE  
☐ MULTIPLE ZONE  
Application Date  
☐ COMMINGLED  
Application Date  
LOCATION EXCEPTION ORDER NO. 720488 FO  
MULTIUNIT ORDER NO. 720489 FO  
INCREASED DENSITY ORDER NO. 701404 701405

CASING & CEMENT (Attach Form 1002C)

TYPE	SIZE	WEIGHT	GRADE	FEET	PSI	SAX	TOP OF CMT
CONDUCTOR	20	52	X42	105			
SURFACE	13.375	54.5	J55	570		535	Surface
INTERMEDIATE	9.625	38.0	J55	3227		565	Surface
PRODUCTION	5.5	23.0	HCP110	21,174	347K	1052	Surface 3200
LINER							

PACKER @ BRAND & TYPE PLUG @ TYPE PLUG @ TYPE  
PACKER @ BRAND & TYPE PLUG @ TYPE PLUG @ TYPE

TOTAL DEPTH 21174  
see survey 1 BBL

COMPLETION & TEST DATA BY PRODUCING FORMATION

FORMATION	319 350 WDFD Woodford				Reported to Frac Focus
SPACING & SPACING ORDER NUMBER	678842 (640) sec 1 697669 confirm				
CLASS: Oil, Gas, Dry, Inj, Disp, Comm Disp, Svc	Oil				
PERFORATED INTERVALS	10,945 - 15917 15952 - 21054				
ACID/VOLUME	7.5% HCl 3838 (gal)				
FRACTURE TREATMENT (Fluids/Prop Amounts)	Fluid: 553,212 bbl Sand: 20,101,488 lbs				



Min Gas Allowable (185:10-17-7)  
OR  
Oil Allowable (185:10-13-3)

Purchaser/Measurer  
First Sales Date

Enable  
9/1/2021

INITIAL TEST DATA

INITIAL TEST DATE	9/12/21				
OIL-BBL/DAY	346				
OIL-GRAVITY (API)	45				
GAS-MCF/DAY	557				
GAS-OIL RATIO CU FT/BBL	1610				
WATER-BBL/DAY	4400				
PUMPING OR FLOWING	Pumping				
INITIAL SHUT-IN PRESSURE	139				
CHOKE SIZE	48/64				
FLOW TUBING PRESSURE					

A record of the formations drilled through, and pertinent remarks are presented on the reverse. I declare that I have knowledge of the contents of this report and am authorized by my organization to make this report, which was prepared by me or under my supervision and direction, with the data and facts stated herein to be true, correct, and complete to the best of my knowledge and belief.

SIGNATURE Kevin R Fischer  
3030 NW Expressway OKC OK 73112  
ADDRESS CITY STATE ZIP  
DATE 11/18/2021 405-431-7275  
PHONE NUMBER  
EMAIL ADDRESS kfischer@rbluff.com

PLEASE TYPE OR USE BLACK INK ONLY  
FORMATION RECORD

Give formation names and tops, if available, or descriptions and thickness of formations drilled through. Show intervals cored or drillstem tested.

NAMES OF FORMATIONS	TOP
Cherokee	9268
Verdigris	9410
Red Fork	9870
Springer	10259
Meramec	10404
Sycamore	10493

LEASE NAME Jessica WELL NO. 6-1-12XH

FOR COMMISSION USE ONLY	
ITD on file <input type="checkbox"/> YES <input type="checkbox"/> NO	
APPROVED <input type="checkbox"/> DISAPPROVED <input type="checkbox"/>	2) Reject Codes
<div></div> <div></div> <div></div> <div></div> <div></div>	

Were open hole logs run?	<input type="radio"/> yes <input checked="" type="radio"/> no
Date Last log was run	
Was CO <sub>2</sub> encountered?	<input type="radio"/> yes <input checked="" type="radio"/> no at what depths? _____
Was H <sub>2</sub> S encountered?	<input type="radio"/> yes <input checked="" type="radio"/> no at what depths? _____
Were unusual drilling circumstances encountered?	<input type="radio"/> yes <input checked="" type="radio"/> no
If yes, briefly explain below	

Other remarks: Echo E&P drilled well. BTE purchased well bore and completed well.

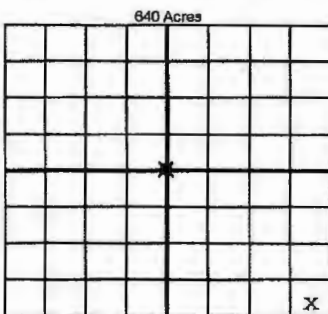

If more than three drainholes are proposed, attach a separate sheet indicating the necessary information.

Direction must be stated in degrees azimuth. Please note, the horizontal drainhole and its end point must be located within the boundaries of the lease or spacing unit.

Directional surveys are required for all drainholes and directional wells

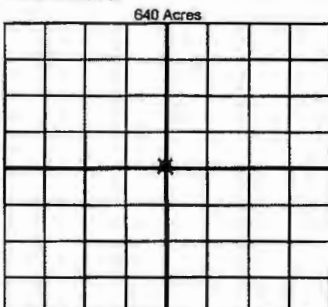

BOTTOM HOLE LOCATION FOR DIRECTIONAL HOLE

SEC	TWP	RGE	COUNTY
1/4	1/4	1/4	1/4
Measured Total Depth	True Vertical Depth	Feet From 1/4 Sec Lines	
		BHL From Lease, Unit, or Property Line:	

BOTTOM HOLE LOCATION FOR HORIZONTAL HOLE: (LATERALS)

LATERAL #1			
SEC	TWP	RGE	COUNTY
12	07N	05W	Grady
SE 1/4	SE 1/4	SE 1/4	SE 1/4
Depth of Deviation	10,009	Radius of Turn	999
Measured Total Depth	21,174	True Vertical Depth	10,700
		Feet From 1/4 Sec Lines	
		FSL 53 FEL 378	
		Direction 182-185	
		Total Length 10161	
		BHL From Lease, Unit, or Property Line: 53' FSL	

LATERAL #2			
SEC	TWP	RGE	COUNTY
1/4	1/4	1/4	1/4
Depth of Deviation		Radius of Turn	
Measured Total Depth		True Vertical Depth	
		Feet From 1/4 Sec Lines	
		Total Length	
		BHL From Lease, Unit, or Property Line:	

LATERAL #3			
SEC	TWP	RGE	COUNTY
1/4	1/4	1/4	1/4
Depth of Deviation		Radius of Turn	
Measured Total Depth		True Vertical Depth	
		Feet From 1/4 Sec Lines	
		Total Length	
		BHL From Lease, Unit, or Property Line:	