

Oklahoma Corporation Commission  
Oil & Gas Conservation Division  
Post Office Box 52000  
Oklahoma City, Oklahoma 73152-2000  
Rule 165: 10-3-25

Form 1002A

API No.: 35137111350001

**Completion Report**

Spud Date:

OTC Prod. Unit No.: 137-19208

Drilling Finished Date:

**Amended**

1st Prod Date:

Amend Reason: ADD CASING INFORMATION / AMEND LOCATION QUARTER SECTION

Completion Date: May 22, 1920

Recomplete Date: May 05, 2020

**Drill Type: STRAIGHT HOLE**

Well Name: G W BOWERS 7

Purchaser/Measurer:

Location: STEPHENS 13 2S 4W  
SE SW SW SW  
180 FSL 490 FWL of 1/4 SEC  
Derrick Elevation: 0 Ground Elevation: 1048

First Sales Date:

Operator: BUTKIN OIL COMPANY LLC 21023  
PO BOX 2090  
16 S 9TH ST STE 306  
DUNCAN, OK 73534-2090

Completion Type		Location Exception		Increased Density	
X	Single Zone	Order No		Order No	
	Multiple Zone	There are no Location Exception records to display.		There are no Increased Density records to display.	
	Commingled				

Casing and Cement							
Type	Size	Weight	Grade	Feet	PSI	SAX	Top of CMT
PRODUCTION	6 5/8			995			UNKNOWN

Liner								
Type	Size	Weight	Grade	Length	PSI	SAX	Top Depth	Bottom Depth
There are no Liner records to display.								

**Total Depth: 1005**

Packer		Plug	
Depth	Brand & Type	Depth	Plug Type
There are no Packer records to display.		970	CEMENT

Initial Test Data										
Test Date	Formation	Oil BBL/Day	Oil-Gravity (API)	Gas MCF/Day	Gas-Oil Ratio Cu FT/BBL	Water BBL/Day	Pumpin or Flowing	Initial Shut-In Pressure	Choke Size	Flow Tubing Pressure
	PERMIAN	3	22				PUMPING			

**Completion and Test Data by Producing Formation**

Formation Name: PERMIAN		Code: 459PRMN	Class: OIL
<b>Spacing Orders</b>		<b>Perforated Intervals</b>	
<b>Order No</b>	<b>Unit Size</b>	<b>From</b>	<b>To</b>
There are no Spacing Order records to display.		368	885
<b>Acid Volumes</b>		<b>Fracture Treatments</b>	
There are no Acid Volume records to display.		There are no Fracture Treatments records to display.	

Formation	Top
SEE ORIGINAL	0

Were open hole logs run? No  
Date last log run:  
  
Were unusual drilling circumstances encountered? No  
Explanation:

<b>Other Remarks</b>
THIS RECORD IS TO SHOW ACTUAL TRUE LOCATION AND CASING INFORMATION AND PERFORATED INTERVAL AND CLASSIFICATION AS OIL.

<b>FOR COMMISSION USE ONLY</b>	
Status: Accepted	1145660

API NO. **137-11135**  
OTC PROD. **137**  
UNIT NO. **19208**

(PLEASE TYPE OR USE BLACK INK ONLY)

OKLAHOMA CORPORATION COMMISSION  
Oil & Gas Conservation Division  
Post Office Box 52000  
Oklahoma City, Oklahoma 73152-2000  
Rule 165:10-3-25

☒ ORIGINAL  
☐ AMENDED (Reason)

**ADD CASING INFORMATION**  
**AMEND LOCATION** Quarter

COMPLETION REPORT

TYPE OF DRILLING OPERATION  
☒ STRAIGHT HOLE ☐ DIRECTIONAL HOLE ☐ HORIZONTAL HOLE  
☐ SERVICE WELL

SPUD DATE **UNKNOWN**  
DRLG FINISHED DATE **UNKNOWN**  
DATE OF WELL COMPLETION **5-22-20**

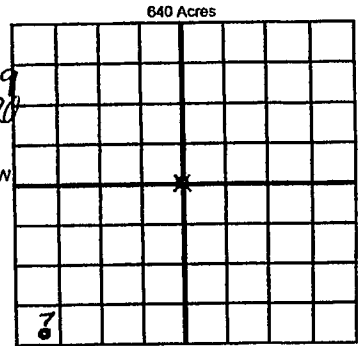

If directional or horizontal, see reverse for bottom hole location.

COUNTY **STEPHENS** SEC **13** TWP **25** RGE **4W**  
LEASE NAME **BOWERS** WELL NO. **7** 1st PROD DATE **UNKNOWN**  
SE 1/4 SW 1/4 SW 1/4 SW 1/4 FSL OF 1/4 SEC **180** FWL OF 1/4 SEC **490** RECOMP DATE **5/5/20**  
ELEVATION Ground **1048** Latitude (if known) Longitude (if known)  
OPERATOR **BUTKIN OIL CO., LLC** OTC / OCC OPERATOR NO. **21023-0**  
ADDRESS **P.O. BOX 2090**  
CITY **DUNCAN** STATE **OK.** ZIP **73534**

COMPLETION TYPE

☒ SINGLE ZONE  
☐ MULTIPLE ZONE  
☐ COMMINGLED  
LOCATION EXCEPTION ORDER NO.  
INCREASED DENSITY ORDER NO.

CASING & CEMENT (Attach Form 1002C)

TYPE	SIZE	WEIGHT	GRADE	FEET	PSI	SAX	TOP OF CMT
CONDUCTOR							
SURFACE							
INTERMEDIATE							
PRODUCTION	<b>6 5/8</b>			<b>995</b>			<b>UNKNOWN</b>
LINER							
							<b>1005</b>

PACKER @ \_\_\_\_\_ BRAND & TYPE \_\_\_\_\_ PLUG @ **970** TYPE **Cement** PLUG @ \_\_\_\_\_ TYPE \_\_\_\_\_  
PACKER @ \_\_\_\_\_ BRAND & TYPE \_\_\_\_\_ PLUG @ \_\_\_\_\_ TYPE \_\_\_\_\_ PLUG @ \_\_\_\_\_ TYPE \_\_\_\_\_  
TOTAL DEPTH **1005**

COMPLETION & TEST DATA BY PRODUCING FORMATION **459 PRMN**

FORMATION	<b>PERMIAN</b>						
SPACING & SPACING ORDER NUMBER							
CLASS: Oil, Gas, Dry, Inj, Disp, Comm Disp, Svc	<b>OIL</b>						
PERFORATED INTERVALS	<b>368-885 (0A)</b>						
ACID/VOLUME							
FRACTURE TREATMENT (Fluids/Prop Amounts)							

**RECEIVED**  
**OCT 07 2020**  
Oklahoma Corporation Commission

Min Gas Allowable (165:10-17-7)

Gas Purchaser/Measurer



OR

First Sales Date

INITIAL TEST DATA

Oil Allowable (165:10-13-3)

INITIAL TEST DATE	<b>UNKNOWN</b>						
OIL-BBL/DAY	<b>3</b>						
OIL-GRAVITY (API)	<b>22</b>						
GAS-MCF/DAY							
GAS-OIL RATIO CU FT/BBL							
WATER-BBL/DAY							
PUMPING OR FLOWING	<b>PUMPING</b>						
INITIAL SHUT-IN PRESSURE							
CHOKE SIZE							
FLOW TUBING PRESSURE							

A record of the formations drilled through, and pertinent remarks are presented on the reverse. I declare that I have knowledge of the contents of this report and am authorized by my organization to make this report, which was prepared by me or under my supervision and direction, with the data and facts stated herein to be true, correct, and complete to the best of my knowledge and belief.

**J. R. Laws**  
SIGNATURE

**JOHN R. LAWS**  
NAME (PRINT OR TYPE)

**5/5/20 580-220-8455**  
DATE PHONE NUMBER

**1515 WARD ROAD ARDMORE OK, 73401**  
ADDRESS CITY STATE ZIP

**JRLAWS@HOTMAIL.COM**  
EMAIL ADDRESS

PLEASE TYPE OR USE BLACK INK ONLY  
FORMATION RECORD

Give formation names and tops, if available, or descriptions and thickness of formations drilled through. Show intervals cored or drillstem tested.

NAMES OF FORMATIONS	TOP
SEE ORIGINAL	

LEASE NAME BOWERS WELL NO. 7

FOR COMMISSION USE ONLY	
ITD on file <input type="checkbox"/> YES <input type="checkbox"/> NO	
APPROVED _____	DISAPPROVED _____
2) Reject Codes	
_____	
_____	
_____	
_____	

Were open hole logs run?	yes	no <input checked="" type="checkbox"/>
Date Last log was run	_____	
Was CO <sub>2</sub> encountered?	yes	no <input checked="" type="checkbox"/> at what depths? _____
Was H <sub>2</sub> S encountered?	yes	no <input checked="" type="checkbox"/> at what depths? _____
Were unusual drilling circumstances encountered?	yes	no <input checked="" type="checkbox"/>
If yes, briefly explain below		

Other remarks:

THIS RECORD IS TO SHOW ACTUAL TRUE LOCATION  
AND CASING INFORMATION and Perforated Interval and  
Classification as oil

640 Acres

If more than three drainholes are proposed, attach a separate sheet indicating the necessary information.

Direction must be stated in degrees azimuth.  
Please note, the horizontal drainhole and its end point must be located within the boundaries of the lease or spacing unit.

Directional surveys are required for all drainholes and directional wells.

640 Acres

BOTTOM HOLE LOCATION FOR DIRECTIONAL HOLE

SEC	TWP	RGE	COUNTY
Spot Location			
1/4	1/4	1/4	1/4
Measured Total Depth		True Vertical Depth	BHL From Lease, Unit, or Property Line:

BOTTOM HOLE LOCATION FOR HORIZONTAL HOLE: (LATERALS)

LATERAL #1			
SEC	TWP	RGE	COUNTY
Spot Location			
1/4	1/4	1/4	1/4
Depth of Deviation		Radius of Turn	Direction
Measured Total Depth		True Vertical Depth	BHL From Lease, Unit, or Property Line:

LATERAL #2			
SEC	TWP	RGE	COUNTY
Spot Location			
1/4	1/4	1/4	1/4
Depth of Deviation		Radius of Turn	Direction
Measured Total Depth		True Vertical Depth	BHL From Lease, Unit, or Property Line:

LATERAL #3			
SEC	TWP	RGE	COUNTY
Spot Location			
1/4	1/4	1/4	1/4
Depth of Deviation		Radius of Turn	Direction
Measured Total Depth		True Vertical Depth	BHL From Lease, Unit, or Property Line: