

Oklahoma Corporation Commission  
Oil & Gas Conservation Division  
Post Office Box 52000  
Oklahoma City, Oklahoma 73152-2000  
Rule 165: 10-3-25

Form 1002A

API No.: 35019263020001

**Completion Report**

Spud Date: September 17, 2018

OTC Prod. Unit No.:

Drilling Finished Date: September 29, 2018

1st Prod Date: March 02, 2019

Completion Date: March 02, 2019

**Drill Type: STRAIGHT HOLE**

Well Name: HEWITT UNIT 22-6103

Purchaser/Measurer:

Location: CARTER 22 4S 2W  
SW SW SW SE  
265 FSL 298 FWL of 1/4 SEC  
Latitude: 34.187987 Longitude: -97.394613  
Derrick Elevation: 908 Ground Elevation: 893

First Sales Date:

Operator: XTO ENERGY INC 21003

22777 SPRINGWOODS VILLAGE PKWY  
SPRING, TX 77389-1425

Completion Type	
X	Single Zone
	Multiple Zone
	Commingled

Location Exception	
Order No	
There are no Location Exception records to display.	

Increased Density	
Order No	
There are no Increased Density records to display.	

Casing and Cement							
Type	Size	Weight	Grade	Feet	PSI	SAX	Top of CMT
CONDUCTOR	16	109	J-55	60			
SURFACE	8 5/8	24	J-55	640		250	SURFACE
PRODUCTION	5 1/2	15.5	K-55	4065		725	SURFACE

Liner								
Type	Size	Weight	Grade	Length	PSI	SAX	Top Depth	Bottom Depth
There are no Liner records to display.								

**Total Depth: 4065**

Packer	
Depth	Brand & Type
There are no Packer records to display.	

Plug	
Depth	Plug Type
There are no Plug records to display.	

Initial Test Data
-------------------

Test Date	Formation	Oil BBL/Day	Oil-Gravity (API)	Gas MCF/Day	Gas-Oil Ratio Cu FT/BBL	Water BBL/Day	Pumpin or Flowing	Initial Shut- In Pressure	Choke Size	Flow Tubing Pressure
Mar 11, 2019	HEWITT	190	35	80	420	245	PUMPING			

<b>Completion and Test Data by Producing Formation</b>					
Formation Name: HEWITT		Code: 405HWTT		Class: OIL	
<b>Spacing Orders</b>		<b>Perforated Intervals</b>			
<b>Order No</b>	<b>Unit Size</b>	<b>From</b>		<b>To</b>	
67990	UNIT	1707		3740	
<b>Acid Volumes</b>		<b>Fracture Treatments</b>			
16,600 GALLONS 15%		271,000 GALLONS 30 POUNDS GEL, 265,600 POUNDS 12/20 SAND, 36,600 POUNDS 16/30 SAND			

Formation	Top
UPPER BAYOU	1516
LIGNITE	1684
LOWER BAYOU	1716
CHUBBEE	2038
1C	2056
1B	2138
2A	2270
3A	2652
3C	2804
4C	3216
5TH SERIES	3486
TUSSY	3700

Were open hole logs run? Yes  
Date last log run: September 26, 2018

Were unusual drilling circumstances encountered? No  
Explanation:

<b>Other Remarks</b>
IRREGULAR SECTION

<b>FOR COMMISSION USE ONLY</b>	
Status: Accepted	1142360

API NO. 019-26302  
OTC PROD.  
UNIT NO.

PLEASE TYPE OR USE BLACK INK ONLY  
NOTE:

Attach copy of original 1002A  
if recompletion or reentry.

OKLAHOMA CORPORATION COMMISSION  
Oil & Gas Conservation Division  
Post Office Box 52000  
Oklahoma City, Oklahoma 73152-2000  
Rule 165:10-3-25

RECEIVED  
MAR 15 2019  
Oklahoma Corporation  
Commission

Form 1002A  
Rev. 2009

☒ ORIGINAL  
☐ AMENDED (Reason)

TYPE OF DRILLING OPERATION

☒ STRAIGHT HOLE ☐ DIRECTIONAL HOLE ☐ HORIZONTAL HOLE  
☐ SERVICE WELL

If directional or horizontal, see reverse for bottom hole location.

COUNTY	Carter	SEC	22	TWP	04S	RGE	02W
LEASE NAME	Hewitt Unit			WELL NO.	22-6103		
SW 1/4	SW 1/4	SW 1/4	SE 1/4	FSL OF 1/4 SEC	265	FWL OF 1/4 SEC	298
ELEVATION	908	Ground	893	Latitude (if known)	34.187987		
OPERATOR NAME	XTO Energy Inc.			OTC/OCC OPERATOR NO.	21003		
ADDRESS	210 Park Avenue, Suite 2350						
CITY	Oklahoma City	STATE	Oklahoma	ZIP	73102		

COMPLETION REPORT

SPUD DATE 9/17/2018  
DRLG FINISHED DATE 9/29/2018  
DATE OF WELL COMPLETION 3/2/2019  
1st PROD DATE 3/2/2019  
RECOMP DATE  
Longitude (if known) -97.394613

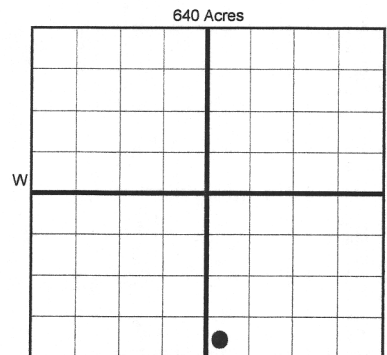

COMPLETION TYPE

☒ SINGLE ZONE  
☐ MULTIPLE ZONE  
Application Date  
☐ COMMINGLED  
Application Date  
LOCATION  
EXCEPTION ORDER  
INCREASED DENSITY  
ORDER NO.

CASING & CEMENT (Form 1002C must be attached)

TYPE	SIZE	WEIGHT	GRADE	FEET	PSI	SAX	TOP OF CMT
CONDUCTOR	16"	109	J-55	60			
SURFACE	8 5/8"	24	J-55	640		250	Surface
INTERMEDIATE							
PRODUCTION	5 1/2"	15.5	K-55	4,065		725	Surface
LINER							
				TOTAL DEPTH	4,065		

PACKER @ \_\_\_\_\_ BRAND & TYPE \_\_\_\_\_ PLUG @ \_\_\_\_\_ TYPE \_\_\_\_\_ PLUG @ \_\_\_\_\_ TYPE \_\_\_\_\_  
PACKER @ \_\_\_\_\_ BRAND & TYPE \_\_\_\_\_ PLUG @ \_\_\_\_\_ TYPE \_\_\_\_\_ PLUG @ \_\_\_\_\_ TYPE \_\_\_\_\_

COMPLETION & TEST DATA BY PRODUCING FORMATION

FORMATION	Hewitt Sands						
SPACING & SPACING ORDER NUMBER	67990 (unit)						
CLASS: Oil, Gas, Dry, Inj, Disp, Comm Disp, Svc	Oil						
PERFORATED INTERVALS	1707-3740 OA						
ACID/VOLUME	16,600 gals 15%						
FRACTURE TREATMENT (Fluids/Prop Amounts)	271,000 gals 30# gel						
	265,600#12/20 Sand						
	36,600#16/30 Sand						

Reported to Frac Focus

Min Gas Allowable (165:10-17-7)

Gas Purchaser/Measurer

First Sales Date

INITIAL TEST DATA

Oil Allowable (165:10-13-3)

INITIAL TEST DATE	3/11/2019						
OIL-BBL/DAY	190 BO						
OIL-GRAVITY (API)	35 API						
GAS-MCF/DAY	80 MCF						
GAS-OIL RATIO CU FT/BBL	420 SCF/BBL						
WATER-BBL/DAY	245 BW						
PUMPING OR FLOWING	Pumping						
INITIAL SHUT-IN PRESSURE	N/A						
CHOKE SIZE	N/A						
FLOW TUBING PRESSURE	N/A						

AS SUBMITTED

A record of the formations drilled through, and pertinent remarks are presented on the reverse. I declare that I have knowledge of the contents of this report and am authorized by my organization to make this report, which was prepared by me or under my supervision and direction, with the data and facts stated herein to be true, correct, and complete to the best of my knowledge and belief.

Debbie Waggoner  
SIGNATURE NAME (PRINT OR TYPE) 3/14/2019 405-319-3243  
210 Park Avenue, Suite 2350 Oklahoma City Ok 73102  
ADDRESS CITY STATE ZIP  
debbie\_waggoner@xtoenergy.com  
EMAIL ADDRESS

Give formation names and tops, if available, or descriptions and thickness of formations drilled through. Show intervals cored or drillstem tested.

WELL NO. 22-6103

NAMES OF FORMATIONS	TOP
Upper Bayou	1,516
Lignite	1,684
Lower Bayou	1716
Chubbee	2,038
1B	2,138
1C	2,056
2A	2,270
3A	2,652
3C	2,804
4C	3,216
5th Series	3,486
Tussy	3,700

FOR COMMISSION USE ONLY	
ITD on file	<input type="checkbox"/> YES <input type="checkbox"/> NO
APPROVED	DISAPPROVED
2) Reject Codes  <hr/> <hr/> <hr/> <hr/> <hr/>	

Were open hole logs run? X yes      no

Date Last log was run 9/26/2018

Was CO<sub>2</sub> encountered?      yes X no at what depths?                     

Was H<sub>2</sub>S encountered?      yes X no at what depths?                     

Were unusual drilling circumstances encountered?      yes X no

If yes, briefly explain below

Other remarks: Irregular Section

640 Acres

A 10x10 grid representing 640 acres. The grid is divided into four 5x5 quadrants by a thick black cross. The top-left quadrant is shaded light blue. The text '640 Acres' is centered at the top of the grid.

If more than three drainholes are proposed, attach a separate sheet indicating the necessary information.

Direction must be stated in degrees azimuth.  
Please note, the horizontal drainhole and its end point must be located within the boundaries of the lease or spacing unit.

Directional surveys are required for all drainholes and directional wells.

640 Acres

SEC	TWP	RGE	COUNTY			
Spot Location				Feet From 1/4 Sec Lines	FSL	FWL
1/4	1/4	1/4	1/4			
Measured Total Depth		True Vertical Depth		BHL From Lease, Unit, or Property Line:		

LATERAL #1						
SEC	TWP	RGE	COUNTY			
Spot Location						
1/4	1/4	1/4	1/4	Feet From 1/4 Sec Lines	FNL	FEL
Depth of Deviation		Radius of Turn		Direction	Total Length	
Measured Total Depth		True Vertical Depth		BHL From Lease, Unit, or Property Line:		

SEC	TWP	RGE	COUNTY			
Spot Location				Feet From 1/4 Sec Lines	FSL	FWL
1/4	1/4	1/4	1/4			
Depth of Deviation		Radius of Turn	Direction	Total Length		
Measured Total Depth		True Vertical Depth	BHL From Lease, Unit, or Property Line:			

SEC	TWP	RGE	COUNTY			
Spot Location						
1/4	1/4	1/4	1/4	Feet From 1/4 Sec Lines	FSL	FWL
Depth of Deviation		Radius of Turn		Direction	Total Length	
Measured Total Depth		True Vertical Depth		BHL From Lease, Unit, or Property Line:		