

Oklahoma Corporation Commission  
Oil & Gas Conservation Division  
Post Office Box 52000  
Oklahoma City, Oklahoma 73152-2000  
Rule 165: 10-3-25

Form 1002A

API No.: 35017500010001

**Completion Report**

Spud Date: August 09, 1963

OTC Prod. Unit No.:

Drilling Finished Date: September 02, 1963

**Amended**

1st Prod Date: September 07, 1963

Amend Reason: CONVERT TO INJECTION WELL

Completion Date: September 09, 1963

Recomplete Date: February 26, 2019

**Drill Type: STRAIGHT HOLE**

**SERVICE WELL**

Well Name: ALMA M BURGE 1

Purchaser/Measurer:

Location: CANADIAN 6 12N 8W  
C N2 SW SE  
990 FSL 660 FWL of 1/4 SEC  
Derrick Elevation: 1407 Ground Elevation: 1385

First Sales Date:

Operator: WILLIAMS REID OPERATING INC 18877

317 ORLEANS DR  
SHREVEPORT, LA 71106-6223

Completion Type		Location Exception		Increased Density	
X	Single Zone	Order No		Order No	
	Multiple Zone	There are no Location Exception records to display.		There are no Increased Density records to display.	
	Commingled				

Casing and Cement							
Type	Size	Weight	Grade	Feet	PSI	SAX	Top of CMT
SURFACE	8 5/8	24		567		350	SURFACE
PRODUCTION	4 1/2	11.6		8319		275	

Liner								
Type	Size	Weight	Grade	Length	PSI	SAX	Top Depth	Bottom Depth
There are no Liner records to display.								

**Total Depth: 8320**

Packer		Plug	
Depth	Brand & Type	Depth	Plug Type
8195	ARROW AS1-X	There are no Plug records to display.	

Initial Test Data
-------------------

Test Date	Formation	Oil BBL/Day	Oil-Gravity (API)	Gas MCF/Day	Gas-Oil Ratio Cu FT/BBL	Water BBL/Day	Pumpin or Flowing	Initial Shut- In Pressure	Choke Size	Flow Tubing Pressure
-----------	-----------	----------------	----------------------	----------------	----------------------------	------------------	----------------------	---------------------------------	---------------	-------------------------

There are no Initial Data records to display.

Completion and Test Data by Producing Formation

Formation Name: COTTAGE GROVE

Code: 405CGGV

Class: INJ

Spacing Orders	
Order No	Unit Size
There are no Spacing Order records to display.	

Perforated Intervals	
From	To
8231	8243

Acid Volumes	
750 GALLONS 12% FE	

Fracture Treatments	
There are no Fracture Treatments records to display.	

Formation	Top
UPPER TONKAWA SAND	7090
LOWER TONKAWA SAND	7490
COTTAGE GROVE SAND	8224

Were open hole logs run? Yes

Date last log run: August 31, 1963

Were unusual drilling circumstances encountered? No

Explanation:

Other Remarks

CONVERTED WELL FROM PRODUCER TO INJECTOR. RAN SUCCESSFUL TRACER SURVEY FEBRUARY 26, 2019, WITNESSED BY OCC FIELD. ARROW AS1-X SET AT 8,195'. OCC - UIC ORDER NUMBER 679942 EXCP - PERMIT NUMBER 1807220042

FOR COMMISSION USE ONLY

1142326

Status: Accepted

API NO. 017-50001  
OTC PROD.  
UNIT NO.

(PLEASE TYPE OR USE BLACK INK ONLY)

OKLAHOMA CORPORATION COMMISSION

Oil & Gas Conservation Division

Post Office Box 52000

Oklahoma City, Oklahoma 73152-2000

Rule 165:10-3-25

RECEIVED

Form 1002A

Rev. 2009

MAR 11 2019

OKLAHOMA CORPORATION COMMISSION

640 Acres

ORIGINAL  
☒ AMENDED (Reason)

CHANGE CLASS TO INJECTION WELL

COMPLETION REPORT

TYPE OF DRILLING OPERATION

☒ STRAIGHT HOLE ☐ DIRECTIONAL HOLE ☐ HORIZONTAL HOLE  
☒ SERVICE WELL

If directional or horizontal, see reverse for bottom hole location.

COUNTY	CANADIAN	SEC	6	TW	2N	RGE	8W	SPUD DATE	8/9/63
LEASE NAME	ALMA M BURGESS	WELL NO.	1	DATE OF WELL COMPLETION	9/9/63	1st PROD DATE	9/7/63	DRLG FINISHED DATE	9/2/63
ELEVATION	1407	Ground	1385	FSL OF 1/4 SEC	990	FWL OF 1/4 SEC	660	RECOMP DATE	7/26/19
OPERATOR NAME	REID WILLIAMS OPERATING, INC.	Latitude (if known)	35°32'N	Longitude (if known)	98°05'W	OTC / OCC OPERATOR NO.	19877		
ADDRESS	317 ORLEANS DR.								
CITY	SHREVEPORT	STATE	LA	ZIP	71106				

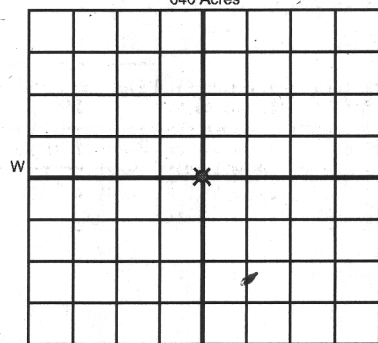

LOCATE WELL

COMPLETION TYPE

<input checked="" type="checkbox"/> SINGLE ZONE	
<input type="checkbox"/> MULTIPLE ZONE	
<input type="checkbox"/> COMMINGLED	
<input type="checkbox"/> LOCATION EXCEPTION	
<input type="checkbox"/> ORDER NO.	
<input type="checkbox"/> INCREASED DENSITY	
<input type="checkbox"/> ORDER NO.	

CASING & CEMENT (Attach Form 1002C)

TYPE	SIZE	WEIGHT	GRADE	FEET	PSI	SAX	TOP OF CMT
CONDUCTOR							
SURFACE	8 5/8	24		567		350	SURF
INTERMEDIATE							
PRODUCTION	4 1/2	11.6		8319		275	
LINER							

PACKER @ 8195 BRAND & TYPE ARROW ASI-X  
PACKER @ BRAND & TYPE  
PLUG @ TYPE  
PLUG @ TYPE  
PLUG @ TYPE

TOTAL DEPTH 8320

COMPLETION & TEST DATA BY PRODUCING FORMATION

705SCGGV

FORMATION	COTTAGE GROVE					No Frac
SPACING & SPACING	679942	(see remarks)				
ORDER NUMBER						
CLASS: Oil, Gas, Dry, Inj, Disp, Comm Disp, Svc	INT					
PERFORATED INTERVALS	8231-8243					
ACID/VOLUME	750 GAL 12% FE					
FRACTURE TREATMENT (Fluids/Prop Amounts)						

Min Gas Allowable (165:10-17-7)

Gas Purchaser/Measurer

☐ OR  
Oil Allowable (165:10-13-3)

First Sales Date

INITIAL TEST DATA

INITIAL TEST DATE						
OIL-BBL/DAY						
OIL-GRAVITY (API)						
GAS-MCF/DAY						
GAS-OIL RATIO CU FT/BBL						
WATER-BBL/DAY						
PUMPING OR FLOWING						
INITIAL SHUT-IN PRESSURE						
CHOKE SIZE						
FLOW TUBING PRESSURE						

AS SUBMITTED

A record of the formations drilled through, and pertinent remarks are presented on the reverse. I declare that I have knowledge of the contents of this report and am authorized by my organization to make this report, which was prepared by me or under my supervision and direction, with the data and facts stated herein to be true, correct, and complete to the best of my knowledge and belief.

SIGNATURE: WTH NAME (PRINT OR TYPE): REID WILLIAMS DATE: 3/7/2019 PHONE NUMBER: 318-869-0368  
ADDRESS: 317 ORLEANS DR CITY: SHREVEPORT STATE: LA ZIP: 71106 EMAIL ADDRESS: Reid.Williams@att.net

PLEASE TYPE OR USE BLACK INK ONLY

FORMATION RECORD

Give formation names and tops, if available, or descriptions and thickness of formations drilled through. Show intervals cored or drillstem tested.

NAMES OF FORMATIONS	TOP
U/TONKAWA SAND	7090
L/TONKAWA SAND	7490
COTTAGE GROVE SAND	8224

LEASE NAME ALMA M BURGE WELL NO. 1

FOR COMMISSION USE ONLY	
ITD on file <input type="checkbox"/> YES <input type="checkbox"/> NO	
APPROVED _____	DISAPPROVED _____
2) Reject Codes	

Were open hole logs run?	<input checked="" type="checkbox"/> yes <input type="checkbox"/> no
Date Last log was run	<u>8/31/1963</u>
Was CO <sub>2</sub> encountered?	<input type="checkbox"/> yes <input checked="" type="checkbox"/> no at what depths? _____
Was H <sub>2</sub> S encountered?	<input type="checkbox"/> yes <input checked="" type="checkbox"/> no at what depths? _____
Were unusual drilling circumstances encountered?	<input type="checkbox"/> yes <input type="checkbox"/> no
If yes, briefly explain below.	

Other remarks:

CONVERTED WELL FROM PRODUCER TO INJECTOR. RAN SUCCESSFUL TRACER SURVEY 2/26/19, WITNESSED BY OCC FIELD. ARROW ASI-X SET AT 8195'. OCC - UIC order #679942 EXCP - PERMIT 1807220042

640 Acres

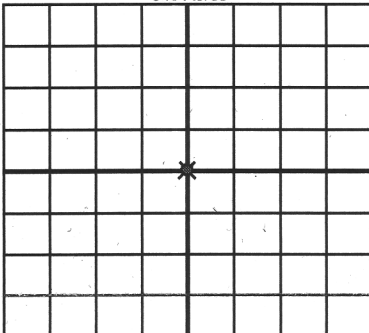

If more than three drainholes are proposed, attach a separate sheet indicating the necessary information.

Direction must be stated in degrees azimuth. Please note, the horizontal drainhole and its end point must be located within the boundaries of the lease or spacing unit.

Directional surveys are required for all drainholes and directional wells.

640 Acres

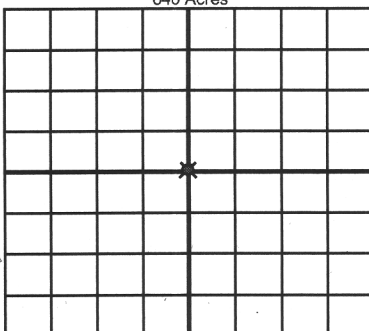

BOTTOM HOLE LOCATION FOR DIRECTIONAL HOLE

SEC	TWP	RGE	COUNTY
Spot Location			
1/4	1/4	1/4	1/4
Feet From 1/4 Sec Lines		FSL	FWL
Measured Total Depth		True Vertical Depth	BHL From Lease, Unit, or Property Line:

BOTTOM HOLE LOCATION FOR HORIZONTAL HOLE: (LATERALS)

LATERAL #1

SEC	TWP	RGE	COUNTY
Spot Location			
1/4	1/4	1/4	1/4
Feet From 1/4 Sec Lines		FSL	FWL
Depth of Deviation		Radius of Turn	Total Length
Measured Total Depth		True Vertical Depth	BHL From Lease, Unit, or Property Line:

LATERAL #2

SEC	TWP	RGE	COUNTY
Spot Location			
1/4	1/4	1/4	1/4
Feet From 1/4 Sec Lines		FSL	FWL
Depth of Deviation		Radius of Turn	Total Length
Measured Total Depth		True Vertical Depth	BHL From Lease, Unit, or Property Line:

LATERAL #3

SEC	TWP	RGE	COUNTY
Spot Location			
1/4	1/4	1/4	1/4
Feet From 1/4 Sec Lines		FSL	FWL
Depth of Deviation		Radius of Turn	Total Length
Measured Total Depth		True Vertical Depth	BHL From Lease, Unit, or Property Line: