

Oklahoma Corporation Commission
Oil & Gas Conservation Division
Post Office Box 52000
Oklahoma City, Oklahoma 73152-2000
Rule 165: 10-3-25

Form 1002A

API No.: 35125239580000

Completion Report

Spud Date: August 04, 2021

OTC Prod. Unit No.: 125-227512-0-0000

Drilling Finished Date: August 19, 2021

1st Prod Date: October 15, 2021

Completion Date: September 10, 2021

Drill Type: STRAIGHT HOLE

Min Gas Allowable: Yes

Well Name: BRAUM FARMS 1-9

Purchaser/Measurer: ENERGY TRANSFER

Location: POTTAWATOMIE 9 5N 3E
SW NE SW NW
1827 FNL 777 FWL of 1/4 SEC
Latitude: 34.92292 Longitude: -96.99893
Derrick Elevation: 941 Ground Elevation: 930

First Sales Date: 10/20/2021

Operator: O G P OPERATING INC 17901

8140 WALNUT HILL LANE STE 610
DALLAS, TX 75231-4336

Completion Type		Location Exception		Increased Density	
X	Single Zone	Order No		Order No	
	Multiple Zone	There are no Location Exception records to display.		There are no Increased Density records to display.	
	Commingled				

Casing and Cement							
Type	Size	Weight	Grade	Feet	PSI	SAX	Top of CMT
CONDUCTOR	16			60		10	
SURFACE	9 5/8	36		254		180	SURFACE
PRODUCTION	5 1/2	17	L-80	2760		110	2360

Liner								
Type	Size	Weight	Grade	Length	PSI	SAX	Top Depth	Bottom Depth
There are no Liner records to display.								

Total Depth: 4350

Packer		Plug	
Depth	Brand & Type	Depth	Plug Type
There are no Packer records to display.		2745	CIBP

Initial Test Data

Test Date	Formation	Oil BBL/Day	Oil-Gravity (API)	Gas MCF/Day	Gas-Oil Ratio Cu FT/BBL	Water BBL/Day	Pumpin or Flowing	Initial Shut-In Pressure	Choke Size	Flow Tubing Pressure
Nov 03, 2021	HOGSHOOTER	58	28.1			4	PUMPING	60		

Completion and Test Data by Producing Formation

Formation Name: LAYTON

Code: 405LYTN

Class: DRY

Spacing Orders

Order No	Unit Size
577026	160

Perforated Intervals

From	To
2772	2780

Acid Volumes

500 GALLONS 10%

Fracture Treatments

There are no Fracture Treatments records to display.
--

Formation Name: HOGSHOOTER

Code: 405HGSR

Class: OIL

Spacing Orders

Order No	Unit Size
577026	160

Perforated Intervals

From	To
2658	2668

Acid Volumes

1,320 GALLONS 15%

Fracture Treatments

16,500 POUNDS 20/40 SAND, 6,000 POUNDS 16/30 SAND, 429.8 BARRELS X-LINK

Formation	Top
BELLE CITY	2332
HOGSHOOTER	2652
UPPER LAYTON	2715
MIDDLE LAYTON	2764
CLEVELAND	2887
HUNTON	3451
SYLVAN	3742
VIOLA	3853
WILCOX	4231

Were open hole logs run? Yes

Date last log run: August 16, 2021

Were unusual drilling circumstances encountered? No

Explanation:

Other Remarks

There are no Other Remarks.

FOR COMMISSION USE ONLY

1147359

Status: Accepted

API NO. 35-125-23958
OTC PROD. UNIT NO. 125227512

Oil and Gas Conservation Division
P.O. Box 52000
Oklahoma City, OK 73152-2000
405-521-2331
OCCCentralProcessing@OCC.OK.GOV



OKLAHOMA
Corporation
Commission

Form 1002A
Rev. 2021

8 ORIGINAL
8 AMENDED (Reason)

Rule 165:10-3-25

COMPLETION REPORT

TYPE OF DRILLING OPERATION
☒ STRAIGHT HOLE ☐ DIRECTIONAL HOLE ☐ HORIZONTAL HOLE
☒ SERVICE WELL

If directional or horizontal, see reverse for bottom hole location.

COUNTY Pottawatomie SEC 9 TWP 5N RGE 3E

LEASE NAME BRAUN FARMS

SW 1/4 NE 1/4 SW 1/4 NW 1/4 E8L 843 FWL 777

ELEVATION 941 Ground 930 Latitude 34.92292 Longitude -96.99893

OPERATOR NAME OGP OPERATING, INC.

OTC / OCC OPERATOR NO. 17901

ADDRESS 8140 WALNUT HILL LANE, SUITE 610

CITY DALLAS STATE TX ZIP 75231

SPUD DATE 08/12/21

DRLG FINISHED DATE 08/19/21

DATE OF WELL COMPLETION 09/10/21

1st PROD DATE 10/15/21

RECOMP DATE

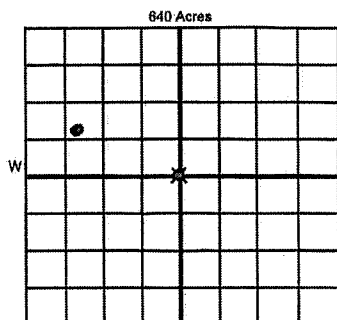

LOCATE WELL

COMPLETION TYPE

☒ SINGLE ZONE
☐ MULTIPLE ZONE
☐ COMMINGLED
LOCATION EXCEPTION ORDER NO.
MULTIUNIT ORDER NO.
INCREASED DENSITY ORDER NO.

CASING & CEMENT (Attach Form 1002C)

TYPE	SIZE	WEIGHT	GRADE	FEET	PSI	SAX	TOP OF CMT
CONDUCTOR	16			60'		10	
SURFACE	9 5/8	36		254'		180	SURFACE
INTERMEDIATE							
PRODUCTION	5 1/2	17	L-80	2760'		110	2360
LINER							

PACKER @ BRAND & TYPE PLUG @ 2745' TYPE CIBP PLUG @ TYPE TOTAL DEPTH 4350'

COMPLETION & TEST DATA BY PRODUCING FORMATION 405LVTN 405H6SR

FORMATION	(LOWER) LAYTON	HOGSHOOTER					
SPACING & SPACING ORDER NUMBER	160/577026	160/577026					
CLASS: Oil, Gas, Dry, Inj, Disp, Comm Disp, Svc	Dry	Oil					
PERFORATED INTERVALS	2772'-2780'	2658'-2668'					
ACID/VOLUME	10% / 500 GAL	15% / 1320 GAL					
FRACTURE TREATMENT (Fluids/Prop Amounts)		16,500LB 20/40 SAND 6000LB 16/30 SAND 429.8 BBLS X-LINK					

Monitor Report
to Free Focus

RECEIVED

DEC 21 2021

OKLAHOMA CORPORATION
COMMISSION

☒ Min Gas Allowable (165:10-17-7)
OR
☐ Oil Allowable (165:10-13-3)

Purchaser/Measurer
First Sales Date

ENERGY TRANSFER
10-20-21

INITIAL TEST DATA

INITIAL TEST DATE	11-3-21				
OIL-BBL/DAY	58				
OIL-GRAVITY (API)	28.1				
GAS-MCF/DAY	TSTM				
GAS-OIL RATIO CU FT/BBL	0				
WATER-BBL/DAY	4				
PUMPING OR FLOWING	PUMPING				
INITIAL SHUT-IN PRESSURE	60				
CHOKE SIZE					
FLOW TUBING PRESSURE					

A record of the formations drilled through, and pertinent remarks are presented on the reverse. I declare that I have knowledge of the contents of this report and am authorized by my organization to make this report, which was prepared by me or under my supervision and direction, with the data and facts stated herein to be true, correct, and complete to the best of my knowledge and belief.

SIGNATURE

DAVID G. BURNS
NAME (PRINT OR TYPE)

12-8-21 214-146-2333
DATE PHONE NUMBER

8140 WALNUT HILL LANE SUITE 610

DALLAS TX 75231

DAVID.BURNS@OGPENERGY.COM

ADDRESS

CITY

STATE

ZIP

EMAIL ADDRESS

PLEASE TYPE OR USE BLACK INK ONLY
FORMATION RECORD

Give formation names and tops, if available, or descriptions and thickness of formations drilled through. Show intervals cored or drillstem tested.

NAMES OF FORMATIONS	TOP
BELLE CITY	2332
HOGSHOOTER	2652
UPPER LAYTON	2715
MIDDLE LAYTON	2764
CLEVELAND	2887
HUNTON	3451
SYLVAN	3742
VIOLA	3853
WILCOX	4231

LEASE NAME _____ WELL NO. _____

FOR COMMISSION USE ONLY	
ITD on file <input type="checkbox"/> YES <input type="checkbox"/> NO	
APPROVED _____ DISAPPROVED _____	2) Reject Codes _____

Were open hole logs run?	<input checked="" type="radio"/> yes <input type="radio"/> no
Date Last log was run	8-16-2021
Was CO ₂ encountered?	<input type="radio"/> yes <input checked="" type="radio"/> no at what depths? _____
Was H ₂ S encountered?	<input type="radio"/> yes <input checked="" type="radio"/> no at what depths? _____
Were unusual drilling circumstances encountered? If yes, briefly explain below	<input type="radio"/> yes <input checked="" type="radio"/> no

Other remarks: _____

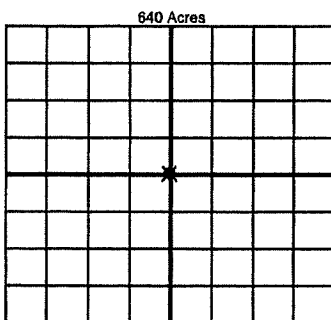

If more than three drainholes are proposed, attach a separate sheet indicating the necessary information.

Direction must be stated in degrees azimuth. Please note, the horizontal drainhole and its end point must be located within the boundaries of the lease or spacing unit.

Directional surveys are required for all drainholes and directional wells

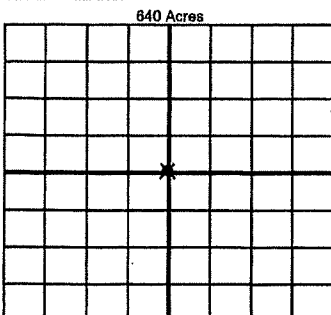

BOTTOM HOLE LOCATION FOR DIRECTIONAL HOLE

SEC	TWP	RGE	COUNTY
1/4	1/4	1/4	1/4
Measured Total Depth		True Vertical Depth	Feet From 1/4 Sec Lines BHL From Lease, Unit, or Property Line:

BOTTOM HOLE LOCATION FOR HORIZONTAL HOLE: (LATERALS)

LATERAL #1			
SEC	TWP	RGE	COUNTY
1/4	1/4	1/4	1/4
Depth of Deviation		Radius of Turn	Direction
Measured Total Depth		True Vertical Depth	Total Length
		BHL From Lease, Unit, or Property Line:	

LATERAL #2			
SEC	TWP	RGE	COUNTY
1/4	1/4	1/4	1/4
Depth of Deviation		Radius of Turn	Direction
Measured Total Depth		True Vertical Depth	Total Length
		BHL From Lease, Unit, or Property Line:	

LATERAL #3			
SEC	TWP	RGE	COUNTY
1/4	1/4	1/4	1/4
Depth of Deviation		Radius of Turn	Direction
Measured Total Depth		True Vertical Depth	Total Length
		BHL From Lease, Unit, or Property Line:	