

Oklahoma Corporation Commission  
Oil & Gas Conservation Division  
Post Office Box 52000  
Oklahoma City, Oklahoma 73152-2000  
Rule 165: 10-3-25

Form 1002A

API No.: 35081243240000

**Completion Report**

Spud Date: December 09, 2021

OTC Prod. Unit No.:

Drilling Finished Date: December 15, 2021

1st Prod Date:

Completion Date: December 15, 2021

**Drill Type: STRAIGHT HOLE**

Well Name: R Z 1

Purchaser/Measurer:

Location: LINCOLN 8 16N 5E  
C SE NW  
1980 FNL 1980 FWL of 1/4 SEC  
Latitude: 35.878576222 Longitude: -96.799025411  
Derrick Elevation: 1046 Ground Elevation: 1040

First Sales Date:

Operator: NAIFCO OIL & GAS LLC 21651  
PO BOX 75467  
304 N MERIDIAN AVE STE 14  
OKLAHOMA CITY, OK 73107-0467

Completion Type		Location Exception		Increased Density	
	Single Zone	Order No		Order No	
	Multiple Zone	There are no Location Exception records to display.		There are no Increased Density records to display.	
	Commingled				

Casing and Cement							
Type	Size	Weight	Grade	Feet	PSI	SAX	Top of CMT
SURFACE	8 5/8			1055		520	SURFACE

Liner								
Type	Size	Weight	Grade	Length	PSI	SAX	Top Depth	Bottom Depth
There are no Liner records to display.								

**Total Depth: 3549**

Packer		Plug	
Depth	Brand & Type	Depth	Plug Type
There are no Packer records to display.		There are no Plug records to display.	

Initial Test Data										
Test Date	Formation	Oil BBL/Day	Oil-Gravity (API)	Gas MCF/Day	Gas-Oil Ratio Cu FT/BBL	Water BBL/Day	Pumpin or Flowing	Initial Shut-In Pressure	Choke Size	Flow Tubing Pressure
There are no Initial Data records to display.										
Completion and Test Data by Producing Formation										

Formation Name: NONE	Code: 999NONE	Class: DRY
----------------------	---------------	------------

Formation	Top
CLEVELAND	2892
OSWEGO	3444
PRUE	3540

Were open hole logs run? Yes  
Date last log run: December 15, 2021  
Were unusual drilling circumstances encountered? No  
Explanation:

Other Remarks
There are no Other Remarks.

FOR COMMISSION USE ONLY	
Status: Accepted	1147383

081-24324

API NO. 08124324  
 OTC PROD.  
 UNIT NO.

Oil and Gas Conservation Division  
 P.O. Box 52000  
 Oklahoma City, OK 73152-2000  
 405-521-2331  
 OCCCentralProcessing@OCC.OK.GOV



**OKLAHOMA**  
 Corporation  
 Commission

Form 1002A  
 Rev. 2021

☒ ORIGINAL  
☐ AMENDED (Reason) \_\_\_\_\_

Rule 165:10-3-26

## COMPLETION REPORT

## TYPE OF DRILLING OPERATION

☒ STRAIGHT HOLE ☐ DIRECTIONAL HOLE ☐ HORIZONTAL HOLE  
☐ SERVICE WELL

If directional or horizontal, see reverse for bottom hole location.

COUNTY	Lincoln	SEC	8	TWP	16N	RGE	5E
LEASE NAME	R 2	WELL NO.	1	DATE OF WELL COMPLETION	12-15-21	1st PROD DATE	-
1/4	C 1/4 SE 1/4 NW 1/4	FWL	1980	RECOMP DATE	-		
ELEVATION	Derrick FL 1046	Ground	1040	Latitude	35° 52' 42.87440 N	Longitude	96° 47' 56.59148 W
OPERATOR NAME	Naifro Oil & Gas LLC			OTC / OCC OPERATOR NO.	21651		
ADDRESS	P.O. Box 197						
CITY	Davenport	STATE	OK	ZIP	74026		

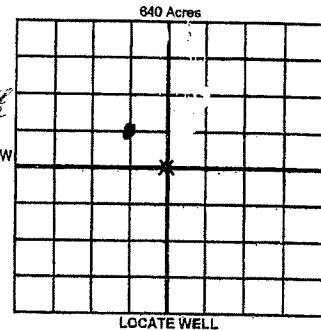

## COMPLETION TYPE

<input type="checkbox"/> SINGLE ZONE	
<input checked="" type="checkbox"/> MULTIPLE ZONE	NA
<input type="checkbox"/> COMMINGLED	
<input type="checkbox"/> LOCATION EXCEPTION	
<input type="checkbox"/> ORDER NO.	
<input type="checkbox"/> MULTUNIT ORDER NO.	
<input type="checkbox"/> INCREASED DENSITY	
<input type="checkbox"/> ORDER NO.	

## CASING &amp; CEMENT (Attach Form 1002C)

TYPE	SIZE	WEIGHT	GRADE	FEET	PSI	SAX	TOP OF CMT
CONDUCTOR							
SURFACE	8 3/4			1055		520	Circ to surface
INTERMEDIATE							
PRODUCTION							
LINER							

PACKER @ \_\_\_\_\_ BRAND & TYPE \_\_\_\_\_ PLUG @ \_\_\_\_\_ TYPE \_\_\_\_\_ PLUG @ \_\_\_\_\_ TYPE \_\_\_\_\_ TOTAL DEPTH 3640  
 PACKER @ \_\_\_\_\_ BRAND & TYPE \_\_\_\_\_ PLUG @ \_\_\_\_\_ TYPE \_\_\_\_\_ PLUG @ \_\_\_\_\_ TYPE \_\_\_\_\_

## COMPLETION &amp; TEST DATA BY PRODUCING FORMATION

FORMATION	Dry Hole					
SPACING & SPACING						
ORDER NUMBER						
CLASS: Oil, Gas, Dry, Inj, Disp, Comm Disp, Svc	Dry					
PERFORATED INTERVALS						
ACID/VOLUME						
FRACTURE TREATMENT (Fluids/Prop Amounts)						

RECEIVED

DEC 8 2021

OKLAHOMA CORPORATION  
COMMISSION

Min Gas Allowable (165:10-17-7)

OR

Oil Allowable (165:10-13-3)

Purchaser/Measurer

First Sales Date

## INITIAL TEST DATA

INITIAL TEST DATE					
OIL-BBL/DAY					
OIL-GRAVITY (API)					
GAS-MCF/DAY					
GAS-OIL RATIO CU FT/BBL					
WATER-BBL/DAY					
PUMPING OR FLOWING					
INITIAL SHUT-IN PRESSURE					
CHOKE SIZE					
FLOW TUBING PRESSURE					

A record of the formations drilled through, and pertinent remarks are presented on the reverse. I declare that I have knowledge of the contents of this report and am authorized by my organization to make this report, which was prepared by me or under my supervision and direction, with the data and facts stated herein to be true, correct, and complete to the best of my knowledge and belief.

J. Wade Waldman J. Wade Waldman 12-25-21 918-377-2331  
 SIGNATURE NAME (PRINT OR TYPE) DATE PHONE NUMBER  
P.O. Box 197 Davenport OK 74026  
 ADDRESS CITY STATE ZIP  
 EMAIL ADDRESS

PLEASE TYPE OR USE BLACK INK ONLY  
FORMATION RECORD

Give formation names and tops, if available, or descriptions and thickness of formations drilled through. Show intervals cored or drillstem tested.

NAMES OF FORMATIONS	TOP
Cleveland	2852
Oswego	3444
Pine	3540

LEASE NAME

R 2

WELL NO.

1

FOR COMMISSION USE ONLY

ITD on file ☐ YES ☐ NO

APPROVED DISAPPROVED

2) Reject Codes

Were open hole logs run?

☒ yes ☐ no

Date Last log was run

12-15-21

Was CO<sub>2</sub> encountered?

☐ yes ☒ no at what depths?

Was H<sub>2</sub>S encountered?

☐ yes ☒ no at what depths?

Were unusual drilling circumstances encountered?

☐ yes ☒ no

If yes, briefly explain below

Other remarks:

640 Acres

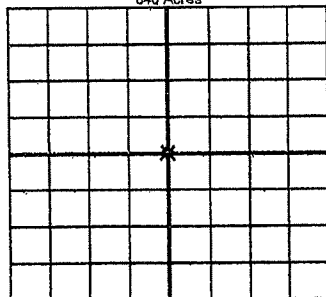

If more than three drainholes are proposed, attach a separate sheet indicating the necessary information.

Direction must be stated in degrees azimuth. Please note, the horizontal drainhole and its end point must be located within the boundaries of the lease or spacing unit.

Directional surveys are required for all drainholes and directional wells.

640 Acres

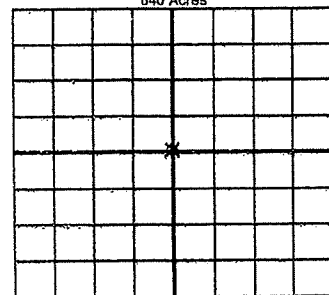

BOTTOM HOLE LOCATION FOR DIRECTIONAL HOLE

SEC	TWP	RGE	COUNTY
1/4	1/4	1/4	1/4
Measured Total Depth	True Vertical Depth	BHL From Lease, Unit, or Property Line:	

BOTTOM HOLE LOCATION FOR HORIZONTAL HOLE: (LATERALS)

SEC	TWP	RGE	COUNTY
1/4	1/4	1/4	1/4
Depth of Deviation	Radius of Turn	Direction	Total Length
Measured Total Depth	True Vertical Depth	BHL From Lease, Unit, or Property Line:	

SEC	TWP	RGE	COUNTY
1/4	1/4	1/4	1/4
Depth of Deviation	Radius of Turn	Direction	Total Length
Measured Total Depth	True Vertical Depth	BHL From Lease, Unit, or Property Line:	

SEC	TWP	RGE	COUNTY
1/4	1/4	1/4	1/4
Depth of Deviation	Radius of Turn	Direction	Total Length
Measured Total Depth	True Vertical Depth	BHL From Lease, Unit, or Property Line:	