

Oklahoma Corporation Commission
Oil & Gas Conservation Division
Post Office Box 52000
Oklahoma City, Oklahoma 73152-2000
Rule 165: 10-3-25

Form 1002A

API No.: 35139013790001

Completion Report

Spud Date: April 13, 1944

OTC Prod. Unit No.: 139-020068-0-0000

Drilling Finished Date: June 03, 1944

Amended

1st Prod Date: June 09, 1944

Amend Reason: RECOMPLETION (FRAC)

Completion Date: June 09, 1944

Recomplete Date: February 20, 2019

Drill Type: STRAIGHT HOLE

Well Name: MILLER 1

Purchaser/Measurer:

Location: TEXAS 22 5N 15E CM
NW NW NW SE
2535 FSL 2520 FEL of 1/4 SEC
Latitude: 36.88461 Longitude: -101.42356
Derrick Elevation: 3138 Ground Elevation: 3133

First Sales Date:

Operator: SCOUT ENERGY MANAGEMENT LLC 23138

4901 LBJ FWY STE 300
DALLAS, TX 75244-6107

Completion Type		Location Exception		Increased Density	
X	Single Zone	Order No		Order No	
	Multiple Zone	There are no Location Exception records to display.		There are no Increased Density records to display.	
	Commingled				

Casing and Cement							
Type	Size	Weight	Grade	Feet	PSI	SAX	Top of CMT
SURFACE	10.75	32.75	8RD	532	1000	325	SURFACE
PRODUCTION	7	24	10V	2678	1000	1000	SURFACE

Liner								
Type	Size	Weight	Grade	Length	PSI	SAX	Top Depth	Bottom Depth
LINER	5.5	14		160	0	0	2650	2810

Total Depth: 2810

Packer		Plug	
Depth	Brand & Type	Depth	Plug Type
2620	PACKER	2810	PBTD

Initial Test Data

Test Date	Formation	Oil BBL/Day	Oil-Gravity (API)	Gas MCF/Day	Gas-Oil Ratio Cu FT/BBL	Water BBL/Day	Pumpin or Flowing	Initial Shut-In Pressure	Choke Size	Flow Tubing Pressure
Feb 21, 2019	GUYMON-HUGOTON			245			FLOWING	907	16/64	90

Completion and Test Data by Producing Formation

Formation Name: GUYMON-HUGOTON

Code: 451GYHG

Class: GAS

Spacing Orders

Order No	Unit Size
17867	640

Perforated Intervals

From	To
There are no Perf. Intervals records to display.	

Acid Volumes

1,000 GALLONS 15% HCL

Fracture Treatments

51,000 POUNDS 16/30 SAND WITH 444 BARRELS WATER, 75 QUALITY FOAM
--

Formation	Top
HERINGTON	2660
KRIDER	2750
WINFIELD	2755
TOWANDA	2814

Were open hole logs run? No

Date last log run:

Were unusual drilling circumstances encountered? No

Explanation:

Other Remarks

OCC - THIS WELL IS AN OPEN HOLE COMPLETION FROM BOTTOM OF THE 7" CASING AT 2,678' TO TOTAL DEPTH AT 2,810'. THE PRODUCTION IS THROUGH A 5 1/2" SLOTTED LINER TO 2,810'.

FOR COMMISSION USE ONLY

1142409

Status: Accepted

API NO. 139-01379
OTC PROD. UNIT NO. 139-020068

(PLEASE TYPE OR USE BLACK INK ONLY)

OKLAHOMA CORPORATION COMMISSION

Oil & Gas Conservation Division

Post Office Box 52000

Oklahoma City, Oklahoma 73152-2000

Rule 165:10-3-25

RECEIVED

MAR 25 2019

OKLAHOMA CORPORATION COMMISSION

Form 1002A

Rev. 2009

☐ ORIGINAL
☒ AMENDED (Reason)

Recompletion (Frac)

COMPLETION REPORT

TYPE OF DRILLING OPERATION
☒ STRAIGHT HOLE ☐ DIRECTIONAL HOLE ☐ HORIZONTAL HOLE
☐ SERVICE WELL
If directional or horizontal, see reverse for bottom hole location.

SPUD DATE 04/13/1944
DRLG FINISHED DATE 06/03/1944
DATE OF WELL COMPLETION 06/09/1944
1st PROD DATE 6-9-1944
RECOMP DATE 02/20/2019
Longitude (if known) -101.42356

COUNTY Texas SEC 22 TWP 5N RGE 15ECM

LEASE NAME Miller

NW 1/4 NW 1/4 SE 1/4 1/4

ELEVATION 3138' Ground 3133' FSL 2535 FEL OF 150' from 1/4 SEC Center 2520

Latitude (if known) 36.88461

OPERATOR NAME Scout Energy Management LLC

ADDRESS 4901 LBJ Freeway, Ste 300

CITY Dallas STATE TX ZIP 75244

OTC/OCC OPERATOR NO. 23138

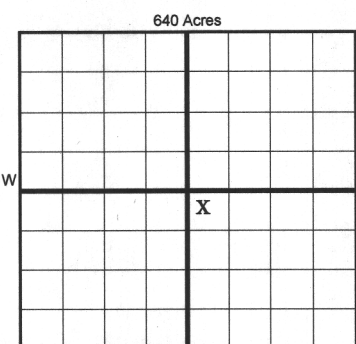

LOCATE WELL

COMPLETION TYPE

☒ SINGLE ZONE
☐ MULTIPLE ZONE
Application Date
COMMINGLED
Application Date
LOCATION EXCEPTION
ORDER NO.
INCREASED DENSITY
ORDER NO.

CASING & CEMENT (Form 1002C must be attached)

TYPE	SIZE	WEIGHT	GRADE	FEET	PSI	SAX	TOP OF CMT
CONDUCTOR							
SURFACE	10.75	32.75	8rd	532'	1000	325	Surface
INTERMEDIATE							
PRODUCTION	7	24	10v	2678'	1000	1000	Surface
SLOTTED LINER	5.5	14		2650' - 2810'			

PACKER @ 2620' BRAND & TYPE

PLUG @ TYPE

PACKER @ BRAND & TYPE

PLUG @ TYPE

TOTAL DEPTH 2810'

PBTD: 2810'

COMPLETION & TEST DATA BY PRODUCING FORMATION

FORMATION	(Chase) Guyman - Hugoton	Reported to Frac Focus
SPACING & SPACING ORDER NUMBER	17867 (640)	
CLASS: Oil, Gas, Dry, Inj, Disp, Comm Disp, Svc	Gas	
PERFORATED INTERVALS	2650'-2810' slotted liner 2684'-2810' open hole	All open hole
ACID/VOLUME	1000 gal. 15% HCl	
FRACTURE TREATMENT (Fluids/Prop Amounts)	51,000# 16/30 sand w/ 444 bbls wtr, 75 quality foam	

Min Gas Allowable (165:10-17-7)

Gas Purchaser/Measurer



OR

First Sales Date

INITIAL TEST DATA

Oil Allowable (165:10-13-3)

INITIAL TEST DATE	02/21/2019
OIL-BBL/DAY	0
OIL-GRAVITY (API)	NA
GAS-MCF/DAY	245
GAS-OIL RATIO CU FT/BBL	NA
WATER-BBL/DAY	0
PUMPING OR FLOWING	Flowing
INITIAL SHUT-IN PRESSURE	907
CHOKE SIZE	16/64
FLOW TUBING PRESSURE	90

AS SUBMITTED

A record of the formations drilled through, and pertinent remarks are presented on the reverse. I declare that I have knowledge of the contents of this report and am authorized by my organization to make this report, which was prepared by me or under my supervision and direction, with the data and facts stated herein to be true, correct, and complete to the best of my knowledge and belief.

Signature of Emily J. Van Der Gryp

NAME (PRINT OR TYPE) Emily J. Van Der Gryp

DATE 03/22/2019 (972) 325-1146

4901 LBJ Freeway, Ste 300

Dallas

TX

75244

evandergryp@scoutep.com

ADDRESS

CITY

STATE

ZIP

EMAIL ADDRESS

FORMATION RECORD

LEASE NAME Miller WELL NO. 1

NAMES OF FORMATIONS	TOP
Herrington	2660
Krider	2750
Winfield	2755
Towanda	2814
TD:	2810

FOR COMMISSION USE ONLY		
ITD on file	<input type="checkbox"/> YES	<input type="checkbox"/> NO
APPROVED	DISAPPROVED	2) Reject Codes

Were open hole logs run? yes X no

Date Last log was run _____

Was CO₂ encountered? yes X no at what depths? _____

Was H₂S encountered? yes X no at what depths? _____

Were unusual drilling circumstances encountered? yes X no

If yes, briefly explain below

Other remarks: OCC - This well is an open hole completion from bottom of the 7" casing at 2678' to total depth at 2810'. The production is thru a 5 1/2" slotted liner to 2810'.

640 Acres

640 Acres

SEC	TWP	RGE	COUNTY		
Spot Location					
1/4	1/4	1/4	1/4	Feet From 1/4 Sec Lines	FSL
Measured Total Depth		True Vertical Depth	BHL From Lease, Unit, or Property Line:		

LATERAL #1						
SEC	TWP	RGE	COUNTY			
Spot Location						
1/4			1/4	1/4	Feet From 1/4 Sec Lines	FSL
Depth of Deviation			Radius of Turn	Direction	Total Length	
Measured Total Depth			True Vertical Depth	BHL From Lease, Unit, or Property Line:		

SEC	TWP	RGE	COUNTY
Spot Location			
1/4	1/4	1/4	1/4
Feet From 1/4 Sec Lines		FSL	FWL
Depth of Deviation	Radius of Turn	Direction	Total Length
Measured Total Depth		True Vertical Depth	
BHL From Lease, Unit, or Property Line:			

SEC	TWP	RGE	COUNTY
Spot Location			
1/4	1/4	1/4	1/4
Feet From 1/4 Sec Lines		FSL	FWL
Depth of Deviation	Radius of Turn	Direction	Total Length
Measured Total Depth		True Vertical Depth	BHL From Lease, Unit, or Property Line:

SCANNED