

Oklahoma Corporation Commission
Oil & Gas Conservation Division
Post Office Box 52000
Oklahoma City, Oklahoma 73152-2000
Rule 165: 10-3-25

Form 1002A

API No.: 35139009290001

Completion Report

Spud Date: October 13, 1944

OTC Prod. Unit No.: 139-020106

Drilling Finished Date: November 05, 1944

1st Prod Date: November 24, 1944

Amended

Completion Date: November 08, 1944

Amend Reason: RECOMPLETION (FRAC)

Recomplete Date: January 18, 2019

Drill Type: STRAIGHT HOLE

Well Name: CHENAULT, M. M. 1

Purchaser/Measurer:

Location: TEXAS 2 3N 14E CM
SW SW SW NE
2595 FNL 2485 FEL of 1/4 SEC
Latitude: 36.755306 Longitude: -101.519056
Derrick Elevation: 3190 Ground Elevation: 3103

First Sales Date:

Operator: SCOUT ENERGY MANAGEMENT LLC 23138

4901 LBJ FWY STE 300
DALLAS, TX 75244-6107

Completion Type		Location Exception		Increased Density	
X	Single Zone	Order No		Order No	
	Multiple Zone	There are no Location Exception records to display.		There are no Increased Density records to display.	
	Commingled				

Casing and Cement							
Type	Size	Weight	Grade	Feet	PSI	SAX	Top of CMT
SURFACE	10.75	32.75	8V	432	1000	300	SURFACE
PRODUCTION	7	24	8RD	2613	1000	1000	SURFACE

Liner								
Type	Size	Weight	Grade	Length	PSI	SAX	Top Depth	Bottom Depth
LINER	5.5	14		152	0	0	2579	2731

Total Depth: 2731

Packer		Plug	
Depth	Brand & Type	Depth	Plug Type
2570	PACKER	2731	PBTD

Initial Test Data

Test Date	Formation	Oil BBL/Day	Oil-Gravity (API)	Gas MCF/Day	Gas-Oil Ratio Cu FT/BBL	Water BBL/Day	Pumpin or Flowing	Initial Shut-In Pressure	Choke Size	Flow Tubing Pressure
Feb 19, 2019	GUYMON-HUGOTON			92			FLOWING	1678	WIDE	8

Completion and Test Data by Producing Formation

Formation Name: GUYMON-HUGOTON

Code: 451GYHG

Class: GAS

Spacing Orders

Order No	Unit Size
17867	640

Perforated Intervals

From	To
There are no Perf. Intervals records to display.	

Acid Volumes

1,000 GALLONS 15% HCL

Fracture Treatments

51,000 POUNDS 16/30 SAND WITH 444 BARRELS WATER, 75 QUALITY FOAM
--

Formation	Top
HERINGTON	2579
KRIDER	2599
WINFIELD	2674
TOWANDA	2725

Were open hole logs run? No

Date last log run:

Were unusual drilling circumstances encountered? No

Explanation:

Other Remarks

OCC - THIS WELL IS AN OPEN HOLE COMPLETION FROM BOTTOM OF THE 7" CASING AT 2,613' TO TOTAL DEPTH AT 2,731'. THE PRODUCTION IS THROUGH A 5 1/2" SLOTTED LINER.

FOR COMMISSION USE ONLY

1142405

Status: Accepted

RECEIVED

Form 1002A

Rev. 2009

MAR 25 2019

OKLAHOMA CORPORATION COMMISSION

API NO. 139-00929
 OTC PROD. UNIT NO. 139-020106

(PLEASE TYPE OR USE BLACK INK ONLY)

OKLAHOMA CORPORATION COMMISSION

Oil & Gas Conservation Division

Post Office Box 52000

Oklahoma City, Oklahoma 73152-2000

Rule 165:10-3-25

☐ ORIGINAL
☒ AMENDED (Reason)

Recompletion (Frac)

COMPLETION REPORT

TYPE OF DRILLING OPERATION
☒ STRAIGHT HOLE ☐ DIRECTIONAL HOLE ☐ HORIZONTAL HOLE
☐ SERVICE WELL

If directional or horizontal, see reverse for bottom hole location.

COUNTY **Texas** SEC **2** TWP **3N** RGE **14ECM**
 LEASE NAME **Chenault, M. M.** WELL NO. **1**
 SW 1/4 SW 1/4 NE 1/4 1/4 **2595** **2485**
 ELEVATION **3190'** Ground **3103'** Latitude (if known) **36.755306** Longitude (if known) **-101.519056**
 OPERATOR NAME **Scout Energy Management LLC** OTC/OCC OPERATOR NO. **23138**
 ADDRESS **4901 LBJ Freeway, Ste 300**
 CITY **Dallas** STATE **TX** ZIP **75244**

SPUD DATE **10/13/1944**
 DRLG FINISHED DATE **11/05/1944**
 DATE OF WELL COMPLETION **11/08/1944**
 1st PROD DATE **11-24-1944**
 RECOMP DATE **01/18/2019**
 Longitude (if known) **-101.519056**

640 Acres

LOCATE WELL

COMPLETION TYPE

☒ SINGLE ZONE
☐ MULTIPLE ZONE
☐ COMMINGLED
☐ LOCATION EXCEPTION
☐ ORDER NO.
☐ INCREASED DENSITY
☐ ORDER NO.

CASING & CEMENT (Form 1002C must be attached)

TYPE	SIZE	WEIGHT	GRADE	FEET	PSI	SAX	TOP OF CMT
CONDUCTOR							
SURFACE	10.75	32.75	8V	432'	1000	300	Surface
INTERMEDIATE							
PRODUCTION	7	24	8 rd	2613'	1000	1000	Surface
SLOTTED LINER	5.5	14		2579' - 2731'			
				TOTAL DEPTH			2731'

PACKER @ **2570'** BRAND & TYPE
 PACKER @ BRAND & TYPE

PLUG @ TYPE PLUG @ TYPE
 PLUG @ TYPE PLUG @ TYPE

TOTAL DEPTH 2731'

PBTD: 2731'

COMPLETION & TEST DATA BY PRODUCING FORMATION

FORMATION **(Chase) Geymon - Hugoton**
 SPACING & SPACING ORDER NUMBER **17867 (640)**
 CLASS: Oil, Gas, Dry, Inj, Disp, Comm Disp, Svc **Gas**
 PERFORATED INTERVALS **2579'-2731' slotted liner - open hole**
2613'-2731' open hole
 ACID/VOLUME **1000 gal. 15% HCl**
 FRACTURE TREATMENT (Fluids/Prop Amounts) **51,000# 16/30 sand w/ 444 bbls wtr, 75 quality foam**

Min Gas Allowable (165:10-17-7)

Gas Purchaser/Measurer



OR

First Sales Date

INITIAL TEST DATA

Oil Allowable (165:10-13-3)

INITIAL TEST DATE	02/19/2019
OIL-BBL/DAY	0
OIL-GRAVITY (API)	NA
GAS-MCF/DAY	92
GAS-OIL RATIO CU FT/BBL	NA
WATER-BBL/DAY	0
PUMPING OR FLOWING	Flowing
INITIAL SHUT-IN PRESSURE	1678
CHOKE SIZE	Wide Open
FLOW TUBING PRESSURE	8

AS SUBMITTED

A record of the formations drilled through, and pertinent remarks are presented on the reverse. I declare that I have knowledge of the contents of this report and am authorized by my organization to make this report, which was prepared by me or under my supervision and direction, with the data and facts stated herein to be true, correct, and complete to the best of my knowledge and belief.

Emily J. Van Der Gryp
 SIGNATURE

Emily J. Van Der Gryp

NAME (PRINT OR TYPE)

03/22/2019 (972) 325-1146

DATE PHONE NUMBER

4901 LBJ Freeway, Ste 300
 ADDRESS

Dallas
 CITY

TX
 STATE

75244
 ZIP

evandergryp@scoutep.com
 EMAIL ADDRESS

Give formation names and tops, if available, or descriptions and thickness of formations drilled through. Show intervals cored or drillstem tested.

WELL NO. 1

NAMES OF FORMATIONS	TOP
Herrington	2579
Krider	2599
Winfield	2674
Towanda	2725
	TD: 2731

FOR COMMISSION USE ONLY	
ITD on file	<input type="checkbox"/> YES <input type="checkbox"/> NO
APPROVED	DISAPPROVED
2) Reject Codes	

Were open hole logs run? ___ yes X no

Date Last log was run _____

Was CO₂ encountered? ___ yes X no at what depths? _____

Was H₂S encountered? ___ yes X no at what depths? _____

Were unusual drilling circumstances encountered? ___ yes X no
If yes, briefly explain below _____

Other remarks:

Other remarks: OCC - This well is an open hole completion from bottom of the 7" casing at 2613' to total depth at 2731'. The production is through a 5 1/2" slotted liner

640 Acres

040 Rings

If more than three drainholes are proposed, attach a separate sheet indicating the necessary information.

Direction must be stated in degrees azimuth.
Please note, the horizontal drainhole and its end
point must be located within the boundaries of the
lease or spacing unit.

Directional surveys are required for all drainholes and directional wells.

640 Acres

A blank 10x10 grid for graphing. The grid is composed of 10 columns and 10 rows of squares. A thick vertical line runs down the center, separating the first five columns from the last five columns. A thick horizontal line runs across the middle, separating the first five rows from the last five rows. The intersection of these two lines is at the center of the grid. The top edge of the grid is labeled with the numbers 0 through 9, with '0' at the far left and '9' at the far right. The right edge of the grid is labeled with the letters A through J, with 'A' at the top and 'J' at the bottom. The grid is intended for plotting a line graph.

BOTTOM HOLE LOCATION FOR DIRECTIONAL HOLE

SEC	TWP	RGE	COUNTY
Spot Location			
1/4	1/4	1/4	1/4
Measured Total Depth		True Vertical Depth	BHL From Lease, Unit, or Property Line:

BOTTOM HOLE LOCATION FOR HORIZONTAL HOLE: (LATERALS)

LATERAL #1

SEC	TWP	RGE	COUNTY
Spot Location			
1/4	1/4	1/4	1/4
Feet From 1/4 Sec Lines		FSL	FWL
Depth of Deviation	Radius of Turn	Direction	Total Length
Measured Total Depth		True Vertical Depth	
BHL From Lease, Unit, or Property Line:			

LATERAL #2

SEC	TWP	RGE	COUNTY
Spot Location			
1/4	1/4	1/4	1/4
Feet From 1/4 Sec Lines		FSL	FWL
Depth of Deviation	Radius of Turn	Direction	Total Length
Measured Total Depth		True Vertical Depth	BHL From Lease, Unit, or Property Line:

LATERAL #3

SEC	TWP	RGE	COUNTY
Spot Location			
1/4	1/4	1/4	1/4
Feet From 1/4 Sec Lines		FSL	FWL
Depth of Deviation	Radius of Turn	Direction	Total Length
Measured Total Depth		True Vertical Depth	
BHL From Lease, Unit, or Property Line:			

4/4/19

RECEIVED

Form 1002A
Rev. 2009

MAR 25 2019

OKLAHOMA CORPORATION COMMISSION

1002A

Addendum

API NO. 139-00929
OTC PROD. UNIT NO. 139-020106

(PLEASE TYPE OR USE BLACK INK ONLY)

OKLAHOMA CORPORATION COMMISSION
Oil & Gas Conservation Division
Post Office Box 52000
Oklahoma City, Oklahoma 73152-2000
Rule 165:10-3-25

A: 020106 I

☒ ORIGINAL
☐ AMENDED (Reason)

Recompletion (Frac)

COMPLETION REPORT

TYPE OF DRILLING OPERATION
☒ STRAIGHT HOLE ☐ DIRECTIONAL HOLE ☐ HORIZONTAL HOLE
If directional or horizontal, see reverse for bottom hole location.

SPUD DATE 10/13/1944
DRLG FINISHED DATE 11/05/1944
DATE OF WELL COMPLETION 11/08/1944
1st PROD DATE 11-24-1944
RECOMP DATE 01/18/2019
Longitude (if known) -101.519056

COUNTY Texas SEC 2 TWP 3N RGE 14ECM
LEASE NAME Chenault, M. M.
SW 1/4 SW 1/4 NE 1/4 1/4
ELEVATION 3190' Ground 3103'
Derrick FL 3190' Ground 3103'
Latitude (if known) 36.755306
OPERATOR NAME Scout Energy Management LLC
ADDRESS 4901 LBJ Freeway, Ste 300
CITY Dallas STATE TX ZIP 75244

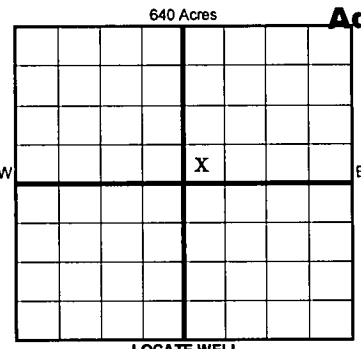

LOCATE WELL

COMPLETION TYPE

☒ SINGLE ZONE
☐ MULTIPLE ZONE
Application Date
☐ COMMINGLED
Application Date
LOCATION EXCEPTION
ORDER NO.
INCREASED DENSITY
ORDER NO.

CASING & CEMENT (Form 1002C must be attached)

TYPE	SIZE	WEIGHT	GRADE	FEET	PSI	SAX	TOP OF CMT
CONDUCTOR							
SURFACE	10.75	32.75	8V	432'	1000	300	Surface
INTERMEDIATE							
PRODUCTION	7	24	8 rd	2613'	1000	1000	Surface
SLOTTED LINER	5.5	14		2579' - 2731'			

PACKER @ 2570' BRAND & TYPE PLUG @ TYPE PLUG @ TYPE
PACKER @ BRAND & TYPE PLUG @ TYPE PLUG @ TYPE

TOTAL DEPTH 2731'
PBTD: 2731'

COMPLETION & TEST DATA BY PRODUCING FORMATION

FORMATION	(Chase) Guyman - Hugoton						Reported to Frac Facies
SPACING & SPACING ORDER NUMBER	17867 (640)						
CLASS: Oil, Gas, Dry, Inj, Disp, Comm Disp, Svc	Gas						
PERFORATED INTERVALS	2579'-2731' slotted liner - open hole 2613'-2731' open hole						
ACID/VOLUME	1000 gal. 15% HCl						
FRACTURE TREATMENT (Fluids/Prop Amounts)	51,000# 16/30 sand w/ 444 bbls wtr, 75 quality foam						

Min Gas Allowable (165:10-17-7)

Gas Purchaser/Measurer
First Sales Date

INITIAL TEST DATA

Oil Allowable (165:10-13-3)

INITIAL TEST DATE	02/19/2019						
OIL-BBL/DAY	0						
OIL-GRAVITY (API)	NA						
GAS-MCF/DAY	92						
GAS-OIL RATIO CU FT/BBL	NA						
WATER-BBL/DAY	0						
PUMPING OR FLOWING	Flowing						
INITIAL SHUT-IN PRESSURE	1678						
CHOKE SIZE	Wide Open						
FLOW TUBING PRESSURE	8						

AS SUBMITTED

A record of the formations drilled through, and pertinent remarks are presented on the reverse. I declare that I have knowledge of the contents of this report and am authorized by my organization to make this report, which was prepared by me or under my supervision and direction, with the data and facts stated herein to be true, correct, and complete to the best of my knowledge and belief.
Signature: Emily J. Van Der Gryp
NAME (PRINT OR TYPE) Emily J. Van Der Gryp
DATE 03/22/2019 (972) 325-1146
PHONE NUMBER
4901 LBJ Freeway, Ste 300 Dallas TX 75244 evandergryp@scoutep.com
ADDRESS CITY STATE ZIP EMAIL ADDRESS

SCANNED