

Oklahoma Corporation Commission
Oil & Gas Conservation Division
Post Office Box 52000
Oklahoma City, Oklahoma 73152-2000
Rule 165: 10-3-25

Form 1002A

API No.: 35051248760000

Completion Report

Spud Date: November 03, 2021

OTC Prod. Unit No.:

Drilling Finished Date: December 01, 2021

1st Prod Date:

Completion Date: December 01, 2021

Drill Type: DIRECTIONAL HOLE

Well Name: SCR 3-31X6H

Purchaser/Measurer:

Location: GRADY 30 4N 5W
NE SE SW SE
369 FSL 1389 FEL of 1/4 SEC
Latitude: 34.78260198 Longitude: -97.76918088
Derrick Elevation: 0 Ground Elevation: 1201

First Sales Date:

Operator: GULFPORT MIDCON LLC 24020

3001 QUAIL SPRINGS PKWY
OKLAHOMA CITY, OK 73134-2640

Completion Type		Location Exception		Increased Density	
	Single Zone	Order No		Order No	
	Multiple Zone	There are no Location Exception records to display.		There are no Increased Density records to display.	
	Commingled				

Casing and Cement							
Type	Size	Weight	Grade	Feet	PSI	SAX	Top of CMT
CONDUCTOR	20		LP	148			
SURFACE	13.375	54	J-55	1507			SURFACE

Liner								
Type	Size	Weight	Grade	Length	PSI	SAX	Top Depth	Bottom Depth
There are no Liner records to display.								

Total Depth: 7622

Packer		Plug	
Depth	Brand & Type	Depth	Plug Type
There are no Packer records to display.		There are no Plug records to display.	

Initial Test Data										
Test Date	Formation	Oil BBL/Day	Oil-Gravity (API)	Gas MCF/Day	Gas-Oil Ratio Cu FT/BBL	Water BBL/Day	Pumpin or Flowing	Initial Shut-In Pressure	Choke Size	Flow Tubing Pressure
There are no Initial Data records to display.										

Completion and Test Data by Producing Formation		
Formation Name: NONE	Code: 999NONE	Class: DRY

Formation	Top
-----------	-----

Were open hole logs run? No
Date last log run:

Were unusual drilling circumstances encountered? Yes
Explanation: DURING DRILLING WELLBORE
DETERIORATED

Other Remarks
DECISION WAS MADE TO PLUG THE WELL. WELL WILL BE PLUGGED AS SOON AS OPERATIONS ARE FINISHED ON PAD.

Bottom Holes
Sec: 30 TWP: 4N RGE: 5W County: GRADY NE SE SW SE 248 FSL 2481 FEL of 1/4 SEC Depth of Deviation: 0 Radius of Turn: 0 Direction: 0 Total Length: 0 Measured Total Depth: 7622 True Vertical Depth: 6286 End Pt. Location From Release, Unit or Property Line: 248

FOR COMMISSION USE ONLY	
Status: Accepted	1147868

RECEIVED

MAR 31 2022

API NO. 3505124876
 OTC PROD.
 UNIT NO.

Oil and Gas Conservation Division
 P.O. Box 52000
 Oklahoma City, OK 73152-2000
 405-521-2331
 OCCCentralProcessing@OCC.OK.GOV



OKLAHOMA
 Corporation
 Commission

OKLAHOMA CORPORATION
 COMMISSION

Form 1002A
 Rev. 2021



ORIGINAL
 AMENDED (Reason)

Rule 165:10-3-25

COMPLETION REPORT

TYPE OF DRILLING OPERATION

☐ STRAIGHT HOLE ☒ DIRECTIONAL HOLE ☐ HORIZONTAL HOLE
☐ SERVICE WELL

If directional or horizontal, see reverse for bottom hole location.

COUNTY	Grady	SEC	30	TWP	04N	RGE	05W	SPUD DATE	11/3/2021	
LEASE NAME	SCR			WELL NO.	3-31X6H			DRLG FINISHED DATE	12/1/2021	
NE 1/4 SE 1/4 SW 1/4 SE 1/4 FSL	369	FEL	1389	DATE OF WELL COMPLETION	12-1-2021				1st PROD DATE	
ELEVATION	Ground	1201	Latitude	34.78260198		Longitude	-97.76918088			
OPERATOR NAME	GULFPORT MIDCON LLC			OTC/OCC OPERATOR NO.	24020					
ADDRESS	3001 QUAIL SPRINGS PARKWAY									
CITY	OKC	STATE	OK	ZIP	73134					

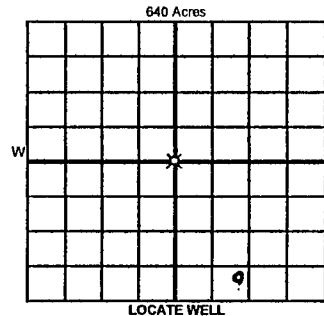

COMPLETION TYPE

<input checked="" type="radio"/> SINGLE ZONE	
<input type="radio"/> MULTIPLE ZONE	
<input type="radio"/> COMMINGLED	
LOCATION EXCEPTION ORDER NO.	-724198
MULTIUNIT ORDER NO.	-724226
INCREASED DENSITY ORDER NO.	724204/724202

CASING & CEMENT (Attach Form 1002C)

TYPE	SIZE	WEIGHT	GRADE	FEET	PSI	SAX	TOP OF CMT
CONDUCTOR	20		LP	148			
SURFACE	13.375	54LBS	J55	1507			Surface
INTERMEDIATE							
PRODUCTION							
LINER							

PACKER @ _____ BRAND & TYPE _____ PLUG @ _____ TYPE _____ PLUG @ _____ TYPE _____
 PACKER @ _____ BRAND & TYPE _____ PLUG @ _____ TYPE _____ PLUG @ _____ TYPE _____

TOTAL DEPTH 7622

COMPLETION & TEST DATA BY PRODUCING FORMATION

FORMATION	Woodford						NO Frac
SPACING & SPACING ORDER NUMBER	385120	390452	146084	471539			
CLASS: Oil, Gas, Dry, Inj. Disp, Comm Disp, Svc	Dry						
PERFORATED INTERVALS							
ACID/VOLUME							
FRACTURE TREATMENT (Fluids/Prop Amounts)							

Min Gas Allowable (165:10-17-7)

Purchaser/Measurer



Oil Allowable (165:10-13-3)

First Sales Date

INITIAL TEST DATA

INITIAL TEST DATE						
OIL-BBL/DAY						
OIL-GRAVITY (API)						
GAS-MCF/DAY						
GAS-OIL RATIO CU FT/BBL						
WATER-BBL/DAY						
PUMPING OR FLOWING						
INITIAL SHUT-IN PRESSURE						
CHOKE SIZE						
FLOW TUBING PRESSURE						

A record of the formations drilled through, and pertinent remarks are presented on the reverse. I declare that I have knowledge of the contents of this report and am authorized by my organization to make this report, which was prepared by me or under my supervision and direction, with the data and facts stated herein to be true, correct, and complete to the best of my knowledge and belief.

Monica Pickens
 SIGNATURE
 3001 Quail Springs Parkway
 ADDRESS
 OKC
 CITY
 OK
 STATE
 73106
 ZIP
 3/31/2022
 DATE
 405-252-4703
 PHONE NUMBER
 mpickens@gulfportenergy.com
 EMAIL ADDRESS

Per operator & survey

PLEASE TYPE OR USE BLACK INK ONLY
FORMATION RECORD

Give formation names and tops, if available, or descriptions and thickness of formations drilled through. Show intervals cored or drillstem tested.

NAMES OF FORMATIONS	TOP
Woodford Never reached	

LEASE NAME SCR WELL NO. 3-31X6H

FOR COMMISSION USE ONLY	
ITD on file <input type="checkbox"/> YES <input type="checkbox"/> NO	
APPROVED <input type="checkbox"/> DISAPPROVED <input type="checkbox"/>	2) Reject Codes

Were open hole logs run?	<input type="radio"/> yes <input checked="" type="radio"/> no
Date Last log was run	
Was CO ₂ encountered?	<input type="radio"/> yes <input checked="" type="radio"/> no at what depths? _____
Was H ₂ S encountered?	<input type="radio"/> yes <input checked="" type="radio"/> no at what depths? _____
Were unusual drilling circumstances encountered?	<input checked="" type="radio"/> yes <input type="radio"/> no
If yes, briefly explain below	

Other remarks: During drilling wellbore deteriorated and decision was made to plug the well. Well will be plugged as soon as operations are finished on pad.

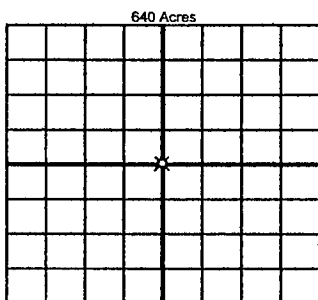

If more than three drainholes are proposed, attach a separate sheet indicating the necessary information.

Direction must be stated in degrees azimuth. Please note, the horizontal drainhole and its end point must be located within the boundaries of the lease or spacing unit.

Directional surveys are required for all drainholes and directional wells

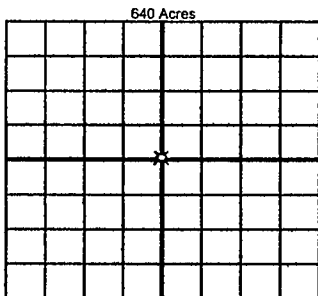

BOTTOM HOLE LOCATION FOR DIRECTIONAL HOLE

SEC <u>30</u>	TWP <u>4N</u>	RGE <u>5W</u>	COUNTY <u>Grady</u>
<u>NE</u> <u>1/4</u>	<u>SE</u> <u>1/4</u>	<u>SW</u> <u>1/4</u>	<u>SE</u> <u>1/4</u>
Measured Total Depth <u>7622</u>		True Vertical Depth <u>6286</u>	Feet From 1/4 Sec Lines <u>F56248 F56248</u>
		BHL From Lease, Unit, or Property Line: <u>248</u>	

BOTTOM HOLE LOCATION FOR HORIZONTAL HOLE: (LATERALS)

LATERAL #1			
SEC	TWP	RGE	COUNTY
<u>1/4</u>	<u>1/4</u>	<u>1/4</u>	<u>1/4</u>
Depth of Deviation	Radius of Turn	Direction	Total Length
Measured Total Depth	True Vertical Depth	BHL From Lease, Unit, or Property Line:	

LATERAL #2			
SEC	TWP	RGE	COUNTY
<u>1/4</u>	<u>1/4</u>	<u>1/4</u>	<u>1/4</u>
Depth of Deviation	Radius of Turn	Direction	Total Length
Measured Total Depth	True Vertical Depth	BHL From Lease, Unit, or Property Line:	

LATERAL #3			
SEC	TWP	RGE	COUNTY
<u>1/4</u>	<u>1/4</u>	<u>1/4</u>	<u>1/4</u>
Depth of Deviation	Radius of Turn	Direction	Total Length
Measured Total Depth	True Vertical Depth	BHL From Lease, Unit, or Property Line:	