

Oklahoma Corporation Commission
Oil & Gas Conservation Division
Post Office Box 52000
Oklahoma City, Oklahoma 73152-2000
Rule 165: 10-3-25

Form 1002A

API No.: 35073268100000

Completion Report

Spud Date: January 28, 2022

OTC Prod. Unit No.: 073-227020-0-1692

Drilling Finished Date: February 15, 2022

1st Prod Date: March 04, 2022

Completion Date: February 21, 2022

Drill Type: HORIZONTAL HOLE

Min Gas Allowable: Yes

Well Name: LINCOLN NORTH UNIT 62-3HO

Purchaser/Measurer:

Location: KINGFISHER 2 17N 6W
NW NW NE NE
142 FNL 1115 FEL of 1/4 SEC
Latitude: 35.985213 Longitude: -97.803913
Derrick Elevation: 0 Ground Elevation: 1108

First Sales Date:

Operator: HINKLE OIL & GAS INC 21639

5600 N MAY AVE STE 295
OKLAHOMA CITY, OK 73112-4275

Completion Type		Location Exception		Increased Density	
X	Single Zone	Order No		Order No	
	Multiple Zone	There are no Location Exception records to display.		There are no Increased Density records to display.	
	Commingled				

Casing and Cement							
Type	Size	Weight	Grade	Feet	PSI	SAX	Top of CMT
CONDUCTOR	20			90			SURFACE
SURFACE	9 5/8	40	J-55	333		125	SURFACE
PRODUCTION	7	26	P-110	6710		225	2735

Liner								
Type	Size	Weight	Grade	Length	PSI	SAX	Top Depth	Bottom Depth
LINER	4 1/2	11.6	P-110	7756	0	865	6501	14257

Total Depth: 14275

Packer		Plug	
Depth	Brand & Type	Depth	Plug Type
There are no Packer records to display.		There are no Plug records to display.	

Initial Test Data

Test Date	Formation	Oil BBL/Day	Oil-Gravity (API)	Gas MCF/Day	Gas-Oil Ratio Cu FT/BBL	Water BBL/Day	Pumpin or Flowing	Initial Shut-In Pressure	Choke Size	Flow Tubing Pressure
Mar 22, 2022	OSWEGO	212	41.1	81	382	1305	PUMPING		OPEN	

Completion and Test Data by Producing Formation

Formation Name: OSWEGO

Code: 404OSWG

Class: OIL

Spacing Orders

Order No	Unit Size
119269	UNIT

Perforated Intervals

From	To
6735	14140

Acid Volumes

There are no Acid Volume records to display.
--

Fracture Treatments

290,850 GALLONS 15% HCL, 86,555 BARRELS SLICK WATER

Formation	Top
OSWEGO	6228

Were open hole logs run? No

Date last log run:

Were unusual drilling circumstances encountered? No

Explanation:

Other Remarks

There are no Other Remarks.

Lateral Holes

Sec: 26 TWP: 18N RGE: 6W County: KINGFISHER

NW NW NE SE

200 FNL 1200 FEL of 1/4 SEC

Depth of Deviation: 5611 Radius of Turn: 1219 Direction: 0 Total Length: 7445

Measured Total Depth: 14275 True Vertical Depth: 6353 End Pt. Location From Release, Unit or Property Line: 200

FOR COMMISSION USE ONLY

1147855

Status: Accepted

API NO. 35-073-26810
OTC PROD. UNIT NO. 873-227020-0-1691

Oil and Gas Conservation Division
P.O. Box 52000
Oklahoma City, OK 73152-2000
405-521-2331
OCCCentralProcessing@OCC.OK.GOV



OKLAHOMA
Corporation
Commission

Form 1002A
Rev. 2021

8 ORIGINAL
AMENDED (Reason)

Rule 165:10-3-25

COMPLETION REPORT

TYPE OF DRILLING OPERATION

☐ STRAIGHT HOLE ☐ DIRECTIONAL HOLE ☒ HORIZONTAL HOLE
☐ SERVICE WELL

If directional or horizontal, see reverse for bottom hole location.

SPUD DATE 1/30/2022
DRLG FINISHED DATE 2/15/2022
DATE OF WELL COMPLETION 2/21/2022
1st PROD DATE 3/4/2022
RECOMP DATE
WELL NO. 62-3HO
FNL 142' FEL 1115'

COUNTY Kingfisher SEC 02 TWP 17N RGE 06W
LEASE NAME Lincoln North Unit
ELEVATION Ground 1108' Latitude 35.985213 Longitude -97.803913
OPERATOR NAME Hinkle Oil & Gas, Inc. OTC / OCC OPERATOR NO. 21639
ADDRESS 5600 N. May Avenue, Suite 295
CITY Oklahoma City STATE OK ZIP 73112

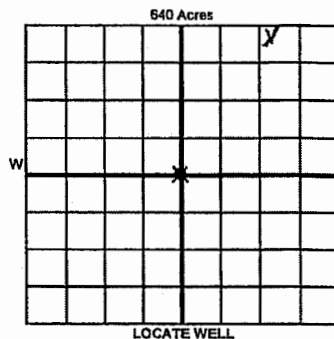

COMPLETION TYPE

☒ SINGLE ZONE
☐ MULTIPLE ZONE
☐ COMMINGLED
LOCATION EXCEPTION ORDER NO.
MULTIUNIT ORDER NO.
INCREASED DENSITY ORDER NO.

CASING & CEMENT (Attach Form 1002C)

TYPE	SIZE	WEIGHT	GRADE	FEET	PSI	SAX	TOP OF CMT
CONDUCTOR	20"			90'			Surface
SURFACE	9 5/8"	40#	J-55	333'		125	Surface
INTERMEDIATE	7"	26#	P-110	6710'		225	2735'
PRODUCTION							
LINER	4 1/2"	11.6#	P-110	6501'-14,257'		865	6501'

PACKER @ BRAND & TYPE

PLUG @

TYPE

PLUG @

TYPE

TOTAL

DEPTH 14,275'

PACKER @ BRAND & TYPE

PLUG @

TYPE

PLUG @

TYPE

COMPLETION & TEST DATA BY PRODUCING FORMATION

FORMATION	Oswego					Monitor
SPACING & SPACING ORDER NUMBER	119269 (unit)					Report to Fractures
CLASS: Oil, Gas, Dry, Inj, Disp, Comm Disp, Svc	Oil					
	6735'-14,140'					
PERFORATED INTERVALS						
ACID VOLUME						
FRACTURE TREATMENT (Fluids/Prop Amounts)	290850 Gal. 15% HCL 86555 Bbl. Slick Water					

RECEIVED

MAR 29 2022

OKLAHOMA CORPORATION
COMMISSION

Min Gas Allowable (165:10-17-7)



OR

Oil Allowable (165:10-13-3)

Purchaser/Measurer

First Sales Date

INITIAL TEST DATA

INITIAL TEST DATE	03/22/2022					
OIL-BBL/DAY	212					
OIL-GRAVITY (API)	41.1					
GAS-MCF/DAY	81					
GAS-OIL RATIO CU FT/BBL	382					
WATER-BBL/DAY	1305					
PUMPING OR FLOWING	Pumping					
INITIAL SHUT-IN PRESSURE	N/A					
CHOKE SIZE	Open					
FLOW TUBING PRESSURE	N/A					

A record of the formations drilled through, and pertinent remarks are presented on the reverse. I declare that I have knowledge of the contents of this report and am authorized by my organization to make this report, which was prepared by me or under my supervision and direction, with the data and facts stated herein to be true, correct, and complete to the best of my knowledge and belief.

B. Hinkle
SIGNATURE

Bruce A. Hinkle
NAME (PRINT OR TYPE)

3/25/2022 405-848-0924
DATE PHONE NUMBER

5600 N. May Avenue, Suite 295

Oklahoma City

OK 73112

Laurahinkle@hoagi.com

ADDRESS

CITY

STATE

ZIP

EMAIL ADDRESS

PLEASE TYPE OR USE BLACK INK ONLY
FORMATION RECORD

Give formation names and tops, if available, or descriptions and thickness of formations drilled through. Show intervals cored or driftestem tested.

NAMES OF FORMATIONS	TOP
Oswego	TVD 6228'

LEASE NAME Lincoln North Unit WELL NO. 62-3HO

FOR COMMISSION USE ONLY	
ITD on file <input type="checkbox"/> YES <input type="checkbox"/> NO	
APPROVED _____	DISAPPROVED _____
2) Reject Codes	

Were open hole logs run?	<input type="radio"/> yes <input checked="" type="radio"/> no
Date Last log was run	_____
Was CO ₂ encountered?	<input type="radio"/> yes <input checked="" type="radio"/> no at what depths? _____
Was H ₂ S encountered?	<input type="radio"/> yes <input checked="" type="radio"/> no at what depths? _____
Were unusual drilling circumstances encountered?	<input type="radio"/> yes <input checked="" type="radio"/> no
If yes, briefly explain below	

Other remarks:

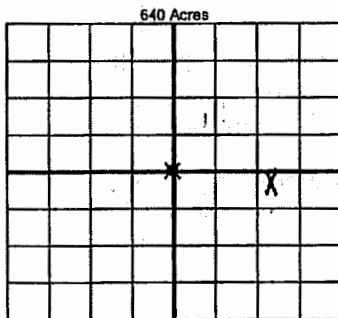

If more than three drainholes are proposed, attach a separate sheet indicating the necessary information.

Direction must be stated in degrees azimuth. Please note, the horizontal drainhole and its end point must be located within the boundaries of the lease or spacing unit.

Directional surveys are required for all drainholes and directional wells

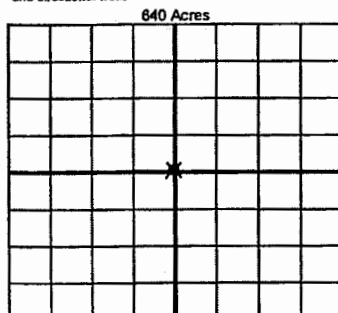

BOTTOM HOLE LOCATION FOR DIRECTIONAL HOLE

SEC	TWP	RGE	COUNTY
1/4	1/4	1/4	1/4
Measured Total Depth		True Vertical Depth	BHL From Lease, Unit, or Property Line:

BOTTOM HOLE LOCATION FOR HORIZONTAL HOLE: (LATERALS)

LATERAL #1			
SEC	TWP	RGE	COUNTY
26	18N	06W	Kingfisher
NW 1/4	NW 1/4	NE 1/4	SE 1/4
Depth of Deviation 5611'		Radius of Turn 1219'	Direction North
Measured Total Depth 14,275'		True Vertical Depth 6353'	Total Length 7445'
		BHL From Lease, Unit, or Property Line:	200'

LATERAL #2			
SEC	TWP	RGE	COUNTY
1/4	1/4	1/4	1/4
Depth of Deviation		Radius of Turn	Direction
Measured Total Depth		True Vertical Depth	Total Length
		BHL From Lease, Unit, or Property Line:	

LATERAL #3			
SEC	TWP	RGE	COUNTY
1/4	1/4	1/4	1/4
Depth of Deviation		Radius of Turn	Direction
Measured Total Depth		True Vertical Depth	Total Length
		BHL From Lease, Unit, or Property Line:	