

Oklahoma Corporation Commission
Oil & Gas Conservation Division
Post Office Box 52000
Oklahoma City, Oklahoma 73152-2000
Rule 165: 10-3-25

Form 1002A

API No.: 35121248810001

Completion Report

Spud Date: October 04, 2021

OTC Prod. Unit No.: 121-227617-0-0000

Drilling Finished Date: October 26, 2021

1st Prod Date: January 21, 2022

Completion Date: December 04, 2021

Drill Type: STRAIGHT HOLE

Min Gas Allowable: Yes

Well Name: WHITING 4-25

Purchaser/Measurer: WEBB ENERGY
RESOURCES

First Sales Date: 01/20/2022

Location: PITTSBURG 25 4N 15E
NE NE SW NE
1620 FNL 1620 FEL of 1/4 SEC
Latitude: 34.792413 Longitude: -95.676949
Derrick Elevation: 642 Ground Elevation: 629

Operator: OXLEY ENERGY LLC 24290
PO BOX 19545
800 WILCREST DR STE 350
HOUSTON, TX 77224-9545

Completion Type		Location Exception		Increased Density	
X	Single Zone	Order No		Order No	
	Multiple Zone	There are no Location Exception records to display.		718066	
	Commingled				

Casing and Cement							
Type	Size	Weight	Grade	Feet	PSI	SAX	Top of CMT
CONDUCTOR	16			45		50	SURFACE
SURFACE	13 3/8	48	J-55	168		100	SURFACE
INTERMEDIATE	9 5/8	36	J-55	1200		230	SURFACE
PRODUCTION	4 1/2	11.6	P-110	9434		1300	SURFACE

Liner								
Type	Size	Weight	Grade	Length	PSI	SAX	Top Depth	Bottom Depth
There are no Liner records to display.								

Total Depth: 9482

Packer		Plug	
Depth	Brand & Type	Depth	Plug Type
There are no Packer records to display.		There are no Plug records to display.	

Initial Test Data

Test Date	Formation	Oil BBL/Day	Oil-Gravity (API)	Gas MCF/Day	Gas-Oil Ratio Cu FT/BBL	Water BBL/Day	Pumpin or Flowing	Initial Shut-In Pressure	Choke Size	Flow Tubing Pressure
Mar 16, 2022	MIDDLE ATOKA			6801	6801	4	FLOWING	1726	2.25	785

Completion and Test Data by Producing Formation

Formation Name: MIDDLE ATOKA

Code: 403ATOKM

Class: GAS

Spacing Orders

Order No	Unit Size
114315	640
116454	640 NPT

Perforated Intervals

From	To
8704	8706
8710	8712
8714	8716
8719	8722
8723	8725
8759	8766
8783	8785
8797	8802
8803	8808
8823	8831
8833	8847
8851	8855
8857	8861
8869	8872
8874	8877
8878	8883
9064	9068
9086	9092
9101	9104
9106	9109

Acid Volumes

19,034 GALLONS 7.5% HCL

Fracture Treatments

4,572 BARRELS GELLED WATER, 159,105 POUNDS 20/40 PROPPANT

Formation	Top
FANSHAWE	4925
FANSHAWE	5555
RED OAK	6230
BRAZIL	7039
RED OAK	8095
BRAZIL	8703
ATOKA E MIDDLE	9001

Were open hole logs run? Yes

Date last log run: October 27, 2021

Were unusual drilling circumstances encountered? No

Explanation:

Other Remarks
There are no Other Remarks.

FOR COMMISSION USE ONLY	
Status: Accepted	1147857

API NO. 35-121-24881
OTC PROD UNIT NO. 21-227617

Oil and Gas Conservation Division
P.O. Box 52000
Oklahoma City, OK 73152-2000
405-521-2331
OCCentralProcessing@OCC.OK.GOV



OKLAHOMA
Corporation
Commission

Form 1002A
Rev. 2021

ORIGINAL
AMENDED (Reason)

Rule 165:10-3-25

COMPLETION REPORT

TYPE OF DRILLING OPERATION

☒ STRAIGHT HOLE ☐ DIRECTIONAL HOLE ☐ HORIZONTAL HOLE
☐ SERVICE WELL

If directional or horizontal, see reverse for bottom hole location.

COUNTY	Pittsburg	SEC	25	TWP	4N	RGE	15E	SPUD DATE	10-4-2021
LEASE NAME	Whiting	WELL NO.	4-25	DRLG FINISHED DATE	10-26-2021	DATE OF WELL COMPLETION	12-4-2021	1st PROD DATE	1-21-2022
NE 1/4 NE 1/4 SW 1/4 NE 1/4	ESL 1020	ESL 1020	ESL 1020	RECOMP DATE		Longitude	-95.676949		
ELEVATION Derrick FL	642	Ground	629	Latitude	34.792413	OTC/OCC OPERATOR NO.	24290		
OPERATOR NAME	Oxley Energy, LLC	ADDRESS	P.O. Box 19545	CITY	Houston	STATE	Texas	ZIP	77224-9545

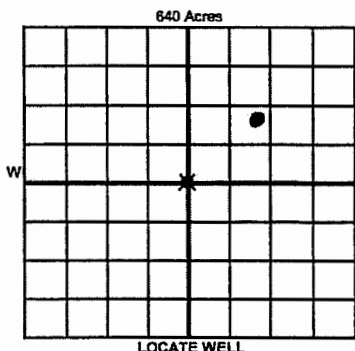

COMPLETION TYPE

<input checked="" type="radio"/> SINGLE ZONE	
<input type="radio"/> MULTIPLE ZONE	
<input type="radio"/> COMMINGLED	
LOCATION EXCEPTION ORDER NO.	none
MULTIUNIT ORDER NO.	none
INCREASED DENSITY ORDER NO.	718066

CASING & CEMENT (Attach Form 1002C)

TYPE	SIZE	WEIGHT	GRADE	FEET	PSI	SAX	TOP OF CMT
CONDUCTOR	16			45		50	surface
SURFACE	13 3/8"	48	J555	168		100	surface
INTERMEDIATE	9 5/8"	36	J55	1200		230	surface
PRODUCTION	4 1/2"	11.6	P110	9434		1300	surface
LINER							

PACKER @ _____ BRAND & TYPE _____ PLUG @ _____ TYPE _____ PLUG @ _____ TYPE _____ TOTAL DEPTH 9482
PACKER @ _____ BRAND & TYPE _____ PLUG @ _____ TYPE _____ PLUG @ _____ TYPE _____

COMPLETION & TEST DATA BY PRODUCING FORMATION 403 ATOKIN

FORMATION	Middle Atoka					Monitor
SPACING & SPACING ORDER NUMBER	(640) 114315, 116454	40 NPT				Report to Frac Focus
CLASS: Oil, Gas, Dry, Inj, Disp, Comm Disp, Svc	Gas					
PERFORATED INTERVALS	8704'-9109' OA					RECEIVED
	see attached summary					MAR 28 2022
ACID/VOLUME	19,034 gals 7.5% HCl					OKLAHOMA CORPORATION COMMISSION
FRACTURE TREATMENT (Fluids/Prop Amounts)	4572 bbls gelled water, 159,105 # 20-40 prop					

☒ Min Gas Allowable (165:10-17-7)
OR
☐ Oil Allowable (165:10-13-3)

Purchaser/Measurer _____
First Sales Date _____
Webb Energy Resources
1/20/2022

INITIAL TEST DATA

INITIAL TEST DATE	3/16/2022					
OIL-BBL/DAY	0					
OIL-GRAVITY (API)						
GAS-MCF/DAY	6801					
GAS-OIL RATIO CU FT/BBL	6801					
WATER-BBL/DAY	4.2					
PUMPING OR FLOWING	flowing					
INITIAL SHUT-IN PRESSURE	1726					
CHOKE SIZE	2.25"					
FLOW TUBING PRESSURE	785					

A record of the formations drilled through, and pertinent remarks are presented on the reverse. I declare that I have knowledge of the contents of this report and am authorized by my organization to make this report, which was prepared by me or under my supervision and direction, with the data and facts stated herein to be true, correct, and complete to the best of my knowledge and belief.

SIGNATURE	Grant Nally	DATE	12-9-2021	PHONE NUMBER	479-783-6734
600 S. 16th St.	Ft. Smith	AR	72901	gnally@newprospect.com	
ADDRESS	CITY	STATE	ZIP	EMAIL ADDRESS	

PLEASE TYPE OR USE BLACK INK ONLY

FORMATION RECORD

Give formation names and tops, if available, or descriptions and thickness of formations drilled through. Show intervals cored or drillstem tested.

NAMES OF FORMATIONS	TOP
Fanshawe	4925
Fanshawe (repeated)	5555
Red Oak	6230
Brazil	7039
Red Oak (repeated)	8095
Brazil (repeated)	8703
Middle Atoka E sand	9001

LEASE NAME Whiting WELL NO. 4-25

FOR COMMISSION USE ONLY		
ITD on file	<input type="checkbox"/> YES <input type="checkbox"/> NO	
APPROVED	DISAPPROVED	2) Reject Codes
<div></div> <div></div> <div></div> <div></div> <div></div>		

Were open hole logs run?	<input checked="" type="radio"/> yes <input type="radio"/> no	
Date Last log was run	10-27-2021	
Was CO ₂ encountered?	<input type="radio"/> yes <input checked="" type="radio"/> no	at what depths?
Was H ₂ S encountered?	<input type="radio"/> yes <input checked="" type="radio"/> no	at what depths?
Were unusual drilling circumstances encountered?	<input type="radio"/> yes <input checked="" type="radio"/> no	
If yes, briefly explain below		

Other remarks:

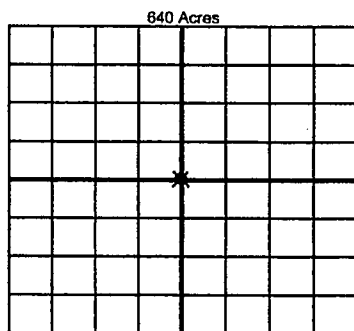

If more than three drainholes are proposed, attach a separate sheet indicating the necessary information.

Direction must be stated in degrees azimuth. Please note, the horizontal drainhole and its end point must be located within the boundaries of the lease or spacing unit.

Directional surveys are required for all drainholes and directional wells

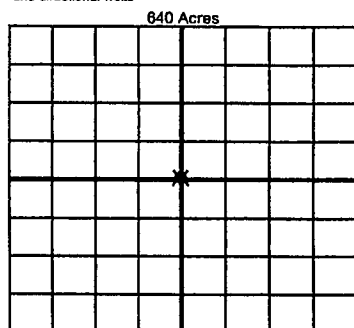

BOTTOM HOLE LOCATION FOR DIRECTIONAL HOLE

SEC	TWP	RGE	COUNTY
1/4	1/4	1/4	1/4
Measured Total Depth		True Vertical Depth	Feet From 1/4 Sec Lines
BHL From Lease, Unit, or Property Line:			

BOTTOM HOLE LOCATION FOR HORIZONTAL HOLE: (LATERALS)

LATERAL #1			
SEC	TWP	RGE	COUNTY
1/4	1/4	1/4	1/4
Depth of Deviation		Radius of Turn	Direction
Measured Total Depth		True Vertical Depth	Total Length
BHL From Lease, Unit, or Property Line:			

LATERAL #2			
SEC	TWP	RGE	COUNTY
1/4	1/4	1/4	1/4
Depth of Deviation		Radius of Turn	Direction
Measured Total Depth		True Vertical Depth	Total Length
BHL From Lease, Unit, or Property Line:			

LATERAL #3			
SEC	TWP	RGE	COUNTY
1/4	1/4	1/4	1/4
Depth of Deviation		Radius of Turn	Direction
Measured Total Depth		True Vertical Depth	Total Length
BHL From Lease, Unit, or Property Line:			

Image @ 1002A

Oxley Energy Whiting #4-25

Sec. 25-4N-15E

Pittsburg County

Perforated Intervals:

8704-06; 8710-12; 8714-16; 8719-22; 8723- 25; 8759- 66; 8783- 85; 8797- 8802; 8803- 08; 8823- 31;
8833- 47; 8851- 55; 8857- 61; 8869- 72; 8874- 77; 8878- 83; 9064-68; 9086-92; 9101-04; 9106- 09

Oklahoma Corporation Commission
Oil & Gas Conservation Division
Post Office Box 52000
Oklahoma City, Oklahoma 73152-2000
Rule 165: 10-3-25

5/1/22

Form 1002A

1002A
Addendum

API No.: 35121248810001

Completion Report

Spud Date: October 04, 2021

OTC Prod. Unit No.: 121-227617-0-0000

Drilling Finished Date: October 26, 2021

1st Prod Date: January 21, 2022

Completion Date: December 04, 2021

A: 050313 AS

Drill Type: **STRAIGHT HOLE**

Min Gas Allowable: Yes

Well Name: WHITING 4-25

Purchaser/Measurer: WEBB ENERGY
RESOURCES

First Sales Date: 01/20/2022

Location: PITTSBURG 25 4N 15E
NE NE SW NE
1620 FNL 1620 FEL of 1/4 SEC
Latitude: 34.792413 Longitude: -95.676949
Derrick Elevation: 642 Ground Elevation: 629

Operator: OXLEY ENERGY LLC 24290
PO BOX 19545
800 WILCREST DR STE 350
HOUSTON, TX 77224-9545

Completion Type	
X	Single Zone
	Multiple Zone
	Commingled

Location Exception
Order No
There are no Location Exception records to display.

Increased Density
Order No
718066

Casing and Cement							
Type	Size	Weight	Grade	Feet	PSI	SAX	Top of CMT
CONDUCTOR	16			45		50	SURFACE
SURFACE	13 3/8	48	J-55	168		100	SURFACE
INTERMEDIATE	9 5/8	36	J-55	1200		230	SURFACE
PRODUCTION	4 1/2	11.6	P-110	9434		1300	SURFACE

Liner								
Type	Size	Weight	Grade	Length	PSI	SAX	Top Depth	Bottom Depth
There are no Liner records to display.								

Total Depth: 9482

Packer	
Depth	Brand & Type
There are no Packer records to display.	

Plug	
Depth	Plug Type
There are no Plug records to display.	

Initial Test Data

April 06, 2022

3/16/22

403A TOKM

1726