

Oklahoma Corporation Commission  
Oil & Gas Conservation Division  
Post Office Box 52000  
Oklahoma City, Oklahoma 73152-2000  
Rule 165: 10-3-25

Form 1002A

API No.: 35103247510000

**Completion Report**

Spud Date: December 28, 2018

OTC Prod. Unit No.: 103-225517

Drilling Finished Date: January 13, 2019

1st Prod Date: May 19, 2019

Completion Date: June 10, 2020

**Drill Type:** HORIZONTAL HOLE

Min Gas Allowable: Yes

Well Name: GLEASON 1-31-30XH

Purchaser/Measurer: ETC TEXAS PIPELINE LTD

Location: NOBLE 6 20N 1W  
SE NW NW NW  
600 FNL 465 FWL of 1/4 SEC  
Latitude: 36.244455 Longitude: -97.352386  
Derrick Elevation: 0 Ground Elevation: 1111

First Sales Date: 06/06/2019

Operator: CHARTER OAK PRODUCTION CO LLC 21672

13929 QUAIL POINTE DR  
OKLAHOMA CITY, OK 73134-1037

Completion Type	
X	Single Zone
	Multiple Zone
	Commingled

Location Exception
Order No
696938

Increased Density
Order No
N/A

Casing and Cement							
Type	Size	Weight	Grade	Feet	PSI	SAX	Top of CMT
CONDUCTOR	20			82			SURFACE
SURFACE	10 3/4	45.5	J-55	370		300	SURFACE
INTERMEDIATE	7 5/8	29.7	J-55	5059		250	3420
PRODUCTION	5 1/2 & 4 1/2	20 & 13.5	P-110	11943		920	3270

Liner								
Type	Size	Weight	Grade	Length	PSI	SAX	Top Depth	Bottom Depth
There are no Liner records to display.								

**Total Depth: 11957**

Packer	
Depth	Brand & Type
There are no Packer records to display.	

Plug	
Depth	Plug Type
There are no Plug records to display.	

Initial Test Data
-------------------

Test Date	Formation	Oil BBL/Day	Oil-Gravity (API)	Gas MCF/Day	Gas-Oil Ratio Cu FT/BBL	Water BBL/Day	Pumpin or Flowing	Initial Shut-In Pressure	Choke Size	Flow Tubing Pressure
Jun 10, 2020	BIG LIME	93	40.8	246	2645	399	PUMPING	1739	N/A	

<b>Completion and Test Data by Producing Formation</b>	
Formation Name: BIG LIME	Code: 404BGLM
Class: OIL	

Spacing Orders	
Order No	Unit Size
692851	480

Perforated Intervals	
From	To
5135	11853

Acid Volumes	
440,254 GALLONS 20% HCL	

Fracture Treatments	
160,708 BARRELS SLICK WATER, 715,060 POUNDS 40/70 SAND, 1,805,870 POUNDS 30/50 SAND	

Formation	Top
BIG LIME	4944

Were open hole logs run? No

Date last log run:

Were unusual drilling circumstances encountered? No

Explanation:

Other Remarks
OCC - SPACING ORDER NUMBER 692851 IS AN IRREGULAR 480 ACRE UNIT COVERING SW/4 SEC 30-21N-1W AND W/2 SEC 31-21N-1W. OCC - THE ORDER 700483 1S AN EXCEPTION TO THE RULE 165:10-3-28(C)(2)(B).

Lateral Holes
<p>Sec: 30 TWP: 21N RGE: 1W County: NOBLE</p> <p>SE   NW   NW   SW</p> <p>613 FNL   641 FWL of 1/4 SEC</p> <p>Depth of Deviation: 3670 Radius of Turn: 883 Direction: 360 Total Length: 6745</p> <p>Measured Total Depth: 11957 True Vertical Depth: 4531   End Pt. Location From Release, Unit or Property Line: 613</p>

FOR COMMISSION USE ONLY	
Status: Accepted	1145395

API NO. 35-103-24751  
OTC PROD. UNIT NO. 103-225517

PLEASE TYPE OR USE BLACK INK ONLY

NOTE:

Attach copy of original 1002A if recompletion or reentry.

OKLAHOMA CORPORATION COMMISSION  
Oil & Gas Conservation Division  
Post Office Box 52000  
Oklahoma City, Oklahoma 73152-2000  
Rule 165:10-3-25

Form 1002A  
Rev. 2009

☒ ORIGINAL  
☐ AMENDED (Reason)

COMPLETION REPORT

TYPE OF DRILLING OPERATION

☐ STRAIGHT HOLE ☐ DIRECTIONAL HOLE ☒ HORIZONTAL HOLE  
☐ SERVICE WELL

If directional or horizontal, see reverse for bottom hole location.

COUNTY Noble	SEC 6	TWP 20N	RGE 01W	SPUD DATE 12/28/18
LEASE NAME Gleason	WELL NO. 1-31-30XH	DATE 1/13/19	DATE OF WELL COMPLETION 6/10/20	1st PROD DATE 5/19/19
SE 1/4 NW 1/4 NW 1/4 NW 1/4	588' OF 1/4 SEC 600' FNL	PWL OF 1/4 SEC 465'	RECOMP DATE	
ELEVATION N Derrick Ground 1111'	Latitude (if known) 36.244455	Longitude (if known) -97.352386		
OPERATOR NAME Charter Oak Production Co., LLC	OTC/OCC OPERATOR NO. 21672			
ADDRESS 13929 Quail Pointe Dr.				
CITY Oklahoma City	STATE OK	ZIP 73134		

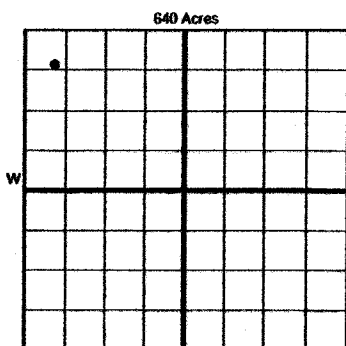

COMPLETION TYPE

<input checked="" type="checkbox"/> SINGLE ZONE
<input type="checkbox"/> MULTIPLE ZONE
Application Date
<input type="checkbox"/> COMMINGLED
Application Date
LOCATION 696938 E.O.
EXCEPTION ORDER
INCREASED DENSITY N/A
ORDER NO.

CASING & CEMENT (Form 1002C must be attached)

TYPE	SIZE	WEIGHT	GRADE	FEET	PSI	SAX	TOP OF CMT
CONDUCTOR	20"			82'			Surface
SURFACE	10 3/4"	45.5#	J-55	370		300	Surface
INTERMEDIATE	7 5/8"	29.7#	J-55	5059'		250	3420'
PRODUCTION	5 1/2   4 1/2	20#   13.5#	P-110	11,943'		920	3270'
LINER							
						TOTAL DEPTH	11,957'

PACKER @ \_\_\_\_\_ BRAND & TYPE \_\_\_\_\_ PLUG @ \_\_\_\_\_ TYPE \_\_\_\_\_ PLUG @ \_\_\_\_\_ TYPE \_\_\_\_\_  
PACKER @ \_\_\_\_\_ BRAND & TYPE \_\_\_\_\_ PLUG @ \_\_\_\_\_ TYPE \_\_\_\_\_ PLUG @ \_\_\_\_\_ TYPE \_\_\_\_\_

COMPLETION & TEST DATA BY PRODUCING FORMATION

FORMATION	Big Lime						
SPACING & SPACING ORDER NUMBER	480 Ac. - 692851						
CLASS: Oil, Gas, Dry, Inj, Disp, Comm Disp, Svc	Oil						
PERFORATED INTERVALS	5135' - 11,853' O.A.						
ACID/VOLUME	440,254 Gal 20% HCl						
FRACTURE TREATMENT (Fluids/Prop Amounts)	160,708 BBL slick water						
	715,060# 40/70 sand						
	1,805,870# 30/50 sand						

RECEIVED

JUL 06 2020

Oklahoma Corporation  
Commission

Reported  
to ETC EOCs



Min Gas Allowable

(165:10-17-7)

Gas Purchaser/Measurer

ETC Texas Pipeline, LTD

OR

First Sales Date

6/6/19

Oil Allowable

(165:10-13-3)

INITIAL TEST DATA

INITIAL TEST DATE	6/10/20					
OIL-BBL/DAY	93					
OIL-GRAVITY (API)	40.8					
GAS-MCF/DAY	246					
GAS-OIL RATIO CU FT/BBL	2645					
WATER-BBL/DAY	399					
PUMPING OR FLOWING	Pumping					
INITIAL SHUT-IN PRESSURE	1739 psi					
CHOKE SIZE	N/A					
FLOW TUBING PRESSURE	N/A					

A record of the formations drilled through, and pertinent remarks are presented on the reverse. I declare that I have knowledge of the contents of this report and am authorized by my organization to make this report; which was prepared by me or under my supervision and direction, with the data and facts stated herein to be true, correct, and complete to the best of my knowledge and belief.

SIGNATURE	NAME (PRINT OR TYPE)	DATE	PHONE NUMBER
13929 Quail Pointe Dr.	Oklahoma City OK 73134	6/25/20	(405) 286-0361
ADDRESS	CITY STATE ZIP	EMAIL ADDRESS	
		brevetti@charteroakproduction.com	

PLEASE TYPE OR USE BLACK INK ONLY  
FORMATION RECORD

Give formation names and tops, if available, or descriptions and thickness of formations drilled through. Show intervals cored or drillstem tested.

LEASE NAME Gleason

WELL NO. 1-35-3841

NAMES OF FORMATIONS	TOP
Big Lime	4944'

FOR COMMISSION USE ONLY

ITD on file ☐ YES ☐ NO

APPROVED \_\_\_\_\_ DISAPPROVED \_\_\_\_\_

2) Reject Codes \_\_\_\_\_

Were open hole logs run? ☐ yes ☒ no

Date Last log was run \_\_\_\_\_

Was CO<sub>2</sub> encountered? ☐ yes ☒ no at what depths? \_\_\_\_\_

Was H<sub>2</sub>S encountered? ☐ yes ☒ no at what depths? \_\_\_\_\_

Were unusual drilling circumstances encountered? ☐ yes ☒ no  
If yes, briefly explain below \_\_\_\_\_

Other remarks:

OCC - spacing order 692851 is an irregular 480 acre unit covering SW 1/4 Sec 30 - 21N - 1W and W 1/2 Sec 31 - 21N - 1W  
OCC - Order 700483 is an Exception to Rule 165:10-3-28 (C)(2)(B)

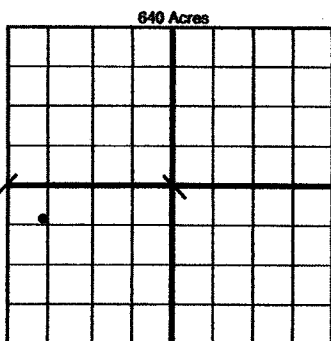

If more than three drainholes are proposed, attach a separate sheet indicating the necessary information.

Direction must be stated in degrees azimuth.  
Please note, the horizontal drainhole and its end point must be located within the boundaries of the lease or spacing unit.

Directional surveys are required for all drainholes and directional wells.

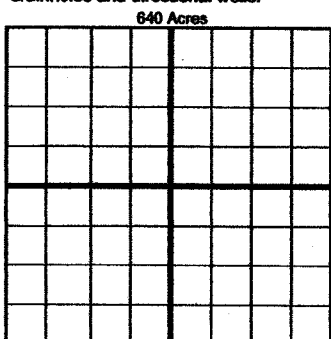

BOTTOM HOLE LOCATION FOR DIRECTIONAL HOLE

SEC	TWP	RGE	COUNTY				
30	21N	1W	Noble County				
Spot Location	1/4	1/4	1/4	1/4	Feet From 1/4 Sec Lines	FSL	FWL
Measured Total Depth	True Vertical Depth		BHL From Lease, Unit, or Property Line:				

BOTTOM HOLE LOCATION FOR HORIZONTAL HOLE: (LATERALS)

LATERAL #1

SEC	TWP	RGE	COUNTY				
30	21N	1W	Noble County				
Spot Location	SE 1/4	NW 1/4	NW 1/4	SW 1/4	Feet From 1/4 Sec Lines	FSL 613' FNL	FWL 641'
Depth of Deviation	3670'	Radius of Turn	883'	Direction	359.5° 360	Total Length	6745'
Measured Total Depth	11,957'	True Vertical Depth	4531'	BHL From Lease, Unit, or Property Line: 613'			

LATERAL #2

SEC	TWP	RGE	COUNTY				
30	21N	1W	Noble County				
Spot Location	1/4	1/4	1/4	1/4	Feet From 1/4 Sec Lines	FSL	FWL
Depth of Deviation		Radius of Turn		Direction		Total Length	
Measured Total Depth		True Vertical Depth		BHL From Lease, Unit, or Property Line:			

LATERAL #3

SEC	TWP	RGE	COUNTY				
30	21N	1W	Noble County				
Spot Location	1/4	1/4	1/4	1/4	Feet From 1/4 Sec Lines	FSL	FWL
Depth of Deviation		Radius of Turn		Direction		Total Length	
Measured Total Depth		True Vertical Depth		BHL From Lease, Unit, or Property Line:			