

Oklahoma Corporation Commission  
Oil & Gas Conservation Division  
Post Office Box 52000  
Oklahoma City, Oklahoma 73152-2000  
Rule 165: 10-3-25

Form 1002A

API No.: 35019264180001

**Completion Report**

Spud Date: November 06, 2020

OTC Prod. Unit No.: 019-012538-0-5383

Drilling Finished Date: November 17, 2020

1st Prod Date:

Completion Date: February 04, 2021

**Drill Type: DIRECTIONAL HOLE**

**SERVICE WELL**

Well Name: SW WILDCAT JIM DEESE UNIT 13-2-I

Purchaser/Measurer:

Location: CARTER 7 2S 2W  
NW NW SW NW  
1495 FNL 120 FWL of 1/4 SEC  
Latitude: 34.401201 Longitude: -97.457051  
Derrick Elevation: 0 Ground Elevation: 0

First Sales Date:

Operator: MACK ENERGY CO 11739

4700 GAILLARDIA PKWY STE 102  
OKLAHOMA CITY, OK 73142-1839

Completion Type		Location Exception		Increased Density	
X	Single Zone	Order No		Order No	
	Multiple Zone	N/A		N/A	
	Commingle				

Casing and Cement							
Type	Size	Weight	Grade	Feet	PSI	SAX	Top of CMT
SURFACE	9 5/8	40		1310		685	SURFACE
PRODUCTION	7	26		4440		235	1780

Liner								
Type	Size	Weight	Grade	Length	PSI	SAX	Top Depth	Bottom Depth
There are no Liner records to display.								

**Total Depth: 4440**

Packer		Plug	
Depth	Brand & Type	Depth	Plug Type
3123	AS-1X	There are no Plug records to display.	

Initial Test Data
-------------------

Test Date	Formation	Oil BBL/Day	Oil-Gravity (API)	Gas MCF/Day	Gas-Oil Ratio Cu FT/BBL	Water BBL/Day	Pumpin or Flowing	Initial Shut-In Pressure	Choke Size	Flow Tubing Pressure
-----------	-----------	-------------	-------------------	-------------	-------------------------	---------------	-------------------	--------------------------	------------	----------------------

There are no Initial Data records to display.

### Completion and Test Data by Producing Formation

Formation Name: DEESE

Code: 404DEESS

Class: INJ

#### Spacing Orders

Order No

Unit Size

There are no Spacing Order records to display.

#### Perforated Intervals

From

To

4206

4270

#### Acid Volumes

1,750 GALLONS 7.5%, 1,750 POUNDS ROCK SALT

#### Fracture Treatments

NONE

Formation Name: DEESE

Code: 404DEESS

Class: INJ

#### Spacing Orders

Order No

Unit Size

There are no Spacing Order records to display.

#### Perforated Intervals

From

To

3987

4165

#### Acid Volumes

6,000 GALLONS 7.5%, 6,000 POUNDS ROCK SALT

#### Fracture Treatments

NONE

Formation Name: DEESE

Code: 404DEESS

Class: INJ

#### Spacing Orders

Order No

Unit Size

There are no Spacing Order records to display.

#### Perforated Intervals

From

To

3914

3942

#### Acid Volumes

3,050 GALLONS 7.5%, 2,150 POUNDS ROCK SALT

#### Fracture Treatments

NONE

Formation Name: DEESE

Code: 404DEESS

Class: INJ

#### Spacing Orders

Order No

Unit Size

There are no Spacing Order records to display.

#### Perforated Intervals

From

To

3742

3780

#### Acid Volumes

3,050 GALLONS 7.5%, 2,1K50 POUNDS ROCK SALT

#### Fracture Treatments

NONE

Formation Name: DEESE		Code: 404DEESS		Class: INJ	
<b>Spacing Orders</b>			<b>Perforated Intervals</b>		
<b>Order No</b>	<b>Unit Size</b>		<b>From</b>	<b>To</b>	
There are no Spacing Order records to display.			3287	3613	
<b>Acid Volumes</b>			<b>Fracture Treatments</b>		
2,550 GALLONS 7.5%, 1,500 POUNDS ROCK SALT			NONE		

Formation Name: DEESE		Code: 404DEESS		Class: INJ	
<b>Spacing Orders</b>			<b>Perforated Intervals</b>		
<b>Order No</b>	<b>Unit Size</b>		<b>From</b>	<b>To</b>	
There are no Spacing Order records to display.			3161	3188	
<b>Acid Volumes</b>			<b>Fracture Treatments</b>		
2,150 GALLONS 7.5%, 1,500 POUNDS ROCK SALT			NONE		

<b>Formation</b>	<b>Top</b>
DEESE	2940

Were open hole logs run? Yes

Date last log run: November 15, 2020

Were unusual drilling circumstances encountered? No

Explanation:

<b>Other Remarks</b>
OCC - UIC PERMIT # 2100302201

<b>Bottom Holes</b>
Sec: 12 TWP: 2S RGE: 3W County: CARTER  NE NE SE NE  1453 FNL 80 FEL of 1/4 SEC  Depth of Deviation: 0 Radius of Turn: 0 Direction: 0 Total Length: 0  Measured Total Depth: 4580 True Vertical Depth: 4573 End Pt. Location From Release, Unit or Property Line: 80

<b>FOR COMMISSION USE ONLY</b>	
Status: Accepted	1146138

API NO. 019-26418  
OTC PROD. 019-012538-  
UNIT NO. 0-5383

(PLEASE TYPE OR USE BLACK INK ONLY)

OKLAHOMA CORPORATION COMMISSION

Oil & Gas Conservation Division

Post Office Box 52000

Oklahoma City, Oklahoma 73152-2000

Rule 165:10-3-25

Form 1002A

Rev. 2009

☒ ORIGINAL  
☐ AMENDED (Reason) \_\_\_\_\_

COMPLETION REPORT

TYPE OF DRILLING OPERATION

☐ STRAIGHT HOLE ☒ DIRECTIONAL HOLE ☐ HORIZONTAL HOLE  
☒ SERVICE WELL

If directional or horizontal, see reverse for bottom hole location.

COUNTY	Carter	SEC	7	TWP	2S	RGE	2W	SPUD DATE	11-6-20
LEASE NAME	SW WJDU				WELL NO.	13-2i	DRLG FINISHED DATE	11-17-20	
NW 1/4 NW 1/4 SW 1/4 NW 1/4				FOR OF 1/4 SEC	1495	FWL OF 1/4 SEC	120	DATE OF WELL COMPLETION	2-4-21
ELEVATION	Ground		Latitude (if known)		34.401201		Longitude (if known)		- 97.457051
OPERATOR NAME	Mack Energy Co.				OTC / OCC OPERATOR NO.		11739		
ADDRESS	P.O. Box 400								
CITY	Duncan			STATE	OK	ZIP	73534		

640 Acres

LOCATE WELL

COMPLETION TYPE

<input checked="" type="checkbox"/> SINGLE ZONE	
<input type="checkbox"/> MULTIPLE ZONE	
Application Date	
COMINGLED	
Application Date	
LOCATION EXCEPTION ORDER NO.	N/A
INCREASED DENSITY ORDER NO.	N/A

CASING & CEMENT (Attach Form 1002C)

TYPE	SIZE	WEIGHT	GRADE	FEET	PSI	SAX	TOP OF CMT
CONDUCTOR							
SURFACE	9 5/8"	40#		1310'		685	Surface
INTERMEDIATE							
PRODUCTION	7"	26#		4440'		235	1780'
LINER							

PACKER @ 3123' BRAND & TYPE AS-1X PLUG @ TYPE PLUG @ TYPE TOTAL DEPTH 4440'

COMPLETION & TEST DATA BY PRODUCING FORMATION

FORMATION	(L. Morris)	(M Morris)	(U. Morris)	(Carpenter)	(Tussy)	(Eason)
SPACING & SPACING						
ORDER NUMBER						
CLASS: Oil, Gas, Dry, Inj, Disp, Comm Disp, Svc	Inj	Inj	Inj	Inj	Inj	Inj
PERFORATED INTERVALS	4206 - 4270'	3987 - 4165'	3914 - 3942'	3742-3780'	3287 - 3613'	3161-3188'
ACID/VOLUME	1750 gals 7.5%, 1750# rock salt	6000 gals 7.5% 6000# rock salt	3050 gals 7.5% 2150# rs	U. Morris & Carpenter Acidized together	2550 gals 7.5%, 1500# rock salt	2150 gals 7.5%, 1500# rs
FRACTURE TREATMENT (Fluids/Prop Amounts)	none	none	none	none	none	none

No Frac

Min Gas Allowable (165:10-17-7) Gas Purchaser/Measurer  
OR  
Oil Allowable (165:10-13-3) First Sales Date

INITIAL TEST DATA

INITIAL TEST DATE	N/A Injection Well				
OIL-BBL/DAY					
OIL-GRAVITY (API)					
GAS-MCF/DAY					
GAS-OIL RATIO CU FT/BBL					
WATER-BBL/DAY					
PUMPING OR FLOWING					
INITIAL SHUT-IN PRESSURE					
CHOKE SIZE					
FLOW TUBING PRESSURE					

A record of the formations drilled through, and pertinent remarks are presented on the reverse. I declare that I have knowledge of the contents of this report and am authorized by my organization to make this report, which was prepared by me or under my supervision and direction, with the data and facts stated herein to be true, correct, and complete to the best of my knowledge and belief.

SIGNATURE	Dinah Mayes	DATE	2/17/2021	PHONE NUMBER	580-856-3705
3730 Samedan Rd.	Ratliff City	OK	73481	EMAIL ADDRESS	dmayes@mackenergy.com
ADDRESS	CITY	STATE	ZIP		

PLEASE TYPE OR USE BLACK INK ONLY  
FORMATION RECORD

Give formation names and tops, if available, or descriptions and thickness of formations drilled through. Show intervals cored or drillstem tested.

NAMES OF FORMATIONS	TOP
Deese	2940'

LEASE NAME SW WJDU WELL NO. 13-2i

FOR COMMISSION USE ONLY	
ITD on file <input type="checkbox"/> YES <input type="checkbox"/> NO	
APPROVED _____ DISAPPROVED _____	2) Reject Codes

Were open hole logs run?	<input checked="" type="checkbox"/> yes <input type="checkbox"/> no
Date Last log was run	<u>11/15/2020</u>
Was CO <sub>2</sub> encountered?	<input type="checkbox"/> yes <input checked="" type="checkbox"/> no at what depths? _____
Was H <sub>2</sub> S encountered?	<input type="checkbox"/> yes <input checked="" type="checkbox"/> no at what depths? _____
Were unusual drilling circumstances encountered?	<input type="checkbox"/> yes <input checked="" type="checkbox"/> no
If yes, briefly explain below	

Other remarks: Permit ~~2100302201~~ 2100302201

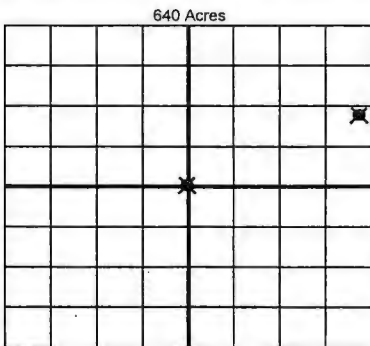

If more than three drainholes are proposed, attach a separate sheet indicating the necessary information.

Direction must be stated in degrees azimuth. Please note, the horizontal drainhole and its end point must be located within the boundaries of the lease or spacing unit.

Directional surveys are required for all drainholes and directional wells.

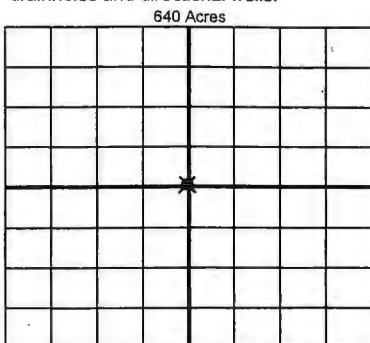

BOTTOM HOLE LOCATION FOR DIRECTIONAL HOLE

SEC 12	TWP 2S	RGE 3W	COUNTY Carter
Spot Location		NE 1/4	NE 1/4
Measured Total Depth		4580'	True Vertical Depth 4573'
Feet From 1/4 Sec Lines		FNL 1488'	FEL 80'
BHL From Lease, Unit, or Property Line: <u>1138' 80</u>			

BOTTOM HOLE LOCATION FOR HORIZONTAL HOLE: (LATERALS)

SEC	TWP	RGE	COUNTY
Spot Location		1/4	1/4
Depth of Deviation		Radius of Turn	Direction
Measured Total Depth		True Vertical Depth	BHL From Lease, Unit, or Property Line:

LATERAL #2

SEC	TWP	RGE	COUNTY
Spot Location		1/4	1/4
Depth of Deviation		Radius of Turn	Direction
Measured Total Depth		True Vertical Depth	BHL From Lease, Unit, or Property Line:

LATERAL #3

SEC	TWP	RGE	COUNTY
Spot Location		1/4	1/4
Depth of Deviation		Radius of Turn	Direction
Measured Total Depth		True Vertical Depth	BHL From Lease, Unit, or Property Line: