

Oklahoma Corporation Commission  
Oil & Gas Conservation Division  
Post Office Box 52000  
Oklahoma City, Oklahoma 73152-2000  
Rule 165: 10-3-25

Form 1002A

API No.: 35019264230000

**Completion Report**

Spud Date: December 29, 2020

OTC Prod. Unit No.: 019-226592-0-5383

Drilling Finished Date: January 04, 2021

1st Prod Date:

Completion Date: March 09, 2021

**Drill Type:** STRAIGHT HOLE

SERVICE WELL

DIRECTIONAL HOLE

Well Name: SW WILDCAT JIM DEESE UNIT 9-4

Purchaser/Measurer:

Location: CARTER 12 2S 3W  
NW NW SE NE  
1385 FNL 1016 FEL of 1/4 SEC  
Latitude: 34.401499 Longitude: -97.460814  
Derrick Elevation: 0 Ground Elevation: 1017

First Sales Date:

Operator: MACK ENERGY CO 11739

4700 GAILLARDIA PKWY STE 102  
OKLAHOMA CITY, OK 73142-1839

Completion Type		Location Exception		Increased Density	
X	Single Zone	Order No		Order No	
	Multiple Zone	There are no Location Exception records to display.		There are no Increased Density records to display.	
	Commingled				

Casing and Cement							
Type	Size	Weight	Grade	Feet	PSI	SAX	Top of CMT
SURFACE	9 5/8	40	K-55	1337		685	SURFACE
PRODUCTION	7	26	P-110	4830		375	800

Liner								
Type	Size	Weight	Grade	Length	PSI	SAX	Top Depth	Bottom Depth
There are no Liner records to display.								

**Total Depth: 4834**

Packer		Plug	
Depth	Brand & Type	Depth	Plug Type
3149	AS-1XIPC	4807	CEMENT & CASING SHOE

Initial Test Data
-------------------

Test Date	Formation	Oil BBL/Day	Oil-Gravity (API)	Gas MCF/Day	Gas-Oil Ratio Cu FT/BBL	Water BBL/Day	Pumpin or Flowing	Initial Shut-In Pressure	Choke Size	Flow Tubing Pressure
-----------	-----------	-------------	-------------------	-------------	-------------------------	---------------	-------------------	--------------------------	------------	----------------------

There are no Initial Data records to display.

### Completion and Test Data by Producing Formation

Formation Name: DEESE

Code: 404DEESS

Class: INJ

#### Spacing Orders

Order No	Unit Size
701901	UNIT

#### Perforated Intervals

From	To
4442	4567

#### Acid Volumes

2,500 GALLONS 7.5% NEFE, 2,400 POUNDS ROCK SALT

#### Fracture Treatments

There are no Fracture Treatments records to display.

Formation Name: DEESE

Code: 404DEESS

Class: INJ

#### Spacing Orders

Order No	Unit Size
701901	UNIT

#### Perforated Intervals

From	To
4197	4295

#### Acid Volumes

1,300 GALLONS 7.5% NEFE, 1,100 POUNDS ROCK SALT

#### Fracture Treatments

There are no Fracture Treatments records to display.

Formation Name: DEESE

Code: 404DEESS

Class: INJ

#### Spacing Orders

Order No	Unit Size
701901	UNIT

#### Perforated Intervals

From	To
4031	4069

#### Acid Volumes

1,300 GALLONS 7.5% NEFE, 1,100 POUNDS ROCK SALT

#### Fracture Treatments

There are no Fracture Treatments records to display.

Formation Name: DEESE

Code: 404DEESS

Class: INJ

#### Spacing Orders

Order No	Unit Size
701901	UNIT

#### Perforated Intervals

From	To
3894	3913

#### Acid Volumes

800 GALLONS 7.5% NEFE, 600 POUNDS ROCK SALT

#### Fracture Treatments

There are no Fracture Treatments records to display.

Formation Name: DEESE

Code: 404DEESS

Class: INJ

**Spacing Orders**

Order No	Unit Size
701901	UNIT

**Perforated Intervals**

From	To
3644	3860

**Acid Volumes**

1,300 GALLONS 7.5% NEFE, 1,100 POUNDS ROCK SALT, 1,500 GALLONS 7.5% NEFE, 1,300 POUNDS ROCK SALT

**Fracture Treatments**

There are no Fracture Treatments records to display.

Formation	Top
CISCO	1517
HOXBAR	2007
COUNTY LINE LIME	2255
COUNTY LINE SAND	2328
TATUMS	2480
DEESE GROUP	2987
FUSULINID	3120
EASON	3242
TUSSY	3376
TUSSY LIME	3397
CARPENTER SANDS	3690
MORRIS	4025

Were open hole logs run? Yes

Date last log run: January 03, 2021

Were unusual drilling circumstances encountered? No

Explanation:

**Other Remarks**

OCC - UIC PERMIT 2100402303. PER OPERATOR-THIS WELL HAS BECOME PART OF THE NEWLY FORMED SW WILDCAT JIM DEESE UNIT (SW WJDU) APPROVED AS OF SEPTEMBER 9, 2019.

**Bottom Holes**

Sec: 12 TWP: 2S RGE: 3W County: CARTER

SE SW NE NE

1144 FNL 844 FEL of 1/4 SEC

Depth of Deviation: 0 Radius of Turn: 0 Direction: 0 Total Length: 0

Measured Total Depth: 4819 True Vertical Depth: 4802 End Pt. Location From Release, Unit or Property Line: 844

**FOR COMMISSION USE ONLY**

1146311

Status: Accepted



PLEASE TYPE OR USE BLACK INK ONLY

FORMATION RECORD

Give formation names and tops, if available, or descriptions and thickness of formations drilled through. Show intervals cored or drillstem tested.

NAMES OF FORMATIONS	TOP
Cisco	1517'
Hoxbar	2007'
County Line Lime	2255'
County Line Sand	2328'
Tatums	2480'
Deese Group	2987'
Fussulinid	3120'
Eason	3242'
Tussy	3376'
Tussy Lime	3397'
Carpenter Sands	3690'
Morris	4025'

LEASE NAME SW WJDU WELL NO. 9-4

FOR COMMISSION USE ONLY	
ITD on file <input type="checkbox"/> YES <input type="checkbox"/> NO	
APPROVED _____	DISAPPROVED _____
2) Reject Codes _____	
_____	
_____	
_____	
_____	

Were open hole logs run?	<input checked="" type="checkbox"/> yes <input type="checkbox"/> no
Date Last log was run	<u>1/3/2021</u>
Was CO <sub>2</sub> encountered?	<input type="checkbox"/> yes <input checked="" type="checkbox"/> no at what depths? _____
Was H <sub>2</sub> S encountered?	<input type="checkbox"/> yes <input checked="" type="checkbox"/> no at what depths? _____
Were unusual drilling circumstances encountered?	<input type="checkbox"/> yes <input checked="" type="checkbox"/> no
If yes, briefly explain below _____	

Other remarks: This well has become part of the newly formed SW Wildcat Jim Deese Unit (SW WJDU) approved as of 9-9-19

*OCC- UIC permit 2100402303*

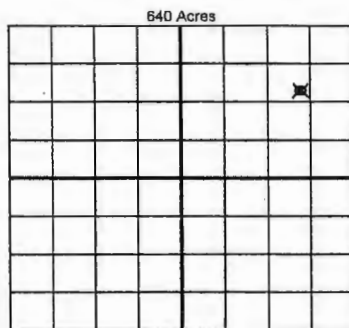

If more than three drainholes are proposed, attach a separate sheet indicating the necessary information.

Direction must be stated in degrees azimuth. Please note, the horizontal drainhole and its end point must be located within the boundaries of the lease or spacing unit.

Directional surveys are required for all drainholes and directional wells.

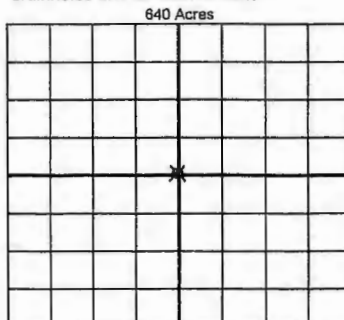

BOTTOM HOLE LOCATION FOR DIRECTIONAL HOLE

SEC 12	TWP 2S	RGE 3W	COUNTY	Carter	<u>1144</u>	<u>844</u>
Spot Location				FEET FROM 1/4 SEC LINES	FNL <u>1053</u>	FEL <u>851</u>
SE 1/4 SW 1/4 NE 1/4 NE 1/4						
Measured Total Depth <u>4713' 4819</u>		True Vertical Depth <u>4700' 4802</u>		BHL From Lease, Unit, or Property Line: <u>530'</u>		

BOTTOM HOLE LOCATION FOR HORIZONTAL HOLE: (LATERALS)

SEC	TWP	RGE	COUNTY
Spot Location			
1/4	1/4	1/4	1/4
Depth of Deviation		Radius of Turn	Direction
Measured Total Depth		True Vertical Depth	BHL From Lease, Unit, or Property Line:

LATERAL #2

SEC	TWP	RGE	COUNTY
Spot Location			
1/4	1/4	1/4	1/4
Depth of Deviation		Radius of Turn	Direction
Measured Total Depth		True Vertical Depth	BHL From Lease, Unit, or Property Line:

LATERAL #3

SEC	TWP	RGE	COUNTY
Spot Location			
1/4	1/4	1/4	1/4
Depth of Deviation		Radius of Turn	Direction
Measured Total Depth		True Vertical Depth	BHL From Lease, Unit, or Property Line: