

Oklahoma Corporation Commission
Oil & Gas Conservation Division
Post Office Box 52000
Oklahoma City, Oklahoma 73152-2000
Rule 165: 10-3-25

Form 1002A

API No.: 35071244420002

Completion Report

Spud Date: July 23, 2011

OTC Prod. Unit No.: 071-206471-0-0000

Drilling Finished Date: July 28, 2011

Amended

Amend Reason: COMPLETE, PERFORATE, AND ACIDIZE CLEVELAND FORMATION / SET CIBP AT 3,358' COMMINGLE WITH BIG LIME-OSWEGO

1st Prod Date: September 07, 2011

Completion Date: September 07, 2011

Recomplete Date: October 07, 2021

Drill Type: STRAIGHT HOLE

Well Name: DICKERSON 1-34

Purchaser/Measurer:

Location: KAY 34 29N 1W
C NW SE
1980 FSL 660 FWL of 1/4 SEC
Derrick Elevation: 1107 Ground Elevation: 1094

First Sales Date:

Operator: BARBER OIL LLC 24363

8801 S YALE AVE STE 150
TULSA, OK 74137-3575

Completion Type		Location Exception		Increased Density	
	Single Zone	Order No		Order No	
	Multiple Zone	There are no Location Exception records to display.		There are no Increased Density records to display.	
X	Commingled				

Casing and Cement							
Type	Size	Weight	Grade	Feet	PSI	SAX	Top of CMT
SURFACE	8 5/8	24		329		230	SURFACE
PRODUCTION	5 1/2	15.5		3683		260	1283

Liner								
Type	Size	Weight	Grade	Length	PSI	SAX	Top Depth	Bottom Depth
There are no Liner records to display.								

Total Depth: 3689

Packer		Plug	
Depth	Brand & Type	Depth	Plug Type
There are no Packer records to display.		3358	CIBP

Initial Test Data										
Test Date	Formation	Oil BBL/Day	Oil-Gravity (API)	Gas MCF/Day	Gas-Oil Ratio Cu FT/BBL	Water BBL/Day	Pumpin or Flowing	Initial Shut-In Pressure	Choke Size	Flow Tubing Pressure
Oct 07, 2021	CLEVELAND,OSWEGO	0.5	41			80	PUMPING			

Completion and Test Data by Producing Formation

Formation Name: BIG LIME-OSWEGO

Code: 404BGLO

Class: OIL

Spacing Orders

Order No	Unit Size
587735	320

Perforated Intervals

From	To
3301	3306
3336	3342

Acid Volumes

1,000 GALLONS

Fracture Treatments

NONE

Formation Name: BIG LIME-OSWEGO

Code: 404BGLO

Class: OIL

Spacing Orders

Order No	Unit Size
587735	320

Perforated Intervals

From	To
3302	3312
3337	3343

Acid Volumes

2,500 GALLONS

Fracture Treatments

NONE

Formation Name: CLEVELAND

Code: 405CLVD

Class: OIL

Spacing Orders

Order No	Unit Size
587735	320

Perforated Intervals

From	To
3165	3172
3175	3178
3181	3196

Acid Volumes

1,000 GALLONS

Fracture Treatments

45,000 POUNDS SAND, 948 BARRELS

Formation Name: CLEVELAND

Code: 405CLVD

Class: OIL

Spacing Orders

Order No	Unit Size
587735	320

Perforated Intervals

From	To
3198	3202
3205	3206
3210	3216

Acid Volumes

There are no Acid Volume records to display.

Fracture Treatments

There are no Fracture Treatments records to display.

Formation Name: CLEVELAND,OSWEGO

Code: 999CDOG

Class: OIL

Formation	Top
TONKAWA	2436
LAYTON	2874
CLEVELAND	3166
BARTLESVILLE	3431
WILCOX	3650

Were open hole logs run? Yes

Date last log run: July 28, 2008

Were unusual drilling circumstances encountered? No

Explanation:

Other Remarks

There are no Other Remarks.

FOR COMMISSION USE ONLY

1147013

Status: Accepted

API NO. 071-24442
 OTC PROD. UNIT NO. 071-206471

Oil and Gas Conservation Division
 P.O. Box 52000
 Oklahoma City, OK 73152-2000
 405-522-0577
 OCCCentralProcessing@OCC.OK.GOV



OKLAHOMA
 Corporation
 Commission

RECEIVED

OCT 18 2021

Form 1002A
 Rev. 2020

ORIGINAL
 AMENDED (Reason) Complete perf and acidize Cleveland formation

TYPE OF DRILLING OPERATION Set CIBP 3350

☒ STRAIGHT HOLE ☐ DIRECTIONAL HOLE ☐ HORIZONTAL HOLE
☐ SERVICE WELL

If directional or horizontal, see reverse for bottom hole location.

COUNTY Kay SEC 34 TWP 29N RGE 1W

LEASE NAME Dickerson WELL NO. 1-34

1/4 C 1/4 NW 1/4 SE 1/4 SW FSL 1980' FWL 660'

ELEVATION 1107 Ground 1094 Latitude Longitude

OPERATOR NAME Barber Oil, LLC OTC / OCC OPERATOR NO. 24363

ADDRESS 8801 South Yale Avenue, Suite 150

CITY Tulsa STATE OK ZIP 74137

Rule 185:10-3-25

COMPLETION REPORT

OKLAHOMA CORPORATION
 COMMISSION

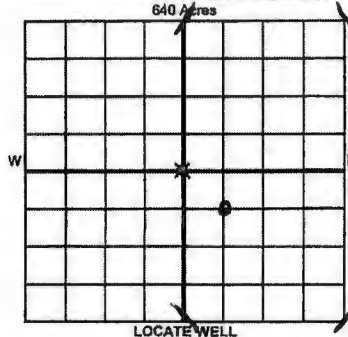

COMPLETION TYPE

☐ SINGLE ZONE
☐ MULTIPLE ZONE
☒ COMMINGLED
 LOCATION EXCEPTION ORDER NO.
 MULTIUNIT ORDER NO.
 INCREASED DENSITY ORDER NO.

CASING & CEMENT (Attach Form 1002C)

TYPE	SIZE	WEIGHT	GRADE	FEET	PSI	SAX	TOP OF CMT
CONDUCTOR						230	
SURFACE	8 5/8"	24#		329		200	Surface
INTERMEDIATE							
PRODUCTION	5 1/2	15.5#		280-3603		260	1283
LINER							

PACKER @ BRAND & TYPE CIBP @ 3350 PLUG @ TYPE PLUG @ TYPE TOTAL DEPTH 3689'

PACKER @ BRAND & TYPE PLUG @ TYPE PLUG @ TYPE

COMPLETION & TEST DATA BY PRODUCING FORMATION 404BGLD 404BKVL 404BGLD 351MISS 405CLVD

FORMATION	351MISS	Mississippi	Big Lime-Oswego	Bartlesville	Big Lime-Oswego	Mississippi	Cleveland
SPACING & SPACING ORDER NUMBER	587735 - 320 A	587735 - 320A	587735-320 A	587735-320 A	587735 - 320A	587735 - 320 A	587735 - 320 A
CLASS: Oil, Gas, Dry, Inj, Disp, Comm Disp, Svc	<u>Gas Dry</u>	<u>Gas</u>	<u>Gas Dry</u>	<u>Gas</u>	<u>Gas Dry</u>	<u>Oil</u>	
PERFORATED INTERVALS	3596'-3609'	3301'-3306'	3436'-3440'	3337'-3343'	3482'-3495'	3165'-3172'	3175'-3178'
	3482'-3490'	3336'-3342'		3302'-3312'	3596'-3609'	3181'-3196'	
ACID/VOLUME	1000 gal	1000 gal	1000 gal	2500 gal	1500 gal	1000 gal	
FRACTURE TREATMENT (Fluids/Prop Amounts)	no	no	no	no	30000# sand	45,000 # sand	948 bbls

X out below CIBP at 3350

Min Gas Allowable (185:10-17-7) OR Oil Allowable (185:10-13-3)

Purchaser/Measurer First Sales Date

INITIAL TEST DATA

INITIAL TEST DATE	9/8/2011	9/16/2011	9/8/2011	9/6/2011	5/1/2012	see
OIL-BBL/DAY	2.34	3.51	0	2.5	.5	next page
OIL-GRAVITY (API)	41	39	NA	39	40	
GAS-MCF/DAY	40.5	45.2	30000	45000	50000	
GAS-OIL RATIO CU FT/BBL	17308	12877	30000	18000000	100000000	nan
WATER-BBL/DAY	5.85	4.68	0	4.68	8	
PUMPING OR FLOWING	flow	flow	flow	flow	Flow	
INITIAL SHUT-IN PRESSURE	1020	1100	250	1100	600	
CHOKE SIZE	16/64	16/64	1/4	1/4	1/4	
FLOW TUBING PRESSURE	110	80	20	80	40	

A record of the formations drilled through, and pertinent remarks are presented on the reverse. I declare that I have knowledge of the contents of this report and am authorized by my organization to make this report, which was prepared by me or under my supervision and direction, with the data and facts stated herein to be true, correct, and complete to the best of my knowledge and belief.

Barbara Courtney SIGNATURE
 8801 South Yale Ave, Suite 150 ADDRESS
 Tulsa CITY
 OK STATE
 74137 ZIP

Barbara Courtney NAME (PRINT OR TYPE)
 10/14/2021 DATE
 918-638-5951 PHONE NUMBER
 bcourtney@barberoilco.com EMAIL ADDRESS

API NO. 071-24442
OTC PROD. UNIT NO. 71-206471

Oil and Gas Conservation Division
P.O. Box 52000
Oklahoma City, OK 73152-2000
405-522-0577
OCCCentralProcessing@OCC.OK.GOV



OKLAHOMA
Corporation
Commission

page
2 of 3

Form 1002A
Rev. 2020

☒ ORIGINAL
☐ AMENDED (Reason) Complete part and acidize Cleveland formation

Rule 165:10-3-25

COMPLETION REPORT

TYPE OF DRILLING OPERATION
☒ STRAIGHT HOLE ☐ DIRECTIONAL HOLE ☐ HORIZONTAL HOLE
☐ SERVICE WELL

If directional or horizontal, see reverse for bottom hole location.

COUNTY	Kay	SEC	34	TWP	29N	RGE	1W
LEASE NAME	Dickerson			WELL NO.	1-34		
1/4	C	1/4	NW	1/4	SE	1/4	SW
ELEVATION	1107	Ground	1094	Latitude	Longitude		
OPERATOR NAME	Barber Oil, LC			OTC / OCC OPERATOR NO.	24363		
ADDRESS	8801 South Yale Avenue, Suite 150						
CITY	Tulsa		STATE	OK	ZIP	74137	

SPUD DATE 7/23/2011
DRLG FINISHED DATE 7/28/2011
DATE OF WELL COMPLETION 9/7/2011
1st PROD DATE 9/7/2011
RECOMP DATE 10/7/2021

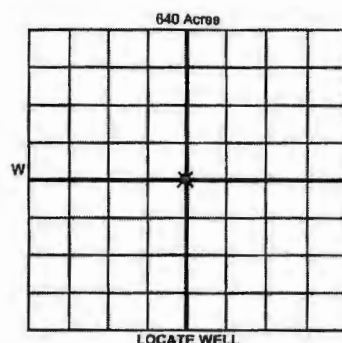

COMPLETION TYPE

<input type="radio"/> SINGLE ZONE	
<input checked="" type="radio"/> MULTIPLE ZONE	
<input type="radio"/> COMMINGLED	
LOCATION EXCEPTION ORDER NO.	
MULTIUNIT ORDER NO.	
INCREASED DENSITY ORDER NO.	

CASING & CEMENT (Attach Form 1002C)

TYPE	SIZE	WEIGHT	GRADE	FEET	PSI	SAX	TOP OF CMT
CONDUCTOR							
SURFACE	8 5/8"	24#		329		200	Surface
INTERMEDIATE							
PRODUCTION	5 1/2"	15.5#		260			1283
LINER							

PACKER @ BRAND & TYPE CIBP PLUG @ 3358' TYPE PLUG @ TYPE TOTAL DEPTH 3689'

COMPLETION & TEST DATA BY PRODUCING FORMATION

FORMATION	Cleveland
SPACING & SPACING ORDER NUMBER	587735 - 320 A
CLASS: Oil, Gas, Dry, Inj, Disp, Comm Disp, Svc	Oil
PERFORATED INTERVALS	3198'-3202' 3205'-3206' 3210'-3216'
ACID/VOLUME	
FRACTURE TREATMENT (Fluids/Prop Amounts)	

☐ Min Gas Allowable (165:10-17-7)
OR
☐ Oil Allowable (165:10-13-3)

Purchaser/Messenger
First Sales Date

INITIAL TEST DATA

INITIAL TEST DATE	10/7/2021
OIL-BBL/DAY	.50
OIL-GRAVITY (API)	41
GAS-MCF/DAY	0
GAS-OIL RATIO CU FT/BBL	0
WATER-BBL/DAY	80
PUMPING OR FLOWING	Pumping
INITIAL SHUT-IN PRESSURE	
CHOKE SIZE	
FLOW TUBING PRESSURE	

A record of the formations drilled through, and pertinent remarks are presented on the reverse. I declare that I have knowledge of the contents of this report and am authorized by my organization to make this report, which was prepared by me or under my supervision and direction, with the data and facts stated herein to be true, correct, and complete to the best of my knowledge and belief.

SIGNATURE	Barbara Courtney	DATE	9/18-638-5951
8801 South Yale Ave, Suite 150	Tulsa OK 74137	PHONE NUMBER	
ADDRESS	CITY STATE ZIP	EMAIL ADDRESS	bcourtney@barberoilo.com

PLEASE TYPE OR USE BLACK INK ONLY
FORMATION RECORD

Give formation names and tops, if available, or descriptions and thickness of formations drilled through. Show intervals cored or drillstem tested.

NAMES OF FORMATIONS	TOP
Tonkawa	2436
Layton	2874
Cleveland	3166
Bartlesville	3431
Wilcox	3650

LEASE NAME _____ WELL NO. _____

FOR COMMISSION USE ONLY

ITD on file ☐ YES ☐ NO

APPROVED _____ DISAPPROVED _____ 2) Reject Codes _____

Were open hole logs run? ☒ yes ☐ no

Date Last log was run _____ 7/28/2011

Was CO₂ encountered? ☐ yes ☒ no at what depths? _____

Was H₂S encountered? ☐ yes ☒ no at what depths? _____

Were unusual drilling circumstances encountered? ☐ yes ☒ no

If yes, briefly explain below _____

Other remarks: _____

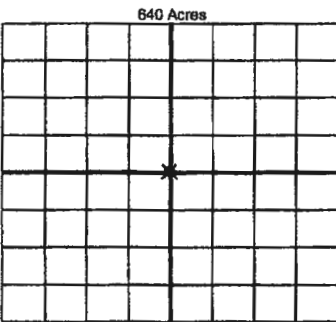

If more than three drainholes are proposed, attach a separate sheet indicating the necessary information.

Direction must be stated in degrees azimuth. Please note, the horizontal drainhole and its end point must be located within the boundaries of the lease or spacing unit.

Directional surveys are required for all drainholes and directional wells

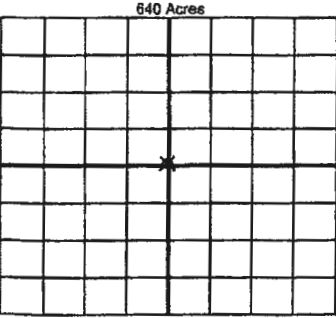

BOTTOM HOLE LOCATION FOR DIRECTIONAL HOLE

SEC	TWP	RGE	COUNTY
1/4	1/4	1/4	1/4
Measured Total Depth		True Vertical Depth	Feet From 1/4 Sec Lines
BHL From Lease, Unit, or Property Line:			

BOTTOM HOLE LOCATION FOR HORIZONTAL HOLE: (LATERALS)

LATERAL #1

SEC	TWP	RGE	COUNTY
1/4	1/4	1/4	1/4
Depth of Deviation		Radius of Turn	Direction
Measured Total Depth		True Vertical Depth	Total Length
BHL From Lease, Unit, or Property Line:			

LATERAL #2

SEC	TWP	RGE	COUNTY
1/4	1/4	1/4	1/4
Depth of Deviation		Radius of Turn	Direction
Measured Total Depth		True Vertical Depth	Total Length
BHL From Lease, Unit, or Property Line:			

LATERAL #3

SEC	TWP	RGE	COUNTY
1/4	1/4	1/4	1/4
Depth of Deviation		Radius of Turn	Direction
Measured Total Depth		True Vertical Depth	Total Length
BHL From Lease, Unit, or Property Line:			