

Oklahoma Corporation Commission
Oil & Gas Conservation Division
Post Office Box 52000
Oklahoma City, Oklahoma 73152-2000
Rule 165: 10-3-25

Form 1002A

API No.: 35019262870000

Completion Report

Spud Date: March 09, 2018

OTC Prod. Unit No.: 019-225294-0-0000

Drilling Finished Date: June 16, 2018

1st Prod Date: June 11, 2019

Completion Date: June 11, 2019

Drill Type: HORIZONTAL HOLE

Well Name: LAWSON 3-13H14X

Purchaser/Measurer: TARGA, ETC

Location: CARTER 13 3S 2E
NE SE SE SE
650 FSL 289 FEL of 1/4 SEC
Latitude: 34.290472 Longitude: -97.038855
Derrick Elevation: 0 Ground Elevation: 716

First Sales Date: 06/11/2019

Operator: XTO ENERGY INC 21003

22777 SPRINGWOODS VILLAGE PKWY
SPRING, TX 77389-1425

Completion Type		Location Exception		Increased Density	
X	Single Zone	Order No		Order No	
	Multiple Zone	701456		674281	
	Commingled			674954	

Casing and Cement							
Type	Size	Weight	Grade	Feet	PSI	SAX	Top of CMT
CONDUCTOR	20	53	PE&B	110			
SURFACE	9 5/8	36	J-55	2018		510	SURFACE
PRODUCTION	5 1/2	23	P-110	22843		2910	8550

Liner								
Type	Size	Weight	Grade	Length	PSI	SAX	Top Depth	Bottom Depth
There are no Liner records to display.								

Total Depth: 22843

Packer	
Depth	Brand & Type
There are no Packer records to display.	

Plug	
Depth	Plug Type
There are no Plug records to display.	

Initial Test Data

Test Date	Formation	Oil BBL/Day	Oil-Gravity (API)	Gas MCF/Day	Gas-Oil Ratio Cu FT/BBL	Water BBL/Day	Pumpin or Flowing	Initial Shut-In Pressure	Choke Size	Flow Tubing Pressure
Jul 16, 2019	WOODFORD	228	57	4276	18754	1200	FLOWING	974	53/64	568

Completion and Test Data by Producing Formation	
Formation Name: WOODFORD	Code: 319WDFD
Class: GAS	

Spacing Orders	
Order No	Unit Size
197431	640
701453	MULTIUNIT

Perforated Intervals	
From	To
12576	22704

Acid Volumes	
1000 GALLONS TOTAL ACID	

Fracture Treatments	
552,695 BARRELS TOTAL TREATED WATER, 1,629,120 LBS 100 MESH SAND, 13,979,486 LBS 40/70 SAND	

Formation	Top
WOODFORD	12365

Were open hole logs run? No
Date last log run:

Were unusual drilling circumstances encountered? No
Explanation:

Other Remarks
There are no Other Remarks.

Lateral Holes
<p>Sec: 14 TWP: 3S RGE: 2E County: CARTER</p> <p>NW NW NW SW</p> <p>2335 FSL 34 FWL of 1/4 SEC</p> <p>Depth of Deviation: 12100 Radius of Turn: 1018 Direction: 269 Total Length: 9139</p> <p>Measured Total Depth: 22843 True Vertical Depth: 11893 End Pt. Location From Release, Unit or Property Line: 34</p>

FOR COMMISSION USE ONLY	
Status: Accepted	1143552

API NO. 019-26287
OTC PROD. UNIT NO. 019-225294

(PLEASE TYPE OR USE BLACK INK ONLY)

OKLAHOMA CORPORATION COMMISSION
Oil & Gas Conservation Division
Post Office Box 52000
Oklahoma City, Oklahoma 73152-2000
Rule 165:10-3-25

RECEIVED
JUL 18 2019
Oklahoma Corporation
Commission

Form 1002A
Rev. 2009

☒ ORIGINAL
☐ AMENDED (Reason)

TYPE OF DRILLING OPERATION

☐ STRAIGHT HOLE ☐ DIRECTIONAL HOLE ☒ HORIZONTAL HOLE
☐ SERVICE WELL

If directional or horizontal, see reverse for bottom hole location.

COUNTY Carter SEC 13 TWP 3S RGE 2E
LEASE NAME Lawson 3-13H14X
NE 1/4 SE 1/4 SE 1/4 FSL OF 650 1/4 SEC 289
ELEVATION Derrick FL Ground 716' Latitude (if known) 34.290472 Longitude (if known) -97.038855
OPERATOR NAME XTO Energy Inc. OTC / OCC OPERATOR NO. 21003
ADDRESS 210 Park Avenue, Suite 2350
CITY Oklahoma City STATE Oklahoma ZIP 73102

COMPLETION REPORT

SPUD DATE 3/9/2018
DRLG FINISHED DATE 6/16/2018
DATE OF WELL COMPLETION 6/11/2019
1st PROD DATE 6/11/2018
RECOMP DATE
W E

640 Acres
LOCATE WELL

COMPLETION TYPE

☒ SINGLE ZONE
☐ MULTIPLE ZONE
Application Date
COMINGLED
Application Date
LOCATION EXCEPTION ORDER NO.
INCREASED DENSITY ORDER NO. 674954, 674281

CASING & CEMENT (Attach Form 1002C)

TYPE	SIZE	WEIGHT	GRADE	FEET	PSI	SAX	TOP OF CMT
CONDUCTOR	20"	53	PE&B	110			
SURFACE	9 5/8"	36	J-55	2018		510	Surface
INTERMEDIATE							
PRODUCTION	5 1/2"	23	P-110	22843		2910	8550'
LINER							
TOTAL DEPTH							22843'

PACKER @ BRAND & TYPE PLUG @ TYPE PLUG @ TYPE
PACKER @ BRAND & TYPE PLUG @ TYPE PLUG @ TYPE

COMPLETION & TEST DATA BY PRODUCING FORMATION

FORMATION	Woodford	319 WDED				
SPACING & SPACING ORDER NUMBER	640: 197431	701453 (Multiunit)				Reported to FracFocus
CLASS: Oil, Gas, Dry, Inj, Disp, Comm Disp, Svc	Gas					
PERFORATED INTERVALS	36 Stages					
	12576-22704					
ACID/VOLUME	1000 gals					
FRACTURE TREATMENT (Fluids/Prop Amounts)	552,695 BTW Bbs Treated Water					
	1,629,120#100 Mesh Sand					
	13,979,486# 40/70 Sand					

Min Gas Allowable (165:10-17-7)
OR
Oil Allowable (165:10-13-3)

Gas Purchaser/Measurer
First Sales Date

Targa, ETC
6/11/2019

INITIAL TEST DATA

INITIAL TEST DATE	7/16/2019					
OIL-BBL/DAY	228					
OIL-GRAVITY (API)	57					
GAS-MCF/DAY	4276					
GAS-OIL RATIO CU FT/BBL	18754					
WATER-BBL/DAY	1200					
PUMPING OR FLOWING	Flowing					
INITIAL SHUT-IN PRESSURE	974 psi					
CHOKE SIZE	53/64"					
FLOW TUBING PRESSURE	568					

AS SUBMITTED

A record of the formations drilled through, and pertinent remarks are presented on the reverse. I declare that I have knowledge of the contents of this report and am authorized by my organization to make this report, which was prepared by me or under my supervision and direction, with the data and facts stated herein to be true, correct, and complete to the best of my knowledge and belief.

SIGNATURE *Debbie Waggoner* NAME (PRINT OR TYPE) Debbie Waggoner DATE 7/17/2019 PHONE NUMBER 405-319-3243
210 Park Avenue, Suite 2350 ADDRESS Oklahoma City CITY Ok STATE 73102 ZIP
debbie_waggoner@xtoenergy.com EMAIL ADDRESS

PLEASE TYPE OR USE BLACK INK ONLY
FORMATION RECORD

Give formation names and tops, if available, or descriptions and thickness of formations drilled through. Show intervals cored or drillstem tested.

LEASE NAME Lawson WELL NO. 3-13H14X

NAMES OF FORMATIONS	TOP
Woodford	12365'

FOR COMMISSION USE ONLY

ITD on file ☐ YES ☐ NO

APPROVED _____ DISAPPROVED _____

2) Reject Codes _____

Were open hole logs run? _____ yes ☒ no

Date Last log was run _____

Was CO₂ encountered? _____ yes ☒ no at what depths? _____

Was H₂S encountered? _____ yes ☒ no at what depths? _____

Were unusual drilling circumstances encountered? _____ yes ☒ no

If yes, briefly explain below _____

Other remarks: Irregular Section



If more than three drainholes are proposed, attach a separate sheet indicating the necessary information.

Direction must be stated in degrees azimuth. Please note, the horizontal drainhole and its end point must be located within the boundaries of the lease or spacing unit.

Directional surveys are required for all drainholes and directional wells.

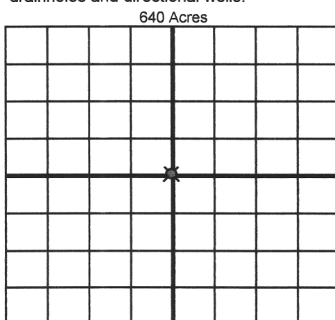

BOTTOM HOLE LOCATION FOR DIRECTIONAL HOLE

SEC	TWP	RGE	COUNTY
Spot Location		Feet From 1/4 Sec Lines	FSL
1/4	1/4	1/4	FWL
Measured Total Depth	True Vertical Depth	BHL From Lease, Unit, or Property Line:	

BOTTOM HOLE LOCATION FOR HORIZONTAL HOLE: (LATERALS)

LATERAL #1

SEC	TWP	RGE	COUNTY
14	3S	2E	Carter
Spot Location		Feet From 1/4 Sec Lines	FSL
NW 1/4	NW 1/4	NW 1/4	FWL 34
Depth of Deviation	Radius of Turn	Direction	Total Length
12,100	1018.6	269-279.3	9,143
Measured Total Depth	True Vertical Depth	BHL From Lease, Unit, or Property Line:	
22,843	11,893	-2335 FSL & 34 FWL	

LATERAL #2

SEC	TWP	RGE	COUNTY
Spot Location		Feet From 1/4 Sec Lines	FSL
1/4	1/4	1/4	FWL
Depth of Deviation	Radius of Turn	Direction	Total Length
Measured Total Depth	True Vertical Depth	BHL From Lease, Unit, or Property Line:	

LATERAL #3

SEC	TWP	RGE	COUNTY
Spot Location		Feet From 1/4 Sec Lines	FSL
1/4	1/4	1/4	FWL
Depth of Deviation	Radius of Turn	Direction	Total Length
Measured Total Depth	True Vertical Depth	BHL From Lease, Unit, or Property Line:	

effective date 6/14/19 7-18-2019 (Paper Copy)

Oklahoma Corporation Commission
Oil & Gas Conservation Division
Post Office Box 52000
Oklahoma City, Oklahoma 73152-2000
Rule 165: 10-3-25

Form 1002

1002A
Addendum

API No.: 3501926287000

Completion Report

Spud Date: March 09, 2018

OTC Prod. Unit No.: 019-225294-0-0000 ✓

Drilling Finished Date: June 16, 2018

1st Prod Date: June 11, 2019

Completion Date: June 11, 2019

Drill Type: HORIZONTAL HOLE

Well Name: LAWSON 3-13H14X

Purchaser/Measurer: TARGA, ETC

Location: CARTER 13 3S 2E
NE SE SE SE
650 FSL 289 FEL of 1/4 SEC
Latitude: 34.290472 Longitude: -97.038855
Derrick Elevation: 0 Ground Elevation: 716

First Sales Date: 06/11/2019

Operator: XTO ENERGY INC 21003

22777 SPRINGWOODS VILLAGE PKWY
SPRING, TX 77389-1425

Multiunit =
SHL (Sec 13) - 49.61% 225294 I
(Sec 14) - 50.39% 225294 AI

Completion Type		Location Exception		Increased Density	
X	Single Zone	Order No		Order No	
	Multiple Zone	701456		674281	
	Commingled			674954	

sep Alluv
Sec 13 - 675021
Sec 14 - 674885

Casing and Cement							
Type	Size	Weight	Grade	Feet	PSI	SAX	Top of CMT
CONDUCTOR	20	53	PE&B	110			
SURFACE	9 5/8	36	J-55	2018		510	SURFACE
PRODUCTION	5 1/2	23	P-110	22843		2910	8550

Liner								
Type	Size	Weight	Grade	Length	PSI	SAX	Top Depth	Bottom Depth
There are no Liner records to display.								

Total Depth: 22843

Packer	
Depth	Brand & Type
There are no Packer records to display.	

Plug	
Depth	Plug Type
There are no Plug records to display.	

Initial Test Data

7-16-2019

319 WDFD

~~TEST~~ Scale

974 psi

October 02, 2019

EZ
EZ

1 of 2

JR