

Oklahoma Corporation Commission
Oil & Gas Conservation Division
Post Office Box 52000
Oklahoma City, Oklahoma 73152-2000
Rule 165: 10-3-25

Form 1002A

API No.: 35051242570000

Completion Report

Spud Date: April 20, 2018

OTC Prod. Unit No.: 051-225575-0-0000

Drilling Finished Date: June 13, 2018

1st Prod Date: May 19, 2019

Completion Date: May 19, 2019

Drill Type: HORIZONTAL HOLE

Well Name: JEANNIE 1-27X04H

Purchaser/Measurer:

Location: GRADY 27 5N 6W
SE NW NW SW
2075 FSL 362 FWL of 1/4 SEC
Latitude: 34.87522313 Longitude: -97.82770343
Derrick Elevation: 0 Ground Elevation: 1146

First Sales Date:

Operator: GULFPORT MIDCON LLC 24020

3001 QUAIL SPRINGS PKWY
OKLAHOMA CITY, OK 73134-2640

Completion Type	
X	Single Zone
	Multiple Zone
	Commingled

Location Exception	
Order No	
701280	

Increased Density	
Order No	
668987	
676188	

Casing and Cement							
Type	Size	Weight	Grade	Feet	PSI	SAX	Top of CMT
CONDUCTOR	30			120			SURFACE
SURFACE	20		J-55	524		630	SURFACE
INTERMEDIATE	13-3/8		J-55	4009		1525	SURFACE
INTERMEDIATE	9-5/8		P110	12571		940	5235
PRODUCTION	5-1/2		P110	27170		3135	9006

Liner								
Type	Size	Weight	Grade	Length	PSI	SAX	Top Depth	Bottom Depth
There are no Liner records to display.								

Total Depth: 27170

Packer	
Depth	Brand & Type
There are no Packer records to display.	

Plug	
Depth	Plug Type
There are no Plug records to display.	

Initial Test Data

Test Date	Formation	Oil BBL/Day	Oil-Gravity (API)	Gas MCF/Day	Gas-Oil Ratio Cu FT/BBL	Water BBL/Day	Pumpin or Flowing	Initial Shut-In Pressure	Choke Size	Flow Tubing Pressure
May 29, 2019	WOODFORD	605	59	18734	30965	4161	FLOWING	4643	34/64	

Completion and Test Data by Producing Formation

Formation Name: WOODFORD

Code: 319WDFD

Class: GAS

Spacing Orders

Order No	Unit Size
456941	640
406347	640
446322	640
701279	MULTIUNIT

Perforated Intervals

From	To
15438	27053

Acid Volumes

2,638 TOTAL ACID

Fracture Treatments

534,719 BARRELS TOTAL FLUID, 25,012,832 POUNDS TOTAL SAND

Formation	Top
WOODFORD	15147

Were open hole logs run? No

Date last log run:

Were unusual drilling circumstances encountered? No

Explanation:

Other Remarks

There are no Other Remarks.

Lateral Holes

Sec: 4 TWP: 5N RGE: 6W County: GRADY

SW SE SE SE

66 FSL 435 FEL of 1/4 SEC

Depth of Deviation: 14643 Radius of Turn: 382 Direction: 177 Total Length: 11927

Measured Total Depth: 27170 True Vertical Depth: 15243 End Pt. Location From Release, Unit or Property Line: 66

FOR COMMISSION USE ONLY

Status: Accepted

1143554

API NO. 051-24257
OTC PROD. UNIT NO. 051-225575

(PLEASE TYPE OR USE BLACK INK ONLY)

OKLAHOMA CORPORATION COMMISSION
Oil & Gas Conservation Division
Post Office Box 52000
Oklahoma City, Oklahoma 73152-2000
Rule 165:10-3-25

RECEIVED

JUL 19 2019

Form 1002A
Rev. 2009

☒ ORIGINAL
☐ AMENDED (Reason)

COMPLETION REPORT

TYPE OF DRILLING OPERATION

☐ STRAIGHT HOLE ☐ DIRECTIONAL HOLE ☒ HORIZONTAL HOLE
☐ SERVICE WELL

If directional or horizontal, see reverse for bottom hole location.

COUNTY Grady SEC 27 TWP 5N RGE 6W
LEASE NAME Jeannie
SE 1/4 NW 1/4 NW 1/4 SW 1/4 FSL OF 2075 1/4 SEC 362
ELEVATION Derrick FL Ground 1146 Latitude (if known) 34.8752221 Longitude (if known) -97.8277015
OPERATOR NAME Gulfport MidCon LLC OTC / OCC OPERATOR NO. 24020
ADDRESS 3001 Quail Springs Parkway
CITY Oklahoma City STATE OK ZIP 73134

SPUD DATE 4/20/2018
DRLG FINISHED DATE 6/13/2018
DATE OF WELL COMPLETION 5/19/2019
1st PROD DATE 5/19/2019
RECOMP DATE

640 Acres
W E
LOCATE WELL

COMPLETION TYPE

☒ SINGLE ZONE
☐ MULTIPLE ZONE
Application Date F.O. 701280
COMINGLED Application Date 701280
LOCATION EXCEPTION ORDER NO. 669425
INCREASED DENSITY ORDER NO. 668987
676188

CASING & CEMENT (Attach Form 1002C)

TYPE	SIZE	WEIGHT	GRADE	FEET	PSI	SAX	TOP OF CMT
CONDUCTOR	30			120			
SURFACE	20		J55	524		630	Surface
INTERMEDIATE	13 3/8		J55	4,009		1525	Surface
PRODUCTION	9 5/8		P110	12,571		940	5,235
LINER	5 1/2		P110	27,170		3,135	18,164 9006
						TOTAL DEPTH	27,170

PACKER @ _____ BRAND & TYPE _____ PLUG @ _____ TYPE _____ PLUG @ _____ TYPE _____
PACKER @ _____ BRAND & TYPE _____ PLUG @ _____ TYPE _____ PLUG @ _____ TYPE _____

COMPLETION & TEST DATA BY PRODUCING FORMATION

FORMATION	(40) Woodford	Woodford				Reported to Frac Focus
SPACING & SPACING ORDER NUMBER	640/#406347	MU#669941	446322 (40)			
CLASS: Oil, Gas, Dry, Inj, Disp, Comm Disp, Gvc	GAS					
PERFORATED INTERVALS	15,438-27,053					
ACID/VOLUME	2,638 Acid					
FRACTURE TREATMENT (Fluids/Prop Amounts)	534,719 bbls Water 25,012,832 lbs Sand					

☐ Min Gas Allowable (165:10-17-7) OR ☐ Oil Allowable (165:10-13-3) Gas Purchaser/Messurer First Sales Date

INITIAL TEST DATA

INITIAL TEST DATE	5/29/2019				
OIL-BBL/DAY	605				
OIL-GRAVITY (API)	59				
GAS-MCF/DAY	18,734				
GAS-OIL RATIO CU FT/BBL	30,965				
WATER-BBL/DAY	4,161				
PUMPING OR FLOWING	Flowing				
INITIAL SHUT-IN PRESSURE	4,643				
CHOKE SIZE	34/64				
FLOW TUBING PRESSURE	N/A				

AS SUBMITTED

A record of the formations drilled through, and pertinent remarks are presented on the reverse. I declare that I have knowledge of the contents of this report and am authorized by my organization to make this report, which was prepared by me or under my supervision and direction, with the data and facts stated herein to be true, correct, and complete to the best of my knowledge and belief.

Signature: Monica Pickens DATE: 7/19/2019 PHONE NUMBER: 252-4703
3001 Quail Springs Parkway OKC OK 73134 mpickens@gulfportenergy.com
ADDRESS CITY STATE ZIP EMAIL ADDRESS

PLEASE TYPE OR USE BLACK INK ONLY

FORMATION RECORD

Give formation names and tops, if available, or descriptions and thickness of formations drilled through. Show intervals cored or drillstem tested.

NAMES OF FORMATIONS	TOP
Woodford	15,147

LEASE NAME Jeannie WELL NO. 1-27X04H

FOR COMMISSION USE ONLY	
ITD on file <input type="checkbox"/> YES <input type="checkbox"/> NO	
APPROVED _____	DISAPPROVED _____
2) Reject Codes	

Were open hole logs run?	_____ yes <input checked="" type="checkbox"/> no
Date Last log was run	_____
Was CO ₂ encountered?	_____ yes <input checked="" type="checkbox"/> no at what depths? _____
Was H ₂ S encountered?	_____ yes <input checked="" type="checkbox"/> no at what depths? _____
Were unusual drilling circumstances encountered?	_____ yes <input checked="" type="checkbox"/> no
If yes, briefly explain below	

Other remarks:

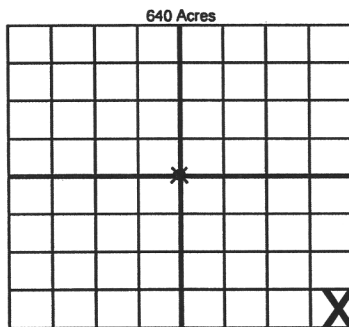

If more than three drainholes are proposed, attach a separate sheet indicating the necessary information.

Direction must be stated in degrees azimuth.
Please note, the horizontal drainhole and its end point must be located within the boundaries of the lease or spacing unit.

Directional surveys are required for all drainholes and directional wells.

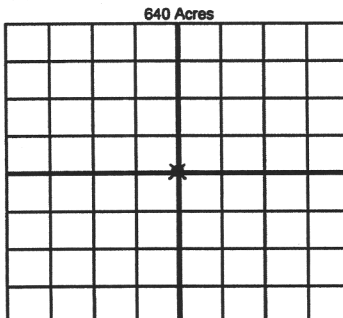

BOTTOM HOLE LOCATION FOR DIRECTIONAL HOLE

SEC	TWP	RGE	COUNTY
Spot Location		Feet From 1/4 Sec Lines	FSL
1/4	1/4	1/4	1/4
Measured Total Depth		True Vertical Depth	BHL From Lease, Unit, or Property Line:

BOTTOM HOLE LOCATION FOR HORIZONTAL HOLE: (LATERALS)

LATERAL #1			
SEC	TWP	RGE	COUNTY
04	5N	6W	Grady
Spot Location		Feet From 1/4 Sec Lines	FSL
SE 1/4	SE 1/4	SE 1/4	66
Depth of Deviation		Radius of Turn	Direction
14,643		382	177 181
Measured Total Depth		True Vertical Depth	Total Length
27,170		15,243	11,927
		BHL From Lease, Unit, or Property Line: 66	

LATERAL #2			
SEC	TWP	RGE	COUNTY
Spot Location		Feet From 1/4 Sec Lines	FSL
1/4	1/4	1/4	1/4
Depth of Deviation		Radius of Turn	Direction
Measured Total Depth		True Vertical Depth	Total Length
		BHL From Lease, Unit, or Property Line:	

LATERAL #3			
SEC	TWP	RGE	COUNTY
Spot Location		Feet From 1/4 Sec Lines	FSL
1/4	1/4	1/4	1/4
Depth of Deviation		Radius of Turn	Direction
Measured Total Depth		True Vertical Depth	Total Length
		BHL From Lease, Unit, or Property Line:	

TEST: ☒ INITIAL
☐ ANNUAL
☐ RETEST

OKLAHOMA CORPORATION COMMISSION

Oil & Gas Conservation Division

Post Office Box 52000

Oklahoma City, Oklahoma 73152-2000

RECEIVED

OCT 15 2019

Form 1016

Rev. 2018

Oklahoma Corporation
Commission

BACK PRESSURE TEST FOR NATURAL GAS WELLS

OAC 165:10-17-6

DATE OF TEST:

8/9/2019

DATE OF 1ST SALES: 5/20/2019

Operator Gulfport Midcon, LLC			Operator # 24020			
Address 3001 Quail Springs Parkway			City Oklahoma City		ST OK	ZIP 73134
E-mail mpickens@gulfportenergy.com		Ph 405-252-4703	Fax 405-252-4901		Well Name/# Jeannie 1-27X34H	
Gas Volumes to be Reported to OCC by: Gulfport Midcon			Gas Volume ? Reporter # 24020		API # 051-24257	
Producing Zone Woodford 319WDFDL			OTC Lease # 051-225575			
Surface Location SE 1/4 NW 1/4 NW 1/4 SW 1/4			Sec 27	Twp 05N	Rge 06W	(OCC use) Allowable # (see below)
Zone Location (if different) 1/4 1/4 1/4 1/4			Sec	Twp	Rge	County Grady
Field SCOOP			Spacing Size 640			

COMPLETION: ☒ Single ☐ Multiple Zone ☐ Commingled ☐ Recompletion Date of Completion 05/17/19

Total Depth 27190	Plug Back Depth	Packer Set Depth	Elevation 1146
Csg Size 5.5	WT 23 d 4.67	Depth Set 27190	Perfs. 15438 - 27053
Tbg Size	WT d	Depth Set	Perfs.
Prod. Thru Casing	Res. Temp. F 287 @ 21246	Mean Grd. Temp. F 60	Atm. Press. PSIA 14.4
L 21246 H 21246 G _g .7440 %CO ₂ .680 %N ₂ .556 H ₂ S(ppm)	Prover	Meter Run X	Taps Flange

SHUT-IN DATA		FLOW DATA						TUBING DATA		CASING DATA		BHP DATA		FLOW (HRS)
PRESS	(HRS)	LINE SIZE	X	ORIFICE SIZE	PRESS	(INCHES)	TEMP	PRESS	TEMP	PRESS	TEMP	PRESS	TEMP	
					(PSIG)	(ROOTS)								
3958	24	4.026		2.375	885	146	98			3477	90			24

RATE OF FLOW CALCULATIONS

COEFFICIENT (24 HOUR)	$\sqrt{h_w P_m}$	PRESSURE P _m	FLOW TEMP. FACTOR F _t	GRAVITY FACTOR F _g	SUPER COMPRESS FACTOR F _{pv}	RATE OF FLOW (Q) MCFD
29.72	362.3705	899.4	.9653	1.1593	1.0986	13242

P _r	TEMP. R	T _r	Z
1.3507	557.7	1.3911	.8285

Gas/Liquid Hydrocarbon Ratio		41.9	MCF/BBL
API Gravity of Liquid Hydrocarbons		60	Deg.
Specific Gravity Separator Gas	.744	Specific Gravity Flowing Fluid	.8093
Critical Pressure	665.88 PSIA	Critical Pressure	663.09 PSIA
Critical Temperature	400.89 R	Critical Temperature	420.86 R

P_c 3972.4 (PSIA) P_c² 15779.96

P _w	P _w ²	P _c ² - P _w ²
3491.4	12189.87	3590.09

Multiflow:

27-05N-06W: 13% 225575 I
34-05N-06W: 45% 225575A I
04-04N-06W: 42% 225575B I

$$\frac{P_c^2}{P_c^2 - P_w^2} = \frac{4.3954}{(Not to exceed 5.263)}$$

$$\frac{P_c^2}{P_c^2 - P_w^2} = 3.5201$$

$$\frac{P_c^2}{P_c^2 - P_w^2} = 46612$$

Calculated wellhead open flow	46612	MCFD @ 14.65	Angle of Slope	Slope, n	.850
-------------------------------	-------	--------------	----------------	----------	------

Remarks Oil Produced 316 BBLS Water Produced 528 BBLS

RECEIVED

Approved by Commission:	Conducted by: Steve Airington	Calculated by: Thurmond McGlothlin	Checked by: Oklahoma Corporation Commission
WITNESSED - OCC FIELD STAFF: Y <input type="checkbox"/> N <input checked="" type="checkbox"/> NAME: Jan [Signature] (over)			DATE: 8-15-19

IF THE ALLOWABLE FOR THIS WELL HAS BEEN ADJUSTED BY COMMISSION ORDER, PLEASE GIVE THE ORDER NUMBER(S) IN ONE OR MORE OF THE CATEGORIES BELOW:

INCREASED DENSITY 662898/663021 LOCATION EXCEPTION * 661321

COMMINGLING _____ MULTIPLE ZONE _____

SEPARATE OR SPECIAL ALLOWABLE * 698192 (all units - 27, 34, 04)

OTHER PENALTY ORDER(S) * Multunit FO 701279

* FOR THESE ORDER TYPES, PLEASE DESCRIBE ALLOWABLES AND/OR PENALTIES:

I declare that I have knowledge of the contents of this report and am authorized by my organization to make this report, which was prepared by me or under my supervision and direction, with the data and facts stated herein to be true, correct and complete to the best of my knowledge and belief.

Scot _____ Manager
SIGNATURE TITLE

Thurmond McGlothlin 08/12/19 580-256-9849
COMPANY DATE PHONE NO.

Pc SHUT-IN PRESSURE, PSIA (LENGTH OF SHUT-IN MINIMUM OF 24 HOURS).

Pw STATIC COLUMN WELLHEAD PRESSURE CORRESPONDING TO THE FLOWING WELLHEAD PRESSURE, PSIA (TO BE RECORDED AT END OF EACH FLOW RATE.) THE VALUE OF Pw SHOULD NOT EXCEED 90% OF Pc.

Gg SPECIFIC GRAVITY OF SEPARATOR GAS (AIR = 1.000).

L LENGTH OF THE FLOW STRING FROM THE MIDDLE OF THE PRODUCING FORMATION TO THE PRESSURE POINT AT WELLHEAD, FEET.

H VERTICAL DEPTH CORRESPONDING TO L, FEET.

Q 24 HOUR RATE OF FLOW, MCF/D.

d INSIDE DIAMETER, INCHES.

R DEGREES, RANKINE (DEGREES FAHRENHEIT ABSOLUTE).

Pr REDUCED PRESSURE, DIMENSIONLESS.

Tr REDUCED TEMPERATURE, DIMENSIONLESS.

Z COMPRESSIBILITY FACTOR, DIMENSIONLESS.