

Oklahoma Corporation Commission
Oil & Gas Conservation Division
Post Office Box 52000
Oklahoma City, Oklahoma 73152-2000
Rule 165: 10-3-25

Form 1002A

API No.: 35101229410000

Completion Report

Spud Date: February 20, 2019

OTC Prod. Unit No.:

Drilling Finished Date: February 25, 2019

1st Prod Date: March 08, 2019

Completion Date: March 08, 2019

Drill Type: STRAIGHT HOLE

Well Name: SOUTH ALBERT 2

Purchaser/Measurer:

Location: MUSKOGEE 2 14N 15E
S2 NE NW NW
2190 FSL 990 FWL of 1/4 SEC
Derrick Elevation: 0 Ground Elevation: 0

First Sales Date:

Operator: T BAR M ENERGY RESOURCES LLC 23380
PO BOX 668
1302 COMMERCIAL
MOUNDS, OK 74047-0668

Completion Type		Location Exception		Increased Density	
X	Single Zone	Order No		Order No	
	Multiple Zone	There are no Location Exception records to display.		There are no Increased Density records to display.	
	Commingled				

Casing and Cement							
Type	Size	Weight	Grade	Feet	PSI	SAX	Top of CMT
SURFACE	7	14	LS	230		60	SURFACE
PRODUCTION	4 1/2	9.5	LS	2323	4000	100	1280

Liner								
Type	Size	Weight	Grade	Length	PSI	SAX	Top Depth	Bottom Depth
There are no Liner records to display.								

Total Depth: 2330

Packer		Plug	
Depth	Brand & Type	Depth	Plug Type
There are no Packer records to display.		There are no Plug records to display.	

Initial Test Data										
Test Date	Formation	Oil BBL/Day	Oil-Gravity (API)	Gas MCF/Day	Gas-Oil Ratio Cu FT/BBL	Water BBL/Day	Pumpin or Flowing	Initial Shut-In Pressure	Choke Size	Flow Tubing Pressure
Mar 08, 2019	DUTCHER	2	36	15	7500	5	PUMPING			

Completion and Test Data by Producing Formation			
Formation Name: DUTCHER		Code: 403DTCR	Class: OIL
Spacing Orders		Perforated Intervals	
Order No	Unit Size	From	To
NONE		1579	1586
		1704	1709
Acid Volumes		Fracture Treatments	
1,000 GALLONS		14,000 POUNDS	

Formation	Top
HARTSHORNE	1430
UPPER DUTCHER	1574
UNION VALLEY	1770
MISSISSIPPI LIME	1828
WOODFORD	2258
SYLVAN	2282
VIOLA	2315

Were open hole logs run? Yes
Date last log run: February 25, 2019

Were unusual drilling circumstances encountered? No
Explanation:

Other Remarks
There are no Other Remarks.

FOR COMMISSION USE ONLY	
Status: Accepted	1143641

API NO. 5-101-22941-000
OTC PROD.
UNIT NO.

(PLEASE TYPE OR USE BLACK INK ONLY)

OKLAHOMA CORPORATION COMMISSION

Oil & Gas Conservation Division

Post Office Box 52000

Oklahoma City, Oklahoma 73152-2000

Rule 165:10-3-25

Form 1002A

Rev. 2009

☒ ORIGINAL
☐ AMENDED (Reason) _____

COMPLETION REPORT

TYPE OF DRILLING OPERATION

☒ STRAIGHT HOLE ☐ DIRECTIONAL HOLE ☐ HORIZONTAL HOLE
☐ SERVICE WELL

If directional or horizontal, see reverse for bottom hole location.

COUNTY	Muskogee	SEC	2	TWP	14N	RGE	15E
LEASE NAME	South Albert			WELL NO.	2		
S 1/2 1/4 NE 1/4 NW 1/4 NW 1/4				FSL OF 1/4 SEC	2190	FWL OF 1/4 SEC	990
ELEVATION	Ground			Latitude (if known)	Longitude (if known)		
OPERATOR NAME	T Bar M Energy Resources LLC			OTC / OCC OPERATOR NO.	23380		
ADDRESS	1302 Commercial						
CITY	Mounds		STATE	Ok	ZIP	74067	

SPUD DATE 02-20-2019

DRLG FINISHED DATE 02-25-2019

DATE OF WELL COMPLETION 03/08/19

1st PROD DATE 3-8-19

RECOMP DATE

LOCATE WELL

COMPLETION TYPE

<input checked="" type="checkbox"/> SINGLE ZONE	
<input type="checkbox"/> MULTIPLE ZONE	
Application Date	
<input type="checkbox"/> COMMINGLED	
Application Date	
LOCATION EXCEPTION	
ORDER NO.	
INCREASED DENSITY	
ORDER NO.	

CASING & CEMENT (Attach Form 1002C)

TYPE	SIZE	WEIGHT	GRADE	FEET	PSI	SAX	TOP OF CMT
CONDUCTOR							
SURFACE	7	14	LS	230		60	surface
INTERMEDIATE							
PRODUCTION	4 1/2	9.5	LS	2323	4000	100	1280
LINER							
TOTAL DEPTH							2,330

PACKER @ _____ BRAND & TYPE _____ PLUG @ _____ TYPE _____ PLUG @ _____ TYPE _____
PACKER @ _____ BRAND & TYPE _____ PLUG @ _____ TYPE _____ PLUG @ _____ TYPE _____

COMPLETION & TEST DATA BY PRODUCING FORMATION

FORMATION	(U) Dutcher	(U) Dutcher				
SPACING & SPACING						
ORDER NUMBER	none	none				
CLASS: Oil, Gas, Dry, Inj, Disp, Comm Disp, Svc	oil	oil				
	1704-09	1579-86				
PERFORATED INTERVALS						
ACID/VOLUME	1000 gal	1000gal				
FRACTURE TREATMENT (Fluids/Prop Amounts)	14000 lb					

☐ Min Gas Allowable (165:10-17-7)
OR
☒ Oil Allowable (165:10-13-3)

Gas Purchaser/Measurer

First Sales Date

INITIAL TEST DATA

INITIAL TEST DATE	3/8/2019				
OIL-BBL/DAY	2				
OIL-GRAVITY (API)	36				
GAS-MCF/DAY	15				
GAS-OIL RATIO CU FT/BBL	7500				
WATER-BBL/DAY	5				
PUMPING OR FLOWING	pumping				
INITIAL SHUT-IN PRESSURE					
CHOKE SIZE					
FLOW TUBING PRESSURE					

AS SUBMITTED

A record of the formations drilled through, and pertinent remarks are presented on the reverse. I declare that I have knowledge of the contents of this report and am authorized by my organization to make this report, which was prepared by me or under my supervision and direction, with the data and facts stated herein to be true, correct, and complete to the best of my knowledge and belief.

Phil Hammill

SIGNATURE

Box 3R

Phil Hammill

NAME (PRINT OR TYPE)

Renns

OK

74421

7/29/2019

DATE

(918) 267-4243

PHONE NUMBER

PLEASE TYPE OR USE BLACK INK ONLY

FORMATION RECORD

Give formation names and tops, if available, or descriptions and thickness of formations drilled through. Show intervals cored or drillstem tested.

NAMES OF FORMATIONS	TOP
Hartshorne	1,430
Upper Dutcher	1574
Union Valley	1,770
Mississippi Lime	1,828
Woodford	2,258
Slyvan	2,282
Viola	2,315

LEASE NAME South Albert WELL NO. 2

FOR COMMISSION USE ONLY

ITD on file ☐ YES ☐ NO

APPROVED _____ DISAPPROVED _____

2) Reject Codes

Were open hole logs run? ☒ yes ☐ noDate Last log was run 2/25/2019Was CO₂ encountered? ☐ yes ☒ no at what depths? _____Was H₂S encountered? ☐ yes ☒ no at what depths? _____Were unusual drilling circumstances encountered? ☐ yes ☒ no
If yes, briefly explain below _____

Other remarks:

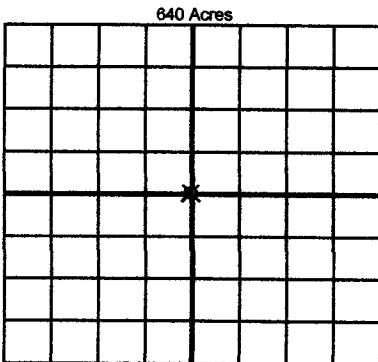

If more than three drainholes are proposed, attach a separate sheet indicating the necessary information.

Direction must be stated in degrees azimuth. Please note, the horizontal drainhole and its end point must be located within the boundaries of the lease or spacing unit.

Directional surveys are required for all drainholes and directional wells.

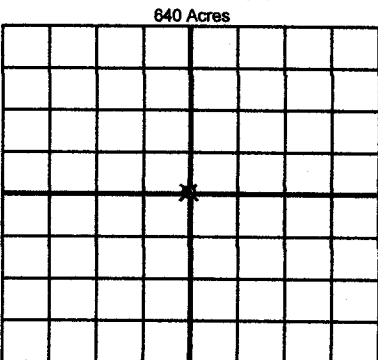

BOTTOM HOLE LOCATION FOR DIRECTIONAL HOLE

SEC	TWP	RGE	COUNTY
Spot Location			
1/4	1/4	1/4	1/4
Measured Total Depth		True Vertical Depth	BHL From Lease, Unit, or Property Line:

BOTTOM HOLE LOCATION FOR HORIZONTAL HOLE: (LATERALS)

LATERAL #1

SEC	TWP	RGE	COUNTY
Spot Location			
1/4	1/4	1/4	1/4
Depth of Deviation		Radius of Turn	Direction
Measured Total Depth		True Vertical Depth	BHL From Lease, Unit, or Property Line:

LATERAL #2

SEC	TWP	RGE	COUNTY
Spot Location			
1/4	1/4	1/4	1/4
Depth of Deviation		Radius of Turn	Direction
Measured Total Depth		True Vertical Depth	BHL From Lease, Unit, or Property Line:

LATERAL #3

SEC	TWP	RGE	COUNTY
Spot Location			
1/4	1/4	1/4	1/4
Depth of Deviation		Radius of Turn	Direction
Measured Total Depth		True Vertical Depth	BHL From Lease, Unit, or Property Line: