

Oklahoma Corporation Commission
Oil & Gas Conservation Division
Post Office Box 52000
Oklahoma City, Oklahoma 73152-2000
Rule 165: 10-3-25

Form 1002A

API No.: 35093250790001

Completion Report

Spud Date: September 14, 2017

OTC Prod. Unit No.: 093-225589-0-0000

Drilling Finished Date: May 05, 2019

1st Prod Date: May 23, 2019

Amended

Completion Date: May 17, 2019

Amend Reason: DRILLED LATERAL AND COMPLETED

Drill Type: HORIZONTAL HOLE

Min Gas Allowable: Yes

Well Name: WAHL 21-20-12 1H

Purchaser/Measurer: CHESAPEAKE OPERATING LLC

First Sales Date: 05/23/2019

Location: MAJOR 21 20N 12W
SW SE SW SW
320 FSL 670 FWL of 1/4 SEC
Latitude: 36.188486 Longitude: -98.492385
Derrick Elevation: 1501 Ground Elevation: 1476

Operator: CHESAPEAKE OPERATING LLC 17441
PO BOX 18496
6100 N WESTERN AVE
OKLAHOMA CITY, OK 73154-0496

Completion Type	
X	Single Zone
	Multiple Zone
	Commingled

Location Exception
Order No
698646

Increased Density
Order No
There are no Increased Density records to display.

Casing and Cement							
Type	Size	Weight	Grade	Feet	PSI	SAX	Top of CMT
SURFACE	13-3/8	54.50	J-55	1525		1666	SURFACE
INTERMEDIATE	9-5/8	40	P110/L80	7395		590	4828
PRODUCTION	5-1/2	20	P-110EC	12930		1215	6589

Liner								
Type	Size	Weight	Grade	Length	PSI	SAX	Top Depth	Bottom Depth
There are no Liner records to display.								

Total Depth: 12935

Packer	
Depth	Brand & Type
There are no Packer records to display.	

Plug	
Depth	Plug Type
There are no Plug records to display.	

Initial Test Data

Test Date	Formation	Oil BBL/Day	Oil-Gravity (API)	Gas MCF/Day	Gas-Oil Ratio Cu FT/BBL	Water BBL/Day	Pumpin or Flowing	Initial Shut-In Pressure	Choke Size	Flow Tubing Pressure
Jul 05, 2019	MISSISSIPPI SOLID	255	39.77	1026	4024	918	ARTIFICIA			91

Completion and Test Data by Producing Formation					
Formation Name: MISSISSIPPI SOLID		Code: 351MSSSD		Class: OIL	
Spacing Orders		Perforated Intervals			
Order No	Unit Size	From		To	
228797	640	8515		12813	
Acid Volumes		Fracture Treatments			
46,410 GALLONS TOTAL ACID		176,286 BARRELS TOTAL FLUID, 7,460,151 POUNDS TOTAL PROPPANT			

Formation	Top
MISSISSIPPI	8505

Were open hole logs run? Yes

Date last log run: April 30, 2019

Were unusual drilling circumstances encountered? No

Explanation:

Other Remarks
There are no Other Remarks.

Lateral Holes
Sec: 21 TWP: 20N RGE: 12W County: MAJOR NE NW NW NW 52 FNL 451 FWL of 1/4 SEC Depth of Deviation: 7719 Radius of Turn: 494 Direction: 2 Total Length: 4430 Measured Total Depth: 12935 True Vertical Depth: 8213 End Pt. Location From Release, Unit or Property Line: 52

FOR COMMISSION USE ONLY	
Status: Accepted	1143553

API NO. 093-25079
OTC PROD.
UNIT NO. 093-225589

PLEASE TYPE OR USE BLACK INK ONLY
NOTE:
Attach copy of original 1002A if recompletion or reentry.

OKLAHOMA CORPORATION COMMISSION
Oil & Gas Conservation Division
Post Office Box 52000
Oklahoma City, Oklahoma 73152-2000
Rule 165:10-3-25

RECEIVED
Form 1002A
Rev. 2009

JUL 18 2019

OKLAHOMA CORPORATION
COMMISSION

ORIGINAL
☒ AMENDED
Reason Amended Drilled lateral and completed

TYPE OF DRILLING OPERATION
☐ STRAIGHT HOLE ☐ DIRECTIONAL HOLE ☒ HORIZONTAL HOLE
☐ SERVICE WELL

If directional or horizontal, see reverse for bottom hole location.

COUNTY	Major	SEC	21	TWP	20N	RGE	12W
LEASE NAME	Wahl 21-20-12		WELL NO		1H		
SHL	SW 1/4 SE 1/4 SW 1/4 SW 1/4		FSL	FWL OF		670	
ELEVATION	Derrick Fl 1,501 Ground 1,476		Latitude (if Known)		36.188486		
OPERATOR NAME	CHESAPEAKE OPERATING, L.L.C.				OTC/OCC OPERATOR NO.	17441	
ADDRESS	P.O. BOX 18496						
CITY	OKLAHOMA CITY		STATE	OK		ZIP	73154

COMPLETION REPORT

SPUD DATE	9/14/2017
DRLG FINISHED DATE	5/5/2019
DATE OF WELL COMPLETION	5/17/2019
1ST PROD DATE	5/23/2019
RECOMP DATE	
Longitude (if Known)	-98.492385

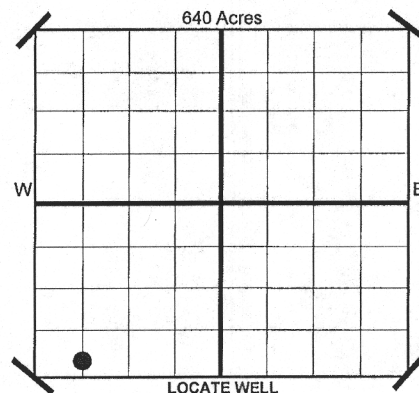

COMPLETION TYPE

<input checked="" type="checkbox"/> SINGLE ZONE	
<input type="checkbox"/> MULTIPLE ZONE	
Application Date	
<input type="checkbox"/> COMMINGLED	
Application Date	
LOCATION EXCEPTION ORDER NO.	698646 F.O.
INCREASED DENSITY ORDER NO.	N/A

CASING & CEMENT (Form 1002C must be attached)

TYPE	SIZE	WEIGHT	GRADE	FEET	PSI	SAX	TOP
CONDUCTOR							
SURFACE	13-3/8"	54.50#	J-55	1,525		1,666	Surface
INTERMEDIATE	9-5/8"	40#	P110/L80	7,395		590	4,828
PRODUCTION	5-1/2"	20#	P-110EC	12,930		1,215	6,589
LINER							
							12,935

PACKER @ _____ BRAND & TYPE _____ PLUG @ _____ TYPE _____ PLUG @ _____ TYPE _____
PACKER @ _____ BRAND & TYPE _____ PLUG @ _____ TYPE _____ PLUG @ _____ TYPE _____

TOTAL DEPTH

COMPLETION & TEST DATA BY PRODUCING FORMATION

FORMATION	Mississippi Solid								
SPACING & SPACING ORDER NUMBER	640 228797								
CLASS: Oil, Gas, Dry, Inj. Disp, Comm Disp, Svc	Oil								
PERFORATED INTERVALS	8,515 - 12,813								
ACID/VOLUME	46,410 gals acid 176,286 bbls fluids								
FRACTURE TREATMENT (Fluids/Prop Amounts)	7,460,151# proppant								

Reported to
Frac Focus

Minimum Gas Allowable (165:10-17-7)

Gas Purchaser/Measurer

Chesapeake Operating, L.L.C.

☒

OR

1st Sales Date

5/23/2019

INITIAL TEST DATA

Oil Allowable (165:10-13-3)

INITIAL TEST DATE	7/5/2019								
OIL-BBL/DAY	255								
OIL-GRAVITY (API)	39.77								
GAS-MCF/DAY	1,026								
GAS-OIL RATIO CU FT/BBL	4,024								
WATER-BBL/DAY	918								
PUMPING OR FLOWING	Artificial Lift								
INITIAL SHUT-IN PRESSURE									
CHOKE SIZE									
FLOW TUBING PRESSURE	91								

AS SUBMITTED

A record of the formations drilled through, and pertinent remarks are presented on the reverse. I declare that I have knowledge of the contents of this report and am authorized by my organization to make this report, which was prepared by me or under my supervision and direction, with the data and facts stated herein to be true, correct, and complete to the best of my knowledge and belief.

SIGNATURE	JUANITA COOPER - SR. REGULATORY ANALYST	DATE	7/17/2019	PHONE NUMBER	405-848-8000
P.O. BOX 18496	OKLAHOMA CITY	OK	73154	EMAIL ADDRESS	juanita.cooper@chk.com
ADDRESS	CITY	STATE	ZIP		

PLEASE TYPE OR USE BLACK INK ONLY
FORMATION RECORD

Give formation names and tops, if available, or descriptions and thickness of formations drilled through. Show intervals cored or drillstem tested.

LEASE NAME Wahl 21-20-12

WELL NO. 1H

NAMES OF FORMATIONS	TOP
Mississippi Solid	8,505

FOR COMMISSION USE ONLY	
ITD on file <input type="checkbox"/> YES <input type="checkbox"/> NO	
APPROVED _____	DISAPPROVED _____
2) Reject Codes	

Were open hole logs run?	<input checked="" type="checkbox"/> yes	<input type="checkbox"/> no
Date Last log was run	4/30/2019	
Was CO ₂ encountered?	yes <input type="checkbox"/>	no <input checked="" type="checkbox"/> at what depths?
Was H ₂ S encountered?	yes <input type="checkbox"/>	no <input checked="" type="checkbox"/> at what depths?
Were unusual drilling circumstances encountered?	<input type="checkbox"/> yes <input checked="" type="checkbox"/> no	
If yes, briefly explain.		

Other remarks:

640 Acres

If more than three drainholes are proposed, attach a separate sheet indicating the necessary information.

Direction must be stated in degrees azimuth. Please note, the horizontal drainhole and its end point must be located within the boundaries of the lease or spacing unit.

Directional surveys are required for all drainholes and directional wells.

640 Acres

BOTTOM HOLE LOCATION FOR DIRECTIONAL HOLE

SEC	TWP	RGE	COUNTY
Spot Location	1/4	1/4	1/4
Measured Total Depth	True Vertical Depth		
Feet From 1/4 Sec Lines FSL _____ FWL _____			
BHL From Lease, Unit, or Property Line:			

BOTTOM HOLE LOCATION FOR HORIZONTAL HOLE: (LATERALS)

LATERAL #1	SEC	TWP	RGE	COUNTY
Spot Location	21	20N	12W	Major
NE 1/4 NW 1/4 NW 1/4	Feet From 1/4 Sec Lines FNL 52 FWL 451			
Depth of Deviation 7,719	Radius of Turn 494			
Measured Total Depth 12,935	True Vertical Depth 8,213			
Direction 2 Total Length 4,430				
BHL From Lease, Unit, or Property Line: 52				

LATERAL #2

SEC	TWP	RGE	COUNTY
Spot Location	1/4	1/4	1/4
Depth of Deviation	Radius of Turn		
Measured Total Depth	True Vertical Depth		
Feet From 1/4 Sec Lines FSL _____ FWL _____			
Direction _____ Total Length _____			
BHL From Lease, Unit, or Property Line:			

LATERAL #3

SEC	TWP	RGE	COUNTY
Spot Location	1/4	1/4	1/4
Depth of Deviation	Radius of Turn		
Measured Total Depth	True Vertical Depth		
Feet From 1/4 Sec Lines FSL _____ FWL _____			
Direction _____ Total Length _____			
BHL From Lease, Unit, or Property Line:			

13800 WIRELESS WAY, OKLA. CITY, OKLA. 73134 * LOCAL (405) 843-4847 * OUT OF STATE (800) 654-3219

Certificate of Authorization No. 1293 LS

County, Oklahoma

320'FSL - 670'FWL Section 21 Township 20N Range 12W I.M.



Well No.: 1H

1476' Gr. at Level Pad

Good Drill Site? _____ Yes

Reference Stakes or Alternate Location

Stakes Set None

Best Accessibility to Location From South off county road

Distance & Direction

from Hwy Jct or Town From Fairview, OK, go ± 5.6 mi. South on St. Hwy. 58, then ± 1.0 mi. West

on county road to the SW Cor. of Sec. 21-T20N-R12W

This information was gathered with a GPS receiver with ± 1 foot Horiz./Vert. accuracy.

DATUM: NAD-27
LAT: 36°11'18.5"N
LONG: 98°29'32.6"W
LAT: 36.188485° N
LONG: 98.492385° W
STATE PLANE
COORDINATES: (US Feet)
ZONE: OK NORTH
X: 1854699.5
Y: 432988.2

Project # 126824 Date of Drawing: May 29, 2019

Date Staked: May 04, 2017 ST

FINAL AS-DRILLED PLAT

AS-DRILLED INFORMATION
FURNISHED BY CHESAPEAKE OPERATING, L.L.C.