

Oklahoma Corporation Commission
Oil & Gas Conservation Division
Post Office Box 52000
Oklahoma City, Oklahoma 73152-2000
Rule 165: 10-3-25

Form 1002A

API No.: 35019262880000

Completion Report

Spud Date: April 15, 2018

OTC Prod. Unit No.: 019-225341-0-0000

Drilling Finished Date: November 15, 2018

1st Prod Date: June 14, 2019

Completion Date: June 14, 2019

Drill Type: HORIZONTAL HOLE

Min Gas Allowable: Yes

Well Name: LAWSON 4-13H14X

Purchaser/Measurer: ETC

Location: CARTER 13 3S 2E
NE SE NE NE
880 FNL 260 FEL of 1/4 SEC
Derrick Elevation: 805 Ground Elevation: 775

First Sales Date: 06/14/2019

Operator: XTO ENERGY INC 21003

22777 SPRINGWOODS VILLAGE PKWY
SPRING, TX 77389-1425

Completion Type		Location Exception		Increased Density	
X	Single Zone	Order No		Order No	
	Multiple Zone	701512		674281	
	Commingled			674954	

Casing and Cement							
Type	Size	Weight	Grade	Feet	PSI	SAX	Top of CMT
CONDUCTOR	20	94	J-55	110			SURFACE
SURFACE	13 3/8	54.5	J-55	2060		845	SURFACE
INTERMEDIATE	9 5/8	40	P-110	11758		920	9429
PRODUCTION	5 1/2	23	P-110	22862		2915	7330

Liner								
Type	Size	Weight	Grade	Length	PSI	SAX	Top Depth	Bottom Depth
There are no Liner records to display.								

Total Depth: 22862

Packer	
Depth	Brand & Type
There are no Packer records to display.	

Plug	
Depth	Plug Type
There are no Plug records to display.	

Initial Test Data

Test Date	Formation	Oil BBL/Day	Oil-Gravity (API)	Gas MCF/Day	Gas-Oil Ratio Cu FT/BBL	Water BBL/Day	Pumpin or Flowing	Initial Shut-In Pressure	Choke Size	Flow Tubing Pressure
Jun 17, 2019	WOODFORD	203	53	2571	12665	505	FLOWING	917	64/64	360

Completion and Test Data by Producing Formation

Formation Name: WOODFORD

Code: 319WDFD

Class: OIL

Spacing Orders

Order No	Unit Size
197431	640
701454	MULTIUNIT

Perforated Intervals

From	To
12597	22725

Acid Volumes

9,000 GALLONS

Fracture Treatments

36 STAGES - 519,210 BARRELS TREATED WATER, 1,629,220 POUNDS 100 MESH SAND, 13,973,910 POUNDS 40/70 SAND

Formation	Top
WOODFORD	12255

Were open hole logs run? No

Date last log run:

Were unusual drilling circumstances encountered? No

Explanation:

Other Remarks
IRREGULAR SECTION

Lateral Holes

Sec: 14 TWP: 3S RGE: 2E County: CARTER

NW SW SW NW

2123 FNL 60 FWL of 1/4 SEC

Depth of Deviation: 11760 Radius of Turn: 592 Direction: 268 Total Length: 10172

Measured Total Depth: 22862 True Vertical Depth: 11901 End Pt. Location From Release, Unit or Property Line: 60

FOR COMMISSION USE ONLY

Status: Accepted

1143637

API NO. 019-26288
OTC PROD. UNIT NO. 019-225341

PLEASE TYPE OR USE BLACK INK ONLY

NOTE:

Attach copy of original 1002A
if recompletion or reentry.

OKLAHOMA CORPORATION COMMISSION
Oil & Gas Conservation Division
Post Office Box 52000
Oklahoma City, Oklahoma 73152-2000
Rule 165:10-3-25

RECEIVED
AUG 05 2019
Oklahoma Corporation
Commission

Form 1002A
Rev. 2009

☒ ORIGINAL
☐ AMENDED (Reason)

TYPE OF DRILLING OPERATION

☐ STRAIGHT HOLE ☐ DIRECTIONAL HOLE ☒ HORIZONTAL HOLE
☐ SERVICE WELL

If directional or horizontal, see reverse for bottom hole location.

COUNTY	Carter	SEC	13	TWP	03S	RGE	02E
LEASE NAME	Lawson 4-13H14X			WELL NO.			
NE 1/4	SE 1/4	NE 1/4	NE 1/4	FNL OF 1/4 SEC	880	FEL OF 1/4 SEC	260
ELEVATION N Derrick	805	Ground	775	Latitude (if known)	34.300775N		
OPERATOR NAME	XTO Energy Inc.			OTC/OCC OPERATOR NO.	21003		
ADDRESS	210 Park Avenue, Suite 2350						
CITY	Oklahoma City	STATE	Oklahoma	ZIP	73102		

COMPLETION REPORT

SPUD DATE 4/15/2018
DRLG FINISHED DATE 11/15/2018
DATE OF WELL COMPLETION 6/14/2019
1st PROD DATE 6/14/2019
RECOMP DATE
Longitude (if known) 97.038714W

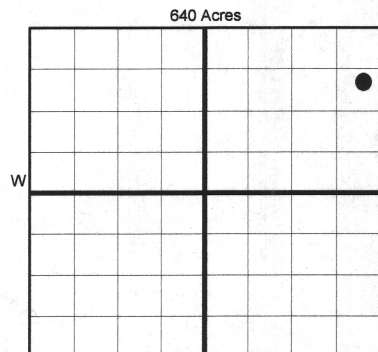

LOCATE WELL

COMPLETION TYPE

<input checked="" type="checkbox"/> SINGLE ZONE
<input type="checkbox"/> MULTIPLE ZONE
Application Date
COMMINGLED
Application Date
LOCATION
EXCEPTION ORDER
INCREASED DENSITY ORDER NO.

701512 F.O.
674576, 674577
674954, 674281

CASING & CEMENT (Form 1002C must be attached)

TYPE	SIZE	WEIGHT	GRADE	FEET	PSI	SAX	TOP OF CMT
CONDUCTOR	20"	94	J-55	110			Surface
SURFACE	13 3/8"	54.5	J-55	2060		845	Surface
INTERMEDIATE	9 5/8"	40	P-110	11,758		920	9,429
PRODUCTION	5 1/2"	23	P-110	22,862		2915	7330
LINER							
TOTAL DEPTH							22862'

PACKER @ _____ BRAND & TYPE _____ PLUG @ _____ TYPE _____ PLUG @ _____ TYPE _____
PACKER @ _____ BRAND & TYPE _____ PLUG @ _____ TYPE _____ PLUG @ _____ TYPE _____

COMPLETION & TEST DATA BY PRODUCING FORMATION

FORMATION	Woodford
SPACING & SPACING ORDER NUMBER	640: 197431
CLASS: Oil, Gas, Dry, Inj, Disp, Comm Disp, Svc	Oil
PERFORATED INTERVALS	36 Stages
	12597-22725
ACID/VOLUME	9000 gals
FRACTURE TREATMENT (Fluids/Prop Amounts)	519, 210 BFW Bbls Treated Water
	1,629,220# 100 Mesh Sand
	13,973,910# 40/70 Sand

Reported
to Frac Focus

Min Gas Allowable (165:10-17-7) ☒ OR Gas Purchaser/Measurer ETC
Oil Allowable (165:10-13-3) First Sales Date 6/14/2019

INITIAL TEST DATA

INITIAL TEST DATE	6/17/2019
OIL-BBL/DAY	203
OIL-GRAVITY (API)	53
GAS-MCF/DAY	2571
GAS-OIL RATIO CU FT/BBL	12665
WATER-BBL/DAY	505
PUMPING OR FLOWING	Flowing
INITIAL SHUT-IN PRESSURE	917 psi
CHOKE SIZE	64/64"
FLOW TUBING PRESSURE	360 psi

AS SUBMITTED

A record of the formations drilled through, and pertinent remarks are presented on the reverse. I declare that I have knowledge of the contents of this report and am authorized by my organization to make this report, which was prepared by me or under my supervision and direction, with the data and facts stated herein to be true, correct, and complete to the best of my knowledge and belief.

SIGNATURE	NAME (PRINT OR TYPE)	DATE	PHONE NUMBER
Debbie Waggoner	Debbie Waggoner	8/2/2019	405-319-3243
210 Park Avenue, Suite 2350	Oklahoma City Ok 73102	debbie_waggoner@xtoenergy.com	
ADDRESS	CITY STATE ZIP	EMAIL ADDRESS	

Give formation names and tops, if available, or descriptions and thickness of formations drilled through. Show intervals cored or drillstem tested.

WELL NO. 4-13H14X

NAMES OF FORMATIONS	TOP
Woodford	12255'

FOR COMMISSION USE ONLY	
ITD on file	<input type="checkbox"/> YES <input type="checkbox"/> NO
APPROVED	DISAPPROVED
<div>2) Reject Codes</div> <div> <div></div> <div></div> <div></div> <div></div> <div></div> </div>	

Were open hole logs run? yes X no

Date Last log was run _____

Was CO₂ encountered? yes X no at what depths? _____

Was H₂S encountered? yes X no at what depths? _____

Were unusual drilling circumstances encountered? yes X no

If yes, briefly explain below

Other remarks: Irregular Section

If more than three drainholes are proposed, attach a separate sheet indicating the necessary information.

Direction must be stated in degrees azimuth.
Please note, the horizontal drainhole and its end point must be located within the boundaries of the lease or spacing unit.

Directional surveys are required for all drainholes and directional wells.

640 Acres

SEC	TWP	RGE	COUNTY			
Spot Location				Feet From 1/4 Sec Lines	FSL	FWL
1/4	1/4	1/4	1/4			
Measured Total Depth		True Vertical Depth		BHL From Lease, Unit, or Property Line:		

LATERAL #1									
SEC 14	TWP	3S	RGE	2E	COUNTY	Carter 2123			
Spot Location		NW 1/4 SW 1/4		NW 1/4		Feet From 1/4 Sec Lines		FNL 2133	FWL 60
Depth of Deviation		11760		Radius of Turn		592.1		Direction 268 263.1	
Measured Total Depth		22862		True Vertical Depth		11901		Total Length 10172.0	
								BHL From Lease, Unit, or Property Line: 2133 FNL & 60 FWL	

SEC	TWP	RGE	COUNTY			
Spot Location				Feet From 1/4 Sec Lines	FSL	FWL
1/4	1/4	1/4	1/4			
Depth of Deviation		Radius of Turn	Direction	Total Length		
Measured Total Depth		True Vertical Depth	BHL From Lease, Unit, or Property Line:			

SEC	TWP	RGE	COUNTY			
Spot Location				Feet From 1/4 Sec Lines	FSL	FWL
1/4	1/4	1/4	1/4			
Depth of Deviation		Radius of Turn	Direction	Total Length		
Measured Total Depth		True Vertical Depth	BHL From Lease, Unit, or Property Line:			