

Oklahoma Corporation Commission
Oil & Gas Conservation Division
Post Office Box 52000
Oklahoma City, Oklahoma 73152-2000
Rule 165: 10-3-25

Form 1002A

API No.: 35111149040001

Completion Report

Spud Date: June 06, 1955

OTC Prod. Unit No.:

Drilling Finished Date: July 14, 1955

Amended

1st Prod Date: July 14, 1955

Amend Reason: CONVERT TO INJECTION SALTWATER

Completion Date: July 14, 1955

Recomplete Date: April 15, 2019

Drill Type: STRAIGHT HOLE

SERVICE WELL

Well Name: BASSETT 6

Purchaser/Measurer:

Location: OKMULGEE 19 14N 14E
NW NW SE SW
1100 FSL 1540 FWL of 1/4 SEC
Latitude: 35.670893 Longitude: -95.867872
Derrick Elevation: 0 Ground Elevation: 0

First Sales Date:

Operator: D & L OPERATING LLC 20099
PO BOX 153
105 S HUGHES AVE
MORRIS, OK 74445-4820

Completion Type	
X	Single Zone
	Multiple Zone
	Commingled

Location Exception
Order No
There are no Location Exception records to display.

Increased Density
Order No
There are no Increased Density records to display.

Casing and Cement							
Type	Size	Weight	Grade	Feet	PSI	SAX	Top of CMT
PRODUCTION	7 & 5 1/2	17 & 11.5		1355		185	SURFACE

Liner								
Type	Size	Weight	Grade	Length	PSI	SAX	Top Depth	Bottom Depth
There are no Liner records to display.								

Total Depth: 1390

Packer	
Depth	Brand & Type
1305	TENSION

Plug	
Depth	Plug Type
There are no Plug records to display.	

Initial Test Data

Test Date	Formation	Oil BBL/Day	Oil-Gravity (API)	Gas MCF/Day	Gas-Oil Ratio Cu FT/BBL	Water BBL/Day	Pumpin or Flowing	Initial Shut- In Pressure	Choke Size	Flow Tubing Pressure
There are no Initial Data records to display.										

Completion and Test Data by Producing Formation									
Formation Name: BOOCH				Code: 404BOCH			Class: INJ		
Spacing Orders				Perforated Intervals					
Order No		Unit Size		From			To		
There are no Spacing Order records to display.				There are no Perf. Intervals records to display.					
Acid Volumes				Fracture Treatments					
NONE				NONE					

Formation	Top
BOOCH SAND	1355

Were open hole logs run? No

Date last log run:

Were unusual drilling circumstances encountered? No

Explanation:

Other Remarks
OLD WELL CLEANED OUT IN 1955. TOTAL DEPTH 1,390'. BOOCH SAND 1,355' - 1,380'. RAN 415' 5 1/2" SWEDGED TO 7" AND RAN 940' 7" TO SURFACE. PUMPED 185 SACKS CEMENT TO SURFACE. COMPLETED AS SALTWATER INPUT WELL. 1,305' 2 3/8 TUBING AND PACKER. OCC - THIS WELL IS AN OPEN HOLE COMPLETION FROM BOTTOM OF 7" AND 5 1/2" CASING AT 1,355' TO TOTAL DEPTH AT 1,390'. PERMIT NUMBER 1906350017

FOR COMMISSION USE ONLY
<div>Status: Accepted</div> <div>1143606</div>

API NO. **111-14904**
OTC PROD.
UNIT NO.

(PLEASE TYPE OR USE BLACK INK ONLY)

OKLAHOMA CORPORATION COMMISSION
Oil & Gas Conservation Division
Post Office Box 52000
Oklahoma City, Oklahoma 73152-2000
Rule 165:10-3-25

RECEIVED

Form 1002A
Rev. 2009

JUL 31 2019

OKLAHOMA CORPORATION
COMMISSION

☒ ORIGINAL
☒ AMENDED (Reason)

Convert to Apply For permit to Inject Soft Water

COMPLETION REPORT

TYPE OF DRILLING OPERATION

☒ STRAIGHT HOLE ☐ DIRECTIONAL HOLE ☐ HORIZONTAL HOLE
☐ SERVICE WELL

If directional or horizontal, see reverse for bottom hole location.

COUNTY **OKMULGEE** SEC **19** TWP **14N** RGE **14E**
LEASE NAME **BASSE H** WELL NO. **#6**
NW 1/4 NW 1/4 SE 1/4 SW 1/4 FSL OF 1/4 SEC **1100** FWL OF 1/4 SEC **1540** RECOMP DATE **4-15-2019**
ELEVATION Derrick FL **GL** Ground Latitude (if known) **35.670893** Longitude (if known) **-95.867872**
OPERATOR NAME **D+L OPERATING LLC** OTC / OCC OPERATOR NO. **20099**
ADDRESS **P.O. BOX 153**
CITY **MORRIS** STATE **OKIA** ZIP **74445**

SPUD DATE **6-6-55**
DRLG FINISHED DATE **7-14-55**
DATE OF WELL COMPLETION **7-14-55**
1st PROD DATE **7-14-55**

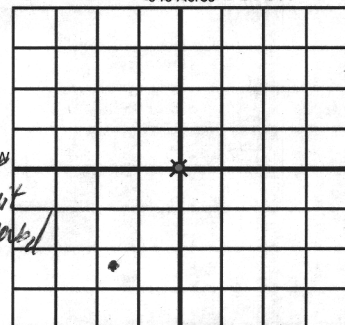

COMPLETION TYPE

☒ SINGLE ZONE
☐ MULTIPLE ZONE
Application Date
COMINGLED
Application Date
LOCATION EXCEPTION
ORDER NO.
INCREASED DENSITY
ORDER NO.

CASING & CEMENT (Attach Form 1002C)

TYPE	SIZE	WEIGHT	GRADE	FEET	PSI	SAX	TOP OF CMT
CONDUCTOR							
SURFACE							
INTERMEDIATE							
PRODUCTION	7"	17#		940 = 1355		185	surface
LINER	5 1/2"	11.5#		415			
							1390

PACKER @ **1305** BRAND & TYPE **tension**
PACKER @ _____ BRAND & TYPE _____

PLUG @ _____ TYPE _____ PLUG @ _____ TYPE _____
PLUG @ _____ TYPE _____ PLUG @ _____ TYPE _____

COMPLETION & TEST DATA BY PRODUCING FORMATION

FORMATION	BOOCH						
SPACING & SPACING							
ORDER NUMBER							
CLASS: Oil, Gas, Dry, Inj, Disp, Comm Disp, Svc	INJECTION						
PERFORATED INTERVALS	OPEN Hole	1355-80					
ACID/VOLUME	NONE						
FRACTURE TREATMENT (Fluids/Prop Amounts)	NONE						

Min Gas Allowable (165:10-17-7)



OR

Oil Allowable (165:10-13-3)

Gas Purchaser/Measurer

First Sales Date

INITIAL TEST DATA

INITIAL TEST DATE							
OIL-BBL/DAY							
OIL-GRAVITY (API)							
GAS-MCF/DAY							
GAS-OIL RATIO CU FT/BBL							
WATER-BBL/DAY							
PUMPING OR FLOWING							
INITIAL SHUT-IN PRESSURE							
CHOKE SIZE							
FLOW TUBING PRESSURE							

AS SUBMITTED

A record of the formations drilled through, and pertinent remarks are presented on the reverse. I declare that I have knowledge of the contents of this report and am authorized by my organization to make this report, which was prepared by me or under my supervision and direction, with the data and facts stated herein to be true, correct, and complete to the best of my knowledge and belief.

Larry Mathews SIGNATURE **LARRY MATHEWS** NAME (PRINT OR TYPE)
18151 S 270 RD ADDRESS **MORRIS OKIA 74445** CITY STATE ZIP **NA** EMAIL ADDRESS
7-23-19 DATE **918-756-7272** PHONE NUMBER

PLEASE TYPE OR USE BLACK INK ONLY
FORMATION RECORD

Give formation names and tops, if available, or descriptions and thickness of formations drilled through. Show intervals cored or drillstem tested.

LEASE NAME Bassett WELL NO. #6

NAMES OF FORMATIONS	TOP
Booch Sand	1355

FOR COMMISSION USE ONLY	
ITD on file <input type="checkbox"/> YES <input type="checkbox"/> NO	
APPROVED _____	DISAPPROVED _____
2) Reject Codes	

Were open hole logs run?	yes <input type="checkbox"/> no <input checked="" type="checkbox"/>
Date Last log was run	_____
Was CO ₂ encountered?	yes <input type="checkbox"/> no <input checked="" type="checkbox"/> at what depths? _____
Was H ₂ S encountered?	yes <input type="checkbox"/> no <input checked="" type="checkbox"/> at what depths? _____
Were unusual drilling circumstances encountered?	yes <input type="checkbox"/> no <input checked="" type="checkbox"/>
If yes, briefly explain below	

Other remarks: old well cleaned out in 1955 to 1390 Booch Sand 1355-1380
Ran 415' 5 1/2" swaged to 7" & Ran 940' 7" to surface. Pumped 185
sa cement to surface. Completed as s/w input well. 1305' 2 3/8 tubing
& packer.
OCC - This well is an open hole completion from bottom of 7 1/2" casing
at 1355' to total depth at 1390' PERMIT 1906350017

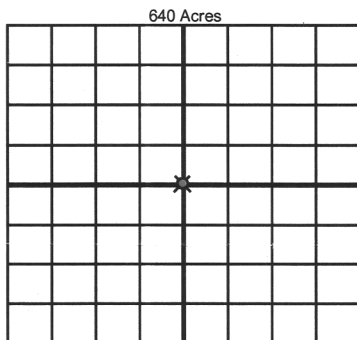

If more than three drainholes are proposed, attach a separate sheet indicating the necessary information.

Direction must be stated in degrees azimuth. Please note, the horizontal drainhole and its end point must be located within the boundaries of the lease or spacing unit.

Directional surveys are required for all drainholes and directional wells.

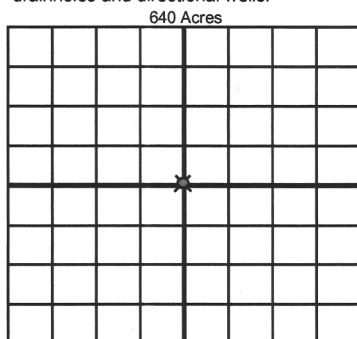

BOTTOM HOLE LOCATION FOR DIRECTIONAL HOLE

SEC	TWP	RGE	COUNTY
Spot Location			
1/4	1/4	1/4	1/4
Measured Total Depth		True Vertical Depth	BHL From Lease, Unit, or Property Line:

BOTTOM HOLE LOCATION FOR HORIZONTAL HOLE: (LATERALS)

LATERAL #1

SEC	TWP	RGE	COUNTY
Spot Location			
1/4	1/4	1/4	1/4
Depth of Deviation		Radius of Turn	Direction
Measured Total Depth		True Vertical Depth	BHL From Lease, Unit, or Property Line:

LATERAL #2

SEC	TWP	RGE	COUNTY
Spot Location			
1/4	1/4	1/4	1/4
Depth of Deviation		Radius of Turn	Direction
Measured Total Depth		True Vertical Depth	BHL From Lease, Unit, or Property Line:

LATERAL #3

SEC	TWP	RGE	COUNTY
Spot Location			
1/4	1/4	1/4	1/4
Depth of Deviation		Radius of Turn	Direction
Measured Total Depth		True Vertical Depth	BHL From Lease, Unit, or Property Line: