

Oklahoma Corporation Commission
Oil & Gas Conservation Division
Post Office Box 52000
Oklahoma City, Oklahoma 73152-2000
Rule 165: 10-3-25

Form 1002A

API No.: 35051245690000

Completion Report

Spud Date: April 07, 2019

OTC Prod. Unit No.: 051-225798-0-0000

Drilling Finished Date: April 14, 2019

1st Prod Date: June 20, 2019

Completion Date: June 10, 2019

Drill Type: STRAIGHT HOLE

Min Gas Allowable: Yes

Well Name: LARRY JACKSON 6-17

Purchaser/Measurer:

Location: GRADY 17 3N 7W
SE NW SE NE
1935 FNL 665 FEL of 1/4 SEC
Latitude: 34.7344636 Longitude: -97.9512013
Derrick Elevation: 1318 Ground Elevation: 1310

First Sales Date:

Operator: SUNDOWN ENERGY LP 21689

16400 DALLAS PKWY STE 100
DALLAS, TX 75248-2609

Completion Type		Location Exception		Increased Density	
X	Single Zone	Order No		Order No	
	Multiple Zone	There are no Location Exception records to display.		There are no Increased Density records to display.	
	Commingled				

Casing and Cement							
Type	Size	Weight	Grade	Feet	PSI	SAX	Top of CMT
CONDUCTOR	16			80		7	SURFACE
SURFACE	9 5/8	40	J-55	974	3000	450	SURFACE
PRODUCTION	5 1/2	15 & 17	J-55	3645	3000	325	1685

Liner								
Type	Size	Weight	Grade	Length	PSI	SAX	Top Depth	Bottom Depth
There are no Liner records to display.								

Total Depth: 3700

Packer	
Depth	Brand & Type
There are no Packer records to display.	

Plug	
Depth	Plug Type
2725	CIBP
3350	CIBP

Initial Test Data

Test Date	Formation	Oil BBL/Day	Oil-Gravity (API)	Gas MCF/Day	Gas-Oil Ratio Cu FT/BBL	Water BBL/Day	Pumpin or Flowing	Initial Shut-In Pressure	Choke Size	Flow Tubing Pressure
May 27, 2019	NOBLE-OLSON								64/64	
Jun 27, 2019	FORTUNA					160	PUMPINT	50	64/64	
Jul 23, 2019	FORTUNA	13	32			124	PUMPING	50	614/64	

Completion and Test Data by Producing Formation

Formation Name: NOBLE-OLSON

Code: 451NBLO

Class: DRY

Spacing Orders

Order No	Unit Size
NONE	

Perforated Intervals

From	To
3372	3416

Acid Volumes

500 GALLONS 7 1/2% HCL

Fracture Treatments

NONE

Formation Name: NOBLE-OLSON

Code: 451NBLO

Class: DRY

Spacing Orders

Order No	Unit Size
NONE	

Perforated Intervals

From	To
2986	3254

Acid Volumes

1,300 GALLONS 7 1/2% HCL

Fracture Treatments

NONE

Formation Name: FORTUNA

Code: 451FRTN

Class: DRY

Spacing Orders

Order No	Unit Size
NONE	

Perforated Intervals

From	To
2772	2777

Acid Volumes

500 GALLONS 7 1/2% HCL

Fracture Treatments

NONE

Formation Name: FORTUNA

Code: 451FRTN

Class: OIL

Spacing Orders

Order No	Unit Size
NONE	

Perforated Intervals

From	To
2592	2597

Acid Volumes

NONE

Fracture Treatments

NONE

Formation	Top
FORTUNA	1911

Were open hole logs run? Yes

Date last log run: April 13, 2019

NOBLE-OLSON	3106
-------------	------

Were unusual drilling circumstances encountered? No
Explanation:

Other Remarks
There are no Other Remarks.

FOR COMMISSION USE ONLY	
Status: Accepted	1143581

API NO. 051-24569
OTC PROD. UNIT NO. 051-225798

(PLEASE TYPE OR USE BLACK INK ONLY)

OKLAHOMA CORPORATION COMMISSION
Oil & Gas Conservation Division
Post Office Box 52000
Oklahoma City, Oklahoma 73152-2000
Rule 165:10-3-25

RECEIVED

Form 1002A
Rev. 2009

JUL 29 2019

OKLAHOMA CORPORATION COMMISSION
640 Acres

☒ ORIGINAL
☐ AMENDED (Reason)

COMPLETION REPORT

TYPE OF DRILLING OPERATION

☒ STRAIGHT HOLE ☐ DIRECTIONAL HOLE ☐ HORIZONTAL HOLE
☐ SERVICE WELL

If directional or horizontal, see reverse for bottom hole location.

COUNTY GRADY SEC 17 TWP 3N RGE 7W
LEASE NAME LARRY JACKSON
SE 1/4 NW 1/4 SE 1/4 NE 1/4
ELEVATION Derrick FL 1318 Ground 1310
OPERATOR NAME SUNDOWN ENERGY, LP
ADDRESS 16400 DALLAS PARKWAY #100
CITY DALLAS STATE TX ZIP 75248

SPUD DATE 4/7/2019
DRLG FINISHED DATE 4/14/2019
DATE OF WELL COMPLETION 6/10/2019
1st PROD DATE 6/20/2019
RECOMP DATE

W E

LOCATE WELL

COMPLETION TYPE

☒ SINGLE ZONE
☐ MULTIPLE ZONE
☐ COMMINGLED
☐ LOCATION EXCEPTION
☐ INCREASED DENSITY

CASING & CEMENT (Attach Form 1002C)

TYPE	SIZE	WEIGHT	GRADE	FEET	PSI	SAX	TOP OF CMT
CONDUCTOR	16			80		7.5yd	SURF
SURFACE	9 5/8	40	J55	974	3000	485	SURF
INTERMEDIATE						450	
PRODUCTION	5 1/2	15 & 17	J55	3645	3000	325	1685
LINER							

Per 1002C

PACKER @ BRAND & TYPE CIBP PLUG @ 3350' TYPE CIBP PLUG @ 2725' TYPE CIBP

TOTAL DEPTH 3,700

COMPLETION & TEST DATA BY PRODUCING FORMATION

FORMATION	NOBLE-OLSEN	NOBLE-OLSEN	FORTUNA	FORTUNA	No Frac
SPACING & SPACING ORDER NUMBER	NONE	NONE	NONE	NONE	
CLASS: Oil, Gas, Dry, Inj, Disp, Comm Disp, Svc	DRY	DRY	DRY	OIL	
PERFORATED INTERVALS	3372'-3374'	3249'-3254'	2772'-2777'	2592'-2597'	
ACID/VOLUME	500 GAL 7 1/2 HCL	1300 GAL 7 1/2% HCL	500 GAL 7 1/2% HCL	NONE	
FRACTURE TREATMENT (Fluids/Prop Amounts)	NONE	NONE	NONE	NONE	

AS SUBMITTED

☒ Min Gas Allowable (165:10-17-7) OR Gas Purchaser/Measurer First Sales Date
☐ Oil Allowable (165:10-13-3)

INITIAL TEST DATA

INITIAL TEST DATE	5/27/2019	6/27/2019	7/23/2019
OIL-BBL/DAY	0	0	13
OIL-GRAVITY (API)	NA	NA	32
GAS-MCF/DAY	TSTM	TSTM	TSTM
GAS-OIL RATIO CU FT/BBL	NA	NA	NA
WATER-BBL/DAY	0	160	124
PUMPING OR FLOWING	NA	PUMPING	PUMPING
INITIAL SHUT-IN PRESSURE	0	50	50
CHOKE SIZE	64/64	64/64	64/64
FLOW TUBING PRESSURE	NA	NA	NA

A record of the formations drilled through, and pertinent remarks are presented on the reverse. I declare that I have knowledge of the contents of this report and am authorized by my organization to make this report, which was prepared by me or under my supervision and direction, with the data and facts stated herein to be true, correct, and complete to the best of my knowledge and belief.

RALPH BUTLER, PE

7/25/19 (214) 368-6100

SIGNATURE

NAME (PRINT OR TYPE)

DATE PHONE NUMBER

16400 DALLAS PARKWAY #100

DALLAS TEXAS 75248

rbutler@sundownenergy.com

ADDRESS

CITY

STATE

ZIP

EMAIL ADDRESS

PLEASE TYPE OR USE BLACK INK ONLY
FORMATION RECORD

Give formation names and tops, if available, or descriptions and thickness of formations drilled through. Show intervals cored or drillstem tested.

NAMES OF FORMATIONS	TOP
FORTUNA	1911'
NOBLE-OLSEN	3106'

LEASE NAME LARRY JACKSON 6-17 WELL NO. _____

FOR COMMISSION USE ONLY	
ITD on file <input type="checkbox"/> YES <input type="checkbox"/> NO	
APPROVED _____	DISAPPROVED _____
2) Reject Codes	

Were open hole logs run? ☒ yes ☐ no

Date Last log was run 4/13/2019

Was CO₂ encountered? ☐ yes ☒ no at what depths? _____

Was H₂S encountered? ☐ yes ☒ no at what depths? _____

Were unusual drilling circumstances encountered? ☐ yes ☒ no

If yes, briefly explain below _____

Other remarks: _____

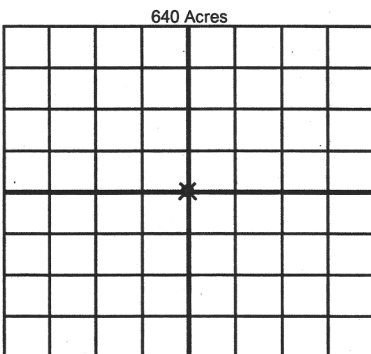

If more than three drainholes are proposed, attach a separate sheet indicating the necessary information.

Direction must be stated in degrees azimuth. Please note, the horizontal drainhole and its end point must be located within the boundaries of the lease or spacing unit.

Directional surveys are required for all drainholes and directional wells.

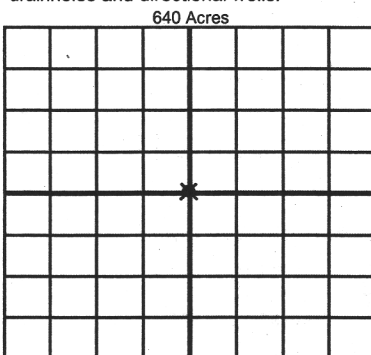

BOTTOM HOLE LOCATION FOR DIRECTIONAL HOLE

SEC	TWP	RGE	COUNTY
Spot Location			
1/4	1/4	1/4	1/4
Measured Total Depth		True Vertical Depth	BHL From Lease, Unit, or Property Line:

BOTTOM HOLE LOCATION FOR HORIZONTAL HOLE: (LATERALS)

LATERAL #1

SEC	TWP	RGE	COUNTY
Spot Location			
1/4	1/4	1/4	1/4
Depth of Deviation		Radius of Turn	Direction
Measured Total Depth		True Vertical Depth	BHL From Lease, Unit, or Property Line:

LATERAL #2

SEC	TWP	RGE	COUNTY
Spot Location			
1/4	1/4	1/4	1/4
Depth of Deviation		Radius of Turn	Direction
Measured Total Depth		True Vertical Depth	BHL From Lease, Unit, or Property Line:

LATERAL #3

SEC	TWP	RGE	COUNTY
Spot Location			
1/4	1/4	1/4	1/4
Depth of Deviation		Radius of Turn	Direction
Measured Total Depth		True Vertical Depth	BHL From Lease, Unit, or Property Line: