

Oklahoma Corporation Commission  
Oil & Gas Conservation Division  
Post Office Box 52000  
Oklahoma City, Oklahoma 73152-2000  
Rule 165: 10-3-25

Form 1002A

API No.: 35051245710000

**Completion Report**

Spud Date: April 17, 2019

OTC Prod. Unit No.: 051-225797-0-0000

Drilling Finished Date: April 24, 2019

1st Prod Date: June 09, 2019

Completion Date: May 21, 2019

**Drill Type:** STRAIGHT HOLE

Min Gas Allowable: Yes

Well Name: LARRY JACKSON 4-16

Purchaser/Measurer:

Location: GRADY 16 3N 7W  
C S2 SW NW  
2310 FNL 660 FWL of 1/4 SEC  
Latitude: 34.733442 Longitude: -97.946787  
Derrick Elevation: 1324 Ground Elevation: 1316

First Sales Date:

Operator: SUNDOWN ENERGY LP 21689

16400 DALLAS PKWY STE 100  
DALLAS, TX 75248-2609

Completion Type		Location Exception		Increased Density	
X	Single Zone	Order No		Order No	
	Multiple Zone	NONE		NONE	
	Commingled				

Casing and Cement							
Type	Size	Weight	Grade	Feet	PSI	SAX	Top of CMT
CONDUCTOR	16			80		7	SURFACE
SURFACE	8 5/8	24 & 32	J-55	1051	3000	550	SURFACE
PRODUCTION	5 1/2	15 & 17	N-80	3694	3000	325	1810

Liner								
Type	Size	Weight	Grade	Length	PSI	SAX	Top Depth	Bottom Depth
There are no Liner records to display.								

**Total Depth: 3700**

Packer	
Depth	Brand & Type
There are no Packer records to display.	

Plug	
Depth	Plug Type
There are no Plug records to display.	

Initial Test Data
-------------------

Test Date	Formation	Oil BBL/Day	Oil-Gravity (API)	Gas MCF/Day	Gas-Oil Ratio Cu FT/BBL	Water BBL/Day	Pumpin or Flowing	Initial Shut-In Pressure	Choke Size	Flow Tubing Pressure
Jun 15, 2019	NOBLE-OLSON	13.5	34			37	PUMPING	200	64/64	

<b>Completion and Test Data by Producing Formation</b>															
Formation Name: NOBLE-OLSON		Code: 451NBLO	Class: OIL												
<table border="1" style="width:100%; border-collapse: collapse;"> <tr><th colspan="2">Spacing Orders</th></tr> <tr> <th>Order No</th> <th>Unit Size</th> </tr> <tr> <td>NONE</td> <td></td> </tr> </table>		Spacing Orders		Order No	Unit Size	NONE		<table border="1" style="width:100%; border-collapse: collapse;"> <tr><th colspan="2">Perforated Intervals</th></tr> <tr> <th>From</th> <th>To</th> </tr> <tr> <td>3177</td> <td>3403</td> </tr> </table>		Perforated Intervals		From	To	3177	3403
Spacing Orders															
Order No	Unit Size														
NONE															
Perforated Intervals															
From	To														
3177	3403														
<table border="1" style="width:100%; border-collapse: collapse;"> <tr><th colspan="2">Acid Volumes</th></tr> <tr> <td colspan="2">750 GALLONS 7.5%</td> </tr> </table>		Acid Volumes		750 GALLONS 7.5%		<table border="1" style="width:100%; border-collapse: collapse;"> <tr><th colspan="2">Fracture Treatments</th></tr> <tr> <td colspan="2">NONE</td> </tr> </table>		Fracture Treatments		NONE					
Acid Volumes															
750 GALLONS 7.5%															
Fracture Treatments															
NONE															

Formation	Top
FORTUNA	1907
NOBLE-OLSON	3162

Were open hole logs run? Yes  
 Date last log run: April 23, 2019  
  
 Were unusual drilling circumstances encountered? No  
 Explanation:

<b>Other Remarks</b>
There are no Other Remarks.

<b>FOR COMMISSION USE ONLY</b>	
Status: Accepted	1143582

API NO. 051-24571  
OTC PROD. UNIT NO. 051-225797

(PLEASE TYPE OR USE BLACK INK ONLY)

OKLAHOMA CORPORATION COMMISSION  
Oil & Gas Conservation Division  
Post Office Box 52000  
Oklahoma City, Oklahoma 73152-2000  
Rule 165:10-3-25

RECEIVED

Form 1002A  
Rev. 2009

JUL 29 2019

OKLAHOMA CORPORATION COMMISSION

☒ ORIGINAL  
☐ AMENDED (Reason) \_\_\_\_\_

COMPLETION REPORT

TYPE OF DRILLING OPERATION

☒ STRAIGHT HOLE ☐ DIRECTIONAL HOLE ☐ HORIZONTAL HOLE  
☐ SERVICE WELL

If directional or horizontal, see reverse for bottom hole location.

COUNTY	GRADY	SEC	16	TWP	3N	RGE	7W	SPUD DATE	4/17/19
LEASE NAME	LARRY JACKSON	WELL NO.	4-16	DRLG FINISHED DATE	4/24/19	DATE OF WELL COMPLETION	5/21/19	1st PROD DATE	6/9/19
ELEVATION Derrick FL	1324.5	Ground	1316	Latitude (if known)	34.733442	Longitude (if known)	-97.946787	RECOMP DATE	
OPERATOR NAME	SUNDOWN ENERGY, LP	OTC / OCC OPERATOR NO.	21689						
ADDRESS	16400 DALLAS PARKWAY #100								
CITY	DALLAS	STATE	TX	ZIP	75248				

W										E

LOCATE WELL

COMPLETION TYPE

<input checked="" type="checkbox"/> SINGLE ZONE	
<input type="checkbox"/> MULTIPLE ZONE	
Application Date	
<input type="checkbox"/> COMMINGLED	
Application Date	
LOCATION EXCEPTION ORDER NO.	none
INCREASED DENSITY ORDER NO.	none

CASING & CEMENT (Attach Form 1002C)

TYPE	SIZE	WEIGHT	GRADE	FEET	PSI	SAX	TOP OF CMT
CONDUCTOR	16			80		7.5yd	SURF
SURFACE	8 5/8	24&32	J55	1051	3000	550	SURF
INTERMEDIATE							
PRODUCTION	5 1/2	15 & 17	N80	3694	3000	325	1810
LINER							
							3,700

PACKER @ \_\_\_\_\_ BRAND & TYPE \_\_\_\_\_ PLUG @ \_\_\_\_\_ TYPE \_\_\_\_\_ PLUG @ \_\_\_\_\_ TYPE \_\_\_\_\_  
PACKER @ \_\_\_\_\_ BRAND & TYPE \_\_\_\_\_ PLUG @ \_\_\_\_\_ TYPE \_\_\_\_\_ PLUG @ \_\_\_\_\_ TYPE \_\_\_\_\_

COMPLETION & TEST DATA BY PRODUCING FORMATION

FORMATION	NOBLE-OLSEN						No Frac
SPACING & SPACING ORDER NUMBER	NONE						
CLASS: Oil, Gas, Dry, Inj, Disp, Comm Disp, Svc	OIL						
PERFORATED INTERVALS	1-3177'-3190'						
	2- 3368'-3374'						
	3-3396'-3403'						
ACID/VOLUME	1 & 2 750 GAL 7.5%						
	3- 750 GAL 7.5%						
FRACTURE TREATMENT (Fluids/Prop Amounts)	NONE						

Min Gas Allowable (165:10-17-7)

Gas Purchaser/Measurer

☒

OR

First Sales Date

INITIAL TEST DATA

Oil Allowable (165:10-13-3)

INITIAL TEST DATE	6/15/2019					
OIL-BBL/DAY	13.5					
OIL-GRAVITY ( API)	34					
GAS-MCF/DAY	TSTM					
GAS-OIL RATIO CU FT/BBL	NA					
WATER-BBL/DAY	37					
PUMPING OR FLOWING	PUMPING					
INITIAL SHUT-IN PRESSURE	200					
CHOKE SIZE	64/64					
FLOW TUBING PRESSURE	NA					

AS SUBMITTED

A record of the formations drilled through, and pertinent remarks are presented on the reverse. I declare that I have knowledge of the contents of this report and am authorized by my organization to make this report, which was prepared by me or under my supervision and direction, with the data and facts stated herein to be true, correct, and complete to the best of my knowledge and belief.

SIGNATURE \_\_\_\_\_ NAME (PRINT OR TYPE) RALPH BUTLER, PE  
16400 DALLAS PARKWAY #100 DALLAS TEXAS 75248  
ADDRESS CITY STATE ZIP  
DATE 7/25/19 PHONE NUMBER (214) 368-6100  
EMAIL ADDRESS rbutler@sundownenergy.com

PLEASE TYPE OR USE BLACK INK ONLY  
FORMATION RECORD

Give formation names and tops, if available, or descriptions and thickness of formations drilled through. Show intervals cored or drillstem tested.

LEASE NAME **LARRY JACKSON 4-16**

WELL NO. \_\_\_\_\_

NAMES OF FORMATIONS	TOP
FORTUNA	1907'
NOBLE-OLSEN	3162'

FOR COMMISSION USE ONLY

ITD on file ☐ YES ☐ NO

APPROVED \_\_\_\_\_ DISAPPROVED \_\_\_\_\_

2) Reject Codes

\_\_\_\_\_

\_\_\_\_\_

\_\_\_\_\_

\_\_\_\_\_

Were open hole logs run? ☒ yes ☐ no

Date Last log was run 4/23/2019

Was CO<sub>2</sub> encountered? ☐ yes ☒ no at what depths? \_\_\_\_\_

Was H<sub>2</sub>S encountered? ☐ yes ☒ no at what depths? \_\_\_\_\_

Were unusual drilling circumstances encountered? ☐ yes ☒ no

If yes, briefly explain below \_\_\_\_\_

Other remarks: \_\_\_\_\_

\_\_\_\_\_

\_\_\_\_\_

\_\_\_\_\_

\_\_\_\_\_

\_\_\_\_\_

640 Acres

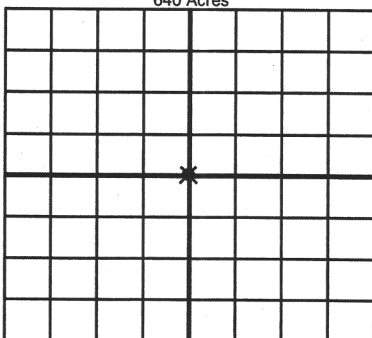

If more than three drainholes are proposed, attach a separate sheet indicating the necessary information.

Direction must be stated in degrees azimuth. Please note, the horizontal drainhole and its end point must be located within the boundaries of the lease or spacing unit.

Directional surveys are required for all drainholes and directional wells.

640 Acres

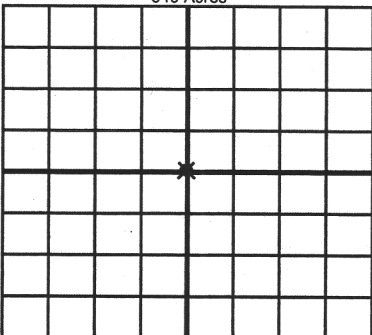

**BOTTOM HOLE LOCATION FOR DIRECTIONAL HOLE**

SEC	TWP	RGE	COUNTY
Spot Location		Feet From 1/4 Sec Lines	FSL
1/4	1/4	1/4	1/4
Measured Total Depth	True Vertical Depth	BHL From Lease, Unit, or Property Line:	

**BOTTOM HOLE LOCATION FOR HORIZONTAL HOLE: (LATERALS)**

**LATERAL #1**

SEC	TWP	RGE	COUNTY
Spot Location		Feet From 1/4 Sec Lines	FSL
1/4	1/4	1/4	1/4
Depth of Deviation	Radius of Turn	Direction	Total Length
Measured Total Depth	True Vertical Depth	BHL From Lease, Unit, or Property Line:	

**LATERAL #2**

SEC	TWP	RGE	COUNTY
Spot Location		Feet From 1/4 Sec Lines	FSL
1/4	1/4	1/4	1/4
Depth of Deviation	Radius of Turn	Direction	Total Length
Measured Total Depth	True Vertical Depth	BHL From Lease, Unit, or Property Line:	

**LATERAL #3**

SEC	TWP	RGE	COUNTY
Spot Location		Feet From 1/4 Sec Lines	FSL
1/4	1/4	1/4	1/4
Depth of Deviation	Radius of Turn	Direction	Total Length
Measured Total Depth	True Vertical Depth	BHL From Lease, Unit, or Property Line:	