

Oklahoma Corporation Commission
Oil & Gas Conservation Division
Post Office Box 52000
Oklahoma City, Oklahoma 73152-2000
Rule 165: 10-3-25

Form 1002A

API No.: 35093251500001

Completion Report

Spud Date: April 16, 2019

OTC Prod. Unit No.: 093-226827-0-0000

Drilling Finished Date: May 20, 2019

1st Prod Date: March 21, 2020

Completion Date: March 21, 2020

Drill Type: HORIZONTAL HOLE

Min Gas Allowable: Yes

Well Name: RED BANDANA 21N-9W 12-1H

Purchaser/Measurer: TARGA

Location: MAJOR 12 21N 9W
SW SW SE SW
215 FSL 1530 FWL of 1/4 SEC
Latitude: 36.304478 Longitude: -98.116718
Derrick Elevation: 1289 Ground Elevation: 1271

First Sales Date: 06/11/2020

Operator: INTERSTATE EXPLORATIONS LLC 24089
PO BOX 984
301 E 18TH ST
CISCO, TX 76437-0984

Completion Type		Location Exception		Increased Density	
X	Single Zone	Order No		Order No	
	Multiple Zone	709151		There are no Increased Density records to display.	
	Commingled	718112 MOD			

Casing and Cement							
Type	Size	Weight	Grade	Feet	PSI	SAX	Top of CMT
SURFACE	11 3/4	42	J-55	525		250	SURFACE
PRODUCTION	8 5/8	32	P-110	7167		290	5082

Liner								
Type	Size	Weight	Grade	Length	PSI	SAX	Top Depth	Bottom Depth
LINER	5 1/2	23	P-110	12710	0	0	SURFACE	12710

Total Depth: 12710

Packer	
Depth	Brand & Type
There are no Packer records to display.	

Plug	
Depth	Plug Type
There are no Plug records to display.	

Initial Test Data

Test Date	Formation	Oil BBL/Day	Oil-Gravity (API)	Gas MCF/Day	Gas-Oil Ratio Cu FT/BBL	Water BBL/Day	Pumpin or Flowing	Initial Shut-In Pressure	Choke Size	Flow Tubing Pressure
Apr 21, 2020	MISSISSIPPIAN	42	40	12	286	1882	ESP		OPEN	220

Completion and Test Data by Producing Formation

Formation Name: MISSISSIPPIAN

Code: 359MSSP

Class: OIL

Spacing Orders

Order No	Unit Size
685298	640

Perforated Intervals

From	To
There are no Perf. Intervals records to display.	

Acid Volumes

1,107 BARRELS 15% HCL

Fracture Treatments

384,941 BARRELS SLICKWATER, 11,000,561 POUNDS PROPPANT
--

Formation	Top
BIG LIME	6263
OSWEGO	6323
VERDIGRIS	6513
RED FORK	6606
MANNING	6810
MISSISSIPPI	6977

Were open hole logs run? No

Date last log run:

Were unusual drilling circumstances encountered? Yes

Explanation: LOST CIRCULATION ZONE ENCOUNTERED AT 8,525' MD. PRODUCTION CASING NOT CEMENTED DUE TO LOSS CIRCULATION, THIS IS WHY OPERATOR RAN A PACKER SYSTEM.

Other Remarks

OCC - THIS WELL IS AN OPEN HOLE COMPLETION FROM BOTTOM OF THE 8 5/8" CASING AT 7176' TO TOTAL DEPTH AT 12710'. THE 5 1/2" LINER IS NOT CEMENTED. OCC - IN INITIAL TEST ESP IS ELECTRONIC SUBMERSIBLE PUMP

Lateral Holes

Sec: 12 TWP: 21N RGE: 9W County: MAJOR

NW NW NE NW

200 FNL 1450 FWL of 1/4 SEC

Depth of Deviation: 6074 Radius of Turn: 1886 Direction: 360 Total Length: 4853

Measured Total Depth: 12710 True Vertical Depth: 7436 End Pt. Location From Release, Unit or Property Line: 200

FOR COMMISSION USE ONLY

1145598

Status: Accepted

API NO. 093-25150
OTC PROD. 093226827
UNIT NO.

(PLEASE TYPE OR USE BLACK INK ONLY)

OKLAHOMA CORPORATION COMMISSION
Oil & Gas Conservation Division
Post Office Box 52000
Oklahoma City, Oklahoma 73152-2000
Rule 165.10-3-25

Form 1002A
Rev. 2009

☒ ORIGINAL
☐ AMENDED (Reason)

COMPLETION REPORT

TYPE OF DRILLING OPERATION

☐ STRAIGHT HOLE ☐ DIRECTIONAL HOLE ☒ HORIZONTAL HOLE
☐ SERVICE WELL

If directional or horizontal, see reverse for bottom hole location.

COUNTY Major SEC 12 TWP 21N RGE 9W
LEASE NAME Red Bandana 21N-9W WELL NO. 12-1H
SW 1/4 SW 1/4 SE 1/4 SW 1/4 FSL OF 215 FWL OF 1530
ELEVATION 1289 Ground 1271 Latitude (if known) 36.304478 Longitude (if known) -98.116718
OPERATOR NAME Interstate Explorations LLC OTC/OCC OPERATOR NO. 24089
ADDRESS PO Box 984
CITY Cisco STATE TX ZIP 76437

SPUD DATE 4/16/19
DRLG FINISHED DATE 5/20/19
DATE OF WELL COMPLETION 3/21/2020
1st PROD DATE 3/21/2020
RECOMP DATE

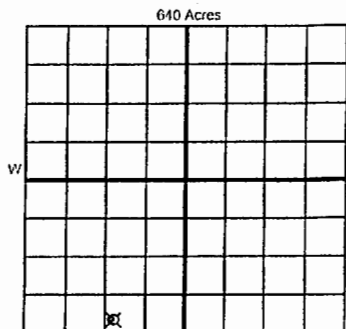

COMPLETION TYPE

☒ SINGLE ZONE
☐ MULTIPLE ZONE
Application Date
☐ COMINGLED
Application Date
LOCATION EXCEPTION ORDER NO.
INCREASED DENSITY ORDER NO.

CASING & CEMENT (Attach Form 1002C)

TYPE	SIZE	WEIGHT	GRADE	FEET	PSI	SAX	TOP OF CMT
CONDUCTOR							
SURFACE	11 3/4	42#	J-55	525'		250	surface
INTERMEDIATE	8 5/8	32#	P-110	7,167		290	5,082
PRODUCTION	5 1/2	23#	P-110	12,710		See	Notes
LINER							
TOTAL DEPTH							12,710'

PACKER @ BRAND & TYPE PLUG @ TYPE PLUG @ TYPE
PACKER @ BRAND & TYPE PLUG @ TYPE PLUG @ TYPE

COMPLETION & TEST DATA BY PRODUCING FORMATION

FORMATION Mississippian
SPACING & SPACING (640) Horizontal
ORDER NUMBER 685298
CLASS: Oil, Gas, Dry, Inj.
Disp, Comm Disp, Svc
PERFORATED INTERVALS
ACID/VOLUME 1107 bbls 15% HCL
FRACTURE TREATMENT (Fluids/Prop Amounts) 384,941 bbls slickwater 11,000,561# proppant

☒ Min Gas Allowable (165:10-17-7) Gas Purchaser/Measurer Targa
OR First Sales Date 6/11/2020
☐ Oil Allowable (165:10-13-3)

INITIAL TEST DATA

INITIAL TEST DATE	4/21/2020
OIL-BBL/DAY	42
OIL-GRAVITY (API)	40
GAS-MCF/DAY	12
GAS-OIL RATIO CU FT/BBL	286
WATER-BBL/DAY	1882
PUMPING OR FLOWING	ESP
INITIAL SHUT-IN PRESSURE	
CHOKE SIZE	Open
FLOW TUBING PRESSURE	220

A record of the formations drilled through, and pertinent remarks are presented on the reverse. I declare that I have knowledge of the contents of this report and am authorized by my organization to make this report, which was prepared by me or under my supervision and direction, with the data and facts stated herein to be true, correct, and complete to the best of my knowledge and belief.

SIGNATURE Matt Dawson 9/18/2020 713/308/4910
1331 Lamar Street, Suite 1370 Houston TX 77010
ADDRESS CITY STATE ZIP matt.dawson@ie-llc.net
EMAIL ADDRESS

PLEASE TYPE OR USE BLACK INK ONLY

FORMATION RECORD

Give formation names and tops, if available, or descriptions and thickness of formations drilled through. Show intervals cored or drillstem tested.

NAMES OF FORMATIONS	TOP
Big Lime	6,263'
Oswego	6,323'
Verdigris	6,513'
Redfork	6,606'
Manning	6,810'
Mississippi	6,977'

LEASE NAME Red Bandana 21N-9W WELL NO 12-1H

FOR COMMISSION USE ONLY	
ITD on file <input type="checkbox"/> YES <input type="checkbox"/> NO	
APPROVED _____	DISAPPROVED _____
2) Reject Codes	

Were open hole logs run?	yes	<input checked="" type="checkbox"/> no
Date Last log was run	_____	
Was CO ₂ encountered?	yes	<input checked="" type="checkbox"/> no at what depths? _____
Was H ₂ S encountered?	yes	<input checked="" type="checkbox"/> no at what depths? _____
Were unusual drilling circumstances encountered?	<input checked="" type="checkbox"/> yes <input type="checkbox"/> no	
If yes, briefly explain below		
Lost circulation zone encountered at 8,525' MD		

Other remarks: Production was not cemented due to loss circulation. That is why we ran the packer system.

OCC-ESP- is electronic submersible pump

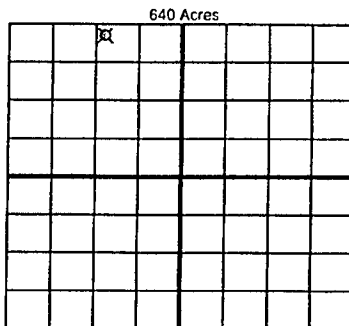

If more than three drainholes are proposed, attach a separate sheet indicating the necessary information

Direction must be stated in degrees azimuth. Please note, the horizontal drainhole and its end point must be located within the boundaries of the lease or spacing unit.

Directional surveys are required for all drainholes and directional wells.

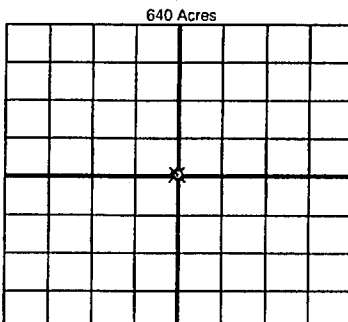

BOTTOM HOLE LOCATION FOR DIRECTIONAL HOLE

SEC	TWP	RGE	COUNTY
Spot Location			
1/4	1/4	1/4	1/4
Measured Total Depth		True Vertical Depth	BHL From Lease, Unit, or Property Line:

BOTTOM HOLE LOCATION FOR HORIZONTAL HOLE: (LATERALS)

LATERAL #1

SEC	TWP	RGE	COUNTY	Major
12	21N	9W		
Spot Location				
NW 1/4	NW 1/4	NE 1/4	NW 1/4	Feet From 1/4 Sec Lines
Depth of Deviation		Radius of Turn	Direction	FNL 200
6,074'		1,886'	360°	FWL 1500
Measured Total Depth		True Vertical Depth	Total Length	
12,710'		7,436'	4,853'	
			BHL From Lease, Unit, or Property Line:	
			200' FNL	

LATERAL #2

SEC	TWP	RGE	COUNTY
Spot Location			
1/4	1/4	1/4	1/4
Depth of Deviation		Radius of Turn	Direction
Measured Total Depth		True Vertical Depth	BHL From Lease, Unit, or Property Line:

LATERAL #3

SEC	TWP	RGE	COUNTY
Spot Location			
1/4	1/4	1/4	1/4
Depth of Deviation		Radius of Turn	Direction
Measured Total Depth		True Vertical Depth	BHL From Lease, Unit, or Property Line:

x spess compliant

OKLAHOMA CORPORATION COMMISSION
OIL & GAS CONSERVATION DIVISION
P.O. BOX 52000
OKLAHOMA CITY, OK 73152-2000
(Rule 165:10-3-1)

PUN-043-226827 *Producing 6-2020*
Approval Date: 08/02/2018
Expiration Date: 02/02/2020
spudded 4-16-19

API NUMBER: 093 25150 A

Horizontal Hole Oil & Gas

Amend reason: MOVED SHL & BHL, MTD.

AMEND PERMIT TO DRILL

WELL LOCATION: Sec: 12 Twp: 21N Rge: 9W

County: MAJOR

SPOT LOCATION: ☐ SW ☐ SW ☐ SE ☐ SW

FEET FROM QUARTER: FROM SOUTH FROM WEST

SECTION LINES: 215 1530

Lease Name: RED BANDANA 21N-9W

Well No: 12-1H

Well will be 215 feet from nearest unit or lease boundary.

Operator Name: INTERSTATE EXPLORATIONS LLC

Telephone: 8178503600

OTC/OCC Number: 24089 0

INTERSTATE EXPLORATIONS LLC

PO BOX 984

CISCO, TX 76437-0984

RODNEY & KIMBERLY STOTTS

PO BOX 197

MENO OK 73760

Formation(s) (Permit Valid for Listed Formations Only):

	Name	Depth	Name	Depth
1	MISSISSIPPIAN	6765	6	
2			7	
3			8	
4			9	
5			10	

Spacing Orders: 685298

Location Exception Orders: *709151FO*

Increased Density Orders:

Pending CD Numbers: *201801800*

Special Orders:

Total Depth: 12500

Ground Elevation: 1271

Surface Casing: 490

Depth to base of Treatable Water-Bearing FM: 440

Under Federal Jurisdiction: No

Fresh Water Supply Well Drilled: No

Surface Water used to Drill: Yes

PIT 1 INFORMATION

Approved Method for disposal of Drilling Fluids:

Type of Pit System: CLOSED Closed System Means Steel Pits

Type of Mud System: WATER BASED

Chlorides Max: 8000 Average: 5000

D. One time land application -- (REQUIRES PERMIT)

PERMIT NO: 18-34802

Is depth to top of ground water greater than 10ft below base of pit? Y

H. CLOSED SYSTEM=STEEL PITS (REQUIRED - ORDER 287231)

Within 1 mile of municipal water well? Y

Wellhead Protection Area? Y

Pit is located in a Hydrologically Sensitive Area.

Category of Pit: C

Liner not required for Category: C

Pit Location Is AP/TE DEPOSIT

Pit Location Formation: TERRACE

This permit does not address the right of entry or settlement of surface damages.

The duration of this permit is SIX MONTHS, except as otherwise provided by Rule 165: 10-3-1.

Rule 165: 10-3-4 (c) (7) (e) - The Operator shall give 24 Hours notice by telephone to the appropriate District Office of the Conservation Division as to when Surface Casing will be run.

HORIZONTAL HOLE 1

Sec 12 Twp 21N Rge 9W County MAJOR

Spot Location of End Point: NW NW NE NW

Feet From: NORTH 1/4 Section Line: 200

Feet From: WEST 1/4 Section Line: 1500

Depth of Deviation: 6700

Radius of Turn: 593

Direction: 359

Total Length: 4869

Measured Total Depth: 12500

True Vertical Depth: 7445

End Point Location from Lease,

Unit, or Property Line: 165

Notes:

Category

Description

HYDRAULIC FRACTURING

6/28/2018 - G71 - OCC 165:10-3-10 REQUIRES:

1) PRIOR TO COMMENCEMENT OF HYDRAULIC FRACTURING OPERATIONS FOR HORIZONTAL WELLS, NOTICE GIVEN FIVE BUSINESS DAYS IN ADVANCE TO OFFSET OPERATORS WITH WELLS COMPLETED IN THE SAME COMMON SOURCE OF SUPPLY WITHIN 1/2 MILE;

2) WITH NOTICE ALSO GIVEN 48 HOURS IN ADVANCE OF HYDRAULIC FRACTURING ALL WELLS TO BOTH THE OCC CENTRAL OFFICE AND LOCAL DISTRICT OFFICES, USING THE "FRAC NOTICE FORM" FOUND AT THE FOLLOWING LINK: OCCEWEB.COM/OG/OGFORMS.HTML; AND,

3) THE CHEMICAL DISCLOSURE OF HYDRAULIC FRACTURING INGREDIENTS FOR ALL WELLS TO BE REPORTED TO FRACFOCUS WITHIN 60 DAYS AFTER THE CONCLUSION THE HYDRAULIC FRACTURING OPERATIONS, USING THE FOLLOWING LINK: FRACFOCUS.ORG

PENDING CD - 201801800

8/1/2018 - G58 - (I.O.) 12-21N-9W

X201801798 MSSP

COMPL. INT. NCT 165' FNL, NCT 165' FSL, NCT 330' FWL

NO OP. NAMED

REC 4/17/2018 (MURER)

PUBLIC WATER SUPPLY WELLS

6/28/2018 - G71 - ENID - 1 PWS/WPA, NE/4 14-21N-9W & 1 PWS/WPA, SE/4 11-21N-9W

SPACING - 685298

4/9/2019 - G58 - (640)(HOR) 12-21N-9W

EST MSSP

POE TO BHL NLT 600' FB

(COEXIST SP. ORDER 133892 MSSLM; SP. ORDER 160431 MSSLM, MNNG)

This permit does not address the right of entry or settlement of surface damages.

The duration of this permit is SIX MONTHS, except as otherwise provided by Rule 165: 10-3-1.

Rule 165: 10-3-4 (c) (7) (e) - The Operator shall give 24 Hours notice by telephone to the appropriate District Office of the Conservation Division as to when Surface Casing will be run.

093 25150 RED BANDANA 21N-9W 12-1H