

Oklahoma Corporation Commission
Oil & Gas Conservation Division
Post Office Box 52000
Oklahoma City, Oklahoma 73152-2000
Rule 165: 10-3-25

Form 1002A

API No.: 35029213880001

Completion Report

Spud Date: November 27, 2018

OTC Prod. Unit No.: 029-22582-0-0000

Drilling Finished Date: January 08, 2019

1st Prod Date: February 12, 2019

Completion Date: February 03, 2019

Drill Type: HORIZONTAL HOLE

Min Gas Allowable: Yes

Well Name: BIG OAK 1-35/26H

Purchaser/Measurer: SOUTHWEST ENERGY LP

Location: COAL 35 3N 9E
SE SW NW NW
1110 FNL 331 FWL of 1/4 SEC
Latitude: 34.412836 Longitude: -96.20084
Derrick Elevation: 748 Ground Elevation: 723

First Sales Date: 02/12/2019

Operator: CANYON CREEK ENERGY OPERATING LLC 23443

2431 E 61ST ST STE 400
TULSA, OK 74136-1237

Completion Type		Location Exception		Increased Density	
X	Single Zone	Order No		Order No	
	Multiple Zone	696701		701484	
	Commingled				

Casing and Cement							
Type	Size	Weight	Grade	Feet	PSI	SAX	Top of CMT
SURFACE	9 5/8	36	J-55	1025		290	SURFACE
PRODUCTION	5 1/2	20	P-110	12089		1270	3962

Liner								
Type	Size	Weight	Grade	Length	PSI	SAX	Top Depth	Bottom Depth
There are no Liner records to display.								

Total Depth: 12114

Packer	
Depth	Brand & Type
There are no Packer records to display.	

Plug	
Depth	Plug Type
There are no Plug records to display.	

Initial Test Data

Test Date	Formation	Oil BBL/Day	Oil-Gravity (API)	Gas MCF/Day	Gas-Oil Ratio Cu FT/BBL	Water BBL/Day	Pumpin or Flowing	Initial Shut-In Pressure	Choke Size	Flow Tubing Pressure
Apr 27, 2019	WOODFORD-MISSISSIPPIAN	12	43	1874	156167	2310	FLOWING	535	F. O.	180

Completion and Test Data by Producing Formation

Formation Name: WOODFORD

Code: 319WDFD

Class: GAS

Spacing Orders

Order No	Unit Size
692258	640
690491	640
701535	MULTIUNIT

Perforated Intervals

From	To
7769	10821

Acid Volumes

NONE

Fracture Treatments

3,904,200 POUNDS SAND, 135,548 BARRELS FRAC FLUID

Formation Name: MISSISSIPPIAN

Code: 359MSSP

Class: GAS

Spacing Orders

Order No	Unit Size
692258	640
690491	640
701535	MULTIUNIT

Perforated Intervals

From	To
10821	11314

Acid Volumes

NONE

Fracture Treatments

585,672 POUNDS SAND, 19,016 BARRELS FRAC FLUID
--

Formation Name: WOODFORD

Code: 319WDFD

Class: GAS

Spacing Orders

Order No	Unit Size
692258	640
690491	640
701535	MULTIUNIT

Perforated Intervals

From	To
11314	11971

Acid Volumes

924 GALLONS 15% HCL

Fracture Treatments

964,286 POUNDS SAND, 29,667 BARRELS FRAC FLUID
--

Formation Name: WOODFORD-MISSISSIPPIAN

Code:

Class: GAS

Formation	Top
MISSISSIPPIAN	7085

Were open hole logs run? No

Date last log run:

WOODFORD	7389
----------	------

Were unusual drilling circumstances encountered? No
Explanation:

Other Remarks
OCC - THIS DOCUMENT IS ACCEPTED BASED ON THE DATA SUBMITTED THE FINAL LOCATION EXCEPTION HAS NOT BEEN ISSUED.

Lateral Holes
Sec: 26 TWP: 3N RGE: 9E County: COAL SE SW NW NW 1200 FNL 644 FWL of 1/4 SEC Depth of Deviation: 6342 Radius of Turn: 1352 Direction: 355 Total Length: 4420 Measured Total Depth: 12114 True Vertical Depth: 7557 End Pt. Location From Release, Unit or Property Line: 644

FOR COMMISSION USE ONLY
<div>Status: Accepted</div> <div>1143675</div>

API NO. 029 21388 X PLEASE TYPE OR USE BLACK INK ONLY
NOTE:
OTC PROD. 029-22581 Attach copy of original 1002A
UNIT NO. 0-0000 if recompletion or reentry.

☒ ORIGINAL
☐ AMENDED (Reason)

OKLAHOMA CORPORATION COMMISSION
Oil & Gas Conservation Division
Post Office Box 52000
Oklahoma City, Oklahoma 73152-2000
Rule 165:10-3-25

RECEIVED

AUG 09 2019

OKLAHOMA CORPORATION COMMISSION

TYPE OF DRILLING OPERATION
☐ STRAIGHT HOLE ☐ DIRECTIONAL HOLE ☒ HORIZONTAL HOLE
☐ SERVICE WELL
If directional or horizontal, see reverse for bottom hole location.

COUNTY Coal SEC 35 TWP 3N RGE 9E
LEASE NAME Big Oak
SE 1/4 SW 1/4 NW 1/4 NW 1/4 1110 FNL OF 1/4 SEC 1110
ELEVATION 748 Ground 723 Latitude (if known) 34.412836 Longitude (if known) -96.200840
OPERATOR NAME Canyon Creek Energy Operating LLC OPERATOR NO. 23443
ADDRESS 2431 E. 61st St Suite 400
CITY Tulsa STATE OK ZIP 74136

SPUD DATE 11/27/2018
DRLG FINISHED DATE 1/8/2019
DATE OF WELL COMPLETION 2/3/2019
1st PROD DATE 2/12/2019
RECOMP DATE
WELL NO. I-35/2641
FEET OF FWL 331

640 Acres
LOCATE WELL

COMPLETION TYPE

☒ SINGLE ZONE
☐ MULTIPLE ZONE
Application Date
COMINGLED
Application Date
LOCATION
EXCEPTION ORDER 696701
INCREASED DENSITY
ORDER NO. 694433 701484
FO

CASING & CEMENT (Form 1002C must be attached)

TYPE	SIZE	WEIGHT	GRADE	FEET	PSI	SAX	TOP OF CMT
CONDUCTOR							
SURFACE	9 5/8"	36#	J55	1025'		290	Surface
INTERMEDIATE							
PRODUCTION	5 1/2"	20#	P110	12,089'		1270	3,962'
LINER							
TOTAL DEPTH							12,114

PACKER @ _____ BRAND & TYPE _____ PLUG @ _____ TYPE _____ PLUG @ _____ TYPE _____
PACKER @ _____ BRAND & TYPE _____ PLUG @ _____ TYPE _____ PLUG @ _____ TYPE _____

COMPLETION & TEST DATA BY PRODUCING FORMATION

FORMATION	Woodford	Mississippian	Woodford	FO	Reported
SPACING & SPACING ORDER NUMBER	640/692258/690491	640/692258/690491	640/692258/690491	701535 (Multiunit)	to Frac Focus
CLASS: Oil, Gas, Dry, Inj, Disp, Comm Disp, Svc	Gas	Gas	Gas		
PERFORATED INTERVALS	7769-10821	10821-11314	11314-11971		
ACID/VOLUME	None	None	924 gals/ 15' HCl		
FRACTURE TREATMENT (Fluids/Prop Amounts)	3,904,200#s Sand	585,672 #s Sand	964,286#s Sand		
	135,548 bbls	19,016 bbls	29,667 bbls		
	Frac Fluid	Frac Fluid	Frac Fluid		

☒ Min Gas Allowable (165:10-17) OR ☐ Min Oil Allowable (165:10-13-3)
Gas Purchaser/Measurer Southwest Energy, LP
First Sales Date 2/12/2019

INITIAL TEST DATA

INITIAL TEST DATE	4/27/2019
OIL-BBL/DAY	12
OIL-GRAVITY (API)	43
GAS-MCF/DAY	1,874
GAS-OIL RATIO CU FT/BBL	156,167
WATER-BBL/DAY	2310
PUMPING OR FLOWING	Flowing
INITIAL SHUT-IN PRESSURE	535
CHOKE SIZE	F.O.
FLOW TUBING PRESSURE	180

AS SUBMITTED

A record of the formations drilled through, and pertinent remarks are presented on the reverse. I declare that I have knowledge of the contents of this report and am authorized by my organization to make this report, which was prepared by me or under my supervision and direction, with the data and facts stated herein to be true, correct, and complete to the best of my knowledge and belief.

C. Daniel Jacobs
SIGNATURE C. Daniel Jacobs
2431 E. 61st ST. SUITE400 TULSA OK 74136
ADDRESS CITY STATE ZIP
8/7/2019 918-561-6737
DATE PHONE NUMBER
djacobs@cceok.com
EMAIL ADDRESS

PLEASE TYPE OR USE BLACK INK ONLY

FORMATION RECORD

Give formation names and tops, if available, or descriptions and thickness of formations drilled through. Show intervals cored or drillstem tested.

NAMES OF FORMATIONS	TOP
Woodford	7389 MD
Mississippian	7085 MD

LEASE NAME Big Oak WELL NO. 1-35/26H

FOR COMMISSION USE ONLY	
ITD on file <input type="checkbox"/> YES <input type="checkbox"/> NO	
APPROVED _____	DISAPPROVED _____
2) Reject Codes	

Were open hole logs run?	yes	<input checked="" type="checkbox"/> no
Date Last log was run	_____	
Was CO ₂ encountered?	yes	<input checked="" type="checkbox"/> no at what depths? _____
Was H ₂ S encountered?	yes	<input checked="" type="checkbox"/> no at what depths? _____
Were unusual drilling circumstances encountered?	yes	<input checked="" type="checkbox"/> no
If yes, briefly explain below		

Other remarks:

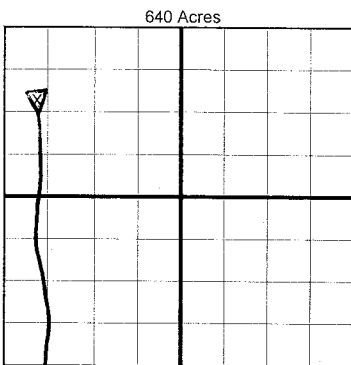

If more than three drainholes are proposed, attach a separate sheet indicating the necessary information.

Direction must be stated in degrees azimuth. Please note, the horizontal drainhole and its end point must be located within the boundaries of the lease or spacing unit.

Directional surveys are required for all drainholes and directional wells.

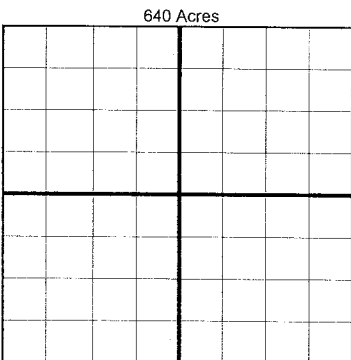

BOTTOM HOLE LOCATION FOR DIRECTIONAL HOLE

SEC	TWP	RGE	COUNTY
Spot Location	1/4	1/4	1/4
Measured Total Depth	True Vertical Depth		BHL From Lease, Unit, or Property Line:

BOTTOM HOLE LOCATION FOR HORIZONTAL HOLE: (LATERALS)

LATERAL #1

SEC	TWP	RGE	COUNTY
26	3N	9E	Coal <u>FNL1200</u>
Spot Location	SE 1/4	SW 1/4	NW 1/4
Depth of Deviation	6,342	Radius of Turn	1352
Measured Total Depth	12,114	True Vertical Depth	7,557
Feet From 1/4 Sec Lines		FSL	FWL
Direction		Total Length	4,420
BHL From Lease, Unit, or Property Line:		<u>1200' FNL 644' FWL</u>	

LATERAL #2

SEC	TWP	RGE	COUNTY
Spot Location	1/4	1/4	1/4
Depth of Deviation	Radius of Turn		Direction
Measured Total Depth	True Vertical Depth		BHL From Lease, Unit, or Property Line:
Feet From 1/4 Sec Lines		FSL	FWL
Total Length			

LATERAL #3

SEC	TWP	RGE	COUNTY
Spot Location	1/4	1/4	1/4
Depth of Deviation	Radius of Turn		Direction
Measured Total Depth	True Vertical Depth		BHL From Lease, Unit, or Property Line:
Feet From 1/4 Sec Lines		FSL	FWL
Total Length			

API NO. 029 21388

OTC PROD. UNIT NO. 029-22582

ORIGINAL AMENDED (Reason) 029-22582

OKLAHOMA CORPORATION COMMISSION
Oil & Gas Conservation Division
Post Office Box 52000
Oklahoma City, Oklahoma 73152-2000
Rule 165:10-3-25

COMPLETION REPORT

RECEIVED

AUG 09 2019

OKLAHOMA CORPORATION COMMISSION

Form 1002A
Rev. 2009

1016EZ

TYPE OF DRILLING OPERATION

STRAIGHT HOLE ☐ DIRECTIONAL HOLE ☐ HORIZONTAL HOLE ☒
SERVICE WELL ☐

If directional or horizontal, see reverse for bottom hole location.

COUNTY	Coal	SEC	35	TWP	3N	RGE	9E
LEASE NAME	Big Oak			WELL NO.	1-35/26	1st PROD DATE	2/12/2019
SE 1/4 SW 1/4 NW 1/4 NW 1/4	FNL OF 1/4 SEC 1110			SEC OF 1/4 SEC	331	RECOMP DATE	
ELEVATION Derrick FL	748	Ground	723	Latitude (if known)	34.412836	Longitude (if known)	-96.200840
OPERATOR NAME	Canyon Creek Energy Operating LLC			OPERATOR NO.	23443		
ADDRESS	2431 E. 61st St Suite 400						
CITY	Tulsa	STATE	OK	ZIP	74136		

COMPLETION TYPE

<input checked="" type="checkbox"/> SINGLE ZONE
<input type="checkbox"/> MULTIPLE ZONE
Application Date
<input type="checkbox"/> COMMINGLED
Application Date
LOCATION
EXCEPTION ORDER
INCREASED DENSITY ORDER NO.

CASING & CEMENT (Form 1002C must be attached)

TYPE	SIZE	WEIGHT	GRADE	FEET	PSI	SAX	TOP OF CMT
CONDUCTOR							
SURFACE	9 5/8"	36#	J55	1025'		290	Surface
INTERMEDIATE							
PRODUCTION	5 1/2"	20#	P110	12,089'		1270	3,962'
LINER							

PACKER @ BRAND & TYPE PLUG @ TYPE PLUG @ TYPE

TOTAL DEPTH 12,114

COMPLETION & TEST DATA BY PRODUCING FORMATION

FORMATION	Woodford	Mississippian	Woodford
SPACING & SPACING ORDER NUMBER	640/692258/690491	640/692258/690491	640/692258/690491
CLASS: Oil, Gas, Dry, Inj, Disp, Comm Disp, Svc	Gas	Gas	Gas
PERFORATED INTERVALS	7769-10821	10821-11314	11314-11971
ACID/VOLUME	None	None	924 gals/15' HCl
FRACTURE TREATMENT (Fluids/Prop Amounts)	3,904,200#'s Sand	585,672 #'s Sand	964,286#'s Sand
	135,548 bbls	19,016 bbls	29,667 bbls
	Frac Fluid	Frac Fluid	Frac Fluid

INITIAL TEST DATA

INITIAL TEST DATE	4/27/2019
OIL-BBL/DAY	12
OIL-GRAVITY (API)	43
GAS-MCF/DAY	1,874
GAS-OIL RATIO CU FT/BBL	156,167
WATER-BBL/DAY	2310
PUMPING OR FLOWING	Flowing
INITIAL SHUT-IN PRESSURE	535
CHOKE SIZE	F.O.
FLOW TUBING PRESSURE	180

AS SUBMITTED

A record of the formations drilled through, and pertinent remarks are presented on the reverse. I declare that I have knowledge of the contents of this report and am authorized by my organization to make this report, which was prepared by me or under my supervision and direction, with the data and facts stated herein to be true, correct, and complete to the best of my knowledge and belief.

C. Daniel Jacobs
SIGNATURE
2431 E. 61st ST. SUITE 400
ADDRESS
TULSA
CITY
OK
STATE
74136
ZIP
8/7/2019
DATE
918-561-6737
PHONE NUMBER
djacobs@cceok.com
EMAIL ADDRESS

SCANNED

E2 E2

20