

Oklahoma Corporation Commission
Oil & Gas Conservation Division
Post Office Box 52000
Oklahoma City, Oklahoma 73152-2000
Rule 165: 10-3-25

Form 1002A

API No.: 35087201820003

Completion Report

Spud Date: June 13, 2014

OTC Prod. Unit No.: 087-214127

Drilling Finished Date: June 23, 2014

1st Prod Date: August 14, 2014

Amended

Completion Date: September 26, 2014

Amend Reason: DRILL OUT CIBP AND COMMINGLE WITH VIOLA

Recomplete Date: May 01, 2019

Drill Type: STRAIGHT HOLE

Min Gas Allowable: Yes

Well Name: MARATHON (MARATHON "A" 1) 1-13

Purchaser/Measurer: ONEOK

Location: MCCLAIN 13 5N 2W
C SE SW NE
330 FSL 990 FWL of 1/4 SEC
Latitude: 34.9069443 Longitude: -97.3586645
Derrick Elevation: 1074 Ground Elevation: 1065

First Sales Date: 08/19/2014

Operator: CHARTER OAK PRODUCTION CO LLC 21672

13929 QUAIL POINTE DR
OKLAHOMA CITY, OK 73134-1037

Completion Type		Location Exception		Increased Density	
	Single Zone	Order No		Order No	
	Multiple Zone	623526		N/A	
X	Commingle				

Casing and Cement							
Type	Size	Weight	Grade	Feet	PSI	SAX	Top of CMT
CONDUCTOR	18			50			SURFACE
SURFACE	10 3/4	32.75		573		350	SURFACE
PRODUCTION	5 1/2	17	N-80	7869		575	6350

Liner								
Type	Size	Weight	Grade	Length	PSI	SAX	Top Depth	Bottom Depth
There are no Liner records to display.								

Total Depth: 7894

Packer	
Depth	Brand & Type
There are no Packer records to display.	

Plug	
Depth	Plug Type
7533	CIBP
7690	CIBP

Initial Test Data

Test Date	Formation	Oil BBL/Day	Oil-Gravity (API)	Gas MCF/Day	Gas-Oil Ratio Cu FT/BBL	Water BBL/Day	Pumpin or Flowing	Initial Shut-In Pressure	Choke Size	Flow Tubing Pressure
Jul 03, 2014	BROMIDE						SWAB	1650	N/A	
Jul 16, 2014	VIOLA						SHUT-IN	2884	N/A	
Jul 22, 2014	HUNTON						SHUT-IN	1113	N/A	
Sep 26, 2014	HUNTON-WOODFORD-PENN BASAL UNCONF SAND	25	51.4	806	32240	55	FLOWING	1500	23/64	300
May 01, 2019	VIOLA-HUNTON-WOODFORD-PENN BASAL UNCONF	6	33.2	147	24500	8	PUMPING	250	N/A	

Completion and Test Data by Producing Formation

Formation Name: BROMIDE

Code: 202BRMD

Class: DRY

Spacing Orders

Order No	Unit Size
132192	80

Perforated Intervals

From	To
7752	7756

Acid Volumes

750 GALLONS 7.5% NEFE

Fracture Treatments

50 BARRELS 2% KCL WATER

Formation Name: VIOLA

Code: 202VIOL

Class: GAS

Spacing Orders

Order No	Unit Size
132192	80

Perforated Intervals

From	To
7282	7519

Acid Volumes

30,000 GALLONS 20% NEFE HCL

Fracture Treatments

8,805 BARRELS SLICK WATER, 101,131 POUNDS 20/40 SAND

Formation Name: HUNTON

Code: 269HNTN

Class: GAS

Spacing Orders

Order No	Unit Size
155035	80

Perforated Intervals

From	To
6818	6866

Acid Volumes

1,500 GALLONS 15% HCL

Fracture Treatments

11,636 BARRELS SLICK WATER, 309,037 POUNDS 20/40 SAND

Formation Name: WOODFORD		Code: 319WDFD	Class: GAS
Spacing Orders		Perforated Intervals	
Order No	Unit Size	From	To
596274	80	6782	6800
Acid Volumes		Fracture Treatments	
There are no Acid Volume records to display.		There are no Fracture Treatments records to display.	

Formation Name: PENN BASAL UNCONF SAND		Code: 401BPUNC	Class: GAS
Spacing Orders		Perforated Intervals	
Order No	Unit Size	From	To
596274	80	6710	6749
Acid Volumes		Fracture Treatments	
There are no Acid Volume records to display.		There are no Fracture Treatments records to display.	

Formation Name: HUNTON-WOODFORD-PENN BASAL UNCONF SAND		Code:	Class: GAS
--	--	-------	------------

Formation Name: VIOLA-HUNTON-WOODFORD-PENN BASAL UNCONF		Code:	Class: GAS
---	--	-------	------------

Formation	Top
BASAL PENN	6658
WOODFORD	6756
HUNTON	6812
SYLVAN	7116
VIOLA	7260
BROMIDE	7714

Were open hole logs run? Yes
Date last log run: January 26, 1971

Were unusual drilling circumstances encountered? No
Explanation:

Other Remarks
SEE ORIGINAL 1002A FOR INITIAL COMPLETION AND TEST DATA BY PRODUCING FORMATION.

FOR COMMISSION USE ONLY	
Status: Accepted	1145524

API NO. 35-087-20182
OTC PROD. UNIT NO. 087-214127PLEASE TYPE OR USE BLACK INK ONLY
NOTE:Attach copy of original 1002A
if recompletion or reentry.OKLAHOMA CORPORATION COMMISSION
Oil & Gas Conservation Division
Post Office Box 52000
Oklahoma City, Oklahoma 73152-2000
Rule 165:10-3-25☐ ORIGINAL
☒ AMENDED (Reason) Drill out CIBP & commingle with Viola

COMPLETION REPORT

TYPE OF DRILLING OPERATION

☒ STRAIGHT HOLE ☐ DIRECTIONAL HOLE ☐ HORIZONTAL HOLE
☐ SERVICE WELL

If directional or horizontal, see reverse for bottom hole location.

COUNTY McClain	SEC 13	TWP 05N	RGE 02W	SPUD DATE 6/13/14
LEASE NAME Marathon	WELL NO. 1-13	DATE OF WELL COMPLETION 9/26/14	1st PROD DATE 8/14/14	
C 1/4 SE 1/4 SW 1/4 NE 1/4	FSL OF 1/4 SEC 330'	FWL OF 1/4 SEC 990'	RECOMP DATE 5/1/19	
ELEVATION N Derrick 1074'	Ground 1065'	Latitude (if known) 34.9069443	Longitude (if known) -97.3586645	
OPERATOR NAME Charter Oak Production Co., LLC			OTC/OCC OPERATOR NO. 21672	
ADDRESS 13929 Quail Pointe Dr.				
CITY Oklahoma City	STATE OK	ZIP 73134		

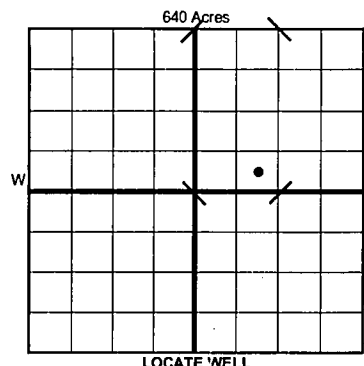

LOCATE WELL

COMPLETION TYPE

☐ SINGLE ZONE
☐ MULTIPLE ZONE
☒ COMMINGLED
 Application Date 5/22/19
 LOCATION 623526
 EXCEPTION ORDER
 INCREASED DENSITY ORDER NO. N/A

CASING & CEMENT (Form 1002C must be attached)

TYPE	SIZE	WEIGHT	GRADE	FEET	PSI	SAX	TOP OF CMT
CONDUCTOR	18"			50'			Surface
SURFACE	10 3/4"	32.75#		573'		350	Surface
INTERMEDIATE							
PRODUCTION	5 1/2"	17#	N-80	7869'		575	6350'
LINER							

 PACKER @ _____ BRAND & TYPE _____ PLUG @ 7533' TYPE CIBP PLUG @ _____ TYPE _____ TOTAL DEPTH 7894'
 PACKER @ _____ BRAND & TYPE _____ PLUG @ 7690 TYPE CIBP PLUG @ _____ TYPE _____

COMPLETION & TEST DATA BY PRODUCING FORMATION - 202 BRAND, 202 VIOLA, 269 HUNTON, 319 WDFD, 401 BPUNC

FORMATION	Bromide	Viola	Hunton	Woodford	Basal Penn	BP, WDFD, HNTN
SPACING & SPACING ORDER NUMBER	80 Ac. - 132192	80 Ac. - 132192	80 Ac. - 155035	80 Ac. - 596274	80 Ac. - 596274	80 Ac. - 155035, 596274
CLASS: Oil, Gas, Dry, Inj, Disp, Comm Disp, Svc	Oil Dry below plug	Oil Gas	Oil Gas	Oil Gas	Oil Gas	Gas
	7752' - 7756'	7282' - 7519' O.A.	6818' - 6866' O.A.	6762' - 6764'	6710' - 6712'	6710' - 6866' O.A.
PERFORATED INTERVALS				6782' - 6784'	6747' - 6749'	
				6798' - 6800'		
ACID/VOLUME	750 Gal 7.5% NeFe	30,000 Gal 20% NeFe HCl	1500 Gal 15% HCl			N/A
	50 BBL 2% KCl water	8805 BBL slick water	11,636 BBL slick water			N/A
FRACTURE TREATMENT (Fluids/Prop Amounts)		101,131# 20/40 sand	309,037# 20/40 sand			

INITIAL TEST DATA

INITIAL TEST DATE	7/3/14	7/16/14	7/22/14	Tested with Hunton	Tested with Hunton	9/26/14
OIL-BBL/DAY	N/A	N/A	N/A			25
OIL-GRAVITY (API)	N/A	N/A	N/A			51.4
GAS-MCF/DAY	N/A	N/A	N/A			806
GAS-OIL RATIO CU FT/BBL	N/A	N/A	N/A			32240
WATER-BBL/DAY	N/A	N/A	N/A			55
PUMPING OR FLOWING	Swab	Shut-in	Shut-in			Flowing
INITIAL SHUT-IN PRESSURE	1650 psi	2884 psi	1113 psi			1500 psi
CHOKE SIZE	N/A	N/A	N/A			23/64"
FLOW TUBING PRESSURE	N/A	N/A	N/A			300 psi

A record of the formations drilled through, and pertinent remarks are presented on the reverse. I declare that I have knowledge of the contents of this report and am authorized by my organization to make this report, which was prepared by me or under my supervision and direction, with the data and facts stated herein to be true, correct, and complete to the best of my knowledge and belief.

 Signature: *JC Brevetti* NAME (PRINT OR TYPE) JC Brevetti, Engineering Tech. DATE 5/22/19 PHONE NUMBER (405) 286-0361
 ADDRESS 13929 Quail Pointe Dr. CITY Oklahoma City STATE OK ZIP 73134 EMAIL ADDRESS brevetti@charteroakproduction.com
see 2nd
Page
New
Test

API NO. 35-087-20182
OTC PROD UNIT NO. 087-214127

PLEASE TYPE OR USE BLACK INK ONLY
NOTE:

Attach copy of original 1002A if recompletion or reentry.

OKLAHOMA CORPORATION COMMISSION
Oil & Gas Conservation Division
Post Office Box 52000
Oklahoma City, Oklahoma 73152-2000
Rule 165:10-3-25

☐ ORIGINAL
☒ AMENDED (Reason) Drill out CIBP & commingle with Viola

COMPLETION REPORT

TYPE OF DRILLING OPERATION
☒ STRAIGHT HOLE ☐ DIRECTIONAL HOLE ☐ HORIZONTAL HOLE
☐ SERVICE WELL

If directional or horizontal, see reverse for bottom hole location.

COUNTY McClain	SEC 13	TWP 05N	RGE 02W	SPUD DATE 6/13/14
LEASE NAME Marathon	WELL NO. 1-13	DATE OF WELL COMPLETION 9/26/14	DRLG FINISHED DATE 6/23/14	
C 1/4 SE 1/4 SW 1/4 NE 1/4	FSL OF 1/4 SEC 330'	FWL OF 1/4 SEC 990'	RECOMP DATE 5/1/19	
ELEVATION 1074' N Derrick	Ground 1065'	Latitude (if known) 34.9069443	Longitude (if known) -97.3586645	
OPERATOR NAME Charter Oak Production Co., LLC		OTC/OCC OPERATOR NO. 21672		
ADDRESS 13929 Quail Pointe Dr.				
CITY Oklahoma City		STATE OK	ZIP 73134	

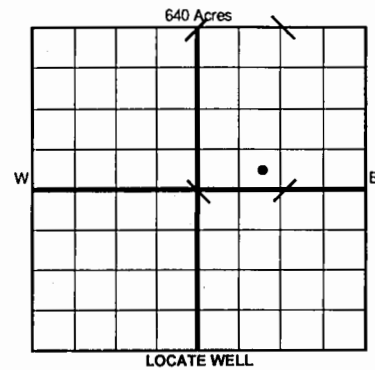

COMPLETION TYPE

<input type="checkbox"/> SINGLE ZONE
<input type="checkbox"/> MULTIPLE ZONE
Application Date
<input checked="" type="checkbox"/> COMMINGLED
Application Date 5/22/19
LOCATION 623526
EXCEPTION ORDER
INCREASED DENSITY ORDER NO. N/A

CASING & CEMENT (Form 1002C must be attached)							
TYPE	SIZE	WEIGHT	GRADE	FEET	PSI	SAX	TOP OF CMT
CONDUCTOR	18"			50'			Surface
SURFACE	10 3/4"	32.75#		573'		350	Surface
INTERMEDIATE							
PRODUCTION	5 1/2"	17#	N-80	7869'		575	6350'
LINER							
TOTAL DEPTH						7894'	

PACKER @ _____ BRAND & TYPE _____ PLUG @ 7533' TYPE CIBP PLUG @ _____ TYPE _____
PACKER @ _____ BRAND & TYPE _____ PLUG @ 7690' TYPE CIBP PLUG @ _____ TYPE _____

COMPLETION & TEST DATA BY PRODUCING FORMATION

FORMATION	BP, WDFD, HNTN, VIOL						
SPACING & SPACING ORDER NUMBER	80 Ac. - 132192, 155035, 596274						
CLASS: Oil, Gas, Dry, Inj, Disp, Comm Disp, Svc	Gas						
PERFORATED INTERVALS	6710' - 7519' O.A.						
ACID/VOLUME	N/A						
FRACTURE TREATMENT (Fluids/Prop Amounts)	N/A						

☐ Min Gas Allowable (165:10-17-7) OR Gas Purchaser/Measurer OneOK
Oil Allowable (165:10-13-3) First Sales Date 8/19/14

INITIAL TEST DATA

INITIAL TEST DATE	5/1/19						
OIL-BBL/DAY	6						
OIL-GRAVITY (API)	33.2						
GAS-MCF/DAY	147						
GAS-OIL RATIO CU FT/BBL	24500						
WATER-BBL/DAY	8						
PUMPING OR FLOWING	Pumping						
INITIAL SHUT-IN PRESSURE	250 psi						
CHOKE SIZE	N/A						
FLOW TUBING PRESSURE	N/A						

A record of the formations drilled through, and pertinent remarks are presented on the reverse. I declare that I have knowledge of the contents of this report and am authorized by my organization to make this report, which was prepared by me or under my supervision and direction, with the data and facts stated herein to be true, correct, and complete to the best of my knowledge and belief.

Joseph M. Brevetti
SIGNATURE NAME (PRINT OR TYPE) DATE 5/22/19 PHONE NUMBER (405) 286-0361
13929 Quail Pointe Dr. Oklahoma City OK 73134 brevetti@charteroakproduction.com
ADDRESS CITY STATE ZIP EMAIL ADDRESS

PLEASE TYPE OR USE BLACK INK ONLY

FORMATION RECORD

Give formation names and tops, if available, or descriptions and thickness of formations drilled through. Show intervals cored or drillstem tested.

LEASE NAME Marathon

WELL NO. 1-13

NAMES OF FORMATIONS	TOP
Basal Penn	6658'
Woodford	6756'
Hunton	6812'
Sylvan	7116'
Viola	7260'
Bromide	7714'

FOR COMMISSION USE ONLY

ITD on file ☐ YES ☐ NO

APPROVED _____ DISAPPROVED _____

2) Reject Codes _____

Were open hole logs run? ☒ yes ☐ no

Date Last log was run January 26, 1971

Was CO₂ encountered? ☐ yes ☒ no at what depths? _____

Was H₂S encountered? ☐ yes ☒ no at what depths? _____

Were unusual drilling circumstances encountered? ☐ yes ☒ no

If yes, briefly explain below _____

Other remarks: See original 1002A for initial completion & test data by producing formation.

640 Acres

If more than three drainholes are proposed, attach a separate sheet indicating the necessary information.

Direction must be stated in degrees azimuth. Please note, the horizontal drainhole and its end point must be located within the boundaries of the lease or spacing unit.

Directional surveys are required for all drainholes and directional wells.

640 Acres

BOTTOM HOLE LOCATION FOR DIRECTIONAL HOLE

SEC	TWP	RGE	COUNTY
Spot Location			
1/4	1/4	1/4	1/4
Measured Total Depth		True Vertical Depth	BHL From Lease, Unit, or Property Line:

BOTTOM HOLE LOCATION FOR HORIZONTAL HOLE: (LATERALS)

LATERAL #1

SEC	TWP	RGE	COUNTY
Spot Location			
1/4	1/4	1/4	1/4
Depth of Deviation		Radius of Turn	Direction
Measured Total Depth		True Vertical Depth	BHL From Lease, Unit, or Property Line:

LATERAL #2

SEC	TWP	RGE	COUNTY
Spot Location			
1/4	1/4	1/4	1/4
Depth of Deviation		Radius of Turn	Direction
Measured Total Depth		True Vertical Depth	BHL From Lease, Unit, or Property Line:

LATERAL #3

SEC	TWP	RGE	COUNTY
Spot Location			
1/4	1/4	1/4	1/4
Depth of Deviation		Radius of Turn	Direction
Measured Total Depth		True Vertical Depth	BHL From Lease, Unit, or Property Line:

11/1/14
01
AS SUBMITTED

RECEIVED

Form 1002A
Rev. 2009

OCT 31 2014

1016EZ

OKLAHOMA CORPORATION
COMMISSION

API NO. 35-087-20182
OTC PROD. UNIT NO. 087-214127

PLEASE TYPE OR USE BLOCK LETTERS
NOTE:

Attach copy of original
if recompletion or reentry.

Oklahoma City, Oklahoma 73152-2000

Rule 165-10-3-25

☒ ORIGINAL
☐ AMENDED (Reason)

Re-entry

COMPLETION REPORT

TYPE OF DRILLING OPERATION

☒ STRAIGHT HOLE ☐ DIRECTIONAL HOLE ☐ HORIZONTAL HOLE
☐ SERVICE WELL

If directional or horizontal, see reverse for bottom hole location.

COUNTY	McClain	SEC	13	TWP	05N	RGE	02W	
LEASE NAME	Marathon			WELL NO.	1-13			
C	1/4	SE	1/4	SW	1/4	NE	1/4	
FSL OF 1/4 SEC	330'			FWL OF 1/4 SEC	990'			
ELEVATION N Derrick	1074'			Ground	1065'			
Latitude (if known)	34.9069443			Longitude (if known)	-97.3586645			
OPERATOR NAME	Charter Oak Production Co., LLC			OTC/OCC OPERATOR NO.	21672			
ADDRESS	13929 Quail Pointe Dr.							
CITY	Oklahoma City			STATE	OK		ZIP	73134

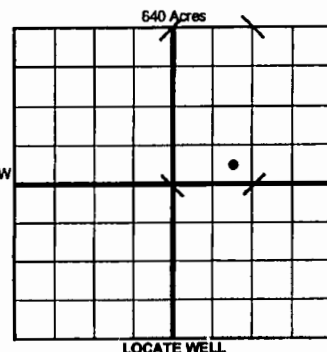

COMPLETION TYPE

<input type="checkbox"/> SINGLE ZONE
<input type="checkbox"/> MULTIPLE ZONE
Application Date
<input checked="" type="checkbox"/> COMMINGLED
Application Date
LOCATION
EXCEPTION ORDER
INCREASED DENSITY ORDER NO.

CASING & CEMENT (Form 1002C must be attached)

TYPE	SIZE	WEIGHT	GRADE	FEET	PSI	SAX	TOP OF CMT
CONDUCTOR	18"			50'			Surface
SURFACE	10 3/4"	32.75#		573'		350	Surface
INTERMEDIATE							
PRODUCTION	5 1/2"	17#	N-80	7869'		575	6350'
LINER							

PACKER @ 6550' BRAND & TYPE ASI-X PLUG @ 7250' TYPE CIBP PLUG @ TYPE
PACKER @ BRAND & TYPE PLUG @ TYPE PLUG @ TYPE

COMPLETION & TEST DATA BY PRODUCING FORMATION: 202 BRND 202 VIOL 216 HNTN 316 WDFD 000 VARS

FORMATION	Bromide	Viola	Hunton	Woodford	Basal Penn.	BP, WDFD, HNTN
SPACING & SPACING ORDER NUMBER	80 Ac. - 132192	80 Ac. - 132192	80 Ac. - 155035	80 Ac. - 596274	80 Ac. - 596274	80 Ac. - 155035, 596274
CLASS: Oil, Gas, Dry, Inj, Disp, Comm Disp, Svc	Oil	Oil	Oil	Oil	Oil	Gas
PERFORATED INTERVALS	7752' - 7756'	7282' - 7519' O.A.	6818' - 6866' O.A.	6762' - 6764'	6710' - 6712'	6710' - 6866' O.A.
		See attached schematic	See attached schematic	6782' - 6784'	6747' - 6749'	See attached schematic
				6798' - 6800'		
ACID/VOLUME	750 Gal 7.5% NeFe	30,000 Gal 20% NeFe HCl	1500 Gal 15% HCl	Treated with Hunton	Treated with Hunton	N/A
	50 BBL 2% KCl water	8805 BBL slick water	11,636 BBL slick water			N/A
FRACTURE TREATMENT (Fluids/Prop Amounts)		101,131# 20/40 sand	309,037# 20/40 sand			

Min Gas Allowable (165:10-17.7)
OR
Oil Allowable (165:10-13.3)

Gas Purchaser/Measurer
First Sale Date

OneOK
8/19/14

INITIAL TEST DATA

INITIAL TEST DATE	7/3/14	7/16/14	7/22/14	Tested with Hunton	Tested with Hunton	9/26/14
OIL-BBL/DAY	N/A	N/A	N/A			25
OIL-GRAVITY (API)	N/A	N/A	N/A			51.4
GAS-MCF/DAY	N/A	N/A	N/A			806
GAS-OIL RATIO CU FT/BBL	N/A	N/A	N/A			32240
WATER-BBL/DAY	N/A	N/A	N/A			55
PUMPING OR FLOWING	Swab	Shut-in	Shut-in			Flowing
INITIAL SHUT-IN PRESSURE	1650 psi	2884 psi	1113 psi			1500 psi
CHOKE SIZE	N/A	N/A	N/A			23/64"
FLOW TUBING PRESSURE	N/A	N/A	N/A			300 psi

A record of the formations drilled through, and pertinent remarks are presented on the reverse. I declare that I have knowledge of the contents of this report and am authorized by my organization to make this report, which was prepared by me or under my supervision and direction, with the data and facts stated herein to be true, correct, and complete to the best of my knowledge and belief.

SIGNATURE	NAME (PRINT OR TYPE)	DATE	PHONE NUMBER
<i>Joseph C. Brevetti</i>	JC Brevetti, Engineering Tech.	10/24/14	(405) 286-0361
13929 Quail Pointe Dr.	Oklahoma City OK 73134	brevetti@charteroakproduction.com	
ADDRESS	CITY STATE ZIP	EMAIL ADDRESS	

320AES
Basal Penn
Hunton
Woodford

BR

SCANNED

Give formation names and tops, if available, or descriptions and thickness of formations drilled through. Show intervals cored or drillstem tested.

WELL NO. 1-13

NAMES OF FORMATIONS	TOP
Basal Penn	6658'
Woodford	6756'
Hunton	6812'
Sylvan	7116'
Viola	7260'
Bromide	7714'

FOR COMMISSION USE ONLY	
ITD on file	<input type="checkbox"/> YES <input type="checkbox"/> NO
APPROVED	DISAPPROVED
	2) Reject Codes

Were open hole logs run? ☒ yes ☐ no

Date Last log was run January 26, 1971

Was CO₂ encountered? ☐ yes ☒ no at what depths? _____

Was H₂S encountered? ☐ yes ☒ no at what depths? _____

Were unusual drilling circumstances encountered? ☐ yes ☒ no

If yes, briefly explain below _____

Other remarks:

640 Acres

If more than three drainholes are proposed, attach a separate sheet indicating the necessary information.

Direction must be stated in degrees azimuth.
Please note, the horizontal drainhole and its end
point must be located within the boundaries of the
lease or spacing unit.

Directional surveys are required for all drainholes and directional wells.

640 Acres

A 10x10 grid representing 640 acres. A thick vertical line is drawn between the 4th and 5th columns, and a thick horizontal line is drawn between the 4th and 5th rows. This divides the grid into four quadrants of 160 acres each (4 columns x 4 rows).

BOTTOM HOLE LOCATION FOR DIRECTIONAL HOLE

SEC	TWP	RGE	COUNTY
Spot Location			
1/4	1/4	1/4	1/4
Measured Total Depth		True Vertical Depth	BHL From Lease, Unit, or Property Line:

BOTTOM HOLE LOCATION FOR HORIZONTAL HOLE: (LATERALS)

LATERAL #1

SEC	TWP	RGE	COUNTY
Spot Location		Feet From 1/4 Sec Lines	FSL
1/4	1/4	1/4	1/4
Depth of Deviation	Radius of Turn	Direction	Total Length
Measured Total Depth	True Vertical Depth	BHL From Lease, Unit, or Property Line:	

LATERAL #2

SEC	TWP	RGE	COUNTY
Spot Location			
1/4	1/4	1/4	1/4
Depth of Deviation		Radius of Turn	Direction
Measured Total Depth		True Vertical Depth	Total Length
BHL From Lease, Unit, or Property Line:			

LATERAL #3

SEC	TWP	RGE	COUNTY
Spot Location			
1/4	1/4	1/4	1/4
Feet From 1/4 Sec Lines		FSL	FWL
Depth of Deviation	Radius of Turn	Direction	Total Length
Measured Total Depth	True Vertical Depth	BHL From Lease, Unit, or Property Line:	

Bob Anthony
Commissioner

Todd Hiatt
Commissioner

Dana Murphy
Commissioner

Oklahoma Corporation Commission

Oil & Gas Conservation Division
P.O. Box 52000
Oklahoma City, Oklahoma 73152-2000



Room 208 Jim Thorpe Building
Telephone: 405-521-2279
Fax: 405-522-0854

June 04, 2019

Operator: 21672
CHARTER OAK PRODUCTION CO LLC
13929 QUAIL POINTE DR
OKLAHOMA CITY, OK 73134-1037

Re: Well Name: MARATHON (MARATHON "A" 1)
Well No: 1-13
API No: 35087201820003
Legal: 13-5N-2W C SE SW NE
County: MCCLAIN

Dear Sir or Madam:

We are returning the form 1002-A (Completion Report) and/or 1002-C (Cementing Report) on the above captioned well for correction as listed below.

THE OPERATOR MUST SHOW EACH COMMON SOURCE OF SUPPLY PRODUCING IN ITS OWN COLUMN. THERE ARE 6 COLUMNS FOR INDIVIDUAL COMMON SOURCES OF SUPPLY, IF MORE COLUMNS NEEDED USE AN ADDITIONAL 1002A. ALL INFORMATION FOR EACH COMMON SOURCE OF SUPPLY NEEDS TO BE COMPLETE. THIS IS A STAND ALONE DOCUMENT, REFERENCING EARLIER DOCUMENTS IS NOT ALLOWED. ANY QUESTIONS CONTACT DENNIS NISKERN AT 405-522-2977.

Please make the requested correction(s) or addition(s) and resubmit the corrected form(s) with a copy of this letter to our office within fifteen (15) days.

Sincerely,

Technical Department

API NO. 35-087-20182
OTC PROD UNIT NO. 087-214127

PLEASE TYPE OR USE BLACK INK ONLY
NOTE:

Attach copy of original 1002A
if recompletion or reentry.

OKLAHOMA CORPORATION COMMISSION
Oil & Gas Conservation Division
Post Office Box 52000
Oklahoma City, Oklahoma 73152-2000
Rule 165:10-3-25

Form 1002A
Rev. 2009

**1002A
Addendum**

☐ ORIGINAL
☒ AMENDED (Reason)

Drill out CIBP & commingle with Viola

COMPLETION REPORT

TYPE OF DRILLING OPERATION

☒ STRAIGHT HOLE ☐ DIRECTIONAL HOLE ☐ HORIZONTAL HOLE
☐ SERVICE WELL

If directional or horizontal, see reverse for bottom hole location.

COUNTY	McClain	SEC	13	TWP	05N	RGE	02W	SPUD DATE	6/13/14
LEASE NAME	Marathon	WELL NO.	1-13	DRLG FINISHED DATE	6/23/14	DATE OF WELL COMPLETION	9/26/14	1st PROD DATE	8/14/14
C	1/4	SE	1/4	SW	1/4	NE	1/4	FSL OF 1/4 SEC	330'
								FWL OF 1/4 SEC	990'
ELEVATION	1074'	Ground	1065'	Latitude (if known)	34.9069443	Longitude (if known)	-97.3586645	RECOMP DATE	5/1/19
OPERATOR NAME	Charter Oak Production Co., LLC							OTC/OCC OPERATOR NO.	21672
ADDRESS	13929 Quail Pointe Dr.								
CITY	Oklahoma City	STATE	OK	ZIP	73134				

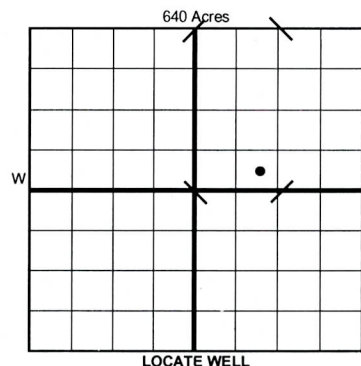

COMPLETION TYPE

<input type="checkbox"/> SINGLE ZONE
<input type="checkbox"/> MULTIPLE ZONE
Application Date
<input checked="" type="checkbox"/> COMMINGLED
Application Date
LOCATION
EXCEPTION ORDER
INCREASED DENSITY ORDER NO.

CASING & CEMENT (Form 1002C must be attached)

TYPE	SIZE	WEIGHT	GRADE	FEET	PSI	SAX	TOP OF CMT
CONDUCTOR	18"			50'			Surface
SURFACE	10 3/4"	32.75#		573'		350	Surface
INTERMEDIATE							
PRODUCTION	5 1/2"	17#	N-80	7869'		575	6350'
LINER							
TOTAL DEPTH							7894'

PACKER @ _____ BRAND & TYPE _____ PLUG @ 7533' TYPE CIBP PLUG @ _____ TYPE _____
PACKER @ _____ BRAND & TYPE _____ PLUG @ 7690' TYPE CIBP PLUG @ _____ TYPE _____

COMPLETION & TEST DATA BY PRODUCING FORMATION

FORMATION	BP, WDFD, HNTN, VIOL						
SPACING & SPACING ORDER NUMBER	80 Ac. - 132192, 155035, 596274						
CLASS: Oil, Gas, Dry, Inj, Disp, Comm Disp, Svc	Gas						
PERFORATED INTERVALS	6710' - 7519' O.A.						
ACID/VOLUME	N/A						
FRACTURE TREATMENT (Fluids/Prop Amounts)	N/A						



Min Gas Allowable (165:10-17-7)
OR
Oil Allowable (165:10-13-3)

Gas Purchaser/Measurer
First Sales Date
OneOK
8/19/14

INITIAL TEST DATA

INITIAL TEST DATE	5/1/19					
OIL-BBL/DAY	6					
OIL-GRAVITY (API)	33.2					
GAS-MCF/DAY	147					
GAS-OIL RATIO CU FT/BBL	24500					
WATER-BBL/DAY	8					
PUMPING OR FLOWING	Pumping					
INITIAL SHUT-IN PRESSURE	250 psi					
CHOKE SIZE	N/A					
FLOW TUBING PRESSURE	N/A					

A record of the formations drilled through, and pertinent remarks are presented on the reverse. I declare that I have knowledge of the contents of this report and am authorized by my organization to make this report, which was prepared by me or under my supervision and direction, with the data and facts stated herein to be true, correct, and complete to the best of my knowledge and belief.

Joseph M. Brevetti
SIGNATURE
13929 Quail Pointe Dr.
ADDRESS
Oklahoma City
CITY
OK
STATE
73134
ZIP
5/22/19
DATE
(405) 286-0361
PHONE NUMBER
brevetti@charteroakproduction.com
EMAIL ADDRESS