

Oklahoma Corporation Commission
Oil & Gas Conservation Division
Post Office Box 52000
Oklahoma City, Oklahoma 73152-2000
Rule 165: 10-3-25

Form 1002A

API No.: 35087222100000

Completion Report

Spud Date: February 26, 2019

OTC Prod. Unit No.:

Drilling Finished Date: March 09, 2019

1st Prod Date:

Completion Date: March 09, 2019

Drill Type: STRAIGHT HOLE

Well Name: IVEY 1-29

Purchaser/Measurer:

Location: MCCLAIN 29 5N 2W
C NE NW NW
2310 FSL 990 FWL of 1/4 SEC
Latitude: 35.11053 Longitude: -97.418017
Derrick Elevation: 0 Ground Elevation: 990

First Sales Date:

Operator: OKLAND OIL COMPANY 7910

110 N ROBINSON AVE STE 400
OKLAHOMA CITY, OK 73102-9022

Completion Type		Location Exception		Increased Density	
	Single Zone		Order No		Order No
	Multiple Zone	There are no Location Exception records to display.		There are no Increased Density records to display.	
	Commingled				

Casing and Cement							
Type	Size	Weight	Grade	Feet	PSI	SAX	Top of CMT
CONDUCTOR	16			80		230	SURFACE
SURFACE	9 5/8	36	J-55	370	1000	130	SURFACE

Liner								
Type	Size	Weight	Grade	Length	PSI	SAX	Top Depth	Bottom Depth
There are no Liner records to display.								

Total Depth: 7220

Packer		Plug	
Depth	Brand & Type	Depth	Plug Type
There are no Packer records to display.		There are no Plug records to display.	

Initial Test Data										
Test Date	Formation	Oil BBL/Day	Oil-Gravity (API)	Gas MCF/Day	Gas-Oil Ratio Cu FT/BBL	Water BBL/Day	Pumpin or Flowing	Initial Shut-In Pressure	Choke Size	Flow Tubing Pressure
There are no Initial Data records to display.										

Completion and Test Data by Producing Formation

Formation Name: NONE

Code:

Class: DRY

Formation	Top
GIBSON	6872
HART	7046
HUNTON	7072

Were open hole logs run? Yes

Date last log run: March 07, 2019

Were unusual drilling circumstances encountered? No

Explanation:

Other Remarks

WELL PLUGGED.

FOR COMMISSION USE ONLY

1142450

Status: Accepted

PLEASE TYPE OR USE BLACK INK ONLY

FORMATION RECORD

Give formation names and tops, if available, or descriptions and thickness of formations drilled through. Show intervals cored or drillstem tested.

LEASE NAME

IVEY

WELL NO. #1-29

NAMES OF FORMATIONS

TOP

GIBSON

6,872

HART

7,046

HUNTON

7072

FOR COMMISSION USE ONLY

ITD on file ☐ YES ☐ NO

APPROVED DISAPPROVED

2) Reject Codes

Were open hole logs run?

☒ yes ☐ no

Date Last log was run

3/7/2019

Was CO₂ encountered?

☐ yes ☒ no at what depths?

Was H₂S encountered?

☐ yes ☒ no at what depths?

Were unusual drilling circumstances encountered?

☐ yes ☒ no

If yes, briefly explain below

Other remarks:

WELL PLUGGED.

BOTTOM HOLE LOCATION FOR DIRECTIONAL HOLE

SEC	TWP	RGE	COUNTY
Spot Location			
1/4	1/4	1/4	1/4
Measured Total Depth		True Vertical Depth	Feet From 1/4 Sec Lines FSL FWL
BHL From Lease, Unit, or Property Line:			

BOTTOM HOLE LOCATION FOR HORIZONTAL HOLE: (LATERALS)

LATERAL #1			
SEC	TWP	RGE	COUNTY
Spot Location			
1/4	1/4	1/4	1/4
Depth of Deviation		Radius of Turn	Direction
Measured Total Depth		True Vertical Depth	Total Length
BHL From Lease, Unit, or Property Line:			

LATERAL #2			
SEC	TWP	RGE	COUNTY
Spot Location			
1/4	1/4	1/4	1/4
Depth of Deviation		Radius of Turn	Direction
Measured Total Depth		True Vertical Depth	Total Length
BHL From Lease, Unit, or Property Line:			

LATERAL #3			
SEC	TWP	RGE	COUNTY
Spot Location			
1/4	1/4	1/4	1/4
Depth of Deviation		Radius of Turn	Direction
Measured Total Depth		True Vertical Depth	Total Length
BHL From Lease, Unit, or Property Line:			

640 Acres

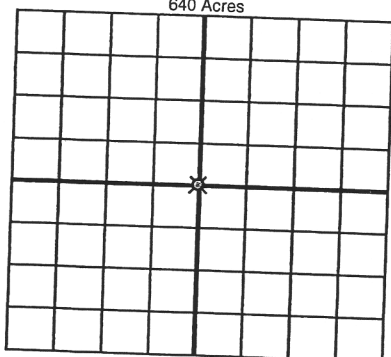

If more than three drainholes are proposed, attach a separate sheet indicating the necessary information.

Direction must be stated in degrees azimuth. Please note, the horizontal drainhole and its end point must be located within the boundaries of the lease or spacing unit.

Directional surveys are required for all drainholes and directional wells.

640 Acres

