

Oklahoma Corporation Commission  
Oil & Gas Conservation Division  
Post Office Box 52000  
Oklahoma City, Oklahoma 73152-2000  
Rule 165: 10-3-25

Form 1002A

API No.: 35053227950003

**Completion Report**

Spud Date: January 21, 2011

OTC Prod. Unit No.:

Drilling Finished Date: February 02, 2011

**Amended**

1st Prod Date:

Amend Reason: RECOMPLETION TO INJECTION

Completion Date: February 21, 2011

Recomplete Date: May 05, 2022

**Drill Type: SERVICE WELL**

**SERVICE WELL**

Well Name: LYNCH SWD 1-10

Purchaser/Measurer:

Location: GRANT 10 26N 6W  
NE SE SE SE  
450 FSL 250 FEL of 1/4 SEC  
Latitude: 36.7397222 Longitude: -97.822633  
Derrick Elevation: 1092 Ground Elevation: 1077

First Sales Date:

Operator: SANDRIDGE EXPLORATION & PRODUCTION LLC 22281

1 E SHERIDAN AVE #500  
OKLAHOMA CITY, OK 73104-2496

Completion Type		Location Exception		Increased Density	
X	Single Zone	Order No		Order No	
	Multiple Zone	There are no Location Exception records to display.		There are no Increased Density records to display.	
	Commingled				

Casing and Cement							
Type	Size	Weight	Grade	Feet	PSI	SAX	Top of CMT
CONDUCTOR	20	94#	K-55	60		5	SURFACE
SURFACE	9 5/8	36#	J-55	1008		440	SURFACE
PRODUCTION	7	26	J-55	6251		575	3800

Liner								
Type	Size	Weight	Grade	Length	PSI	SAX	Top Depth	Bottom Depth
There are no Liner records to display.								

**Total Depth: 7445**

Packer		Plug	
Depth	Brand & Type	Depth	Plug Type
4047	AS-1X	6220	CIBP

Initial Test Data
-------------------

Test Date	Formation	Oil BBL/Day	Oil-Gravity (API)	Gas MCF/Day	Gas-Oil Ratio Cu FT/BBL	Water BBL/Day	Pumpin or Flowing	Initial Shut- In Pressure	Choke Size	Flow Tubing Pressure
-----------	-----------	----------------	----------------------	----------------	----------------------------	------------------	----------------------	---------------------------------	---------------	-------------------------

There are no Initial Data records to display.

Completion and Test Data by Producing Formation

Formation Name: COTTAGE GROVE                      Code: 405CGGV                      Class: INJ

Spacing Orders		Perforated Intervals	
Order No	Unit Size	From	To
NONE		4340	4372
Acid Volumes		Fracture Treatments	
2,500 GALLONS 20% HCL		NONE	

Formation Name: TONKAWA                      Code: 406TNKW                      Class: INJ

Spacing Orders		Perforated Intervals	
Order No	Unit Size	From	To
NONE		4060	4080
		4090	4102
Acid Volumes		Fracture Treatments	
2,500 GALLONS 20% HCL		NONE	

Formation	Top
TONKAWA	3820
COTTAGE GROVE	4295

Were open hole logs run? Yes  
Date last log run: January 28, 2011  
  
Were unusual drilling circumstances encountered? No  
Explanation:

Other Remarks
UIC APPLICATION NUMBER: 2200400501. ADDED PERFORATIONS TO TONKAWA AND COTTAGE GROVE FORMATIONS

FOR COMMISSION USE ONLY	
Status: Accepted	1148148

053-22795-03

RECEIVED

API NO.	35-053227950000
OTC PROD. UNIT NO.	

Oil and Gas Conservation Division  
P.O. Box 52000  
Oklahoma City, OK 73152-2000  
405-521-2331  
OCCCentralProcessing@OCC.OK.GOV



**OKLAHOMA**  
Corporation  
Commission

MAY 11 2022

Form 1002A  
Rev. 2021OKLAHOMA CORPORATION  
COMMISSION

☒ ORIGINAL  
☒ AMENDED (Reason) Recomplete to Injection

Rule 165:10-3-25

COMPLETION REPORT

## TYPE OF DRILLING OPERATION

☒ STRAIGHT HOLE ☐ DIRECTIONAL HOLE ☐ HORIZONTAL HOLE  
☒ SERVICE WELL

If directional or horizontal, see reverse for bottom hole location.

COUNTY	Grant	SEC	10	TWP	26N	RGE	6W
LEASE NAME	Lynch SWD 1-10			WELL NO.			
NE 1/4 SE 1/4 SE 1/4 SE 1/4	FSL	450	FEL	250	RECOMP DATE	5/5/2022	
ELEVATION	1092	Ground	1077	Latitude	36.7397222222222		
Operator Name	Sandridge Exploration and Production LLC			OTC / OCC OPERATOR NO.	22281		
ADDRESS	1 E Sheridan Ave, Suite 500						
CITY	Oklahoma City	STATE	OK	ZIP	73104		

SPUD DATE 1/21/2011

DRLG FINISHED DATE 2/2/2011

DATE OF WELL COMPLETION 2/21/2011

1st PROD DATE

RECOMP DATE 5/5/2022

Longitude -97.8228333333333

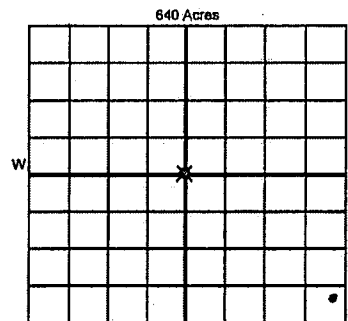

## COMPLETION TYPE

<input checked="" type="radio"/> SINGLE ZONE	
<input type="radio"/> MULTIPLE ZONE	
<input type="radio"/> Application Date	
<input type="radio"/> COMMINGLED	
<input type="radio"/> Application Date	
LOCATION EXCEPTION ORDER NO.	
MULTIUNIT ORDER NO.	
INCREASED DENSITY ORDER NO.	

## CASING &amp; CEMENT (Attach Form 1002C)

TYPE	SIZE	WEIGHT	GRADE	FEET	PSI	SAX	TOP OF CMT
CONDUCTOR	20	94#	K-55	60		5	Surface
SURFACE	9-5/8	36#	J-55	1008		440	Surface
INTERMEDIATE	7	26#	J-55	6251		575	3800
PRODUCTION							
LINER							

PACKER @ 4047 BRAND & TYPE AS-1X PLUG @ 6220 TYPE CIBP PLUG @ TYPE TOTAL DEPTH 7445

## COMPLETION &amp; TEST DATA BY PRODUCING FORMATION

FORMATION	Cottage Grove	Tonkawa				
SPACING & SPACING ORDER NUMBER	No Spacing Order Records	No Spacing Order Records				No Frac
CLASS: Oil, Gas, Dry, Inj, Disp, Comm Disp, Svc	Inj	Inj				
PERFORATED INTERVALS	4340' - 4372'	4060' - 4080'				
		4090' - 4102'				
ACID/VOLUME	2500 Gal 20% HCL	2500 (Treated w/ Cottage Grove Form)				
FRACTURE TREATMENT (Fluids/Prop Amounts)	No fracture treatment records to display	No fracture treatment records to display				

Min Gas Allowable (165:10-17-7)

Purchaser/Measurer



OR

First Sales Date

Oil Allowable (165:10-13-3)

## INITIAL TEST DATA

INITIAL TEST DATE						
OIL-BBL/DAY						
OIL-GRAVITY (API)						
GAS-MCF/DAY						
GAS-OIL RATIO CU FT/BBL						
WATER-BBL/DAY						
PUMPING OR FLOWING						
INITIAL SHUT-IN PRESSURE						
CHOKE SIZE						
FLOW TUBING PRESSURE						

A record of the formations drilled through, and pertinent remarks are presented on the reverse. I declare that I have knowledge of the contents of this report and am authorized by my organization to make this report, which was prepared by me or under my supervision and direction, with the data and facts stated herein to be true, correct, and complete to the best of my knowledge and belief.

<u>Andrew Bormann</u> SIGNATURE	Andrew Bormann NAME (PRINT OR TYPE)	5/9/2022 DATE	405-664-0755 PHONE NUMBER
1 E Sheridan Ave, Suite 500 ADDRESS	Oklahoma City OK 73104 CITY STATE ZIP	abormann@sandridgeenergy.com EMAIL ADDRESS	

PLEASE TYPE OR USE BLACK INK ONLY  
FORMATION RECORD

Give formation names and tops, if available, or descriptions and thickness of formations drilled through. Show intervals cored or drillstem tested.

NAMES OF FORMATIONS	TOP
Tonkawa	3820
Cottage Grove	4295

LEASE NAME Lynch SWD

WELL NO. 1-10

FOR COMMISSION USE ONLY	
ITD on file <input type="checkbox"/> YES <input type="checkbox"/> NO	
APPROVED _____	DISAPPROVED _____
2) Reject Codes	
_____	
_____	
_____	
_____	

Were open hole logs run?	<input checked="" type="radio"/> yes <input type="radio"/> no
Date Last log was run	January 28, 2011
Was CO <sub>2</sub> encountered?	<input type="radio"/> yes <input checked="" type="radio"/> no at what depths? _____
Was H <sub>2</sub> S encountered?	<input type="radio"/> yes <input checked="" type="radio"/> no at what depths? _____
Were unusual drilling circumstances encountered?	<input type="radio"/> yes <input checked="" type="radio"/> no
If yes, briefly explain below	

Other remarks: UIC Application Number: 2200400501. Added perms to Tonkawa and Cottage Grove formations

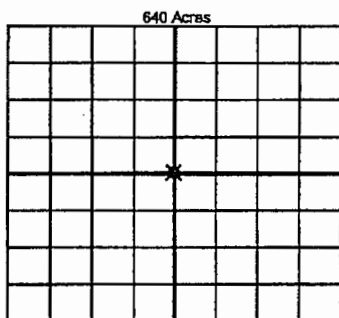

If more than three drainholes are proposed, attach a separate sheet indicating the necessary information.

Direction must be stated in degrees azimuth. Please note, the horizontal drainhole and its end point must be located within the boundaries of the lease or spacing unit.

Directional surveys are required for all drainholes and directional wells

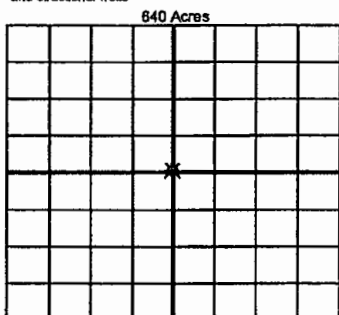

BOTTOM HOLE LOCATION FOR DIRECTIONAL HOLE

SEC	TWP	RGE	COUNTY
1/4	1/4	1/4	1/4
Measured Total Depth		True Vertical Depth	Feet From 1/4 Sec Lines BHL From Lease, Unit, or Property Line:

BOTTOM HOLE LOCATION FOR HORIZONTAL HOLE: (LATERALS)

LATERAL #1			
SEC	TWP	RGE	COUNTY
1/4	1/4	1/4	1/4
Depth of Deviation		Radius of Turn	Direction
Measured Total Depth		True Vertical Depth	Total Length
		BHL From Lease, Unit, or Property Line:	

LATERAL #2			
SEC	TWP	RGE	COUNTY
1/4	1/4	1/4	1/4
Depth of Deviation		Radius of Turn	Direction
Measured Total Depth		True Vertical Depth	Total Length
		BHL From Lease, Unit, or Property Line:	

LATERAL #3			
SEC	TWP	RGE	COUNTY
1/4	1/4	1/4	1/4
Depth of Deviation		Radius of Turn	Direction
Measured Total Depth		True Vertical Depth	Total Length
		BHL From Lease, Unit, or Property Line:	