

Oklahoma Corporation Commission
Oil & Gas Conservation Division
Post Office Box 52000
Oklahoma City, Oklahoma 73152-2000
Rule 165: 10-3-25

Form 1002A

API No.: 35081243280000

Completion Report

Spud Date: February 14, 2022

OTC Prod. Unit No.: 081-227805-0-0000

Drilling Finished Date: March 02, 2022

1st Prod Date: April 25, 2022

Completion Date: April 22, 2022

Drill Type: HORIZONTAL HOLE

Well Name: ESTER CREE 2-26MH

Purchaser/Measurer:

Location: LINCOLN 35 17N 3E
NW NE NW NE
165 FNL 1815 FEL of 1/4 SEC
Latitude: 35.912583 Longitude: -96.651016
Derrick Elevation: 938 Ground Elevation: 918

First Sales Date:

Operator: ROBERSON OIL COMPANY INC 19500
PO BOX 8
201 E COTTAGE ST
ADA, OK 74821-0008

Completion Type	
X	Single Zone
	Multiple Zone
	Commingle

Location Exception
Order No
There are no Location Exception records to display.

Increased Density
Order No
723460

Casing and Cement							
Type	Size	Weight	Grade	Feet	PSI	SAX	Top of CMT
CONDUCTOR	20			60		48	SURFACE
SURFACE	9 5/8	36	J-55	556	3000	280	SURFACE
PRODUCTION	5.5	20	P-110	8617	5000	1070	1726

Liner								
Type	Size	Weight	Grade	Length	PSI	SAX	Top Depth	Bottom Depth
There are no Liner records to display.								

Total Depth: 8627

Packer	
Depth	Brand & Type
There are no Packer records to display.	

Plug	
Depth	Plug Type
There are no Plug records to display.	

Initial Test Data

Test Date	Formation	Oil BBL/Day	Oil-Gravity (API)	Gas MCF/Day	Gas-Oil Ratio Cu FT/BBL	Water BBL/Day	Pumpin or Flowing	Initial Shut-In Pressure	Choke Size	Flow Tubing Pressure
Apr 29, 2022	MISSISSIPPIAN	185	43	264	1435	1685	PUMPING	640		

Completion and Test Data by Producing Formation

Formation Name: MISSISSIPPIAN

Code: 359MSSP

Class: OIL

Spacing Orders

Order No	Unit Size
602822	640

Perforated Intervals

From	To
4800	8500

Acid Volumes

5,000 BARRELS 15% ACID

Fracture Treatments

162,923 BARRELS WATER, 3,500,000 POUNDS 30/50 SAND
--

Formation	Top
BIG LIME	3609
OSWEGO	3645
VERDIGRIS	3789
SKINNER UP	3800
PINK LIME	3990
RED FORK	4017
MISSISSIPPI	4676

Were open hole logs run? No

Date last log run:

Were unusual drilling circumstances encountered? No

Explanation:

Other Remarks

OCC - THE COMPLETION INTERVAL IS WITHIN WHAT IS ALLOWED BY SPACING ORDER NUMBER 602822.

Lateral Holes

Sec: 26 TWP: 17N RGE: 3E County: LINCOLN

NE SE NW NE

689 FNL 1358 FEL of 1/4 SEC

Depth of Deviation: 3154 Radius of Turn: 1554 Direction: 357 Total Length: 3919

Measured Total Depth: 8627 True Vertical Depth: 4262 End Pt. Location From Release, Unit or Property Line: 689

FOR COMMISSION USE ONLY

1148137

Status: Accepted

API NO. 081-24328
OTC PROD UNIT NO. 081-221805

Oil and Gas Conservation Division
P.O. Box 52000
Oklahoma City, OK 73152-2000
405-521-2331
OCCentralProcessing@OCC.OK.GOV



OKLAHOMA
Corporation
Commission

Form 1002A
Rev. 2021

ORIGINAL
AMENDED (Reason)

Rule 165:10-3-25

COMPLETION REPORT

TYPE OF DRILLING OPERATION

☐ STRAIGHT HOLE ☐ DIRECTIONAL HOLE ☒ HORIZONTAL HOLE
☐ SERVICE WELL

If directional or horizontal, see reverse for bottom hole location.

COUNTY	LINCOLN	SEC	35	TWP	17N	RGE	3E	SPUD DATE	2-14-22
LEASE NAME	ESTER CREE			WELL NO.	2-26 MH			DRLG FINISHED DATE	3-02-22
NW 1/4 NE 1/4 NW 1/4 NE 1/4								DATE OF WELL COMPLETION	4-22-22
ELEVATION 938' Ground 918'								1st PROD DATE	4-25-22
Latitude 35.912583°N								RECOMP DATE	N/A
Longitude -96.951016°W									
OPERATOR NAME ROBERSON OIL COMPANY, INC.								OTC / OCC OPERATOR NO.	19500
ADDRESS P.O. BOX 8									
CITY	ADA	STATE	OK	ZIP	74821				

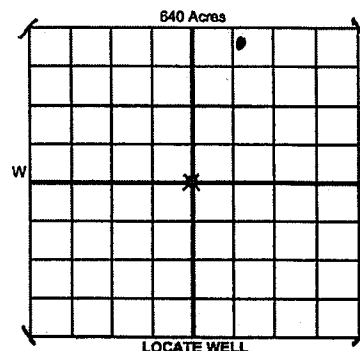

COMPLETION TYPE

<input checked="" type="radio"/> SINGLE ZONE	
<input type="radio"/> MULTIPLE ZONE	
Application Date	
COMINGLED	
Application Date	
LOCATION EXCEPTION ORDER NO.	NONE
MULTIUNIT ORDER NO.	N/A
INCREASED DENSITY ORDER NO.	723460 F.O.

CASING & CEMENT (Attach Form 1002C)

TYPE	SIZE	WEIGHT	GRADE	FEET	PSI	SAX	TOP OF CMT
CONDUCTOR	20"			60'		48	SURFACE
SURFACE	9 5/8"	36#	J-55	556'	3000	280	SURFACE
INTERMEDIATE							
PRODUCTION	5.5"	20#	P-110	8617'	5000	1070	1726'
LINER							

PACKER @ _____ BRAND & TYPE _____ PLUG @ _____ TYPE _____ PLUG @ _____ TYPE _____ TOTAL DEPTH 8621'

COMPLETION & TEST DATA BY PRODUCING FORMATION

FORMATION	MISSISSIPPIAN					
SPACING & SPACING ORDER NUMBER	602822 (640)					
CLASS: Oil, Gas, Dry, Inj., Disp, Comm Disp, Svc	Oil <input checked="" type="checkbox"/>					
PERFORATED INTERVALS	4800-4850 / 4950-5050	5750-5850	6350-6450	6950-7050	7550-7650	8150-8250
	5150-5250 / 5350-5450	5950-6050	6550-6650	7150-7250	7750-7850	8400-8500
	5550-5650	6150-6250	6750-6850	7350-7450	7950-8050	
ACID/VOLUME	5000 BBLS.	15 % ACID				
FRACTURE TREATMENT (Fluids/Prop Amounts)	162,923 BLS.WATER 3,500.00 LBS 30/50 SAND					

Reported to
Free Focus

Min Gas Allowable (165:10-17-7)

Purchaser/Measurer

First Sales Date

INITIAL TEST DATA

INITIAL TEST DATE	4-29-22					
OIL-BBL/DAY	185					
OIL-GRAVITY (API)	43					
GAS-MCF/DAY	264					
GAS-OIL RATIO CU FT/BBL	1435					
WATER-BBL/DAY	1685					
PUMPING OR FLOWING	PUMPING					
INITIAL SHUT-IN PRESSURE	640					
CHOKE SIZE	N/A					
FLOW TUBING PRESSURE	N/A					

RECEIVED

MAY 06 2022

OKLAHOMA CORPORATION
COMMISSION

A record of the formations drilled through, and pertinent remarks are presented on the reverse. I declare that I have knowledge of the contents of this report and am authorized by my organization to make this report, which was prepared by me or under my supervision and direction, with the data and facts stated herein to be true, correct, and complete to the best of my knowledge and belief.

SIGNATURE _____ DAVID ROBERSON, II
P.O. BOX 8 _____
ADDRESS _____ CITY _____ STATE _____ ZIP _____
DATE 5/5/22 PHONE NUMBER 580-332-6170
EMAIL ADDRESS ROIL11@YAHOO.COM

PLEASE TYPE OR USE BLACK INK ONLY
FORMATION RECORD

Give formation names and tops, if available, or descriptions and thickness of formations drilled through. Show intervals cored or drillstem tested.

NAMES OF FORMATIONS	TOP
BIG LIME	3609'
OSWEGO	3645'
VERDIGRIS	3789'
UPPER SKINNER	3800'
PINK LIME	3990'
RED FORK	4017'
MISSISSIPPI	4676'
ALL MD FOOTAGES	

LEASE NAME ESTER CREE WELL NO. 2-26

FOR COMMISSION USE ONLY	
ITD on file <input type="checkbox"/> YES <input type="checkbox"/> NO	
APPROVED <input type="checkbox"/> DISAPPROVED <input type="checkbox"/>	2) Reject Codes
<div></div> <div></div> <div></div> <div></div> <div></div>	

Were open hole logs run?	<input type="radio"/> yes <input checked="" type="radio"/> no
Date Last log was run	N/A
Was CO ₂ encountered?	<input type="radio"/> yes <input checked="" type="radio"/> no at what depths?
Was H ₂ S encountered?	<input type="radio"/> yes <input checked="" type="radio"/> no at what depths?
Were unusual drilling circumstances encountered?	<input type="radio"/> yes <input checked="" type="radio"/> no
If yes, briefly explain below	

Other remarks: OCC - The completion interval is within what is allowed by spacing order 602872

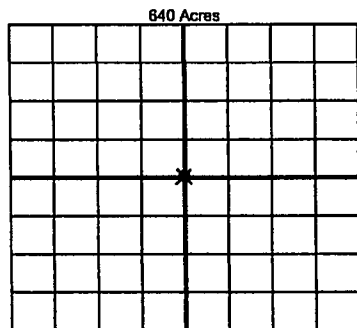

If more than three drainholes are proposed, attach a separate sheet indicating the necessary information.

Direction must be stated in degrees azimuth. Please note, the horizontal drainhole and its end point must be located within the boundaries of the lease or spacing unit.

Directional surveys are required for all drainholes and directional wells

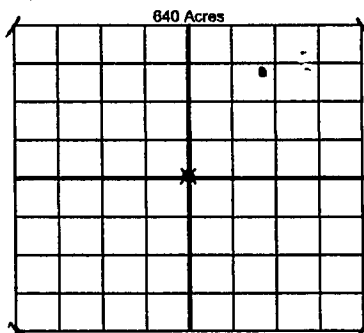

BOTTOM HOLE LOCATION FOR DIRECTIONAL HOLE

SEC	TWP	RGE	COUNTY
1/4	1/4	1/4	1/4
Measured Total Depth	True Vertical Depth	Feet From 1/4 Sec Lines	
		BHL From Lease, Unit, or Property Line:	

BOTTOM HOLE LOCATION FOR HORIZONTAL HOLE: (LATERALS)

LATERAL #1			
SEC	TWP	RGE	COUNTY
26	17N	3E	LINCOLN
SENE 1/4	NWSE 1/4	NENW 1/4	NE 1/4
Depth of Deviation	3154'	Radius of Turn	1554'
Measured Total Depth	8627'	True Vertical Depth	4262'
		Direction	357-366-67
		Total Length	3919'
		BHL From Lease, Unit, or Property Line: 689'	

LATERAL #2			
SEC	TWP	RGE	COUNTY
1/4	1/4	1/4	1/4
Depth of Deviation		Radius of Turn	
Measured Total Depth		True Vertical Depth	
		Direction	
		Total Length	
		BHL From Lease, Unit, or Property Line:	

LATERAL #3			
SEC	TWP	RGE	COUNTY
1/4	1/4	1/4	1/4
Depth of Deviation		Radius of Turn	
Measured Total Depth		True Vertical Depth	
		Direction	
		Total Length	
		BHL From Lease, Unit, or Property Line:	