

Oklahoma Corporation Commission
Oil & Gas Conservation Division
Post Office Box 52000
Oklahoma City, Oklahoma 73152-2000
Rule 165: 10-3-25

Form 1002A

API No.: 35019261690001

Completion Report

Spud Date: March 27, 2015

OTC Prod. Unit No.: 019-212281-0-0000

Drilling Finished Date: March 29, 2015

Amended

1st Prod Date: January 18, 2016

Amend Reason: RECOMPLETION

Completion Date: January 15, 2016

Recomplete Date: February 01, 2021

Drill Type: STRAIGHT HOLE

Well Name: BRADY 152

Purchaser/Measurer:

Location: CARTER 5 2S 2W
E2 NW NW SE
2310 FSL 495 FWL of 1/4 SEC
Derrick Elevation: 1068 Ground Elevation: 1061

First Sales Date:

Operator: KODIAK OIL & GAS INC 23226

204 N WALNUT ST
MUNSTER, TX 76252-2766

Completion Type		Location Exception		Increased Density	
X	Single Zone	Order No		Order No	
	Multiple Zone	There are no Location Exception records to display.		There are no Increased Density records to display.	
	Commingled				

Casing and Cement							
Type	Size	Weight	Grade	Feet	PSI	SAX	Top of CMT
PRODUCTION	5 1/2	15.5	J	2315		400	SURFACE

Liner								
Type	Size	Weight	Grade	Length	PSI	SAX	Top Depth	Bottom Depth
There are no Liner records to display.								

Total Depth: 2500

Packer		Plug	
Depth	Brand & Type	Depth	Plug Type
There are no Packer records to display.		2000	CIBP

Initial Test Data										
Test Date	Formation	Oil BBL/Day	Oil-Gravity (API)	Gas MCF/Day	Gas-Oil Ratio Cu FT/BBL	Water BBL/Day	Pumpin or Flowing	Initial Shut-In Pressure	Choke Size	Flow Tubing Pressure
Feb 01, 2021	HOXBAR	4	27			20	PUMPING	20		

Completion and Test Data by Producing Formation										
---	--	--	--	--	--	--	--	--	--	--

Formation Name: HOXBAR

Code: 405HXBR

Class: OIL

Spacing Orders

Order No	Unit Size
664581	UNIT

Perforated Intervals

From	To
1614	1626

Acid Volumes

There are no Acid Volume records to display.

Fracture Treatments

There are no Fracture Treatments records to display.

Formation	Top
HOXBAR	1292
DEESE	2048

Were open hole logs run? Yes

Date last log run: March 29, 2015

Were unusual drilling circumstances encountered? No

Explanation:

Other Remarks

SET CAST IRON BRIDGE PLUG TO SHUT DEESE OFF AND OPENED HOXBAR SAND

FOR COMMISSION USE ONLY

Status: Accepted

1146183

API NO. 019-26169
OTC PROD. UNIT NO. 019-212281

PLEASE TYPE OR USE BLACK INK ONLY
NOTE:

OKLAHOMA CORPORATION COMMISSION
Oil & Gas Conservation Division
Post Office Box 52000
Oklahoma City, Oklahoma 73162-2000
Rule 165:10-3-26

Form 1002A
Rev. 2009

☐ ORIGINAL
☒ AMENDED (Reason)

Attach copy of original 1002A
if recompletion or reentry.

WELL RECORD *Recompletion*

COMPLETION REPORT

TYPE OF DRILLING OPERATION

☒ STRAIGHT HOLE ☐ DIRECTIONAL HOLE ☐ HORIZONTAL HOLE
☐ SERVICE WELL

If directional or horizontal, see reverse for bottom hole location.

COUNTY **Carter** SEC **5** TWP **2S** RGE **2W**
LEASE NAME **Brady** WELL NO. **152**
E2 1/4 NW 1/4 NW 1/4 SE 1/4 FSL OF 1/4 SEC **2310** FWL OF 1/4 SEC **495**
ELEVATION **1068** Ground **1061** Latitude (if known) Longitude (if known)
OPERATOR NAME **KODIAK OIL & GAS, INC.** OTC/OCC OPERATOR NO. **23226**
ADDRESS **204 N. Walnut St**
CITY **Muenster** STATE **TX** ZIP **76252**

SPUD DATE **3/27/2015**
DRILG FINISHED DATE **3/29/2015**
DATE OF WELL COMPLETION **1/15/2016**
1st PROD DATE **1/18/2016**
RECOMP DATE **2-1-2021**

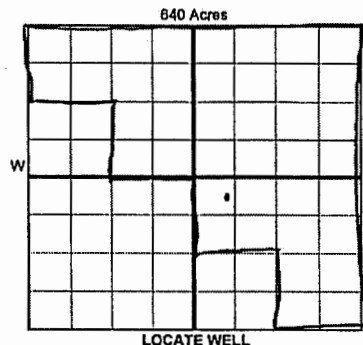

COMPLETION TYPE

☒ SINGLE ZONE
☐ MULTIPLE ZONE
Application Date
☐ COMMINGLED
Application Date
LOCATION
EXCEPTION ORDER
INCREASED DENSITY
ORDER NO.

CASING & CEMENT (Form 1002C must be attached)

TYPE	SIZE	WEIGHT	GRADE	FEET	PSI	SAX	TOP OF CMT
CONDUCTOR							
SURFACE							
INTERMEDIATE							
PRODUCTION	5 1/2	15.5	J	2315		400	Surface
LINER							

PACKER @ _____ BRAND & TYPE **GIBP** PLUG @ **2000'** TYPE **GIBP** PLUG @ _____ TYPE _____ TOTAL DEPTH **2,500**
PACKER @ _____ BRAND & TYPE _____ PLUG @ _____ TYPE _____ PLUG @ _____ TYPE _____

COMPLETION & TEST DATA BY PRODUCING FORMATION

FORMATION	HOXBAR						
SPACING & SPACING ORDER NUMBER	10-00-647304-664581 (unit)						No Frac
CLASS: Oil, Gas, Dry, Inj, Disp, Comm Disp, Svc	Oil						
PERFORATED INTERVALS	1614-1626						
ACID/VOLUME							
FRACTURE TREATMENT (Fluids/Prop Amounts)							

Min Gas Allowable (165:10-17-7)

Gas Purchaser/Measurer



OR

First Sales Date

Oil Allowable (165:10-13-3)

INITIAL TEST DATA

INITIAL TEST DATE	2/1/2021					
OIL-BBL/DAY	4					
OIL-GRAVITY (API)	27					
GAS-MCF/DAY	0					
GAS-OIL RATIO CU FT/BBL	-					
WATER-BBL/DAY	20					
PUMPING OR FLOWING	pumping					
INITIAL SHUT-IN PRESSURE	20					
CHOKE SIZE	-					
FLOW TUBING PRESSURE	-					

A record of the formations drilled through, and pertinent remarks are presented on the reverse. I declare that I have knowledge of the contents of this report and am authorized by my organization to make this report which was prepared by me or under my supervision and direction, with the data and facts stated herein to be true, correct, and complete to the best of my knowledge and belief.

Mel Walterscheid
SIGNATURE NAME (PRINT OR TYPE) **Mel Walterscheid** DATE **2/2/2021** PHONE NUMBER **940-759-4001**
204 N. Walnut St Muenster TX 76252
ADDRESS CITY STATE ZIP EMAIL ADDRESS **wfw@ntin.net**

PLEASE TYPE OR USE BLACK INK ONLY

FORMATION RECORD

Give formation names and tops, if available, or descriptions and thickness of formations drilled through. Show intervals cored or drillstem tested.

NAMES OF FORMATIONS	TOP
Hoxbar	1,292
Deese	2,048

LEASE NAME Brady WELL NO. 152

FOR COMMISSION USE ONLY

ITD on file ☐ YES ☐ NO

APPROVED _____ DISAPPROVED _____

2) Reject Codes

Were open hole logs run? ☒ yes ☐ no

Date Last log was run 3/29/2015

Was CO₂ encountered? ☐ yes ☒ no at what depths? _____

Was H₂S encountered? ☐ yes ☒ no at what depths? _____

Were unusual drilling circumstances encountered? ☐ yes ☒ no
If yes, briefly explain below

Other remarks: SET CAST IRON BRIDGE PLUG TO SHUT DEESE OFF AND OPENED HOXBAR SAND.

640 Acres

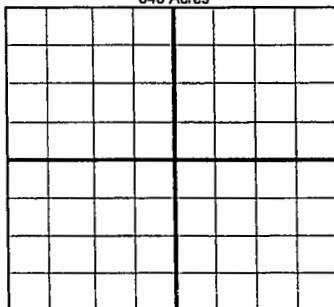

If more than three drainholes are proposed, attach a separate sheet indicating the necessary information.

Direction must be stated in degrees azimuth.
Please note, the horizontal drainhole and its end point must be located within the boundaries of the lease or spacing unit.

Directional surveys are required for all drainholes and directional wells.

640 Acres

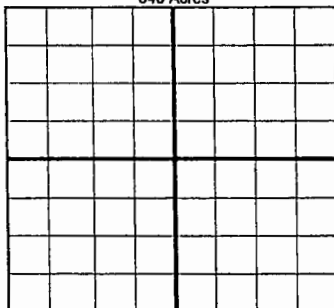

BOTTOM HOLE LOCATION FOR DIRECTIONAL HOLE

SEC	TWP	RGE	COUNTY
Spot Location	1/4	1/4	1/4
Measured Total Depth	True Vertical Depth	Feet From 1/4 Sec Lines	FSL FWL
BHL From Lease, Unit, or Property Line:			

BOTTOM HOLE LOCATION FOR HORIZONTAL HOLE: (LATERALS)

SEC	TWP	RGE	COUNTY
Spot Location	1/4	1/4	1/4
Depth of Deviation	Radius of Turn	Direction	Total Length
Measured Total Depth	True Vertical Depth	BHL From Lease, Unit, or Property Line:	

SEC	TWP	RGE	COUNTY
Spot Location	1/4	1/4	1/4
Depth of Deviation	Radius of Turn	Direction	Total Length
Measured Total Depth	True Vertical Depth	BHL From Lease, Unit, or Property Line:	

SEC	TWP	RGE	COUNTY
Spot Location	1/4	1/4	1/4
Depth of Deviation	Radius of Turn	Direction	Total Length
Measured Total Depth	True Vertical Depth	BHL From Lease, Unit, or Property Line:	