

Oklahoma Corporation Commission
Oil & Gas Conservation Division
Post Office Box 52000
Oklahoma City, Oklahoma 73152-2000
Rule 165: 10-3-25

Form 1002A

API No.: 35019264100001

Completion Report

Spud Date: October 24, 2020

OTC Prod. Unit No.: 019-012538-0-5383

Drilling Finished Date: October 30, 2020

1st Prod Date: March 19, 2021

Completion Date: March 15, 2021

Drill Type: DIRECTIONAL HOLE

Well Name: SW WILDCAT JIM DEESE UNIT 13-3

Purchaser/Measurer:

Location: CARTER 7 2S 2W
NW SW SW NW
2065 FNL 320 FWL of 1/4 SEC
Latitude: 34.399632 Longitude: -97.456388
Derrick Elevation: 1037 Ground Elevation: 1025

First Sales Date:

Operator: MACK ENERGY CO 11739

4700 GAILLARDIA PKWY STE 102
OKLAHOMA CITY, OK 73142-1839

Completion Type		Location Exception		Increased Density	
X	Single Zone	Order No		Order No	
	Multiple Zone	There are no Location Exception records to display.		There are no Increased Density records to display.	
	Commingled				

Casing and Cement							
Type	Size	Weight	Grade	Feet	PSI	SAX	Top of CMT
SURFACE	9 5/8	40	K-55	1319		685	SURFACE
PRODUCTION	7	26	J-55	4725		220	2211

Liner								
Type	Size	Weight	Grade	Length	PSI	SAX	Top Depth	Bottom Depth
There are no Liner records to display.								

Total Depth: 4780

Packer	
Depth	Brand & Type
There are no Packer records to display.	

Plug	
Depth	Plug Type
There are no Plug records to display.	

Initial Test Data										
Test Date	Formation	Oil BBL/Day	Oil-Gravity (API)	Gas MCF/Day	Gas-Oil Ratio Cu FT/BBL	Water BBL/Day	Pumpin or Flowing	Initial Shut-In Pressure	Choke Size	Flow Tubing Pressure
Mar 28, 2021	DEESE	5	23			192	PUMPING	32	N/A	100

Completion and Test Data by Producing Formation

Formation Name: DEESE

Code: 404DEESS

Class: OIL

Spacing Orders

Order No	Unit Size
701901	UNIT

Perforated Intervals

From	To
4436	4567

Acid Volumes

There are no Acid Volume records to display.

Fracture Treatments

36,680 POUNDS 16/30 SAND, 975 BARRELS

Formation Name: DEESE

Code: 404DEESS

Class: OIL

Spacing Orders

Order No	Unit Size
701901	UNIT

Perforated Intervals

From	To
4335	4422

Acid Volumes

There are no Acid Volume records to display.

Fracture Treatments

30,520 POUNDS 16/30 SAND, 908 BARRELS

Formation Name: DEESE

Code: 404DEESS

Class: OIL

Spacing Orders

Order No	Unit Size
701901	UNIT

Perforated Intervals

From	To
3741	4060

Acid Volumes

There are no Acid Volume records to display.

Fracture Treatments

24,670 POUNDS 16/30 SAND, 690 BARRELS

Formation Name: DEESE

Code: 404DEESS

Class: OIL

Spacing Orders

Order No	Unit Size
701901	UNIT

Perforated Intervals

From	To
3407	3614

Acid Volumes

There are no Acid Volume records to display.

Fracture Treatments

19,660 POUNDS 16/30 SAND, 740 BARRELS

Formation Name: DEESE		Code: 404DEESS	Class: OIL
Spacing Orders		Perforated Intervals	
Order No	Unit Size	From	To
701901	UNIT	3148	3176
Acid Volumes		Fracture Treatments	
There are no Acid Volume records to display.		8,980 POUNDS 16/30 SAND, 343 BARRELS	

Formation	Top
CISCO	1510
HOXBAR	1962
COUNTY LINE LIME	2114
COUNTY LINE SAND	2181
TATUMS	2465
DEESE GROUP	2914
FUSULINID	3028
EASON	3250
TUSSY	3392
TUSSY LIME	3466
CARPENTER SANDS	3821
MORRIS	4139

Were open hole logs run? Yes
Date last log run: October 28, 2020

Were unusual drilling circumstances encountered? No
Explanation:

Other Remarks
THIS WELL IS PART OF THE NEWLY FORMED SOUTHWEST WILDCAT JIM DEESE UNIT.

Bottom Holes
Sec: 12 TWP: 2S RGE: 3W County: CARTER NE SE SE NE 2299 FNL 164 FEL of 1/4 SEC Depth of Deviation: 0 Radius of Turn: 0 Direction: 0 Total Length: 0 Measured Total Depth: 4780 True Vertical Depth: 4730 End Pt. Location From Release, Unit or Property Line: 1156

FOR COMMISSION USE ONLY	
Status: Accepted	1146313

API NO. 019-26410
 OTC PROD. 019-012538
 UNIT NO. 0-5383

(PLEASE TYPE OR USE BLACK INK ONLY)

OKLAHOMA CORPORATION COMMISSION
 Oil & Gas Conservation Division
 Post Office Box 52000
 Oklahoma City, Oklahoma 73152-2000
 Rule 165:10-3-25

RECEIVED

Form 1002A
 Rev. 2009

APR 15 2021

☒ ORIGINAL
☐ AMENDED (Reason) _____

COMPLETION REPORT

TYPE OF DRILLING OPERATION

☐ STRAIGHT HOLE ☒ DIRECTIONAL HOLE ☐ HORIZONTAL HOLE
☐ SERVICE WELL

If directional or horizontal, see reverse for bottom hole location.

COUNTY	Carter	SEC	7	TWP	2S	RGE	2W	SPUD DATE	10-24-20
LEASE NAME	SW WJDU Deese Unit			WELL NO.	13-3	DATE OF WELL COMPLETION	3-15-21	DRLG FINISHED DATE	10-30-20
NW 1/4 SW 1/4 SW 1/4 NW 1/4	FNL 1/4 SEC 2065'			FWL OF 1/4 SEC	320'	1st PROD DATE	3-19-21	RECOMP DATE	
ELEVATION Derrick FL	1037'	Ground	1025'	Latitude (if known)	34.399632	Longitude (if known)	- 97.456388		
OPERATOR NAME	Mack Energy Co.				OTC / OCC OPERATOR NO.	11739			
ADDRESS	P.O. Box 400								
CITY	Duncan	STATE	OK	ZIP	73534				

640 Acres

LOCATE WELL

COMPLETION TYPE

<input checked="" type="checkbox"/> SINGLE ZONE	
<input type="checkbox"/> MULTIPLE ZONE	
Application Date	
<input type="checkbox"/> COMMINGLED	
Application Date	
LOCATION EXCEPTION ORDER NO.	
INCREASED DENSITY ORDER NO.	

CASING & CEMENT (Attach Form 1002C)

TYPE	SIZE	WEIGHT	GRADE	FEET	PSI	SAX	TOP OF CMT
CONDUCTOR							
SURFACE	9 5/8"	40#	K-55	1319'		685	Surface
INTERMEDIATE							
PRODUCTION	7"	26#	J-55	4725'		220	2211'
LINER							
TOTAL DEPTH							4780'

PACKER @ _____ BRAND & TYPE _____ PLUG @ _____ TYPE _____ PLUG @ _____ TYPE _____
 PACKER @ _____ BRAND & TYPE _____ PLUG @ _____ TYPE _____ PLUG @ _____ TYPE _____

COMPLETION & TEST DATA BY PRODUCING FORMATION

FORMATION	(Lower Morris)	(Middle Morris)	(U. Morris)	(Tussy)	(Fusulinid)	← All Deese
SPACING & SPACING	10 acre	10 acre	10 acre	10 acre	10 acre	
ORDER NUMBER	701901	701901	701901	701901	701901	
CLASS: Oil, Gas, Dry, Inj, Disp, Comm Disp, Svc	Oil	Oil	Oil	Oil	Oil	
	4436-4567'	4335-4422'	3741-4060'	3407-3614'	3148-3176'	
PERFORATED INTERVALS						
ACID VOLUME						
FRACTURE TREATMENT (Fluids/Prop Amounts)	36680# 16/30 sd & 975 bbls	30520# 16/30 sd & 908 bbls	24670# 16/30 sd & 690 bbls	19660# 16/30 sd & 740 bbls	8980# 16/30 sd & 343 bbls	

Reported to FracFocus

Min Gas Allowable (165:10-17-7)

Gas Purchaser/Measurer

OR

First Sales Date

Oil Allowable (165:10-13-3)

INITIAL TEST DATA

INITIAL TEST DATE	3/28/2021				
OIL-BBL/DAY	5				
OIL-GRAVITY (API)	23				
GAS-MCF/DAY	0				
GAS-OIL RATIO CU FT/BBL	N/A				
WATER-BBL/DAY	192				
PUMPING OR FLOWING	Pumping				
INITIAL SHUT-IN PRESSURE	32				
CHOKE SIZE	N/A				
FLOW TUBING PRESSURE	100				

A record of the formations drilled through, and pertinent remarks are presented on the reverse. I declare that I have knowledge of the contents of this report and am authorized by my organization to make this report, which was prepared by me or under my supervision and direction, with the data and facts stated herein to be true, correct, and complete to the best of my knowledge and belief.

SIGNATURE <i>Dinah Mayes</i>		NAME (PRINT OR TYPE) Dinah Mayes		DATE 4/14/2021		PHONE NUMBER 580-856-3705	
ADDRESS 3730 Samedan Rd		CITY Ratliff City		STATE OK		ZIP 73481	
				EMAIL ADDRESS dmayes@mackenergy.com			

PLEASE TYPE OR USE BLACK INK ON...
FORMATION RECORD

Give formation names and tops, if available, or descriptions and thickness of formations drilled through. Show intervals cored or drillstem tested.

NAMES OF FORMATIONS	TOP
CISCO	1510' MD
Hoxbar	1962'
County Line Lime	2114'
County Line Sand	2181'
Tatums	2465'
Deese Group	2914'
Fussulinid	3028'
Eason	3250'
Tussy	3392'
Tussy Lime	3466'
Carpenter Sands	3821'
Morris	4139'

LEASE NAME SW WJDU WELL NO. 13-3

FOR COMMISSION USE ONLY	
ITD on file <input type="checkbox"/> YES <input type="checkbox"/> NO	
APPROVED _____	DISAPPROVED _____
2) Reject Codes	

Were open hole logs run?	<input checked="" type="checkbox"/> yes <input type="checkbox"/> no
Date Last log was run	<u>10/28/2020</u>
Was CO ₂ encountered?	<input type="checkbox"/> yes <input checked="" type="checkbox"/> no at what depths? _____
Was H ₂ S encountered?	<input type="checkbox"/> yes <input checked="" type="checkbox"/> no at what depths? _____
Were unusual drilling circumstances encountered?	<input type="checkbox"/> yes <input checked="" type="checkbox"/> no
If yes, briefly explain below	

Other remarks: This well is part of the newly formed Southwest Wildcat Jim Deese Unit

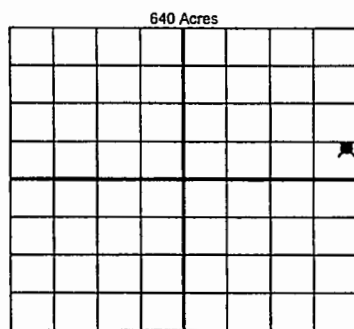

If more than three drainholes are proposed, attach a separate sheet indicating the necessary information.

Direction must be stated in degrees azimuth. Please note, the horizontal drainhole and its end point must be located within the boundaries of the lease or spacing unit.

Directional surveys are required for all drainholes and directional wells.

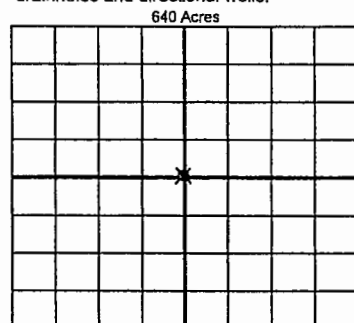

BOTTOM HOLE LOCATION FOR DIRECTIONAL HOLE

SEC <u>12.7</u>	TWP <u>2S</u>	RGE <u>3W 2W</u>	COUNTY <u>Carter</u>
Spot Location			
NE 1/4	SE 1/4	SE 1/4	NE 1/4
Measured Total Depth		BHL From Lease, Unit, or Property Line:	
4780'		1156'	

BOTTOM HOLE LOCATION FOR HORIZONTAL HOLE: (LATERALS)

SEC	TWP	RGE	COUNTY
Spot Location			
1/4	1/4	1/4	1/4
Depth of Deviation	Radius of Turn	Direction	Total Length
Measured Total Depth	True Vertical Depth	BHL From Lease, Unit, or Property Line:	

LATERAL #2

SEC	TWP	RGE	COUNTY
Spot Location			
1/4	1/4	1/4	1/4
Depth of Deviation	Radius of Turn	Direction	Total Length
Measured Total Depth	True Vertical Depth	BHL From Lease, Unit, or Property Line:	

LATERAL #3

SEC	TWP	RGE	COUNTY
Spot Location			
1/4	1/4	1/4	1/4
Depth of Deviation	Radius of Turn	Direction	Total Length
Measured Total Depth	True Vertical Depth	BHL From Lease, Unit, or Property Line:	