

Oklahoma Corporation Commission
Oil & Gas Conservation Division
Post Office Box 52000
Oklahoma City, Oklahoma 73152-2000
Rule 165: 10-3-25

Form 1002A

API No.: 35045214760001

Completion Report

Spud Date: November 28, 1985

OTC Prod. Unit No.: 045-072997-0-0000

Drilling Finished Date: December 15, 1995

Amended

1st Prod Date: April 26, 1988

Amend Reason: REMOVE PLUG AND COMMINGLE

Completion Date: April 26, 1986

Recomplete Date: September 29, 2021

Drill Type: STRAIGHT HOLE

Min Gas Allowable: Yes

Well Name: FRISBY 1-29

Purchaser/Measurer: DCP MIDSTREAM

Location: ELLIS 29 24N 23W
C NW NW
1980 FSL 660 FWL of 1/4 SEC
Derrick Elevation: 2227 Ground Elevation: 2214

First Sales Date: 04/26/1986

Operator: LATIGO OIL AND GAS INC 10027
PO BOX 1208
5815 OKLAHOMA AVE
WOODWARD, OK 73802-1208

Completion Type		Location Exception		Increased Density	
	Single Zone	Order No		Order No	
	Multiple Zone	287679		There are no Increased Density records to display.	
X	Commingled	719476			

Casing and Cement							
Type	Size	Weight	Grade	Feet	PSI	SAX	Top of CMT
CONDUCTOR	20			78		8	SURFACE
SURFACE	8 5/8	24	J-55	878		500	SURFACE
PRODUCTION	5 1/2	17	J-55	8298		200	7340

Liner								
Type	Size	Weight	Grade	Length	PSI	SAX	Top Depth	Bottom Depth
There are no Liner records to display.								

Total Depth: 8298

Packer	
Depth	Brand & Type
There are no Packer records to display.	

Plug	
Depth	Plug Type
There are no Plug records to display.	

Initial Test Data

Test Date	Formation	Oil BBL/Day	Oil-Gravity (API)	Gas MCF/Day	Gas-Oil Ratio Cu FT/BBL	Water BBL/Day	Pumpin or Flowing	Initial Shut-In Pressure	Choke Size	Flow Tubing Pressure
Oct 24, 2021	MISS'AN (CHESTER)-MORROW SAND			78	78	6	PUMPING	120		

Completion and Test Data by Producing Formation									
Formation Name: MISS'AN (CHESTER)				Code: 354MSSNC			Class: GAS		
Spacing Orders				Perforated Intervals					
Order No		Unit Size		From			To		
157915		640		7956			7968		
Acid Volumes				Fracture Treatments					
1,500 GALLONS (1986), 817 BARRELS (1986)				There are no Fracture Treatments records to display.					

Formation Name: MORROW SAND		Code: 402MWSD		Class: GAS	
Spacing Orders		Perforated Intervals			
Order No	Unit Size	From	To		
39292	640	7778	7786		
		7911	7918		
Acid Volumes		Fracture Treatments			
N/A		N/A			

Formation Name: MISS'AN (CHESTER)-MORROW SAND			Code:			Class: GAS		

Formation	Top
MORROW SAND	7700
MISSISSIPPIAN CHESTER	7956

Were open hole logs run? Yes
 Date last log run: December 14, 1985

 Were unusual drilling circumstances encountered? No
 Explanation:

Other Remarks
PULLED RETRIEVABLE BRIDGE PLUG AND COMMINGLED MORROW SAND AND MISSISSIPPIAN (CHESTER). ALSO, REPORTED PERFORATIONS IN MORROW SAND 7,778' - 7,786' THAT WERE NOT PREVIOUSLY REPORTED ON 1002A.

FOR COMMISSION USE ONLY
<div>Status: Accepted</div> <div>1147032</div>

RECEIVED

API NO. 35-045-21476
 OTC PROD. UNIT NO. 045-072997-0-0000

Oil and Gas Conservation Division
 P.O. Box 52000
 Oklahoma City, OK 73152-2000
 405-522-0577
 OCCCentralProcessing@OCC.OK.GOV

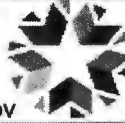

OKLAHOMA OCT 26 2021
 Corporation
 Commission
 OKLAHOMA CORPORATION

Form 1002A
 Rev. 2020

ORIGINAL AMENDED (Reason) *Remove Plug* COMMINGLE

Rule 165:10-3-25

COMPLETION REPORT

TYPE OF DRILLING OPERATION

☒ STRAIGHT HOLE ☐ DIRECTIONAL HOLE ☐ HORIZONTAL HOLE
☐ SERVICE WELL

If directional or horizontal, see reverse for bottom hole location.

COUNTY	ELLIS	SEC	29	TWP	24n	RGE	23w
LEASE NAME	FRISBY			WELL NO.	1-29		
1/4	C	1/4	NW	1/4	NW	1/4	FSL 1980 FWL 660
ELEVATION Derrick FL	2227'	Ground	2214'	Latitude	Longitude		
OPERATOR NAME	LATIGO OIL & GAS, INC.			OTC / OCC OPERATOR NO.	10027		
ADDRESS	P.O. BOX 1208						
CITY	WOODWARD		STATE	OK		ZIP	73802

SPUD DATE 11/28/1985
 DRLG FINISHED DATE 12/15/1995
 DATE OF WELL COMPLETION 4/26/1986
 1st PROD DATE 4/26/1986
 RECOMP DATE 9/29/2021

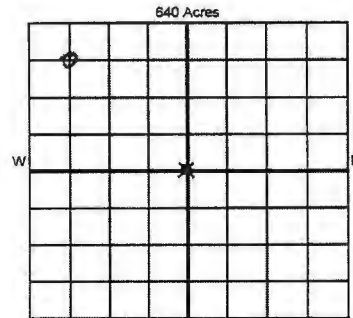

COMPLETION TYPE

<input type="radio"/> SINGLE ZONE	
<input type="radio"/> MULTIPLE ZONE	
Application Date	
<input checked="" type="radio"/> COMMINGLED	7/23/2021
Application Date	
LOCATION EXCEPTION ORDER NO.	287679/719476
MULTITUNIT ORDER NO.	
INCREASED DENSITY ORDER NO.	N/A

CASING & CEMENT (Attach Form 1002C)

TYPE	SIZE	WEIGHT	GRADE	FEET	PSI	SAX	TOP OF CMT
CONDUCTOR	20"			78'		8	SURFACE
SURFACE	8 5/8"	24#	J-55	878'		500	SURFACE
INTERMEDIATE							
PRODUCTION	5 1/2"	17#	J-55	8298'		200	7340'
LINER							

PACKER @ BRAND & TYPE PLUG @ TYPE PLUG @ TYPE TOTAL DEPTH 8298'

COMPLETION & TEST DATA BY PRODUCING FORMATION

FORMATION	Mississippian (Chester)	Morrow Sand					No New Treatments
SPACING & SPACING ORDER NUMBER	157915 (640)	39292 (640)					
CLASS: Oil, Gas, Dry, Inj, Disp, Comm Disp, Svc	Gas	Gas					
PERFORATED INTERVALS	7956-7968'	7778-7786'					
		7911-7918'					
ACID/VOLUME	1500 gal (1986)	NA					
FRACTURE TREATMENT (Fluids/Prop Amounts)	817 bbls (1986)	NA					

☒ Min Gas Allowable (165:10-17-7)
 OR
☐ Oil Allowable (165:10-13-3)

Purchaser/Measurer DCP Midstream
 First Sales Date 4/26/1986

INITIAL TEST DATA

INITIAL TEST DATE	10/24/2021					
OIL-BBL/DAY	0					
OIL-GRAVITY (API)						
GAS-MCF/DAY	78					
GAS-OIL RATIO CU FT/BBL	78					
WATER-BBL/DAY	6					
PUMPING OR FLOWING	Pumping					
INITIAL SHUT-IN PRESSURE	120#					
CHOKE SIZE	NA					
FLOW TUBING PRESSURE	NA					

A record of the formations drilled through, and pertinent remarks are presented on the reverse. I declare that I have knowledge of the contents of this report and am authorized by my organization to make this report, which was prepared by me or under my supervision and direction, with the data and facts stated herein to be true, correct, and complete to the best of my knowledge and belief.

SIGNATURE *Ryan Barby* RYAN BARBY 10/26/2021 580-256-1416-
 P.O. BOX 1208 WOODWARD OK 73802 DATE PHONE NUMBER
 ADDRESS CITY STATE ZIP EMAIL ADDRESS ryanb@latigooil.com

PLEASE TYPE OR USE BLACK INK ONLY
FORMATION RECORD

Give formation names and tops, if available, or descriptions and thickness of formations drilled through. Show intervals cored or drillstem tested.

LEASE NAME FRISBY WELL NO. 1-29

NAMES OF FORMATIONS	TOP
MORROW SAND	7700'
MISSISSIPPIAN CHESTER	7956'

FOR COMMISSION USE ONLY	
ITD on file <input type="checkbox"/> YES <input type="checkbox"/> NO	
APPROVED _____	DISAPPROVED _____
2) Reject Codes	

Were open hole logs run?	<input checked="" type="radio"/> yes <input type="radio"/> no
Date Last log was run	12-14-1985
Was CO ₂ encountered?	<input type="radio"/> yes <input checked="" type="radio"/> no at what depths? _____
Was H ₂ S encountered?	<input type="radio"/> yes <input checked="" type="radio"/> no at what depths? _____
Were unusual drilling circumstances encountered? If yes, briefly explain below	<input type="radio"/> yes <input checked="" type="radio"/> no

Other remarks: Pulled Ret BP and Commingled Morrow Sand and Mississippian (Chester)

Also, reported perms in Morrow Sand 7778-7786' that were not previously reported on 1002A

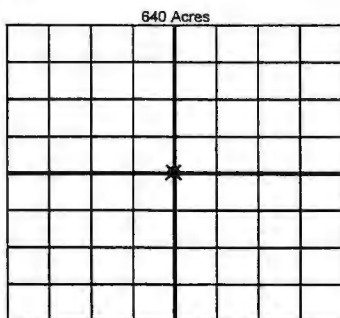

If more than three drainholes are proposed, attach a separate sheet indicating the necessary information.

Direction must be stated in degrees azimuth. Please note, the horizontal drainhole and its end point must be located within the boundaries of the lease or spacing unit.

Directional surveys are required for all drainholes and directional wells

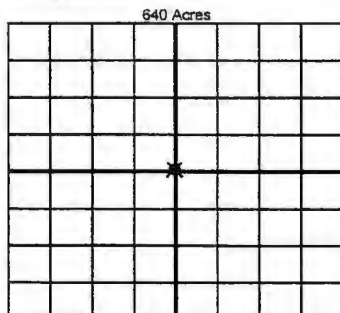

BOTTOM HOLE LOCATION FOR DIRECTIONAL HOLE

SEC	TWP	RGE	COUNTY
1/4	1/4	1/4	1/4
Measured Total Depth		True Vertical Depth	BHL From Lease, Unit, or Property Line:

BOTTOM HOLE LOCATION FOR HORIZONTAL HOLE: (LATERALS)

LATERAL #1			
SEC	TWP	RGE	COUNTY
1/4	1/4	1/4	1/4
Depth of Deviation		Radius of Turn	Direction
Measured Total Depth		True Vertical Depth	BHL From Lease, Unit, or Property Line:

LATERAL #2			
SEC	TWP	RGE	COUNTY
1/4	1/4	1/4	1/4
Depth of Deviation		Radius of Turn	Direction
Measured Total Depth		True Vertical Depth	BHL From Lease, Unit, or Property Line:

LATERAL #3			
SEC	TWP	RGE	COUNTY
1/4	1/4	1/4	1/4
Depth of Deviation		Radius of Turn	Direction
Measured Total Depth		True Vertical Depth	BHL From Lease, Unit, or Property Line: