

Oklahoma Corporation Commission  
Oil & Gas Conservation Division  
Post Office Box 52000  
Oklahoma City, Oklahoma 73152-2000  
Rule 165: 10-3-25

Form 1002A

API No.: 35105412400000

**Completion Report**

Spud Date: June 17, 2016

OTC Prod. Unit No.:

Drilling Finished Date: June 21, 2016

1st Prod Date: December 21, 2018

Completion Date: November 27, 2018

**Drill Type: STRAIGHT HOLE**

Well Name: SHERRY JACKSON 1

Purchaser/Measurer:

Location: NOWATA 10 25N 14E  
SW NE SW NE  
859 FSL 874 FWL of 1/4 SEC  
Derrick Elevation: 0 Ground Elevation: 0

First Sales Date:

Operator: MITCHELL JAMES D 19952

2911 SE WASHINGTON BLVD  
BARTLESVILLE, OK 74006-7610

Completion Type		Location Exception		Increased Density	
X	Single Zone	Order No		Order No	
	Multiple Zone	There are no Location Exception records to display.		There are no Increased Density records to display.	
	Commingled				

Casing and Cement							
Type	Size	Weight	Grade	Feet	PSI	SAX	Top of CMT
SURFACE	7			150		30	SURFACE
PRODUCTION	4 1/2			1065		90	SURFACE

Liner								
Type	Size	Weight	Grade	Length	PSI	SAX	Top Depth	Bottom Depth
There are no Liner records to display.								

**Total Depth: 1065**

Packer		Plug	
Depth	Brand & Type	Depth	Plug Type
There are no Packer records to display.		There are no Plug records to display.	

Initial Test Data										
Test Date	Formation	Oil BBL/Day	Oil-Gravity (API)	Gas MCF/Day	Gas-Oil Ratio Cu FT/BBL	Water BBL/Day	Pumpin or Flowing	Initial Shut-In Pressure	Choke Size	Flow Tubing Pressure
Dec 21, 2018	RED FORK	68.57	38			65	PUMPING			

**Completion and Test Data by Producing Formation**

Formation Name: RED FORK

Code: 404RDFK

Class: OIL

**Spacing Orders****Order No****Unit Size**

There are no Spacing Order records to display.

**Perforated Intervals****From****To**

863

874

**Acid Volumes**

500 GALLONS 15% NEFE HCL ACID

**Fracture Treatments**

FRAC SAND - 30,000 POUNDS;  
BREAKDOWN / FLUSH - 1,600 GALLONS 25 POUNDS  
GELLED WATER;  
PAD - 6,500 GALLONS 25 POUNDS XL-GELLED WATER;  
25 POUNDS SAND LADEN FLUID, 15,500 GALLONS  
GELLED WATER;  
TANK BOTTOMS - 2,856 GALLONS 25 POUNDS GELLED  
WATER

Formation	Top
RED FORK	863

Were open hole logs run? Yes

Date last log run: October 18, 2018

Were unusual drilling circumstances encountered? No

Explanation:

**Other Remarks**

INITIAL PRODUCTION WAS AN ENCOURAGING 68.57 BPD, BUT THAT ONLY LASTED TWO DAYS. ON THE THIRD DAY, PRODUCTION DROPPED TO 5 BPD, AND TWO WEEKS LATER DROPPED TO 2 BPD. WELL CURRENTLY SEEMS TO BE STABILIZED AT 1 3/4 - 2 BPD OF OIL. THE PUMPING UNIT ON THIS WELL IS A 1966 "COOK" BRAND #16 PUMP JACK. (IT WAS ONE OF MY GRANDFATHER MITCHELL'S THAT I RESTORED. ORVILLE ANDERSON MITCHELL - HE BOUGHT IT BRAND NEW).

**FOR COMMISSION USE ONLY**

1143038

Status: Accepted

105-41240

API NO. 10540774  
OTC PROD.  
UNIT NO.PLEASE TYPE OR USE BLACK INK ONLY  
NOTE:Attach copy of original 1002A  
if recompletion or reentry.OKLAHOMA CORPORATION COMMISSION  
Oil & Gas Conservation Division  
Post Office Box 52000  
Oklahoma City, Oklahoma 73152-2000  
Rule 165:10-3-25

RECEIVED

JUN 06 2019

Oklahoma Corporation  
CommissionForm 10  
Rev. 2☒ ORIGINAL  
☐ AMENDED (Reason)

## TYPE OF DRILLING OPERATION

☒ STRAIGHT HOLE ☐ DIRECTIONAL HOLE ☐ HORIZONTAL HOLE  
☐ SERVICE WELL

If directional or horizontal, see reverse for bottom hole location.

COUNTY Nowata SEC 10 TWP 25N RGE 14E  
LEASE NAME Hymarkes Sherry Jackson WELL NO. #1  
SW 1/4 NE 1/4 SW 1/4 NE 1/4 FSL OF 1/4 SEC 859 FWL OF 1/4 SEC 874  
ELEVATION Ground Latitude (if known) Longitude (if known)  
OPERATOR NAME James D. Mitchell OTC/OCC OPERATOR NO. 19952  
ADDRESS 2911 S.E. Washington Blvd.  
CITY Bartlesville STATE Oklahoma ZIP 74006

## COMPLETION REPORT

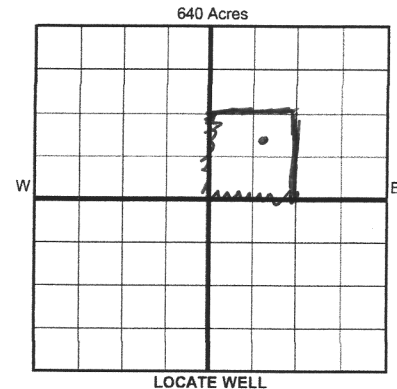
SPUD DATE June 17th 2016  
DRLG FINISHED DATE June 21st 2016  
DATE OF WELL COMPLETION Nov. 27th 2018  
1st PROD DATE Dec. 21st 2018  
RECOMP DATE

## COMPLETION TYPE

☒ SINGLE ZONE  
☐ MULTIPLE ZONE  
Application Date  
COMINGLED  
Application Date  
LOCATION  
EXCEPTION ORDER  
INCREASED DENSITY  
ORDER NO.

## CASING &amp; CEMENT (Form 1002C must be attached)

TYPE	SIZE	WEIGHT	GRADE	FEET	PSI	SAX	TOP OF CMT
CONDUCTOR	<u>4 1/2 in.</u>			<u>1065</u>		<u>90</u>	<u>Surface</u>
SURFACE	<u>7 in.</u>			<u>150</u>		<u>30</u>	<u>Surface</u>
INTERMEDIATE							
PRODUCTION							
LINER							

PACKER @ \_\_\_\_\_ BRAND & TYPE \_\_\_\_\_ PLUG @ \_\_\_\_\_ TYPE \_\_\_\_\_ PLUG @ \_\_\_\_\_ TYPE \_\_\_\_\_  
PACKER @ \_\_\_\_\_ BRAND & TYPE \_\_\_\_\_ PLUG @ \_\_\_\_\_ TYPE \_\_\_\_\_ PLUG @ \_\_\_\_\_ TYPE \_\_\_\_\_TOTAL DEPTH 1065

## COMPLETION &amp; TEST DATA BY PRODUCING FORMATION

FORMATION	<u>Red Fork</u>	<u>404RDFK</u>	<u>Reported to Frac Focus</u>
SPACING & SPACING ORDER NUMBER			
CLASS: Oil, Gas, Dry, Inj, Disp, Comm Disp, Svc	<u>Oil</u>		
PERFORATED INTERVALS	<u>Note: Shot two holes per foot over 11 feet into the Red Fork formation: 863 feet to 874 feet. (22 perforations total.)</u>		
ACID/VOLUME	<u>15% NEE HCL Acid - 500 Gallons</u>		
FRACTURE TREATMENT (Fluids/Prop Amounts)	<u>Frac Sand</u>	<u>Breakdown/Flush</u>	<u>25# Sand-Laden Fluid</u>
	<u>30,000 pds.</u>	<u>#25 Gelled Water: 1600 gallons</u>	<u>Gelled Water: 15,500 Gal.</u>
		<u>6500 Gallons</u>	

Min Gas Allowable (165:10-17-7)

OR

Oil Allowable (165:10-13-3)

Gas Purchaser/Measurer

First Sales Date

## INITIAL TEST DATA

INITIAL TEST DATE	<u>Dec. 21st 2018</u>
OIL-BBL/DAY	<u>68.57</u>
OIL-GRAVITY (API)	<u>38-42</u>
GAS-MCF/DAY	
GAS-OIL RATIO CU FT/BBL	
WATER-BBL/DAY	<u>65.57</u>
PUMPING OR FLOWING	<u>Pumping</u>
INITIAL SHUT-IN PRESSURE	
CHOKE SIZE	
FLOW TUBING PRESSURE	

AS SUBMITTED

A record of the formations drilled through, and pertinent remarks are presented on the reverse. I declare that I have knowledge of the contents of this report and am authorized by my organization to make this report, which was prepared by me or under my supervision and direction, with the data and facts stated herein to be true, correct, and complete to the best of my knowledge and belief.

SIGNATURE James D. Mitchell  
NAME (PRINT OR TYPE)  
ADDRESS 2911 S.E. Washington Blvd. CITY Bartlesville STATE Oklahoma ZIP 74006DATE June 4th 2019 PHONE NUMBER 310-465-5620  
EMAIL ADDRESS mitchelljimd@aol.com

PLEASE TYPE OR USE BLACK INK ONLY

## FORMATION RECORD

Give formation names and tops, if available, or descriptions and thickness of formations drilled through. Show intervals cored or drillstem tested.

NAMES OF FORMATIONS	TOP
<u>Redfork</u>	<u>863 ft.</u>
<u>Note: Bottom of Redfork Formation in this well is 874 feet.</u> <u>(11 feet of sand.)</u>	

LEASE NAME

Hymer Fee

WELL NO.

#1

## FOR COMMISSION USE ONLY

ITD on file ☐ YES ☐ NO

APPROVED DISAPPROVED

2) Reject Codes

Were open hole logs run?

☒ yes ☐ no

Date Last log was run

June 23rd, 2016 (Open Hole)Was CO<sub>2</sub> encountered?☐ yes ☒ no at what depths? \_\_\_\_\_Was H<sub>2</sub>S encountered?☐ yes ☒ no at what depths? \_\_\_\_\_

Were unusual drilling circumstances encountered?

☐ yes ☒ no

If yes, briefly explain below

Note: Cement Bond Log run on October 18th, 2018.

Other remarks:

Initial production was an encouraging 68.57 bpd, but that only lasted two days. On the 3rd day, production dropped to 5 bpd, and two weeks later dropped to 2 bpd. Well currently seems to be stabilized at 1 3/4 - 2 bpd. of oil.

The pumping unit on this well is a 1966 "Cook" brand #16 pump-jack. (It was one of my Grandfather Mitchell's that I restored. (Orville Anderson Mitchell - he bought it brand-new.)

640 Acres

If more than three drainholes are proposed, attach a separate sheet indicating the necessary information.

Direction must be stated in degrees azimuth.  
Please note, the horizontal drainhole and its end point must be located within the boundaries of the lease or spacing unit.

Directional surveys are required for all drainholes and directional wells.

640 Acres

## BOTTOM HOLE LOCATION FOR DIRECTIONAL HOLE

SEC	TWP	RGE	COUNTY
Spot Location			
1/4	1/4	1/4	1/4
Measured Total Depth		True Vertical Depth	BHL From Lease, Unit, or Property Line:

## BOTTOM HOLE LOCATION FOR HORIZONTAL HOLE: (LATERALS)

## LATERAL #1

SEC	TWP	RGE	COUNTY
Spot Location			
1/4	1/4	1/4	1/4
Depth of Deviation		Radius of Turn	Direction
Measured Total Depth		True Vertical Depth	Total Length
			BHL From Lease, Unit, or Property Line:

## LATERAL #2

SEC	TWP	RGE	COUNTY
Spot Location			
1/4	1/4	1/4	1/4
Depth of Deviation		Radius of Turn	Direction
Measured Total Depth		True Vertical Depth	Total Length
			BHL From Lease, Unit, or Property Line:

## LATERAL #3

SEC	TWP	RGE	COUNTY
Spot Location			
1/4	1/4	1/4	1/4
Depth of Deviation		Radius of Turn	Direction
Measured Total Depth		True Vertical Depth	Total Length
			BHL From Lease, Unit, or Property Line: