

Oklahoma Corporation Commission
Oil & Gas Conservation Division
Post Office Box 52000
Oklahoma City, Oklahoma 73152-2000
Rule 165: 10-3-25

Form 1002A

API No.: 35103240140002

Completion Report

Spud Date: June 01, 2006

OTC Prod. Unit No.: 103-117784-0-0000

Drilling Finished Date: June 13, 2006

Amended

1st Prod Date: July 13, 2006

Amend Reason: RECOMPLETION

Completion Date: July 11, 2006

Recomplete Date: December 13, 2018

Drill Type: STRAIGHT HOLE

Well Name: CAROL 4-2

Purchaser/Measurer:

Location: NOBLE 2 24N 1W
NW NW SE SE
1270 FSL 1120 FEL of 1/4 SEC
Derrick Elevation: 0 Ground Elevation: 980

First Sales Date:

Operator: KODA OPERATING LLC 24242

4870 S LEWIS AVE STE 240
TULSA, OK 74105-5153

Completion Type		Location Exception		Increased Density	
	Single Zone	Order No		Order No	
	Multiple Zone	There are no Location Exception records to display.		240901	
X	Commingled			690761	

Casing and Cement							
Type	Size	Weight	Grade	Feet	PSI	SAX	Top of CMT
SURFACE	8 5/8	24	J-55	266		200	SURFACE
PRODUCTION	5 1/2	17 / 15.5	J-55	4903		250	3680

Liner								
Type	Size	Weight	Grade	Length	PSI	SAX	Top Depth	Bottom Depth
There are no Liner records to display.								

Total Depth: 4905

Packer	
Depth	Brand & Type
There are no Packer records to display.	

Plug	
Depth	Plug Type
There are no Plug records to display.	

Initial Test Data										
Test Date	Formation	Oil BBL/Day	Oil-Gravity (API)	Gas MCF/Day	Gas-Oil Ratio Cu FT/BBL	Water BBL/Day	Pumpin or Flowing	Initial Shut-In Pressure	Choke Size	Flow Tubing Pressure
Dec 13, 2018	WILCOX 1&2-VIOLA-MISS LIME-MISS CHAT	8		20	2500	1000	PUMPING			

Completion and Test Data by Producing Formation

Formation Name: WILCOX 2ND

Code: 202WLCX2

Class: OIL

Spacing Orders

Order No	Unit Size
509017	160

Perforated Intervals

From	To
4763	4795
4734	4744

Acid Volumes

36 BARRELS 15% HCL & 249 BBLS FLUID

Fracture Treatments

NONE

Formation Name: WILCOX 1ST

Code: 202WLCX1

Class: OIL

Spacing Orders

Order No	Unit Size
509017	160

Perforated Intervals

From	To
4698	4717

Acid Volumes

ACIDIZED WITH 2ND WILCOX

Fracture Treatments

NONE

Formation Name: VIOLA

Code: 202VIOL

Class: OIL

Spacing Orders

Order No	Unit Size
525189	160

Perforated Intervals

From	To
4668	4682

Acid Volumes

22 BBLS 15% HCL & 214 BBLS FLUID

Fracture Treatments

NONE

Formation Name: MISSISSIPPI LIME

Code: 351MSSLM

Class: OIL

Spacing Orders

Order No	Unit Size
525189	160

Perforated Intervals

From	To
4390	4620

Acid Volumes

258 BBLS 15% HCL

Fracture Treatments

3,762 BBLS FRAC FLUID & 65,200 LBS 20/40 SAND
USING 175 BALL SEALERS

Formation Name: MISSISSIPPI CHAT		Code: 401MSSCT	Class: OIL
Spacing Orders		Perforated Intervals	
Order No	Unit Size	From	To
525189	160	4317	4374
Acid Volumes		Fracture Treatments	
32 BBLS 10% HCL		1,062 BBLS FRAC FLUID & 70,000 LBS 20/40 SAND USING 174 BALL SEALERS	
Formation Name: WILCOX 1&2-VIOLA-MISS LIME-MISS CHAT		Code:	Class: OIL

Formation	Top
VIOLA	4658
WILCOX	4694

Were open hole logs run? Yes
Date last log run: June 12, 2006

Were unusual drilling circumstances encountered? No
Explanation:

Other Remarks
There are no Other Remarks.

FOR COMMISSION USE ONLY	
Status: Accepted	1143882

API NO. 103-24014
OTC PROD. UNIT NO. 103-117784

(PLEASE TYPE OR USE BLACK INK ONLY)

OKLAHOMA CORPORATION COMMISSION
Oil & Gas Conservation Division
Post Office Box 52000
Oklahoma City, Oklahoma 73152-2000
Rule 165:10-3-25

RECEIVED

Form 1002A
Rev. 2009

SEP 23 2019

☒ ORIGINAL
☐ AMENDED (Reason) _____

RE-COMPLETION

COMPLETION REPORT

TYPE OF DRILLING OPERATION

☒ STRAIGHT HOLE ☐ DIRECTIONAL HOLE ☐ HORIZONTAL HOLE
☐ SERVICE WELL

If directional or horizontal, see reverse for bottom hole location.

COUNTY NOBLE SEC 2 TWP 24N RGE 1W
LEASE NAME CAROL
WELL NO. 4-2
NW 1/4 NW 1/4 SE 1/4 SE 1/4 FSL OF 1/4 SEC 1270 FEL OF 1/4 SEC 1120
ELEVATION Ground 980
Derrick FL
OPERATOR NAME KODA OPERATING, LLC
ADDRESS 4870 S LEWIS AVE, STE 240
CITY TULSA STATE OK ZIP 74105

SPUD DATE 6/1/2006
DRLG FINISHED DATE 6/13/2006
DATE OF WELL COMPLETION 7/11/2006
1st PROD DATE 7/13/2006
RECOMP DATE 12/13/2018
OTC / OCC OPERATOR NO. 24242

OKLAHOMA CORPORATION COMMISSION

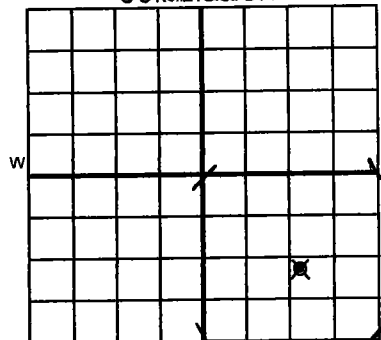

COMPLETION TYPE

☐ SINGLE ZONE
☐ MULTIPLE ZONE
☒ COMMINGLED
LOCATION EXCEPTION ORDER NO.
INCREASED DENSITY ORDER NO.

CASING & CEMENT (Attach Form 1002C)

TYPE	SIZE	WEIGHT	GRADE	FEET	PSI	SAX	TOP OF CMT
CONDUCTOR							
SURFACE	8 5/8	24	J-55	266		200	SURFACE
INTERMEDIATE							
PRODUCTION	5 1/2	17/15.5	J-55	4903		250	3680
LINER							
TOTAL DEPTH							4,905

PACKER @ _____ BRAND & TYPE _____ PLUG @ _____ TYPE _____ PLUG @ _____ TYPE _____
PACKER @ _____ BRAND & TYPE _____ PLUG @ _____ TYPE _____ PLUG @ _____ TYPE _____

COMPLETION & TEST DATA BY PRODUCING FORMATION 202V10L, 202WL CX2, 401M55CT, 351M55LM, 202WL CX1

FORMATION	VIOLA	2nd WILCOX	MISS CHAT	MISS LIME	1st WILCOX
SPACING & SPACING ORDER NUMBER	525189 (160)	509017 (160)	525189 (160)	525189 (160)	509017 (160)
CLASS: Oil, Gas, Dry, Inj, Disp, Comm Disp, Svc	OIL & GAS	OIL & GAS	OIL & GAS	OIL & GAS	oil
PERFORATED INTERVALS	4668-4682	4763-4795 4734-4744 (4698-4717)	4314-4374	4390-4620	4698-4717
ACID/VOLUME	15%HCL 22 BBLS	15%HCL 36 BBLS	10%HCL 32 BBLS	15%HCL 258 BBLS	Acidized 2nd Wilcox
FRACTURE TREATMENT (Fluids/Prop Amounts)	214 BBLS FLUID	249 BBLS FLUID	1062 BBLS FLUID 70000# 20/40 SAND 174 BALL SEALERS	3762 BBLS FLUID 65200# 20/40 SAND 175 BALL SEALERS	

Min Gas Allowable (165:10-17-7)

Gas Purchaser/Measurer

☐ OR
Oil Allowable (165:10-13-3)

First Sales Date

INITIAL TEST DATA

INITIAL TEST DATE	12/13/2018				
OIL-BBL/DAY	8				
OIL-GRAVITY (API)					
GAS-MCF/DAY	20				
GAS-OIL RATIO CU FT/BBL	2500				
WATER-BBL/DAY	1000				
PUMPING OR FLOWING	pumping				
INITIAL SHUT-IN PRESSURE					
CHOKE SIZE					
FLOW TUBING PRESSURE					

AS SUBMITTED

A record of the formations drilled through, and pertinent remarks are presented on the reverse. I declare that I have knowledge of the contents of this report and am authorized by my organization to make this report, which was prepared by me or under my supervision and direction, with the data and facts stated herein to be true, correct, and complete to the best of my knowledge and belief.

STEVE MILLER

9-18-19

918-492-0254

SIGNATURE

NAME (PRINT OR TYPE)

DATE

PHONE NUMBER

4870 S LEWIS AVE, STE 240

TULSA

OK

74105

STEVE@ORIONEXPLORATION.COM

ADDRESS

CITY

STATE

ZIP

EMAIL ADDRESS

PLEASE TYPE OR USE BLACK INK ONLY

FORMATION RECORD

Give formation names and tops, if available, or descriptions and thickness of formations drilled through. Show intervals cored or drillstem tested.

NAMES OF FORMATIONS	TOP
VIOLA	4,658
WILCOX	4,694

LEASE NAME

CAROL

WELL NO.

4-2

FOR COMMISSION USE ONLY	
ITD on file <input type="checkbox"/> YES <input type="checkbox"/> NO	
APPROVED _____	DISAPPROVED _____
2) Reject Codes	

Were open hole logs run?	<input checked="" type="checkbox"/> yes <input type="checkbox"/> no
Date Last log was run	6/12/2006
Was CO ₂ encountered?	<input type="checkbox"/> yes <input type="checkbox"/> no at what depths? _____
Was H ₂ S encountered?	<input type="checkbox"/> yes <input type="checkbox"/> no at what depths? _____
Were unusual drilling circumstances encountered?	<input type="checkbox"/> yes <input type="checkbox"/> no
If yes, briefly explain below	

Other remarks:

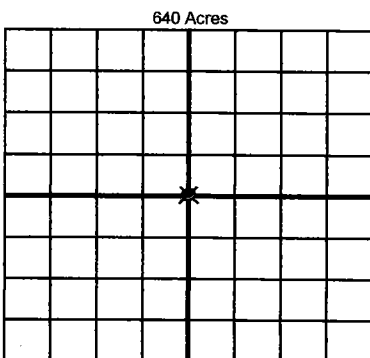

If more than three drainholes are proposed, attach a separate sheet indicating the necessary information.

Direction must be stated in degrees azimuth. Please note, the horizontal drainhole and its end point must be located within the boundaries of the lease or spacing unit.

Directional surveys are required for all drainholes and directional wells.

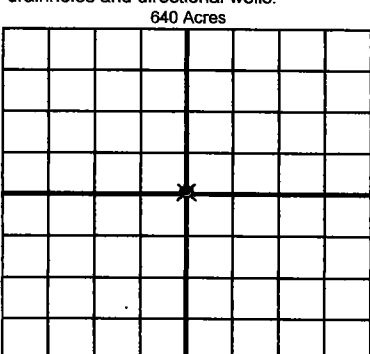

BOTTOM HOLE LOCATION FOR DIRECTIONAL HOLE

SEC	TWP	RGE	COUNTY
Spot Location			
1/4	1/4	1/4	1/4
Measured Total Depth		True Vertical Depth	BHL From Lease, Unit, or Property Line:

BOTTOM HOLE LOCATION FOR HORIZONTAL HOLE: (LATERALS)

LATERAL #1

SEC	TWP	RGE	COUNTY
Spot Location			
1/4	1/4	1/4	1/4
Depth of Deviation		Radius of Turn	Direction
Measured Total Depth		True Vertical Depth	BHL From Lease, Unit, or Property Line:

LATERAL #2

SEC	TWP	RGE	COUNTY
Spot Location			
1/4	1/4	1/4	1/4
Depth of Deviation		Radius of Turn	Direction
Measured Total Depth		True Vertical Depth	BHL From Lease, Unit, or Property Line:

LATERAL #3

SEC	TWP	RGE	COUNTY
Spot Location			
1/4	1/4	1/4	1/4
Depth of Deviation		Radius of Turn	Direction
Measured Total Depth		True Vertical Depth	BHL From Lease, Unit, or Property Line: