

Oklahoma Corporation Commission
Oil & Gas Conservation Division
Post Office Box 52000
Oklahoma City, Oklahoma 73152-2000
Rule 165: 10-3-25

Form 1002A

API No.: 35139006170001

Completion Report

Spud Date: March 23, 1947

OTC Prod. Unit No.: 139-014913-0-0000

Drilling Finished Date: April 05, 1947

Amended

1st Prod Date:

Amend Reason: FRAC WELL

Completion Date: April 05, 1947

Recomplete Date: July 23, 2019

Drill Type: STRAIGHT HOLE

Well Name: DOROTHEA 1

Purchaser/Measurer:

Location: TEXAS 19 1N 16E CM
NE NE NE SW
150 FNL 150 FEL of 1/4 SEC
Latitude: 36.53656 Longitude: -101.37681
Derrick Elevation: 3102 Ground Elevation: 3100

First Sales Date:

Operator: SCOUT ENERGY MANAGEMENT LLC 23138

4901 LBJ FWY STE 300
DALLAS, TX 75244-6107

Completion Type		Location Exception		Increased Density	
X	Single Zone	Order No		Order No	
	Multiple Zone	There are no Location Exception records to display.		There are no Increased Density records to display.	
	Commingled				

Casing and Cement							
Type	Size	Weight	Grade	Feet	PSI	SAX	Top of CMT
SURFACE	8 5/8	17.8	SW	596		300	SURFACE
PRODUCTION	5 1/2	14	H-40	2889		950	SURFACE

Liner								
Type	Size	Weight	Grade	Length	PSI	SAX	Top Depth	Bottom Depth
There are no Liner records to display.								

Total Depth: 3909

Packer		Plug	
Depth	Brand & Type	Depth	Plug Type
There are no Packer records to display.		2864	PBTD

Initial Test Data

Test Date	Formation	Oil BBL/Day	Oil-Gravity (API)	Gas MCF/Day	Gas-Oil Ratio Cu FT/BBL	Water BBL/Day	Pumpin or Flowing	Initial Shut-In Pressure	Choke Size	Flow Tubing Pressure
Jul 25, 2019	GUYMON-HUGOTON			142			FLOWING	104	W/O	10

Completion and Test Data by Producing Formation

Formation Name: GUYMON-HUGOTON

Code: 451GYHG

Class: GAS

Spacing Orders

Order No	Unit Size
17867	640

Perforated Intervals

From	To
2740	2790
2810	2855

Acid Volumes

1,000 GALLONS 15% HCL FOAMED TO 50Q

Fracture Treatments

51,000 BARRELS, 16/30 SAND WITH 444 BARRELS WATER

Formation	Top
CLAY, ROCK	0
SAND, SHELLS	70
RED BEDS, SHELLS	472
SHALE, SHELLS	610
SHALE, SHELLS, SALTS	945
SHALE	1625
SHALE, ANHYDRITE	1816
SHALE	2055
SHALE, SHELLS	2118
SHALE, LIME	2290
LIME	2370
SHALE, ANHYDRITE	2460
LIME	2540
DOLOMITE	2720

Were open hole logs run? No

Date last log run:

Were unusual drilling circumstances encountered? No

Explanation:

Other Remarks

There are no Other Remarks.

FOR COMMISSION USE ONLY

1143719

Status: Accepted

API NO. 35-139-00617 (PLEASE TYPE OR USE BLACK INK ONLY)
OTC PROD. UNIT NO. 139-014913-0-000

OKLAHOMA CORPORATION COMMISSION
Oil & Gas Conservation Division
Post Office Box 52000
Oklahoma City, Oklahoma 73152-2000
Rule 165:10-3-25

RECEIVED

Form 1002A
Rev. 2009

AUG 1 2 2019

OKLAHOMA CORPORATION COMMISSION
640 Acres

☐ ORIGINAL
☒ AMENDED (Reason) Frac Well

COMPLETION REPORT

TYPE OF DRILLING OPERATION
☒ STRAIGHT HOLE ☐ DIRECTIONAL HOLE ☐ HORIZONTAL HOLE
☐ SERVICE WELL

If directional or horizontal, see reverse for bottom hole location.

COUNTY	Texas	SEC	19	TWP	01N	RGE	16E	CM
LEASE NAME	Dorothea				WELL NO.	1	1st PROD DATE	
NE 1/4 NE 1/4 NE 1/4 SW 1/4		END OF 1/4 SEC 150		FEL DF 1/4 SEC 150		DATE OF WELL COMPLETION 04/05/1947		
ELEVATION	3102	Ground	3100	Latitude (if known)		36.53656	Longitude (if known) -101.37681	
OPERATOR NAME	Scout Energy Management LLC				OTC / OCC OPERATOR NO.	23138		
ADDRESS	4901 LBJ Freeway, Suite 300							
CITY	Dallas		STATE	TX		ZIP	75244	

LOCATE WELL									
640 Acres									
W E									

COMPLETION TYPE

<input checked="" type="checkbox"/> SINGLE ZONE	
<input type="checkbox"/> MULTIPLE ZONE	
Application Date	
<input type="checkbox"/> COMMINGLED	
Application Date	
LOCATION EXCEPTION ORDER NO.	
INCREASED DENSITY ORDER NO.	

CASING & CEMENT (Attach Form 1002C)

TYPE	SIZE	WEIGHT	GRADE	FEET	PSI	SAX	TOP OF CMT
CONDUCTOR							
SURFACE	8 5/8	17.8	SW	596		300	Surface
INTERMEDIATE							
PRODUCTION	5 1/2	14	H-40	2889		950	Surface
LINER							

PACKER @ _____ BRAND & TYPE _____ PLUG @ 2864 TYPE PBTD PLUG @ _____ TYPE _____ TOTAL DEPTH 2,909
PACKER @ _____ BRAND & TYPE _____ PLUG @ _____ TYPE _____ PLUG @ _____ TYPE _____

COMPLETION & TEST DATA BY PRODUCING FORMATION

FORMATION	Chase <u>Guyman-Hugoton</u>						Monitor Report to Frac Focus
SPACING & SPACING ORDER NUMBER	17867 (440)						
CLASS: Oil, Gas, Dry, Inj, Disp, Comm Disp, Svc	Gas						
PERFORATED INTERVALS	2740 - 2790						
	2810 - 2855						
ACID/VOLUME	1000 gals 15% HCl foamed to 50Q						
FRACTURE TREATMENT (Fluids/Prop Amounts)	51,000 bls, 16/30 sand w/ 444 bbls wtr						

☐ Min Gas Allowable (165:10-17-7) OR ☐ Oil Allowable (165:10-13-3) Gas Purchaser/Measurer _____ First Sales Date _____

INITIAL TEST DATE	7/25/2019					
OIL-BBL/DAY	-					
OIL-GRAVITY (API)	-					
GAS-MCF/DAY	142					
GAS-OIL RATIO CU FT/BBL	-					
WATER-BBL/DAY	-					
PUMPING OR FLOWING	Flowing					
INITIAL SHUT-IN PRESSURE	104					
CHOKE SIZE	W/O					
FLOW TUBING PRESSURE	10					

A record of the formations drilled through, and pertinent remarks are presented on the reverse. I declare that I have knowledge of the contents of this report and am authorized by my organization to make this report, which was prepared by me or under my supervision and direction, with the data and facts stated herein to be true, correct, and complete to the best of my knowledge and belief.

Emily J. Van Der Gryp SIGNATURE
4901 LBJ Freeway, Suite 300 ADDRESS
Dallas CITY TX 75244 STATE ZIP
Emily J. Van Der Gryp NAME (PRINT OR TYPE)
8/8/2019 DATE (972) 325-1146 PHONE NUMBER
evandergryp@scoutep.com EMAIL ADDRESS

AS SUBMITTED

PLEASE TYPE OR USE BLACK INK ONLY
FORMATION RECORD

Give formation names and tops, if available, or descriptions and thickness of formations drilled through. Show intervals cored or drillstem tested.

LEASE NAME Dorothea WELL NO. 1

NAMES OF FORMATIONS	TOP
Clay, rock	0
Sand, shells	70
Red beds, shells	472
Shale, shells	610
Shale, shells, salts	945
Shale	1,625
Shale, anhydrite	1,816
Shale	2,055
Shale, shells	2,118
Shale, lime	2,290
Lime	2,370
Shale, anhydrite	2,460
Lime	2,540
Dolomite	2,720
TD	2,909

FOR COMMISSION USE ONLY

ITD on file ☐ YES ☐ NO

APPROVED _____ DISAPPROVED _____

2) Reject Codes _____

Were open hole logs run? _____ yes X no

Date Last log was run Unknown

Was CO₂ encountered? _____ yes X no at what depths? _____

Was H₂S encountered? _____ yes X no at what depths? _____

Were unusual drilling circumstances encountered? _____ yes X no

If yes, briefly explain below _____

Other remarks: _____

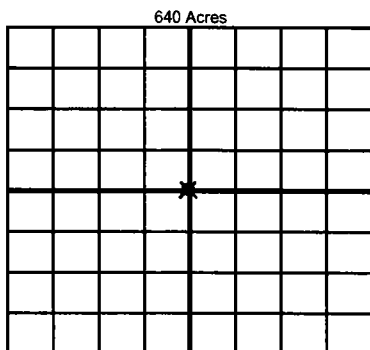

If more than three drainholes are proposed, attach a separate sheet indicating the necessary information.

Direction must be stated in degrees azimuth. Please note, the horizontal drainhole and its end point must be located within the boundaries of the lease or spacing unit.

Directional surveys are required for all drainholes and directional wells.

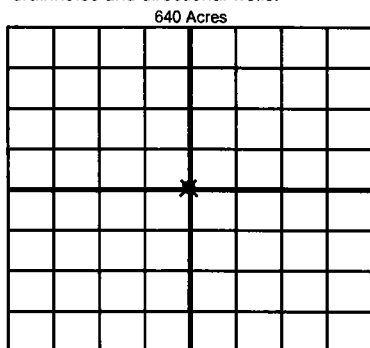

BOTTOM HOLE LOCATION FOR DIRECTIONAL HOLE

SEC	TWP	RGE	COUNTY
Spot Location			
1/4	1/4	1/4	Feet From 1/4 Sec Lines
Measured Total Depth		True Vertical Depth	FSL
			FWL
BHL From Lease, Unit, or Property Line:			

BOTTOM HOLE LOCATION FOR HORIZONTAL HOLE: (LATERALS)

LATERAL #1

SEC	TWP	RGE	COUNTY
Spot Location			
1/4	1/4	1/4	Feet From 1/4 Sec Lines
Depth of Deviation		Radius of Turn	FSL
Measured Total Depth		True Vertical Depth	FWL
			Total Length
BHL From Lease, Unit, or Property Line:			

LATERAL #2

SEC	TWP	RGE	COUNTY
Spot Location			
1/4	1/4	1/4	Feet From 1/4 Sec Lines
Depth of Deviation		Radius of Turn	FSL
Measured Total Depth		True Vertical Depth	FWL
			Total Length
BHL From Lease, Unit, or Property Line:			

LATERAL #3

SEC	TWP	RGE	COUNTY
Spot Location			
1/4	1/4	1/4	Feet From 1/4 Sec Lines
Depth of Deviation		Radius of Turn	FSL
Measured Total Depth		True Vertical Depth	FWL
			Total Length
BHL From Lease, Unit, or Property Line:			