

Oklahoma Corporation Commission  
Oil & Gas Conservation Division  
Post Office Box 52000  
Oklahoma City, Oklahoma 73152-2000  
Rule 165: 10-3-25

Form 1002A

API No.: 35139016570001

**Completion Report**

Spud Date: May 29, 1947

OTC Prod. Unit No.: 139-014950-0-0000

Drilling Finished Date: June 07, 1947

**Amended**

1st Prod Date:

Amend Reason: FRAC WELL

Completion Date: June 16, 1947

Recomplete Date: July 22, 2019

**Drill Type: STRAIGHT HOLE**

Well Name: LANGSTON 1

Purchaser/Measurer:

Location: TEXAS 28 2N 16E CM  
NW NW NW SE  
2436 FSL 2534 FEL of 1/4 SEC  
Latitude: 36.608667 Longitude: -101.34025  
Derrick Elevation: 3006 Ground Elevation: 3003

First Sales Date:

Operator: SCOUT ENERGY MANAGEMENT LLC 23138

4901 LBJ FWY STE 300  
DALLAS, TX 75244-6107

Completion Type		Location Exception		Increased Density	
X	Single Zone	Order No		Order No	
	Multiple Zone	There are no Location Exception records to display.		There are no Increased Density records to display.	
	Commingled				

Casing and Cement							
Type	Size	Weight	Grade	Feet	PSI	SAX	Top of CMT
SURFACE	8 5/8	17.8	SW	638		350	SURFACE
PRODUCTION	5 1/2	14	H-40	2774		900	SURFACE

Liner								
Type	Size	Weight	Grade	Length	PSI	SAX	Top Depth	Bottom Depth
There are no Liner records to display.								

**Total Depth: 2790**

Packer		Plug	
Depth	Brand & Type	Depth	Plug Type
There are no Packer records to display.		2745	PBTD

Initial Test Data
-------------------

Test Date	Formation	Oil BBL/Day	Oil-Gravity (API)	Gas MCF/Day	Gas-Oil Ratio Cu FT/BBL	Water BBL/Day	Pumpin or Flowing	Initial Shut-In Pressure	Choke Size	Flow Tubing Pressure
Jul 25, 2019	GUYMON-HUGOTON			46			FLOWING	185	W/O	20

#### Completion and Test Data by Producing Formation

Formation Name: GUYMON-HUGOTON

Code: 451GYHG

Class: GAS

#### Spacing Orders

Order No	Unit Size
17867	640

#### Perforated Intervals

From	To
2600	2650
2675	2735

#### Acid Volumes

1,000 GALLONS 15% HCL FOAMED TO 50Q
-------------------------------------

#### Fracture Treatments

51,000 BARRELS, 16/30 SAND WITH 444 BARRELS WATER
---

Formation	Top
SURFACE SAND	0
RED BEDS AND GYP	364
RED BEDS	581
RED BEDS, SAND	865
RED BEDS, SHALE	1575
SHALE AND ANHYDRITE	1800
ANHYDRITE, SHALE	1960
LIME, ANHYDRITE	2246
ANHYDRITE, SHALE	2319
ANHYDRITE	2367
LIME, ANHYDRITE	2436
ANHYDRITE	2476
ANHYDRITE, LIME	2527
LIME	2582
DOLOMITE	2600

Were open hole logs run? No

Date last log run:

Were unusual drilling circumstances encountered? No

Explanation:

#### Other Remarks

OCC - THIS WELL IS BOTH PERFORATED AND AN OPEN HOLE COMPLETION. THE OPEN HOLE IS FROM BOTTOM OF THE 5 1/2" CASING TO TOTAL DEPTH OF WELL.

#### FOR COMMISSION USE ONLY

1143720

Status: Accepted

API NO. 35-139-01657  
OTC PROD. UNIT NO. 139-014950-0-000

OKLAHOMA CORPORATION COMMISSION  
Oil & Gas Conservation Division  
Post Office Box 52000  
Oklahoma City, Oklahoma 73152-2000  
Rule 165:10-3-25

**RECEIVED**  
AUG 12 2019  
Oklahoma Corporation  
Commission

Form 1002A  
Rev. 2009

☐ ORIGINAL  
☒ AMENDED (Reason) Frac Well

COMPLETION REPORT

TYPE OF DRILLING OPERATION  
☒ STRAIGHT HOLE ☐ DIRECTIONAL HOLE ☐ HORIZONTAL HOLE  
☐ SERVICE WELL

If directional or horizontal, see reverse for bottom hole location.

COUNTY	Texas	SEC	28	TWP	02N	RGE	16ECM	SPUD DATE	05/29/1947	
LEASE NAME	Langston	WELL NO.	1	DRILL FINISHED DATE	06/07/1947	DATE OF WELL COMPLETION			06/16/1947	
NW 1/4 NW 1/4 NW 1/4 SE 1/4		FSL OF 1/4 SEC	2436	FEL OF 1/4 SEC	2534	RECOMP DATE		07/22/2019		
ELEVATION Derrick FL	3006	Ground	3003	Latitude (if known)	36.608667	Longitude (if known)		-101.34025		
OPERATOR NAME				Scout Energy Management LLC		OTC / OCC OPERATOR NO.		23138		
ADDRESS										4901 LBJ Freeway, Suite 300
CITY				Dallas		STATE	TX	ZIP	75244	

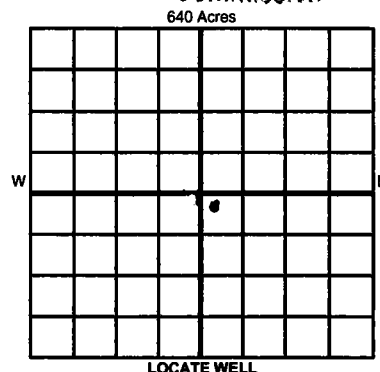

COMPLETION TYPE

<input checked="" type="checkbox"/>	SINGLE ZONE	
<input type="checkbox"/>	MULTIPLE ZONE	
<input type="checkbox"/>	Application Date	
<input type="checkbox"/>	COMINGLED	
<input type="checkbox"/>	Application Date	
<input type="checkbox"/>	LOCATION EXCEPTION	
<input type="checkbox"/>	ORDER NO.	
<input type="checkbox"/>	INCREASED DENSITY	
<input type="checkbox"/>	ORDER NO.	

CASING & CEMENT (Attach Form 1002C)

TYPE	SIZE	WEIGHT	GRADE	FEET	PSI	SAX	TOP OF CMT
CONDUCTOR							
SURFACE	8 5/8	17.8	SW	638		350	Surface
INTERMEDIATE							
PRODUCTION	5 1/2	14	H-40	2774		900	Surface
LINER							

PACKER @ \_\_\_\_\_ BRAND & TYPE \_\_\_\_\_ PLUG @ 2745 TYPE PBTD PLUG @ \_\_\_\_\_ TYPE \_\_\_\_\_ TOTAL DEPTH 2,790  
PACKER @ \_\_\_\_\_ BRAND & TYPE \_\_\_\_\_ PLUG @ \_\_\_\_\_ TYPE \_\_\_\_\_ PLUG @ \_\_\_\_\_ TYPE \_\_\_\_\_

COMPLETION & TEST DATA BY PRODUCING FORMATION

FORMATION	Chase Guyman-Hugoton						Monitor Report to Frac Focus
SPACING & SPACING ORDER NUMBER	17867-640						
CLASS: Oil, Gas, Dry, Inj, Disp, Comm Disp, Svc	Gas						
PERFORATED INTERVALS	2600 - 2650						
	2675 - 2735						
	2760 - 2790 (open hole)	see remarks					
ACID/VOLUME	1000 gals 15% HCl foamed to 50Q						
FRACTURE TREATMENT (Fluids/Prop Amounts)	51,000 bls, 16/30 sand w/ 444 bbls wtr						

Min Gas Allowable (165:10-17-7) ☐ OR Gas Purchaser/Measurer First Sales Date \_\_\_\_\_  
Oil Allowable (165:10-13-3)

INITIAL TEST DATA

INITIAL TEST DATE	7/25/2019					
OIL-BBL/DAY	-					
OIL-GRAVITY ( API)	-					
GAS-MCF/DAY	46					
GAS-OIL RATIO CU FT/BBL	-					
WATER-BBL/DAY	-					
PUMPING OR FLOWING	Flowing					
INITIAL SHUT-IN PRESSURE	185					
CHOKE SIZE	W/O					
FLOW TUBING PRESSURE	20					

**AS SUBMITTED**

A record of the formations drilled through, and pertinent remarks are presented on the reverse. I declare that I have knowledge of the contents of this report and am authorized by my organization to make this report, which was prepared by me or under my supervision and direction, with the data and facts stated herein to be true, correct, and complete to the best of my knowledge and belief.

SIGNATURE	Emily J. Van Der Gryp	DATE	8/8/2019	PHONE NUMBER	(972) 325-1146
ADDRESS	4901 LBJ Freeway, Suite 300	CITY	Dallas	STATE	TX
		ZIP	75244	EMAIL ADDRESS	evandergryp@scoutep.com

**PLEASE TYPE OR USE BLACK INK ONLY**  
**FORMATION RECORD**

Give formation names and tops, if available, or descriptions and thickness of formations drilled through. Show intervals cored or drillstem tested.

LEASE NAME Langston WELL NO. 1

NAMES OF FORMATIONS	TOP
Surface sand	0
Red beds & Gyp	364
Red beds	581
Red bed, sand	865
Red bed, shale	1,575
Shale & Anhydrite	1,800
Anhydrite, shale	1,960
Lime, anhydrite	2,246
Anhydrite, shale	2,319
Anhydrite	2,367
Lime, anhydrite	2,436
Anhydrite	2,476
Abhydrite, lime	2,527
Lime	2,582
Dolomite	2,600
TD	2190

**FOR COMMISSION USE ONLY**

ITD on file ☐ YES ☐ NO

APPROVED \_\_\_\_\_ DISAPPROVED \_\_\_\_\_

2) Reject Codes \_\_\_\_\_

\_\_\_\_\_

\_\_\_\_\_

\_\_\_\_\_

\_\_\_\_\_

Were open hole logs run? \_\_\_\_ yes X no

Date Last log was run Unknown

Was CO<sub>2</sub> encountered? \_\_\_\_ yes X no at what depths? \_\_\_\_\_

Was H<sub>2</sub>S encountered? \_\_\_\_ yes X no at what depths? \_\_\_\_\_

Were unusual drilling circumstances encountered? \_\_\_\_ yes X no

If yes, briefly explain below \_\_\_\_\_

Other remarks: DCC - This well is both perforated and an open hole completion.  
The open hole is from bottom of the 5 1/2" casing to total depth of well.

\_\_\_\_\_

\_\_\_\_\_

\_\_\_\_\_

\_\_\_\_\_

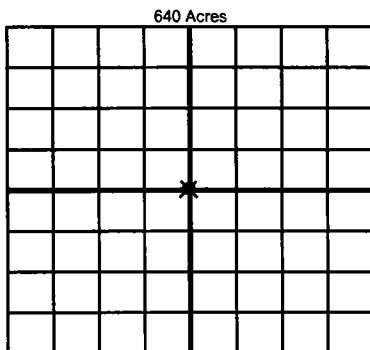

If more than three drainholes are proposed, attach a separate sheet indicating the necessary information.

Direction must be stated in degrees azimuth. Please note, the horizontal drainhole and its end point must be located within the boundaries of the lease or spacing unit.

Directional surveys are required for all drainholes and directional wells.

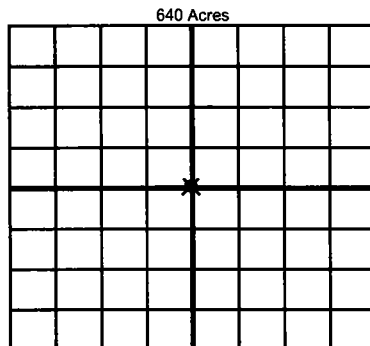

**BOTTOM HOLE LOCATION FOR DIRECTIONAL HOLE**

SEC	TWP	RGE	COUNTY
Spot Location		Feet From 1/4 Sec Lines	FSL
1/4	1/4	1/4	FWL
Measured Total Depth		True Vertical Depth	BHL From Lease, Unit, or Property Line:

**BOTTOM HOLE LOCATION FOR HORIZONTAL HOLE: (LATERALS)**

**LATERAL #1**

SEC	TWP	RGE	COUNTY
Spot Location		Feet From 1/4 Sec Lines	FSL
1/4	1/4	1/4	FWL
Depth of Deviation	Radius of Turn	Direction	Total Length
Measured Total Depth	True Vertical Depth	BHL From Lease, Unit, or Property Line:	

**LATERAL #2**

SEC	TWP	RGE	COUNTY
Spot Location		Feet From 1/4 Sec Lines	FSL
1/4	1/4	1/4	FWL
Depth of Deviation	Radius of Turn	Direction	Total Length
Measured Total Depth	True Vertical Depth	BHL From Lease, Unit, or Property Line:	

**LATERAL #3**

SEC	TWP	RGE	COUNTY
Spot Location		Feet From 1/4 Sec Lines	FSL
1/4	1/4	1/4	FWL
Depth of Deviation	Radius of Turn	Direction	Total Length
Measured Total Depth	True Vertical Depth	BHL From Lease, Unit, or Property Line:	