

Oklahoma Corporation Commission
Oil & Gas Conservation Division
Post Office Box 52000
Oklahoma City, Oklahoma 73152-2000
Rule 165: 10-3-25

Form 1002A

API No.: 35153236450000

Completion Report

Spud Date: May 05, 2019

OTC Prod. Unit No.: 153-226227-0-0000

Drilling Finished Date: May 20, 2019

1st Prod Date:

Completion Date: June 13, 2019

Drill Type: STRAIGHT HOLE

Well Name: ROPER 1-26

Purchaser/Measurer:

Location: WOODWARD 26 23N 20W
NE NE SW SW
1074 FSL 1154 FWL of 1/4 SEC
Derrick Elevation: 1904 Ground Elevation: 1886

First Sales Date:

Operator: WOODWARD IODINE CORPORATION 12837
PO BOX 1245
205865 ECR 32
WOODWARD, OK 73802-1245

Completion Type	
X	Single Zone
	Multiple Zone
	Commingled

Location Exception
Order No
702787

Increased Density
Order No
There are no Increased Density records to display.

Casing and Cement							
Type	Size	Weight	Grade	Feet	PSI	SAX	Top of CMT
CONDUCTOR	20			92			0
SURFACE	13.375	54.5	J-55	454	500	700	SURFACE
INTERMEDIATE	9.625	36	J-55	1705	500	705	SURFACE
PRODUCTION	7	26	P-110	8160	4500	630	SURFACE

Liner								
Type	Size	Weight	Grade	Length	PSI	SAX	Top Depth	Bottom Depth
There are no Liner records to display.								

Total Depth: 8160

Packer	
Depth	Brand & Type
There are no Packer records to display.	

Plug	
Depth	Plug Type
There are no Plug records to display.	

Initial Test Data

Test Date	Formation	Oil BBL/Day	Oil-Gravity (API)	Gas MCF/Day	Gas-Oil Ratio Cu FT/BBL	Water BBL/Day	Pumpin or Flowing	Initial Shut-In Pressure	Choke Size	Flow Tubing Pressure
Sep 30, 2019	MORROW SAND			100		1400	PUMPING	2100	NONE	300

Completion and Test Data by Producing Formation																		
Formation Name: MORROW SAND	Code: 402MWSD	Class: GAS																
<table border="1" style="width:100%; border-collapse: collapse;"> <tr> <th colspan="2" style="text-align: center;">Spacing Orders</th> <th colspan="2" style="text-align: center;">Perforated Intervals</th> </tr> <tr> <th style="width: 50%;">Order No</th> <th style="width: 50%;">Unit Size</th> <th style="width: 50%;">From</th> <th style="width: 50%;">To</th> </tr> <tr> <td>38965</td> <td>640</td> <td>7840</td> <td>8046</td> </tr> <tr> <td>63509</td> <td>640</td> <td></td> <td></td> </tr> </table>			Spacing Orders		Perforated Intervals		Order No	Unit Size	From	To	38965	640	7840	8046	63509	640		
Spacing Orders		Perforated Intervals																
Order No	Unit Size	From	To															
38965	640	7840	8046															
63509	640																	
<table border="1" style="width:100%; border-collapse: collapse;"> <tr> <th style="text-align: center;">Acid Volumes</th> </tr> <tr> <td>There are no Acid Volume records to display.</td> </tr> </table>		Acid Volumes	There are no Acid Volume records to display.	<table border="1" style="width:100%; border-collapse: collapse;"> <tr> <th style="text-align: center;">Fracture Treatments</th> </tr> <tr> <td>185,540 POUNDS 20/40, 34,860 POUNDS 20/40 RC, 2,975 BARRELS XL GEL</td> </tr> </table>	Fracture Treatments	185,540 POUNDS 20/40, 34,860 POUNDS 20/40 RC, 2,975 BARRELS XL GEL												
Acid Volumes																		
There are no Acid Volume records to display.																		
Fracture Treatments																		
185,540 POUNDS 20/40, 34,860 POUNDS 20/40 RC, 2,975 BARRELS XL GEL																		

Formation	Top
OSWEGO	6710
MORROW SHALE	7584
MORROW SAND	7840
CHESTER	8044

Were open hole logs run? Yes
Date last log run: May 16, 2019

Were unusual drilling circumstances encountered? No
Explanation:

Other Remarks WELL DRILLED FOR MORROW WATER FOR EXTRACTION OF IODINE. WELL PRODUCING WITH ESP. OCC - OPERATOR SET CIBP + 10 SACKS CEMENT AT 7,980'. PERFORATED 7,920' TO 7,921'. SQUEEZED CEMENT WITH 150 SACKS, LIFTED CEMENT TO 6,295'. DRILLED OUT AFTER SQUEEZE.
--

FOR COMMISSION USE ONLY	
Status: Accepted	1143849

API NO. 15323245
OTC PROD. UNIT NO. 153-226227-0-0000

(PLEASE TYPE OR USE CHECK INK ONLY)

OKLAHOMA CORPORATION COMMISSION
Oil & Gas Conservation Division
Post Office Box 52000
Oklahoma City, Oklahoma 73152-2000
Rule 165:10-3-25

RECEIVED
Form 1002A
Rev. 2009

OCT 11 2019

☒ ORIGINAL
☐ AMENDED (Reason)

COMPLETION REPORT

TYPE OF DRILLING OPERATION

☒ STRAIGHT HOLE ☐ DIRECTIONAL HOLE ☐ HORIZONTAL HOLE
☐ SERVICE WELL

If directional or horizontal, see reverse for bottom hole location.

COUNTY WOODWARD SEC 26 TWP 23N RGE 20W 1M
LEASE NAME ROPER WELL NO. 1-26
NE 1/4 NE 1/4 SW 1/4 SW 1/4 FSL OF 1/4 SEC 1074 FWL OF 1/4 SEC 1154
ELEVATION 1904 Ground 1886 Latitude (if known) 36°26'15.70" Longitude (if known) 99°18'48.88"
OPERATOR NAME WOODWARD OIL & GAS CORPORATION OTC / OCC OPERATOR NO. 12837 0
ADDRESS PO BOX 1245
CITY WOODWARD STATE OK ZIP 73802-1245

SPUD DATE 5/5/19
DRILL FINISHED DATE 5/20/19
DATE OF WELL COMPLETION 6/13/19
1st PROD DATE
RECOMP DATE

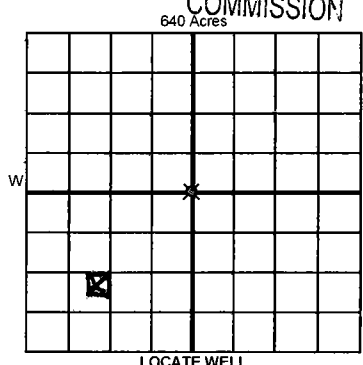

COMPLETION TYPE

☒ SINGLE ZONE
☐ MULTIPLE ZONE
☐ COMMINGLED
LOCATION EXCEPTION ORDER NO. 702787
INCREASED DENSITY ORDER NO.

CASING & CEMENT (Attach Form 1002C)

TYPE	SIZE	WEIGHT	GRADE	FEET	PSI	SAX	TOP OF CMT
CONDUCTOR	20			92			0
SURFACE	13.375	54.5	J55	454	500	700	SURFACE
INTERMEDIATE	7.625	36	J55	170.5	500	700	SURFACE
PRODUCTION	7	26	P110	8160	4500	630	SURFACE
LINER							
				TOTAL DEPTH	8160		

PACKER @ _____ BRAND & TYPE _____ PLUG @ _____ TYPE _____ PLUG @ _____ TYPE _____
PACKER @ _____ BRAND & TYPE _____ PLUG @ _____ TYPE _____ PLUG @ _____ TYPE _____

COMPLETION & TEST DATA BY PRODUCING FORMATION

FORMATION	<u>MORROW Sand</u>							<u>Monitor Report to Frac Focus</u>
SPACING & SPACING ORDER NUMBER	<u>63509</u> <u>38965 (640)</u>							
CLASS: Oil, Gas, Dry, Inj, Disp, Comm Disp, Svc	<u>WATER 645</u>							
PERFORATED INTERVALS	<u>7998-8046</u> <u>7840-7856</u> <u>7868-7888</u>							
ACID/VOLUME								
FRACTURE TREATMENT (Fluids/Prop Amounts)	<u>185,546 # 2940</u> <u>34,860 # 2940 R</u> <u>2,975 BBL VL GEL</u>							

Min Gas Allowable (165:10-17-7)

Gas Purchaser/Measurer

☐

OR

First Sales Date

INITIAL TEST DATA

Oil Allowable (165:10-13-3)

INITIAL TEST DATE	<u>9/30/19</u>						
OIL-BBL/DAY	<u>0</u>						
OIL-GRAVITY (API)	<u>—</u>						
GAS-MCF/DAY	<u>100</u>						
GAS-OIL RATIO CU FT/BBL	<u>—</u>						
WATER-BBL/DAY	<u>1400</u>						
PUMPING OR FLOWING	<u>PUMP - ESP</u>						
INITIAL SHUT-IN PRESSURE	<u>2100</u>						
CHOKE SIZE	<u>NONE</u>						
FLOW TUBING PRESSURE	<u>300 PSI</u>						

AS SUBMITTED

A record of the formations drilled through, and pertinent remarks are presented on the reverse. I declare that I have knowledge of the contents of this report and am authorized by my organization to make this report, which was prepared by me or under my supervision and direction, with the data and facts stated herein to be true, correct, and complete to the best of my knowledge and belief.

SIGNATURE C. Neal Earle NAME (PRINT OR TYPE) NEAL EARLE (AGENT) DATE 9/30/2019 PHONE NUMBER 806 525 9811
ADDRESS 711 W BIRCH CITY CANADIAN TX STATE 79014 EMAIL ADDRESS EARLE@HADEALG.COM

PLEASE TYPE OR USE BLACK INK ONLY
FORMATION RECORD

Give formation names and tops, if available, or descriptions and thickness of formations drilled through. Show intervals cored or drillstem tested.

NAMES OF FORMATIONS	TOP
OSWEGO	6710
MORROW SH	7584
MORROW SD	7840
CHESTER	8044

LEASE NAME

ROPER

WELL NO.

1-26

FOR COMMISSION USE ONLY

ITD on file ☐ YES ☐ NO

APPROVED DISAPPROVED

2) Reject Codes

Were open hole logs run?

X yes no

Date Last log was run

5/16/19

Was CO₂ encountered?

yes X no at what depths?

Was H₂S encountered?

yes X no at what depths?

Were unusual drilling circumstances encountered?
If yes, briefly explain below.

yes X no

Other remarks:

WELL DRILLED FOR MORROW WATER FOR EXTRACTION OF
10 DUNE.

WELL PRODUCING W/ ESP

OCC-Operator set CIBP+10 sacks cement at 7480 perforated 7420 to 7421
squeezed cement with 150 sacks lifted cement to 6295' Drilled out
after squeeze

640 Acres

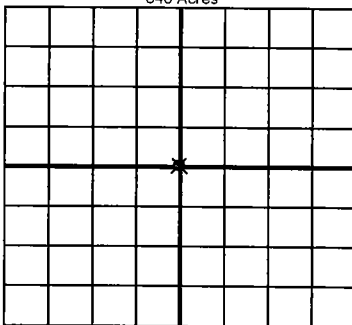

If more than three drainholes are proposed, attach a separate sheet indicating the necessary information.

Direction must be stated in degrees azimuth.
Please note, the horizontal drainhole and its end point must be located within the boundaries of the lease or spacing unit.

Directional surveys are required for all drainholes and directional wells.

640 Acres

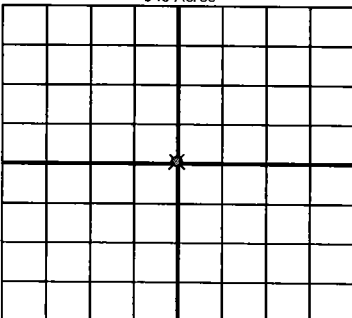

BOTTOM HOLE LOCATION FOR DIRECTIONAL HOLE

SEC	TWP	RGE	COUNTY
Spot Location			
1/4	1/4	1/4	1/4
Measured Total Depth		True Vertical Depth	BHL From Lease, Unit, or Property Line:

BOTTOM HOLE LOCATION FOR HORIZONTAL HOLE: (LATERALS)

LATERAL #1

SEC	TWP	RGE	COUNTY
Spot Location			
1/4	1/4	1/4	1/4
Depth of Deviation		Radius of Turn	Direction
Measured Total Depth		True Vertical Depth	Total Length
BHL From Lease, Unit, or Property Line:			

LATERAL #2

SEC	TWP	RGE	COUNTY
Spot Location			
1/4	1/4	1/4	1/4
Depth of Deviation		Radius of Turn	Direction
Measured Total Depth		True Vertical Depth	Total Length
BHL From Lease, Unit, or Property Line:			

LATERAL #3

SEC	TWP	RGE	COUNTY
Spot Location			
1/4	1/4	1/4	1/4
Depth of Deviation		Radius of Turn	Direction
Measured Total Depth		True Vertical Depth	Total Length
BHL From Lease, Unit, or Property Line:			