

Oklahoma Corporation Commission
Oil & Gas Conservation Division
Post Office Box 52000
Oklahoma City, Oklahoma 73152-2000
Rule 165: 10-3-25

Form 1002A

API No.: 35139016590001

Completion Report

Spud Date: May 07, 1947

OTC Prod. Unit No.: 139-014930-0-0000

Drilling Finished Date: May 16, 1947

Amended

1st Prod Date:

Amend Reason: FRAC WELL

Completion Date: May 16, 1947

Recomplete Date: July 23, 2019

Drill Type: STRAIGHT HOLE

Well Name: RIZLEY 1

Purchaser/Measurer:

Location: TEXAS 33 2N 16E CM
SW SW SW NE
2432 FNL 2531 FEL of 1/4 SEC
Latitude: 36.595306 Longitude: -101.340278
Derrick Elevation: 2855 Ground Elevation: 2852

First Sales Date:

Operator: SCOUT ENERGY MANAGEMENT LLC 23138

4901 LBJ FWY STE 300
DALLAS, TX 75244-6107

Completion Type		Location Exception		Increased Density	
X	Single Zone	Order No		Order No	
	Multiple Zone	There are no Location Exception records to display.		There are no Increased Density records to display.	
	Commingled				

Casing and Cement							
Type	Size	Weight	Grade	Feet	PSI	SAX	Top of CMT
SURFACE	8 5/8	17.8	SW	517		300	SURFACE
PRODUCTION	5 1/2	14	H-40	2639		900	SURFACE

Liner								
Type	Size	Weight	Grade	Length	PSI	SAX	Top Depth	Bottom Depth
There are no Liner records to display.								

Total Depth: 2645

Packer		Plug	
Depth	Brand & Type	Depth	Plug Type
There are no Packer records to display.		There are no Plug records to display.	

Initial Test Data

Test Date	Formation	Oil BBL/Day	Oil-Gravity (API)	Gas MCF/Day	Gas-Oil Ratio Cu FT/BBL	Water BBL/Day	Pumpin or Flowing	Initial Shut-In Pressure	Choke Size	Flow Tubing Pressure
Jul 25, 2019	GUYMON-HUGOTON			216			FLOWING	155	W/O	25

Completion and Test Data by Producing Formation

Formation Name: GUYMON-HUGOTON

Code: 451GYHG

Class: GAS

Spacing Orders

Order No	Unit Size
17867	640

Perforated Intervals

From	To
2510	2645

Acid Volumes

1,000 GALLONS 15% HCL FOAMED TO 50Q

Fracture Treatments

51,000 BARRELS 16/30 SAND WITH 444 BARRELS WATER
--

Formation	Top
SAND, SHELLS	0
RED BEDS	170
SHELLS AND RED BEDS	385
RED BEDS AND GYP	530
SHALE AND SALT	825
SHALE AND SHELLS	1436
ANHYDRITE	2055
SHALE AND ANHYDRITE	2172
ANHYDRITE	2260
LIME	2445
DOLOMITE	2475
SHALE	2614
DOLOMITE	2624

Were open hole logs run? No

Date last log run:

Were unusual drilling circumstances encountered? No

Explanation:

Other Remarks

OCC - THIS WELL IS BOTH PERFORATED AND AN OPEN HOLE COMPLETION. THE OPEN HOLE IS FROM BOTTOM OF THE 5 1/2" CASING TO TOTAL DEPTH OF WELL.

FOR COMMISSION USE ONLY

1143726

Status: Accepted

API NO. 35-139-01659 (PLEASE TYPE OR USE BLACK INK ONLY)

OKLAHOMA CORPORATION COMMISSION

Oil & Gas Conservation Division

Post Office Box 52000

Oklahoma City, Oklahoma 73152-2000

Rule 165:10-3-25

RECEIVED

Form 1002A

Rev. 2009

AUG 12 2019

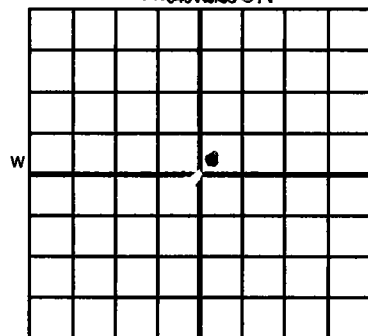
OKLAHOMA CORPORATION
COMMISSION

LOCATE WELL

☐ ORIGINAL
☒ AMENDED (Reason)

Frac Well

COMPLETION REPORT

TYPE OF DRILLING OPERATION

☒ STRAIGHT HOLE ☐ DIRECTIONAL HOLE ☐ HORIZONTAL HOLE
☐ SERVICE WELL

If directional or horizontal, see reverse for bottom hole location.

SPUD DATE 05/07/1947

DRLG FINISHED DATE 05/16/1947

DATE OF WELL COMPLETION 05/16/1947

1st PROD DATE

COUNTY Texas SEC 33 TWP 02N RGE 16ECM

LEASE NAME Rizley

WELL NO. 1

SW 1/4 SW 1/4 NE 1/4 FNL OF 1/4 SEC 2432

FEL OF 1/4 SEC 2531

RECOMP DATE 07/23/2019

ELEVATION 2855 Ground 2852

Latitude (if known) 36.595306

Longitude (if known) -101.340278

OPERATOR NAME Scout Energy Management LLC

OTC / OCC OPERATOR NO. 23138

ADDRESS 4901 LBJ Freeway, Suite 300

CITY Dallas

STATE TX

ZIP 75244

COMPLETION TYPE

☒ SINGLE ZONE
☐ MULTIPLE ZONE
☐ COMMINGLED
☐ LOCATION EXCEPTION
☐ ORDER NO.
☐ INCREASED DENSITY
☐ ORDER NO.

CASING & CEMENT (Attach Form 1002C)

TYPE	SIZE	WEIGHT	GRADE	FEET	PSI	SAX	TOP OF CMT
CONDUCTOR							
SURFACE	8 5/8	17.8	SW	517		300	Surface
INTERMEDIATE							
PRODUCTION	5 1/2	14	H-40	2639		900	Surface
LINER							
						TOTAL DEPTH	2,645

PACKER @ BRAND & TYPE

PLUG @ TYPE

PLUG @ TYPE

TOTAL DEPTH 2,645

PACKER @ BRAND & TYPE

PLUG @ TYPE

PLUG @ TYPE

COMPLETION & TEST DATA BY PRODUCING FORMATION

FORMATION	Chase Guymon-Hugoton					Monitor Report
SPACING & SPACING ORDER NUMBER	17067 (640)					To Frac Focus
CLASS: Oil, Gas, Dry, Inj, Disp, Comm Disp, Svc	Gas					
PERFORATED INTERVALS	2510 - 2645					
	2625 - 2645 (open hole) See remarks					
ACID/VOLUME	1000 gals 15% HCl foamed to 50Q					
FRACTURE TREATMENT (Fluids/Prop Amounts)	51,000 bbls, 16/30 sand w/ 444 bbls wtr					

Min Gas Allowable (165:10-17-7)

Gas Purchaser/Measurer



OR

First Sales Date

Oil Allowable (165:10-13-3)

INITIAL TEST DATA

INITIAL TEST DATE	7/25/2019				
OIL-BBL/DAY	-				
OIL-GRAVITY (API)	-				
GAS-MCF/DAY	216				
GAS-OIL RATIO CU FT/BBL	-				
WATER-BBL/DAY	-				
PUMPING OR FLOWING	Flowing				
INITIAL SHUT-IN PRESSURE	155				
CHOKE SIZE	W/O				
FLOW TUBING PRESSURE	25				

AS SUBMITTED

A record of the formations drilled through, and pertinent remarks are presented on the reverse. I declare that I have knowledge of the contents of this report and am authorized by my organization to make this report, which was prepared by me, or under my supervision and direction, with the data and facts stated herein to be true, correct, and complete to the best of my knowledge and belief.

SIGNATURE

Emily J. Van Der Gryp

NAME (PRINT OR TYPE)

8/8/2019

DATE

(972) 325-1146

PHONE NUMBER

4901 LBJ Freeway, Suite 300

ADDRESS

Dallas

CITY

TX

STATE

75244

ZIP

evandergryp@scoutep.com

EMAIL ADDRESS

PLEASE TYPE OR USE BLACK INK ONLY
FORMATION RECORD

Give formation names and tops, if available, or descriptions and thickness of formations drilled through. Show intervals cored or drillstem tested.

NAMES OF FORMATIONS	TOP
Sand, shells	0
Red beds	170
Shells & red beds	385
Red beds & Gyp	530
Shale & salt	825
Shale & Shells	1,436
Anhydrite	2,055
Shale & Anhydrite	2,172
Anhydrite	2,260
Lime	2,445
Dolomite	2,475
Shale	2,614
Dolomite	2,624
TD	2,645

LEASE NAME Rizley WELL NO. 1

FOR COMMISSION USE ONLY	
ITD on file <input type="checkbox"/> YES <input type="checkbox"/> NO	
APPROVED _____	DISAPPROVED _____
2) Reject Codes	

Were open hole logs run?	yes	<input checked="" type="checkbox"/> no
Date Last log was run	Unknown	
Was CO ₂ encountered?	yes	<input checked="" type="checkbox"/> no at what depths? _____
Was H ₂ S encountered?	yes	<input checked="" type="checkbox"/> no at what depths? _____
Were unusual drilling circumstances encountered?	yes	<input checked="" type="checkbox"/> no
If yes, briefly explain below		

Other remarks:

OCC - This well is both perforated and an open hole completion. The open hole is from bottom of the 5 1/2" casing to total depth of well.

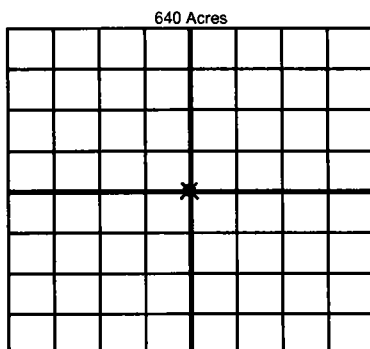

If more than three drainholes are proposed, attach a separate sheet indicating the necessary information.

Direction must be stated in degrees azimuth. Please note, the horizontal drainhole and its end point must be located within the boundaries of the lease or spacing unit.

Directional surveys are required for all drainholes and directional wells.

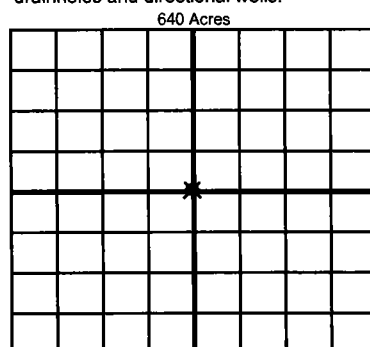

BOTTOM HOLE LOCATION FOR DIRECTIONAL HOLE

SEC	TWP	RGE	COUNTY
Spot Location			
1/4	1/4	1/4	1/4
Measured Total Depth		True Vertical Depth	BHL From Lease, Unit, or Property Line:

BOTTOM HOLE LOCATION FOR HORIZONTAL HOLE: (LATERALS)

LATERAL #1

SEC	TWP	RGE	COUNTY
Spot Location			
1/4	1/4	1/4	1/4
Depth of Deviation		Radius of Turn	Direction
Measured Total Depth		True Vertical Depth	BHL From Lease, Unit, or Property Line:

LATERAL #2

SEC	TWP	RGE	COUNTY
Spot Location			
1/4	1/4	1/4	1/4
Depth of Deviation		Radius of Turn	Direction
Measured Total Depth		True Vertical Depth	BHL From Lease, Unit, or Property Line:

LATERAL #3

SEC	TWP	RGE	COUNTY
Spot Location			
1/4	1/4	1/4	1/4
Depth of Deviation		Radius of Turn	Direction
Measured Total Depth		True Vertical Depth	BHL From Lease, Unit, or Property Line: